

01-74

FEDERAL EMERGENCY MANAGEMENT AGENCY
NATIONAL FLOOD INSURANCE PROGRAMO.M.B. No. 3067-0077
Expires December 31, 2005

ELEVATION CERTIFICATE

6-26-06

Important: Read the instructions on pages 1 - 7.

SECTION A - PROPERTY OWNER INFORMATION			For Insurance Company Use:
BUILDING OWNER'S NAME Millard H. & Betty Y. Childers			Policy Number
BUILDING STREET ADDRESS (including Apt., Unit, Suite, and/or Bldg. No.) OR P.O. ROUTE AND BOX NO. 17465 W. Chinle			Company NAIC Number
CITY Tucson	STATE AZ	ZIP CODE 85653	
PROPERTY DESCRIPTION (Lot and Block Numbers, Tax Parcel Number, Legal Description, etc.) Tax Code #208-11-2690 T11S, R10E, Sec. 29			
BUILDING USE (e.g., Residential, Non-residential, Addition, Accessory, etc. Use a Comments area, if necessary.) Residential			
LATITUDE/LONGITUDE (OPTIONAL) (##° - ##' - ###.###" or ###.####")		HORIZONTAL DATUM: SOURCE: <input type="checkbox"/> GPS (Type): <input type="checkbox"/> USGS Quad Map <input type="checkbox"/> Other: <input type="checkbox"/>	
		<input type="checkbox"/> NAD 1927 <input type="checkbox"/> NAD 1983	

SECTION B - FLOOD INSURANCE RATE MAP (FIRM) INFORMATION					
B1. NFIP COMMUNITY NAME & COMMUNITY NUMBER Pima County 040073		B2. COUNTY NAME Pima		B3. STATE AZ	
B4. MAP AND PANEL NUMBER 04019C 0955	B5. SUFFIX K	B6. FIRM INDEX DATE 2-8-99	B7. FIRM PANEL EFFECTIVE/REVISED DATE 2-8-99	B8. FLOOD ZONE(S) AE	B9. BASE FLOOD ELEVATION(S) (Zone AO, use depth of flooding) 1919.0

B10. Indicate the source of the Base Flood Elevation (BFE) data or base flood depth entered in B9.

☐ FIS Profile ☒ FIRM ☐ Community Determined ☐ Other (Describe):B11. Indicate the elevation datum used for the BFE in B9: ☒ NGVD 1929☐ NAVD 1988 ☐ Other (Describe):B12. Is the building located in a Coastal Barrier Resources System (CBRS) area or Otherwise Protected Area (OPA)? ☐ Yes ☒ No Designation Date: n/a

SECTION C - BUILDING ELEVATION INFORMATION (SURVEY REQUIRED)	
C1. Building elevations are based on: <input type="checkbox"/> Construction Drawings* <input type="checkbox"/> Building Under Construction* <input checked="" type="checkbox"/> Finished Construction	
*A new Elevation Certificate will be required when construction of the building is complete.	
C2. Building Diagram Number 6 (Select the building diagram most similar to the building for which this certificate is being completed - see pages 6 and 7. If no diagram accurately represents the building, provide a sketch or photograph.)	
C3. Elevations - Zones A1-A30, AE, AH, A (with BFE), VE, V1-V30, V (with BFE), AR, AR/A, AR/AE, AR/A1-A30, AR/AH, AR/AO	
Complete Items C3.-a-i below according to the building diagram specified in Item C2. State the datum used. If the datum is different from the datum used for the BFE in Section B, convert the datum to that used for the BFE. Show field measurements and datum conversion calculation. Use the space provided or the Comments area of Section D or Section G, as appropriate, to document the datum conversion.	
Datum <u>NGVD29</u> Conversion/Comments <u>n/a</u>	
Elevation reference mark used <u>Y293reset</u> Does the elevation reference mark used appear on the FIRM? <input type="checkbox"/> Yes <input checked="" type="checkbox"/> No	
<input type="checkbox"/> a) Top of bottom floor (including basement or enclosure)	<u>1922.58</u> ft.(m)
<input type="checkbox"/> b) Top of next higher floor	<u>n/a.</u> ft.(m)
<input type="checkbox"/> c) Bottom of lowest horizontal structural member (V zones only)	<u>n/a.</u> ft.(m)
<input type="checkbox"/> d) Attached garage (top of slab)	<u>n/a.</u> ft.(m)
<input type="checkbox"/> e) Lowest elevation of machinery and/or equipment servicing the building (Describe in a Comments area)	<u>1919.91</u> ft.(m)
<input type="checkbox"/> f) Lowest adjacent (finished) grade (LAG)	<u>1919.05</u> ft.(m)
<input type="checkbox"/> g) Highest adjacent (finished) grade (HAG)	<u>1919.51</u> ft.(m)
<input type="checkbox"/> h) No. of permanent openings (flood vents) within 1 ft. above adjacent grade <u>n/a</u>	
<input type="checkbox"/> i) Total area of all permanent openings (flood vents) in C3.h <u>n/a</u> sq. in. (sq. cm)	

License Number, Embossed Seal, Signature, and Date

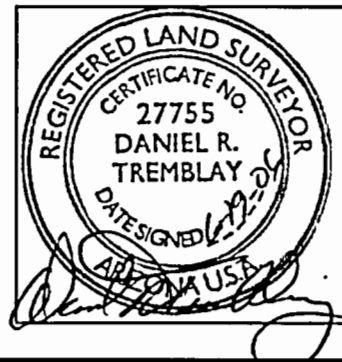

SECTION D - SURVEYOR, ENGINEER, OR ARCHITECT CERTIFICATION	
This certification is to be signed and sealed by a land surveyor, engineer, or architect authorized by law to certify elevation information.	
I certify that the information in Sections A, B, and C on this certificate represents my best efforts to interpret the data available.	
I understand that any false statement may be punishable by fine or imprisonment under 18 U.S. Code, Section 1001.	
CERTIFIER'S NAME Daniel R. Tremblay	LICENSE NUMBER RLS 27755

TITLE Vice President		COMPANY NAME Urban Engineering, Inc.	
ADDRESS 877 S. Alvernon	CITY Tucson	STATE AZ	ZIP CODE 85711
SIGNATURE <i>Daniel R. Tremblay</i>	DATE 6-19-06	TELEPHONE 520-318-3800	

01-74

IMPORTANT: In these spaces, copy the corresponding information from Section A.			For Insurance Company Use:
BUILDING STREET ADDRESS (Including Apt., Unit, Suite, and/or Bldg. No.) OR P.O. ROUTE AND BOX NO. 17465 W. Chinle			Policy Number
CITY Tucson	STATE AZ	ZIP CODE 85653	Company NAIC Number

SECTION D - SURVEYOR, ENGINEER, OR ARCHITECT CERTIFICATION (CONTINUED)

Copy both sides of this Elevation Certificate for (1) community official, (2) insurance agent/company, and (3) building owner.

COMMENTS

There is one AC pad on the south side of the building. Pad elevation = 1919.91.

There is skirting around base of mobile home without openings to measure under side.

☐ Check here if attachments**SECTION E - BUILDING ELEVATION INFORMATION (SURVEY NOT REQUIRED) FOR ZONE AO AND ZONE A (WITHOUT BFE)**

For Zone AO and Zone A (without BFE), complete Items E1 through E4. If the Elevation Certificate is intended for use as supporting information for a LOMA or LOMR-F, Section C must be completed.

E1. Building Diagram Number (Select the building diagram most similar to the building for which this certificate is being completed - see pages 6 and 7. If no diagram accurately represents the building, provide a sketch or photograph.)

E2. The top of the bottom floor (including basement or enclosure) of the building is ___ ft.(m) ___ in.(cm) ☐ above or ☐ below (check one) the highest adjacent grade. (Use natural grade, if available).

E3. For Building Diagrams 6-8 with openings (see page 7), the next higher floor or elevated floor (elevation b) of the building is ___ ft.(m) ___ in.(cm) above the highest adjacent grade. Complete items C3.h and C3.i on front of form.

E4. The top of the platform of machinery and/or equipment servicing the building is ___ ft.(m) ___ in.(cm) ☐ above or ☐ below (check one) the highest adjacent grade. (Use natural grade, if available).

E5. For Zone AO only: If no flood depth number is available, is the top of the bottom floor elevated in accordance with the community's floodplain management ordinance?

☐ Yes ☐ No ☐ Unknown. The local official must certify this information in Section G.**SECTION F - PROPERTY OWNER (OR OWNER'S REPRESENTATIVE) CERTIFICATION**The property owner or owner's authorized representative who completes Sections A, B, C (Items C3.h and C3.i only), and E for Zone A (without a FEMA-issued or community-issued BFE) or Zone AO must sign here. *The statements in Sections A, B, C, and E are correct to the best of my knowledge.*

PROPERTY OWNER'S OR OWNER'S AUTHORIZED REPRESENTATIVE'S NAME

ADDRESS

CITY

STATE

ZIP CODE

SIGNATURE

DATE

TELEPHONE

COMMENTS

☐ Check here if attachments**SECTION G - COMMUNITY INFORMATION (OPTIONAL)**

The local official who is authorized by law or ordinance to administer the community's floodplain management ordinance can complete Sections A, B, C (or E), and G of this Elevation Certificate. Complete the applicable item(s) and sign below.

G1. ☐ The information in Section C was taken from other documentation that has been signed and embossed by a licensed surveyor, engineer, or architect who is authorized by state or local law to certify elevation information. (Indicate the source and date of the elevation data in the Comments area below.)G2. ☐ A community official completed Section E for a building located in Zone A (without a FEMA-issued or community-issued BFE) or Zone AO.G3. ☐ The following information (Items G4-G9) is provided for community floodplain management purposes.

G4. PERMIT NUMBER	G5. DATE PERMIT ISSUED	G6. DATE CERTIFICATE OF COMPLIANCE/OCCUPANCY ISSUED
-------------------	------------------------	---

G7. This permit has been issued for: ☐ New Construction ☐ Substantial Improvement

G8. Elevation of as-built lowest floor (including basement) of the building is:

___ ft.(m)

Datum: ___

G9. BFE or (in Zone AO) depth of flooding at the building site is:

___ ft.(m)

Datum: ___

LOCAL OFFICIAL'S NAME <u>Brian Jones</u>	TITLE <u>Senior Hydrologist</u>
COMMUNITY NAME <u>Pima County</u>	TELEPHONE <u>(520) 243-1800</u>
SIGNATURE <u>[Signature]</u>	DATE <u>6-26-06</u>
COMMENTS <u>Per survey completed by Edgar B. Reynolds on 1-3-02, the lowest horizontal structural member is 1921.94 ft per NGVD 29 datum.</u>	

☐ Check here if attachments

FEDERAL EMERGENCY MANAGEMENT AGENCY
NATIONAL FLOOD INSURANCE PROGRAM

O.M.B. No. 3067-0077
Expires July 31, 2002

ELEVATION CERTIFICATE

Important: Read the instructions on pages 1-7.

SECTION A - PROPERTY OWNER INFORMATION			For Insurance Company Use:	
BUILDING OWNER'S NAME <u>Chillers</u>			Policy Number	
BUILDING STREET ADDRESS (Including Apt., Unit, Suite, and/or Bldg. No.) OR P.O. ROUTE AND BOX NO. <u>17465 W. Chino</u>			Company NAIC Number	
CITY Tucson	STATE <u>208-11-2670</u> AZ	ZIP CODE <u>85653</u>		
PROPERTY DESCRIPTION (Lot and Block Numbers, Tax Parcel Number, Legal Description, etc.) <u>Lot 268 Blanco Ests.</u>				
BUILDING USE (e.g., Residential, Non-residential, Addition, Accessory, etc. Use a Comments area, if necessary.) <u>Res.</u>				
LATITUDE/LONGITUDE (OPTIONAL) (##-##-### or ###.####)		HORIZONTAL DATUM: <input checked="" type="checkbox"/> NAD 1927 <input type="checkbox"/> NAD 1983		
		SOURCE: <input type="checkbox"/> GPS (Type): <input type="checkbox"/> USGS Quad Map <input type="checkbox"/> Other:		

SECTION B - FLOOD INSURANCE RATE MAP (FIRM) INFORMATION

B1. NFIP COMMUNITY NAME & COMMUNITY NUMBER Pima County 040073		B2. COUNTY NAME Pima County		B3. STATE Arizona	
B4. MAP AND PANEL NUMBER 04019C-955	B5. SUFFIX K	B6. FIRM INDEX DATE 2/8/99	B7. FIRM PANEL EFFECTIVE/REVISED DATE 2/8/99	B8. FLOOD ZONE(S) AE	B9. BASE FLOOD ELEVATION(S) (Zone AO, use depth of flooding) 1919.0

B10. Indicate the source of the Base Flood Elevation (BFE) data or base flood depth entered in B9.

☒ FIS Profile ☐ FIRM ☐ Community Determined ☐ Other (Describe):

B11. Indicate the elevation datum used for the BFE in B9: ☒ NGVD 1929 ☐ NAVD 1988 ☐ Other (Describe):

B12. Is the building located in a Coastal Barrier Resources System (CBRS) area or Otherwise Protected Area (OPA)? ☐ Yes ☒ No Designation Date

SECTION C - BUILDING ELEVATION INFORMATION (SURVEY REQUIRED)

C1. Building elevations are based on: ☐ Construction Drawings* ☐ Building Under Construction* ☒ Finished Construction

*A new Elevation Certificate will be required when construction of the building is complete.

C2. Building Diagram Number 5 (Select the building diagram most similar to the building for which this certificate is being completed - see pages 6 and 7. If no diagram accurately represents the building, provide a sketch or photograph.)

C3. Elevations - Zones A1-A30, AE, AH, A (with BFE), VE, V1-V30, V (with BFE), AR, AR/A, AR/AE, AR/A1-A30, AR/AH, AR/AO

Complete Items C3.-a-i below according to the building diagram specified in Item C2. State the datum used. If the datum is different from the datum used for the BFE in Section B, convert the datum to that used for the BFE. Show field measurements and datum conversion calculation. Use the space provided or the Comments area of Section D or Section G, as appropriate, to document the datum conversion.

Datum 1921 Conversion/Comments

Elevation reference mark used RM 217 Does the elevation reference mark used appear on the FIRM? ☒ Yes ☐ No

- ☐ a) Top of bottom floor (including basement or enclosure) NA ft.(m)
- ☐ b) Top of next higher floor NA ft.(m)
- ☐ c) Bottom of lowest horizontal structural member (V-zones only) 1921-94 ft.(m)
- ☐ d) Attached garage (top of slab) NA ft.(m)
- ☐ e) Lowest elevation of machinery and/or equipment servicing the building (Describe in a Comments area) NA ft.(m)
- ☐ f) Lowest adjacent (finished) grade (LAG) NA ft.(m)
- ☐ g) Highest adjacent (finished) grade (HAG) NA ft.(m)
- ☐ h) No. of permanent openings (flood vents) within 1 ft. above adjacent grade NA
- ☐ i) Total area of all permanent openings (flood vents) in C3.h NA sq. in. (sq. cm)

License Number, Embossed Seal, Signature, and Date

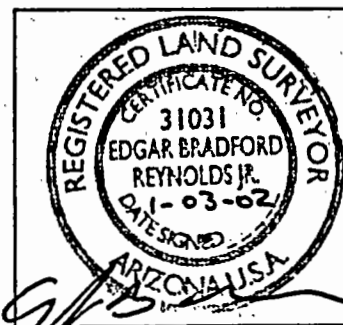

SECTION D - SURVEYOR, ENGINEER, OR ARCHITECT CERTIFICATION

This certification is to be signed and sealed by a land surveyor, engineer, or architect authorized by law to certify elevation information.

I certify that the information in Sections A, B, and C on this certificate represents my best efforts to interpret the data available.

I understand that any false statement may be punishable by fine or imprisonment under 18 U.S. Code, Section 1001.

CERTIFIER'S NAME <u>Edgar B. Reynolds</u>		LICENSE NUMBER <u>AZ 31031 RLS</u>	
TITLE <u>OWNER</u>	COMPANY NAME <u>Reynolds Land Surveyor</u>		
ADDRESS <u>1926 W. Chino Mesa</u>	CITY <u>Tucson</u>	STATE <u>AZ</u>	ZIP CODE <u>85745</u>
SIGNATURE <u>[Signature]</u>	DATE <u>1-03-02</u>	TELEPHONE <u>520-884-0292</u>	

IMPORTANT: In these spaces, copy the corresponding information from Section A.

For Insurance Company Use:

BUILDING STREET ADDRESS (including Apt., Unit, Suite, and/or Bldg. No.) OR P.O. ROUTE AND BOX NO.

Policy Number

CITY

STATE

ZIP CODE

Company NAIC Number

SECTION D - SURVEYOR, ENGINEER, OR ARCHITECT CERTIFICATION (CONTINUED)

Copy both sides of this Elevation Certificate for (1) community official, (2) insurance agent/company, and (3) building owner.

COMMENTS

☐ Check here if attachments**SECTION E - BUILDING ELEVATION INFORMATION (SURVEY NOT REQUIRED) FOR ZONE AO AND ZONE A (WITHOUT BFE)**

For Zone AO and Zone A (without BFE), complete Items E1 through E4. If the Elevation Certificate is intended for use as supporting information for a LOMA or LOMR-F, Section C must be completed.

E1. Building Diagram Number (Select the building diagram most similar to the building for which this certificate is being completed - see pages 6 and 7. If no diagram accurately represents the building, provide a sketch or photograph.)

E2. The top of the bottom floor (including basement or enclosure) of the building is ___ ft.(m) ___ in.(cm) ☐ above or ☐ below (check one) the highest adjacent grade. (Use natural grade, if available).

E3. For Building Diagrams 6-8 with openings (see page 7), the next higher floor or elevated floor (elevation b) of the building is ___ ft.(m) ___ in.(cm) above the highest adjacent grade. Complete items C3.h and C3.i on front of form.

E4. For Zone AO only: If no flood depth number is available, is the top of the bottom floor elevated in accordance with the community's floodplain management ordinance?

☐ Yes ☐ No ☐ Unknown. The local official must certify this information in Section G.**SECTION F - PROPERTY OWNER (OR OWNER'S REPRESENTATIVE) CERTIFICATION**

The property owner or owner's authorized representative who completes Sections A, B, C (Items C3.h and C3.i only), and E for Zone A (without a FEMA-issued or community-issued BFE) or Zone AO must sign here. The statements in Sections A, B, C, and E are correct to the best of my knowledge.

PROPERTY OWNER'S OR OWNER'S AUTHORIZED REPRESENTATIVE'S NAME

ADDRESS

CITY

STATE

ZIP CODE

SIGNATURE

DATE

TELEPHONE

COMMENTS

☐ Check here if attachments**SECTION G - COMMUNITY INFORMATION (OPTIONAL)**

The local official who is authorized by law or ordinance to administer the community's floodplain management ordinance can complete Sections A, B, C (or E), and G of this Elevation Certificate. Complete the applicable item(s) and sign below.

G1. ☐ The information in Section C was taken from other documentation that has been signed and embossed by a licensed surveyor, engineer, or architect who is authorized by state or local law to certify elevation information. (Indicate the source and date of the elevation data in the Comments area below.)G2. ☐ A community official completed Section E for a building located in Zone A (without a FEMA-issued or community-issued BFE) or Zone AO.G3. ☐ The following information (Items G4-G9) is provided for community floodplain management purposes.

G4. PERMIT NUMBER

G5. DATE PERMIT ISSUED

G6. DATE CERTIFICATE OF COMPLIANCE/OCCUPANCY ISSUED

01-711E

G7. This permit has been issued for: ☐ New Construction ☐ Substantial Improvement

G8. Elevation of as-built lowest floor (including basement) of the building is:

___ ft.(m)

Datum:

G9. BFE or (in Zone AO) depth of flooding at the building site is:

___ ft.(m)

Datum:

LOCAL OFFICIAL'S NAME

TITLE

COMMUNITY NAME

TELEPHONE

SIGNATURE

DATE

COMMENTS

☐ Check here if attachments