

FPUP # 03-102E
P03 CP 01260
Client's Initials _____

FEDERAL EMERGENCY MANAGEMENT AGENCY
NATIONAL FLOOD INSURANCE PROGRAM

O.M.B. No. 3067-0077
Expires December 31, 2005

ELEVATION CERTIFICATE

Important: Read the instructions on pages 1 - 7.

SECTION A - PROPERTY OWNER INFORMATION

For Insurance Company Use:

Policy Number

Company NAIC Number

BUILDING OWNER'S NAME

Lebsack, Ken

BUILDING STREET ADDRESS (Including Apt., Unit, Suite, and/or Bldg. No.) OR P.O. ROUTE AND BOX NO.

7235 S. Avalon Dr.

CITY

Tucson

STATE

AZ

ZIP CODE

85 735

PROPERTY DESCRIPTION (Lot and Block Numbers, Tax Parcel Number, Legal Description, etc.)

Tax Code 209-19-0320, T15S R11E Sec17

BUILDING USE (e.g., Residential, Non-residential, Addition, Accessory, etc. Use a Comments area, if necessary.)

Residential, Mobile Home

LATITUDE/LONGITUDE (OPTIONAL)

(##-##-##.## or ##.####)

HORIZONTAL DATUM:

☐ NAD 1927 ☐ NAD 1983

SOURCE: ☐ GPS (Type):

☐ USGS Quad Map

☐ Other: _____

SECTION B - FLOOD INSURANCE RATE MAP (FIRM) INFORMATION

B1. NFIP COMMUNITY NAME & COMMUNITY NUMBER

Pima County 040073

B2. COUNTY NAME

Pima County

B3. STATE

AZ

B4. MAP AND PANEL NUMBER

04019C 2800

B5. SUFFIX

K

B6. FIRM INDEX DATE

2/8/99

B7. FIRM PANEL EFFECTIVE/REVISED DATE

2-8-99

B8. FLOOD ZONE(S)

A

B9. BASE FLOOD ELEVATION(S)

(Zone AO, use depth of flooding)

1.0

B10. Indicate the source of the Base Flood Elevation (BFE) data or base flood depth entered in B9.

☐ FIS Profile

☐ FIRM

☒ Community Determined

☐ Other (Describe): _____

B11. Indicate the elevation datum used for the BFE in B9: ☐ NGVD 1929

☐ NAVD 1988

☒ Other (Describe): FFE

B12. Is the building located in a Coastal Barrier Resources System (CBRS) area or Otherwise Protected Area (OPA)? ☐ Yes ☒ No Designation Date: N/A

SECTION C - BUILDING ELEVATION INFORMATION (SURVEY REQUIRED)

C1. Building elevations are based on: ☐ Construction Drawings* ☐ Building Under Construction* ☒ Finished Construction

*A new Elevation Certificate will be required when construction of the building is complete.

C2. Building Diagram Number 6 (Select the building diagram most similar to the building for which this certificate is being completed - see pages 6 and 7. If no diagram accurately represents the building, provide a sketch or photograph.)

C3. Elevations - Zones A1-A30, AE, AH, A (with BFE), VE, V1-V30, V (with BFE), AR, AR/A, AR/AE, AR/A1-A30, AR/AH, AR/AO

Complete Items C3-a-i below according to the building diagram specified in Item C2. State the datum used. If the datum is different from the datum used for the BFE in Section B, convert the datum to that used for the BFE. Show field measurements and datum conversion calculation. Use the space provided or the Comments area of Section D or Section G, as appropriate, to document the datum conversion.

Datum LOCAL Conversion/Comments NA

Elevation reference mark used NA Does the elevation reference mark used appear on the FIRM? ☐ Yes ☒ No

a) Top of bottom floor (including basement or enclosure) 96.9 ft.(m)

b) Top of next higher floor 100.0 ft.(m)

c) Bottom of lowest horizontal structural member (V zones only) N/A ft.(m)

d) Attached garage (top of slab) N/A ft.(m)

e) Lowest elevation of machinery and/or equipment servicing the building (Describe in a Comments area) 100.0 ft.(m)

f) Lowest adjacent (finished) grade (LAG) 96.4 ft.(m)

g) Highest adjacent (finished) grade (HAG) 96.9 ft.(m)

h) No. of permanent openings (flood vents) within 1 ft. above adjacent grade see comments

i) Total area of all permanent openings (flood vents) in C3.h N/A sq. in. (sq. cm)

License Number, Embossed Seal,
Signature, and Date

SECTION D - SURVEYOR, ENGINEER, OR ARCHITECT CERTIFICATION

This certification is to be signed and sealed by a land surveyor, engineer, or architect authorized by law to certify elevation information.

I certify that the information in Sections A, B, and C on this certificate represents my best efforts to interpret the data available.

I understand that any false statement may be punishable by fine or imprisonment under 18 U.S. Code, Section 1001.

CERTIFIER'S NAME

LICENSE NUMBER

TITLE

COMPANY NAME

ADDRESS

CITY

STATE

ZIP CODE

SIGNATURE

DATE

TELEPHONE

FPUP # 03-102E IMPORTANT: In these spaces, copy the corresponding information from Section A.			For Insurance Company Use:
BUILDING STREET ADDRESS (including Apt., Unit, Suite, and/or Bldg. No.) OR P.O. ROUTE AND BOX NO. 7235 S. Avalon Dr.			Policy Number
CITY Tucson	STATE AZ	ZIP CODE 85 735	Company NAIC Number

SECTION D - SURVEYOR, ENGINEER, OR ARCHITECT CERTIFICATION (CONTINUED)

Copy both sides of this Elevation Certificate for (1) community official, (2) insurance agent/company, and (3) building owner.

COMMENTS

The lowest service equipment (C3e) is the _____. All other equipment is inside at/above the FFE or on roof.

☐ Check here if attachments

SECTION E - BUILDING ELEVATION INFORMATION (SURVEY NOT REQUIRED) FOR ZONE AO AND ZONE A (WITHOUT BFE)

For Zone AO and Zone A (without BFE), complete Items E1 through E4. If the Elevation Certificate is intended for use as supporting information for a LOMA or LOMR-F, Section C must be completed.

- E1. Building Diagram Number ____ (Select the building diagram most similar to the building for which this certificate is being completed - see pages 6 and 7. If no diagram accurately represents the building, provide a sketch or photograph.)
- E2. The top of the bottom floor (including basement or enclosure) of the building is ____ ft.(m) ____ or ☐ below (check one) the highest adjacent grade. (Use natural grade, if available).
- E3. For Building Diagrams 6-8 with openings (see page 7), the next higher floor or elevated floor (elevation b) of the building is ____ ft.(m) ____ in.(cm) above the highest adjacent grade. Complete items C3.h and C3.i on front of form.
- E4. The top of the platform of machinery and/or equipment servicing the building is ____ ft.(m) ____ in.(cm) ☐ above or ☐ below (check one) the highest adjacent grade. (Use natural grade, if available).
- E5. For Zone AO only: If no flood depth number is available, is the top of the bottom floor elevated in accordance with the community's floodplain management ordinance?
☐ Yes ☐ No ☐ Unknown. The local official must certify this information in Section G.

SECTION F - PROPERTY OWNER (OR OWNER'S REPRESENTATIVE) CERTIFICATION

The property owner or owner's authorized representative who completes Sections A, B, C (Items C3.h and C3.i only), and E for Zone A (without a FEMA-issued or community-issued BFE) or Zone AO must sign here. *The statements in Sections A, B, C, and E are correct to the best of my knowledge.*

PROPERTY OWNER'S OR OWNER'S AUTHORIZED REPRESENTATIVE'S NAME _____

ADDRESS _____

CITY _____

STATE _____

ZIP CODE _____

SIGNATURE _____

DATE _____

TELEPHONE _____

COMMENTS _____

☐ Check here if attachments

SECTION G - COMMUNITY INFORMATION (OPTIONAL)

The local official who is authorized by law or ordinance to administer the community's floodplain management ordinance can complete Sections A, B, C (or E), and G of this Elevation Certificate. Complete the applicable item(s) and sign below.

- G1. ☒ The information in Section C was taken from other documentation that has been signed and embossed by a licensed surveyor, engineer, or architect who is authorized by state or local law to certify elevation information. (Indicate the source and date of the elevation data in the Comments area below.)
- G2. ☐ A community official completed Section E for a building located in Zone A (without a FEMA-issued or community-issued BFE) or Zone AO.
- G3. ☐ The following information (Items G4-G9) is provided for community floodplain management purposes.

G4. PERMIT NUMBER 03-102E	G5. DATE PERMIT ISSUED	G6. DATE CERTIFICATE OF COMPLIANCE/OCCUPANCY ISSUED
-------------------------------------	------------------------	---

G7. This permit has been issued for: ☒ New Construction ☐ Substantial Improvement

G8. Elevation of as-built lowest floor (including basement) of the building is: _____ ft.(m)

Datum: _____

G9. BFE or (in Zone AO) depth of flooding at the building site is: _____ ft.(m)

Datum: _____

LOCAL OFFICIAL'S NAME **Eric Shepp**

TITLE **Floodplain Management Division Manager**

COMMUNITY NAME **Pima County**

TELEPHONE **520-740-6350**

SIGNATURE _____

DATE **6-23-06**

COMMENTS The information in Section C is from an Elevation Certificate completed by Todd A. Hout on 06-22-2004 except for C3a,

C3b, and C3e. Lowest elevation of structural member is 2.0 ft. above H.A.G. Lowest equipment in C3e is Water Heater. Break-away skirting surrounding residence. All other equipment is inside at/above the FFE or on roof.

☐ Check here if attachments

03-102E (K.L.)

P03CP01260

FEDERAL EMERGENCY MANAGEMENT AGENCY
NATIONAL FLOOD INSURANCE PROGRAMO.M.B. No. 3067-0077
Expires December 31, 2005

ELEVATION CERTIFICATE

Important: Read the instructions on pages 1-7.

P03CP01260

SECTION A - PROPERTY OWNER INFORMATION		For Insurance Company Use:
BUILDING OWNER'S NAME <u>Lebsock, Helen</u>		Policy Number
BUILDING STREET ADDRESS (Including Apt., Unit, Suite, and/or Bldg. No.) OR P.O. ROUTE AND BOX NO. <u>7235 S. Avalon Dr.</u>		Company NAIC Number
CITY <u>Tucson</u>	STATE <u>AZ</u>	ZIP CODE <u>85735</u>
PROPERTY DESCRIPTION (Lot and Block Numbers, Tax Parcel Number, Legal Description, etc.) <u>TAX CODE = 209-19-0320 T155 / R11E / Sec 17</u>		
BUILDING USE (e.g., Residential, Non-residential, Addition, Accessory, etc. Use a Comments area, if necessary.) <u>Residential Mobile Home</u>		
LATITUDE/LONGITUDE (OPTIONAL) (##° - ##' - ###" or #####)	HORIZONTAL DATUM: <input type="checkbox"/> NAD 1927 <input type="checkbox"/> NAD 1983	SOURCE: <input type="checkbox"/> GPS (Type): <input type="checkbox"/> USGS Quad Map <input type="checkbox"/> Other:

SECTION B - FLOOD INSURANCE RATE MAP (FIRM) INFORMATION

B1. NFIP COMMUNITY NAME & COMMUNITY NUMBER <u>Pima County 040073</u>		B2. COUNTY NAME <u>Pima</u>		B3. STATE <u>Arizona</u>	
B4. MAP AND PANEL NUMBER <u>04019C2800</u>	B5. SUFFIX <u>K</u>	B6. FIRM INDEX DATE <u>2-8-99</u>	B7. FIRM PANEL EFFECTIVE/REVISED DATE <u>2-8-1999</u>	B8. FLOOD ZONE(S) <u>A</u>	B9. BASE FLOOD ELEVATION(S) (Zone AO, use depth of flooding) <u>1.0</u>

B10. Indicate the source of the Base Flood Elevation (BFE) data or base flood depth entered in B9.
☐ FIS Profile ☒ FIRM ☐ Community Determined ☐ Other (Describe): H.A.G.

B11. Indicate the elevation datum used for the BFE in B9: ☐ NGVD 1929 ☐ NAVD 1988 ☒ Other (Describe): H.A.G.

B12. Is the building located in a Coastal Barrier Resources System (CBRS) area or Otherwise Protected Area (OPA)? ☐ Yes ☒ No Designation Date

SECTION C - BUILDING ELEVATION INFORMATION (SURVEY REQUIRED)

C1. Building elevations are based on: ☐ Construction Drawings* ☐ Building Under Construction* ☒ Finished Construction

*A new Elevation Certificate will be required when construction of the building is complete.

C2. Building Diagram Number 5 (Select the building diagram most similar to the building for which this certificate is being completed - see pages 6 and 7. If no diagram accurately represents the building, provide a sketch or photograph.)

C3. Elevations - Zones A1-A30, AE, AH, A (with BFE), VE, V1-V30, V (with BFE), AR, AR/A, AR/AE, AR/A1-A30, AR/AH, AR/AO

Complete Items C3.-a-i below according to the building diagram specified in Item C2. State the datum used. If the datum is different from the datum used for the BFE in Section B, convert the datum to that used for the BFE. Show field measurements and datum conversion calculation. Use the space provided or the Comments area of Section D or Section G, as appropriate, to document the datum conversion.

Datum FPE Conversion/Comments N/AElevation reference mark used FPE Does the elevation reference mark used appear on the FIRM? ☐ Yes ☒ No

- a) Top of bottom floor (including basement or enclosure) 100.00 ft.(m)
- b) Top of next higher floor N/A ft.(m)
- c) Bottom of lowest horizontal structural member (V zones only) 98.9 ft.(m)
- d) Attached garage (top of slab) N/A ft.(m)
- e) Lowest elevation of machinery and/or equipment servicing the building (Describe in a Comments area) N/A ft.(m)
- f) Lowest adjacent (finished) grade (LAG) 96.9 ft.(m) 96.1 ft.(m)
- g) Highest adjacent (finished) grade (HAG) 96.9 ft.(m)
- h) No. of permanent openings (flood vents) within 1 ft. above adjacent grade N/A
- i) Total area of all permanent openings (flood vents) in C3.h N/A sq. in. (sq. cm)

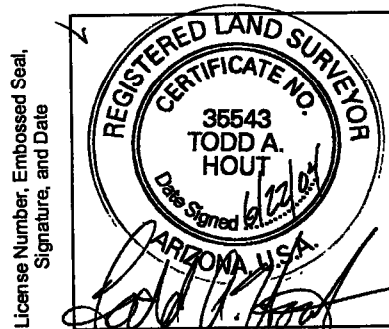

SECTION D - SURVEYOR, ENGINEER, OR ARCHITECT CERTIFICATION

This certification is to be signed and sealed by a land surveyor, engineer, or architect authorized by law to certify elevation information.

I certify that the information in Sections A, B, and C on this certificate represents my best efforts to interpret the data available.

I understand that any false statement may be punishable by fine or imprisonment under 18 U.S. Code, Section 1001.

CERTIFIER'S NAME <u>TODD A. HOUT</u>		LICENSE NUMBER <u>AZ # 35543 (LS)</u>	
TITLE <u>OWNER</u>	COMPANY NAME <u>POLARIS LAND SURVEYING, LLC</u>		
ADDRESS <u>2828 N. COUNTRY CLUB</u>	CITY <u>TUCSON</u>	STATE <u>AZ</u>	ZIP CODE <u>85716</u>
SIGNATURE <u>Todd A. Hout</u>	DATE <u>6/22/04</u>	TELEPHONE <u>(520) 922-6400</u>	

10

IMPORTANT: In these spaces, copy the corresponding information from Section A.		For Insurance Company Use:
BUILDING STREET ADDRESS (Including Apt., Unit, Suite, and/or Bldg. No.) OR P.O. ROUTE AND BOX NO. 7235 S. Avalon Dr.		Policy Number
CITY Tucson	STATE AZ	ZIP CODE 85735
		Company NAIC Number

SECTION D - SURVEYOR, ENGINEER, OR ARCHITECT CERTIFICATION (CONTINUED)

Copy both sides of this Elevation Certificate for (1) community official, (2) insurance agent/company, and (3) building owner.

COMMENTS

MEASUREMENT MADE USING FLOOR OF MOBILE HOME AS 10000. NO EQUIPMENT ATTACHED TO UNIT. MEASURED 6/21/04 JAH

☐ Check here if attachments

SECTION E - BUILDING ELEVATION INFORMATION (SURVEY NOT REQUIRED) FOR ZONE AO AND ZONE A (WITHOUT BFE)

For Zone AO and Zone A (without BFE), complete Items E1 through E4. If the Elevation Certificate is intended for use as supporting information for a LOMA or LOMR-F, Section C must be completed.

- E1. Building Diagram Number (Select the building diagram most similar to the building for which this certificate is being completed – see pages 6 and 7. If no diagram accurately represents the building, provide a sketch or photograph.)
- E2. The top of the bottom floor (including basement or enclosure) of the building is ___ ft.(m) ___ in.(cm) ☐ above or ☐ below (check one) the highest adjacent grade. (Use natural grade, if available).
- E3. For Building Diagrams 6-8 with openings (see page 7), the next higher floor or elevated floor (elevation b) of the building is ___ ft.(m) ___ in.(cm) above the highest adjacent grade. Complete items C3.h and C3.i on front of form.
- E4. The top of the platform of machinery and/or equipment servicing the building is ___ ft.(m) ___ in.(cm) ☐ above or ☐ below (check one) the highest adjacent grade. (Use natural grade, if available).
- E5. For Zone AO only: If no flood depth number is available, is the top of the bottom floor elevated in accordance with the community's floodplain management ordinance?
☐ Yes ☐ No ☐ Unknown. The local official must certify this information in Section G.

SECTION F - PROPERTY OWNER (OR OWNER'S REPRESENTATIVE) CERTIFICATION

The property owner or owner's authorized representative who completes Sections A, B, C (Items C3.h and C3.i only), and E for Zone A (without a FEMA-issued or community-issued BFE) or Zone AO must sign here. The statements in Sections A, B, C, and E are correct to the best of my knowledge.

PROPERTY OWNER'S OR OWNER'S AUTHORIZED REPRESENTATIVE'S NAME

ADDRESS	CITY	STATE	ZIP CODE
SIGNATURE	DATE	TELEPHONE	
COMMENTS			

☐ Check here if attachments

SECTION G - COMMUNITY INFORMATION (OPTIONAL)

The local official who is authorized by law or ordinance to administer the community's floodplain management ordinance can complete Sections A, B, C (or E), and G of this Elevation Certificate. Complete the applicable item(s) and sign below.

- G1. ☐ The information in Section C was taken from other documentation that has been signed and embossed by a licensed surveyor, engineer, or architect who is authorized by state or local law to certify elevation information. (Indicate the source and date of the elevation data in the Comments area below.)
- G2. ☐ A community official completed Section E for a building located in Zone A (without a FEMA-issued or community-issued BFE) or Zone AO.
- G3. ☐ The following information (Items G4-G9) is provided for community floodplain management purposes.

G4. PERMIT NUMBER 03-102E	G5. DATE PERMIT ISSUED 03 4.10.03	G6. DATE CERTIFICATE OF COMPLIANCE/OCCUPANCY ISSUED
------------------------------	--------------------------------------	---

G7. This permit has been issued for: ☐ New Construction ☐ Substantial Improvement

G8. Elevation of as-built lowest floor (including basement) of the building is:

___ ft.(m) Datum: ___

G9. BFE or (in Zone AO) depth of flooding at the building site is:

___ ft.(m) Datum: ___

LOCAL OFFICIAL'S NAME	TITLE
COMMUNITY NAME	TELEPHONE
SIGNATURE	DATE
COMMENTS	

☐ Check here if attachments