

FEDERAL EMERGENCY MANAGEMENT AGENCY  
NATIONAL FLOOD INSURANCE PROGRAM

O.M.B. No. 3067-0077  
Expires December 31, 2005

# ELEVATION CERTIFICATE

Important: Read the instructions on pages 1 - 7.

File

## SECTION A - PROPERTY OWNER INFORMATION

BUILDING OWNER'S NAME Maakestad, Christopher and Susan	For Insurance Company Use: Policy Number
BUILDING STREET ADDRESS (Including Apt., Unit, Suite, and/or Bldg. No.) OR P.O. ROUTE AND BOX NO. 1991 West Corona Road	Company NAIC Number

CITY Tucson	STATE AZ	ZIP CODE 85746
----------------	-------------	-------------------

PROPERTY DESCRIPTION (Lot and Block Numbers, Tax Parcel Number, Legal Description, etc.)  
138-24-007H Section 15 T15S R13E

BUILDING USE (e.g., Residential, Non-residential, Addition, Accessory, etc. Use a Comments area, if necessary.)  
Single Family Residence

LATITUDE/LONGITUDE (OPTIONAL)  
(##° - ##' - ###" or ##.####")

HORIZONTAL DATUM:  
☒ NAD 1927 ☐ NAD 1983

SOURCE: ☐ GPS (Type): \_\_\_\_\_  
☐ USGS Quad Map ☐ Other: DOT

## SECTION B - FLOOD INSURANCE RATE MAP (FIRM) INFORMATION

B1. NFIP COMMUNITY NAME & COMMUNITY NUMBER Pima County 040073		B2. COUNTY NAME Pima		B3. STATE AZ	
B4. MAP AND PANEL NUMBER 2810	B5. SUFFIX K	B6. FIRM INDEX DATE 2-8-99	B7. FIRM PANEL EFFECTIVE/REVISED DATE	B8. FLOOD ZONE(S) AE	B9. BASE FLOOD ELEVATION(S) (Zone AO, use depth of flooding) 2485.4

B10. Indicate the source of the Base Flood Elevation (BFE) data or base flood depth entered in B9.  
☐ FIS Profile ☒ FIRM ☐ Community Determined ☐ Other (Describe): \_\_\_\_\_

B11. Indicate the elevation datum used for the BFE in B9: ☒ NGVD 1929 ☐ NAVD 1988 ☐ Other (Describe): \_\_\_\_\_

B12. Is the building located in a Coastal Barrier Resources System (CBRS) area or Otherwise Protected Area (OPA)? ☐ Yes ☒ No Designation Date \_\_\_\_\_

## SECTION C - BUILDING ELEVATION INFORMATION (SURVEY REQUIRED)

C1. Building elevations are based on: ☐ Construction Drawings\* ☒ Building Under Construction\* ☐ Finished Construction  
\*A new Elevation Certificate will be required when construction of the building is complete.

C2. Building Diagram Number 1 (Select the building diagram most similar to the building for which this certificate is being completed - see pages 6 and 7. If no diagram accurately represents the building, provide a sketch or photograph.)

C3. Elevations - Zones A1-A30, AE, AH, A (with BFE), VE, V1-V30, V (with BFE), AR, AR/A, AR/AE, AR/A1-A30, AR/AH, AR/AO  
Complete Items C3.-a-i below according to the building diagram specified in Item C2. State the datum used. If the datum is different from the datum used for the BFE in Section B, convert the datum to that used for the BFE. Show field measurements and datum conversion calculation. Use the space provided or the Comments area of Section D or Section G, as appropriate, to document the datum conversion.  
Datum NGVD 1929 Conversion/Comments N/A

Elevation reference mark used N15 Does the elevation reference mark used appear on the FIRM? ☐ Yes ☒ No

☐ a) Top of bottom floor (including basement or enclosure) 2486.52 ft.(m)  
☐ b) Top of next higher floor N/A ft.(m)  
☐ c) Bottom of lowest horizontal structural member (V zones only) N/A ft.(m)  
☐ d) Attached garage (top of slab) N/A ft.(m)  
☐ e) Lowest elevation of machinery and/or equipment servicing the building (Describe in a Comments area) N/A ft.(m)  
☐ f) Lowest adjacent (finished) grade (LAG) 2483.92 ft.(m)  
☐ g) Highest adjacent (finished) grade (HAG) 2484.24 ft.(m)  
☐ h) No. of permanent openings (flood vents) within 1 ft. above adjacent grade N/A  
☐ i) Total area of all permanent openings (flood vents) in C3.h N/A sq. in. (sq. cm)

License Number, Embossed Seal, Signature, and Date

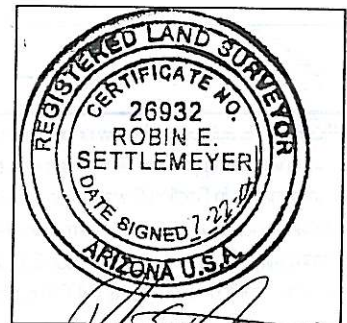

## SECTION D - SURVEYOR, ENGINEER, OR ARCHITECT CERTIFICATION

This certification is to be signed and sealed by a land surveyor, engineer, or architect authorized by law to certify elevation information.  
I certify that the information in Sections A, B, and C on this certificate represents my best efforts to interpret the data available.  
I understand that any false statement may be punishable by fine or imprisonment under 18 U.S. Code, Section 1001.

CERTIFIER'S NAME Robin E. Settlemyer LICENSE NUMBER RLS 26932

TITLE President	COMPANY NAME Settlemyer Surveys, Inc.		
ADDRESS P.O. Box 12612	CITY Tucson	STATE AZ	ZIP CODE 85732
SIGNATURE 	DATE 7/22/04	TELEPHONE 520-512-0666	



**IMPORTANT:** In these spaces, copy the corresponding information from Section A.

BUILDING STREET ADDRESS (including Apt., Unit, Suite, and/or Bldg. No.) OR P.O. ROUTE AND BOX NO.

1991 West Corona Road

CITY  
Tucson

STATE  
AZ

ZIP CODE  
85746

For Insurance Company Use

Policy Number

Company NAIC Number

**SECTION D - SURVEYOR, ENGINEER, OR ARCHITECT CERTIFICATION (CONTINUED)**

Copy both sides of this Elevation Certificate for (1) community official, (2) insurance agent/company, and (3) building owner.

**COMMENTS**

The elevation given in C3, section a) was taken at the top of constructed stemwall as required by Pima County Floodplain Dept.

☐ Check here if attachments

**SECTION E - BUILDING ELEVATION INFORMATION (SURVEY NOT REQUIRED) FOR ZONE AO AND ZONE A (WITHOUT BFE)**

For Zone AO and Zone A (without BFE), complete Items E1 through E4. If the Elevation Certificate is intended for use as supporting information for a LOMA or LOMR-F, Section C must be completed.

E1. Building Diagram Number (Select the building diagram most similar to the building for which this certificate is being completed - see pages 6 and 7. If no diagram accurately represents the building, provide a sketch or photograph.)

E2. The top of the bottom floor (including basement or enclosure) of the building is \_\_\_ ft.(m) \_\_\_ in.(cm) ☐ above or ☐ below (check one) the highest adjacent grade. (Use natural grade, if available).

E3. For Building Diagrams 6-8 with openings (see page 7), the next higher floor or elevated floor (elevation b) of the building is \_\_\_ ft.(m) \_\_\_ in.(cm) above the highest adjacent grade. Complete items C3.h and C3.i on front of form.

E4. The top of the platform of machinery and/or equipment servicing the building is \_\_\_ ft.(m) \_\_\_ in.(cm) ☐ above or ☐ below (check one) the highest adjacent grade. (Use natural grade, if available).

E5. For Zone AO only: If no flood depth number is available, is the top of the bottom floor elevated in accordance with the community's floodplain management ordinance?  
☐ Yes ☐ No ☐ Unknown. The local official must certify this information in Section G.

**SECTION F - PROPERTY OWNER (OR OWNER'S REPRESENTATIVE) CERTIFICATION**

The property owner or owner's authorized representative who completes Sections A, B, C (Items C3.h and C3.i only), and E for Zone A (without a FEMA-issued or community-issued BFE) or Zone AO must sign here. The statements in Sections A, B, C, and E are correct to the best of my knowledge.

PROPERTY OWNER'S OR OWNER'S AUTHORIZED REPRESENTATIVE'S NAME

ADDRESS

CITY

STATE

ZIP CODE

SIGNATURE

DATE

TELEPHONE

COMMENTS

☐ Check here if attachments

**SECTION G - COMMUNITY INFORMATION (OPTIONAL)**

The local official who is authorized by law or ordinance to administer the community's floodplain management ordinance can complete Sections A, B, C (or E), and G of this Elevation Certificate. Complete the applicable item(s) and sign below.

G1. ☐ The information in Section C was taken from other documentation that has been signed and embossed by a licensed surveyor, engineer, or architect who is authorized by state or local law to certify elevation information. (Indicate the source and date of the elevation data in the Comments area below.)

G2. ☐ A community official completed Section E for a building located in Zone A (without a FEMA-issued or community-issued BFE) or Zone AO.

G3. ☐ The following information (Items G4-G9) is provided for community floodplain management purposes.

G4. PERMIT NUMBER

03-625E P03CP 08815

G5. DATE PERMIT ISSUED

9-5-03

G6. DATE CERTIFICATE OF COMPLIANCE/OCCUPANCY ISSUED

G7. This permit has been issued for: ☒ New Construction ☐ Substantial Improvement

G8. Elevation of as-built lowest floor (including basement) of the building is:

\_\_\_ ft.(m)

Datum: \_\_\_

G9. BFE or (in Zone AO) depth of flooding at the building site is:

\_\_\_ ft.(m)

Datum: \_\_\_

LOCAL OFFICIAL'S NAME

TITLE

COMMUNITY NAME

TELEPHONE

SIGNATURE

DATE

COMMENTS

☐ Check here if attachments



**IMPORTANT:** In these spaces, copy the corresponding information from Section A.

BUILDING STREET ADDRESS (Including Apt., Unit, Suite, and/or Bldg. No.) OR P.O. ROUTE AND BOX NO.

1991 West Corona Road

CITY

Tucson

STATE

AZ

ZIP CODE

85746

For Insurance Company Use:

Policy Number

Company NAIC Number

**SECTION D - SURVEYOR, ENGINEER, OR ARCHITECT CERTIFICATION (CONTINUED)**

Copy both sides of this Elevation Certificate for (1) community official, (2) insurance agent/company, and (3) building owner.

**COMMENTS**

The elevation given in C3, section a) was taken at the top of constructed stemwall as required by Pima County Floodplain Dept.

**SECTION E - BUILDING ELEVATION INFORMATION (SURVEY NOT REQUIRED) FOR ZONE AO AND ZONE A (WITHOUT BFE)**

☐ Check here if attachments

For Zone AO and Zone A (without BFE), complete Items E1 through E4. If the Elevation Certificate is intended for use as supporting information for a LOMA or LOMR-F, Section C must be completed.

E1. Building Diagram Number (Select the building diagram most similar to the building for which this certificate is being completed - see pages 6 and 7. If no diagram accurately represents the building, provide a sketch or photograph.)

E2. The top of the bottom floor (including basement or enclosure) of the building is \_\_\_\_ ft.(m) \_\_\_\_ in.(cm) ☐ above or ☐ below (check one) the highest adjacent grade. (Use natural grade, if available).

E3. For Building Diagrams 6-8 with openings (see page 7), the next higher floor or elevated floor (elevation b) of the building is \_\_\_\_ ft.(m) \_\_\_\_ in.(cm) above the highest adjacent grade. Complete items C3.h and C3.i on front of form.

E4. The top of the platform of machinery and/or equipment servicing the building is \_\_\_\_ ft.(m) \_\_\_\_ in.(cm) ☐ above or ☐ below (check one) the highest adjacent grade. (Use natural grade, if available).

E5. For Zone AO only: If no flood depth number is available, is the top of the bottom floor elevated in accordance with the community's floodplain management ordinance?  
☐ Yes ☐ No ☐ Unknown. The local official must certify this information in Section G.

**SECTION F - PROPERTY OWNER (OR OWNER'S REPRESENTATIVE) CERTIFICATION**

The property owner or owner's authorized representative who completes Sections A, B, C (Items C3.h and C3.i only), and E for Zone A (without a FEMA-issued or community-issued BFE) or Zone AO must sign here. The statements in Sections A, B, C, and E are correct to the best of my knowledge.

PROPERTY OWNER'S OR OWNER'S AUTHORIZED REPRESENTATIVE'S NAME

ADDRESS

CITY

STATE

ZIP CODE

SIGNATURE

DATE

TELEPHONE

COMMENTS

**SECTION G - COMMUNITY INFORMATION (OPTIONAL)**

☐ Check here if attachments

The local official who is authorized by law or ordinance to administer the community's floodplain management ordinance can complete Sections A, B, C (or E), and G of this Elevation Certificate. Complete the applicable item(s) and sign below.

G1. ☐ The information in Section C was taken from other documentation that has been signed and embossed by a licensed surveyor, engineer, or architect who is authorized by state or local law to certify elevation information. (Indicate the source and date of the elevation data in the Comments area below.)

G2. ☐ A community official completed Section E for a building located in Zone A (without a FEMA-issued or community-issued BFE) or Zone AO.

G3. ☐ The following information (Items G4-G9) is provided for community floodplain management purposes.

G4. PERMIT NUMBER

03-625E \_ P03CP 08815

G5. DATE PERMIT ISSUED

9-5-03

G6. DATE CERTIFICATE OF COMPLIANCE/OCCUPANCY ISSUED

G7. This permit has been issued for: ☒ New Construction ☐ Substantial Improvement

G8. Elevation of as-built lowest floor (including basement) of the building is:

\_\_\_\_ ft.(m)

Datum: \_\_\_\_

G9. BFE or (in Zone AO) depth of flooding at the building site is:

\_\_\_\_ ft.(m)

Datum: \_\_\_\_

LOCAL OFFICIAL'S NAME

TITLE

COMMUNITY NAME

TELEPHONE

SIGNATURE

DATE

COMMENTS

☐ Check here if attachments



FEDERAL EMERGENCY MANAGEMENT AGENCY  
NATIONAL FLOOD INSURANCE PROGRAM

O.M.B. No. 3067-0077  
Expires December 31, 2005

ELEVATION CERTIFICATE

Important: Read the instructions on pages 1 - 7.

SECTION A - PROPERTY OWNER INFORMATION

BUILDING OWNER'S NAME Maakestad, Christopher and Susan	For Insurance Company Use: Policy Number
BUILDING STREET ADDRESS (Including Apt., Unit, Suite, and/or Bldg. No.) OR P.O. ROUTE AND BOX NO. 1991 West Corona Road	Company NAIC Number

CITY Tucson	STATE AZ	ZIP CODE 85746
----------------	-------------	-------------------

PROPERTY DESCRIPTION (Lot and Block Numbers, Tax Parcel Number, Legal Description, etc.)  
138-24-007H Section 15 T15S R13E

BUILDING USE (e.g., Residential, Non-residential, Addition, Accessory, etc. Use a Comments area, if necessary.)  
Detached Non-Residential Shed

LATITUDE/LONGITUDE (OPTIONAL) ( ##° - ##' - ###.###" or ###.####")	HORIZONTAL DATUM: <input checked="" type="checkbox"/> NAD 1927 <input type="checkbox"/> NAD 1983	SOURCE: <input type="checkbox"/> GPS (Type): <input type="checkbox"/> USGS Quad Map <input type="checkbox"/> Other: DOT
---	---	--

SECTION B - FLOOD INSURANCE RATE MAP (FIRM) INFORMATION

B1. NFIP COMMUNITY NAME & COMMUNITY NUMBER Pima County 040073	B2. COUNTY NAME Pima	B3. STATE AZ
--	-------------------------	-----------------

B4. MAP AND PANEL NUMBER 2810	B5. SUFFIX K	B6. FIRM INDEX DATE 2-8-99	B7. FIRM PANEL EFFECTIVE/REVISED DATE	B8. FLOOD ZONE(S) AE	B9. BASE FLOOD ELEVATION(S) (Zone AO, use depth of flooding) 2485.4
----------------------------------	-----------------	-------------------------------	---------------------------------------	-------------------------	---

B10. Indicate the source of the Base Flood Elevation (BFE) data or base flood depth entered in B9.  
☐ FIS Profile ☒ FIRM ☐ Community Determined ☐ Other (Describe):

B11. Indicate the elevation datum used for the BFE in B9: ☒ NGVD 1929 ☐ NAVD 1988 ☐ Other (Describe):

B12. Is the building located in a Coastal Barrier Resources System (CBRS) area or Otherwise Protected Area (OPA)? ☐ Yes ☒ No Designation Date

SECTION C - BUILDING ELEVATION INFORMATION (SURVEY REQUIRED)

C1. Building elevations are based on: ☐ Construction Drawings\* ☒ Building Under Construction\* ☐ Finished Construction  
\*A new Elevation Certificate will be required when construction of the building is complete.

C2. Building Diagram Number 1 (Select the building diagram most similar to the building for which this certificate is being completed - see pages 6 and 7. If no diagram accurately represents the building, provide a sketch or photograph.)

C3. Elevations - Zones A1-A30, AE, AH, A (with BFE), VE, V1-V30, V (with BFE), AR, AR/A, AR/AE, AR/A1-A30, AR/AH, AR/AO  
Complete Items C3.-a-i below according to the building diagram specified in Item C2. State the datum used. If the datum is different from the datum used for the BFE in Section B, convert the datum to that used for the BFE. Show field measurements and datum conversion calculation. Use the space provided or the Comments area of Section D or Section G, as appropriate, to document the datum conversion.  
Datum NGVD 1929 Conversion/Comments N/A

Elevation reference mark used N15 Does the elevation reference mark used appear on the FIRM? ☐ Yes ☒ No

<input type="checkbox"/> a) Top of bottom floor (including basement or enclosure)	2486. 65 ft.(m)
<input type="checkbox"/> b) Top of next higher floor	N/A. ft.(m)
<input type="checkbox"/> c) Bottom of lowest horizontal structural member (V zones only)	N/A. ft.(m)
<input type="checkbox"/> d) Attached garage (top of slab)	N/A. ft.(m)
<input type="checkbox"/> e) Lowest elevation of machinery and/or equipment servicing the building (Describe in a Comments area)	N/A. ft.(m)
<input type="checkbox"/> f) Lowest adjacent (finished) grade (LAG)	2484. 84 ft.(m)
<input type="checkbox"/> g) Highest adjacent (finished) grade (HAG)	2484. 90 ft.(m)
<input type="checkbox"/> h) No. of permanent openings (flood vents) within 1 ft. above adjacent grade N/A	
<input type="checkbox"/> i) Total area of all permanent openings (flood vents) in C3.h N/A sq. in. (sq. cm)	

License Number, Embossed Seal, Signature, and Date



SECTION D - SURVEYOR, ENGINEER, OR ARCHITECT CERTIFICATION

This certification is to be signed and sealed by a land surveyor, engineer, or architect authorized by law to certify elevation information.  
I certify that the information in Sections A, B, and C on this certificate represents my best efforts to interpret the data available.  
I understand that any false statement may be punishable by fine or imprisonment under 18 U.S. Code, Section 1001.

CERTIFIER'S NAME Robin E. Settlemyer LICENSE NUMBER RLS 26932

TITLE President	COMPANY NAME Settlemyer Surveys, Inc.
-----------------	---------------------------------------

ADDRESS P.O. Box 12612	CITY Tucson	STATE AZ	ZIP CODE 85732
SIGNATURE 	DATE 7/22/04	TELEPHONE 520-512-0666	



<b>IMPORTANT:</b> In these spaces, copy the corresponding information from Section A.			For Insurance Company Use:
BUILDING STREET ADDRESS (including Apt, Unit, Suite, and/or Bldg. No.) OR P.O. ROUTE AND BOX NO. 1991 West Corona Road			Policy Number
CITY Tucson	STATE AZ	ZIP CODE 85746	Company NAIC Number

### SECTION D - SURVEYOR, ENGINEER, OR ARCHITECT CERTIFICATION (CONTINUED)

Copy both sides of this Elevation Certificate for (1) community official, (2) insurance agent/company, and (3) building owner.

#### COMMENTS

The elevation given in C3, section a) was taken at the finish floor elevation of a concrete slab.

☐ Check here if attachments

### SECTION E - BUILDING ELEVATION INFORMATION (SURVEY NOT REQUIRED) FOR ZONE AO AND ZONE A (WITHOUT BFE)

For Zone AO and Zone A (without BFE), complete Items E1 through E4. If the Elevation Certificate is intended for use as supporting information for a LOMA or LOMR-F, Section C must be completed.

- E1. Building Diagram Number \_\_ (Select the building diagram most similar to the building for which this certificate is being completed - see pages 6 and 7. If no diagram accurately represents the building, provide a sketch or photograph.)
- E2. The top of the bottom floor (including basement or enclosure) of the building is \_\_ ft.(m) \_\_ in.(cm) ☐ above or ☐ below (check one) the highest adjacent grade. (Use natural grade, if available).
- E3. For Building Diagrams 6-8 with openings (see page 7), the next higher floor or elevated floor (elevation b) of the building is \_\_ ft.(m) \_\_ in.(cm) above the highest adjacent grade. Complete items C3.h and C3.i on front of form.
- E4. The top of the platform of machinery and/or equipment servicing the building is \_\_ ft.(m) \_\_ in.(cm) ☐ above or ☐ below (check one) the highest adjacent grade. (Use natural grade, if available).
- E5. For Zone AO only: If no flood depth number is available, is the top of the bottom floor elevated in accordance with the community's floodplain management ordinance?  
☐ Yes ☐ No ☐ Unknown. The local official must certify this information in Section G.

### SECTION F - PROPERTY OWNER (OR OWNER'S REPRESENTATIVE) CERTIFICATION

The property owner or owner's authorized representative who completes Sections A, B, C (Items C3.h and C3.i only), and E for Zone A (without a FEMA-issued or community-issued BFE) or Zone AO must sign here. *The statements in Sections A, B, C, and E are correct to the best of my knowledge.*

PROPERTY OWNER'S OR OWNER'S AUTHORIZED REPRESENTATIVE'S NAME

ADDRESS	CITY	STATE	ZIP CODE
SIGNATURE	DATE	TELEPHONE	
COMMENTS			

☐ Check here if attachments

### SECTION G - COMMUNITY INFORMATION (OPTIONAL)

The local official who is authorized by law or ordinance to administer the community's floodplain management ordinance can complete Sections A, B, C (or E), and G of this Elevation Certificate. Complete the applicable item(s) and sign below.

- G1. ☐ The information in Section C was taken from other documentation that has been signed and embossed by a licensed surveyor, engineer, or architect who is authorized by state or local law to certify elevation information. (Indicate the source and date of the elevation data in the Comments area below.)
- G2. ☐ A community official completed Section E for a building located in Zone A (without a FEMA-issued or community-issued BFE) or Zone AO.
- G3. ☐ The following information (Items G4-G9) is provided for community floodplain management purposes.

G4. PERMIT NUMBER 03-625E _ P03CP 08825	G5. DATE PERMIT ISSUED 9-5-03	G6. DATE CERTIFICATE OF COMPLIANCE/OCCUPANCY ISSUED
--	----------------------------------	---

G7. This permit has been issued for: ☒ New Construction ☐ Substantial Improvement

G8. Elevation of as-built lowest floor (including basement) of the building is:

G9. BFE or (in Zone AO) depth of flooding at the building site is:

\_\_\_\_ ft.(m) Datum: \_\_\_\_  
 \_\_\_\_ ft.(m) Datum: \_\_\_\_

LOCAL OFFICIAL'S NAME	TITLE
COMMUNITY NAME	TELEPHONE
SIGNATURE	DATE
COMMENTS	

☐ Check here if attachments



IMPORTANT: In these spaces, copy the corresponding information from Section A.

BUILDING STREET ADDRESS (Including Apt., Unit, Suite, and/or Bldg. No.) OR P.O. ROUTE AND BOX NO.

1991 West Corona Road

CITY

Tucson

STATE

AZ

ZIP CODE

85746

For Insurance Company Use:

Policy Number

Company NAIC Number

### SECTION D - SURVEYOR, ENGINEER, OR ARCHITECT CERTIFICATION (CONTINUED)

Copy both sides of this Elevation Certificate for (1) community official, (2) insurance agent/company, and (3) building owner.

#### COMMENTS

The elevation given in C3, section a) was taken at the finish floor elevation of a concrete slab.

☐ Check here if attachments

### SECTION E - BUILDING ELEVATION INFORMATION (SURVEY NOT REQUIRED) FOR ZONE AO AND ZONE A (WITHOUT BFE)

For Zone AO and Zone A (without BFE), complete Items E1 through E4. If the Elevation Certificate is intended for use as supporting information for a LOMA or LOMR-F, Section C must be completed.

E1. Building Diagram Number (Select the building diagram most similar to the building for which this certificate is being completed - see pages 6 and 7. If no diagram accurately represents the building, provide a sketch or photograph.)

E2. The top of the bottom floor (including basement or enclosure) of the building is \_\_\_ ft.(m) \_\_\_ in.(cm) ☐ above or ☐ below (check one) the highest adjacent grade. (Use natural grade, if available).

E3. For Building Diagrams 6-8 with openings (see page 7), the next higher floor or elevated floor (elevation b) of the building is \_\_\_ ft.(m) \_\_\_ in.(cm) above the highest adjacent grade. Complete items C3.h and C3.i on front of form.

E4. The top of the platform of machinery and/or equipment servicing the building is \_\_\_ ft.(m) \_\_\_ in.(cm) ☐ above or ☐ below (check one) the highest adjacent grade. (Use natural grade, if available).

E5. For Zone AO only: If no flood depth number is available, is the top of the bottom floor elevated in accordance with the community's floodplain management ordinance?  
☐ Yes ☐ No ☐ Unknown. The local official must certify this information in Section G.

### SECTION F - PROPERTY OWNER (OR OWNER'S REPRESENTATIVE) CERTIFICATION

The property owner or owner's authorized representative who completes Sections A, B, C (Items C3.h and C3.i only), and E for Zone A (without a FEMA-issued or community-issued BFE) or Zone AO must sign here. The statements in Sections A, B, C, and E are correct to the best of my knowledge.

PROPERTY OWNER'S OR OWNER'S AUTHORIZED REPRESENTATIVE'S NAME

ADDRESS

CITY

STATE

ZIP CODE

SIGNATURE

DATE

TELEPHONE

COMMENTS

☐ Check here if attachments

### SECTION G - COMMUNITY INFORMATION (OPTIONAL)

The local official who is authorized by law or ordinance to administer the community's floodplain management ordinance can complete Sections A, B, C (or E), and G of this Elevation Certificate. Complete the applicable item(s) and sign below.

G1. ☐ The information in Section C was taken from other documentation that has been signed and embossed by a licensed surveyor, engineer, or architect who is authorized by state or local law to certify elevation information. (Indicate the source and date of the elevation data in the Comments area below.)

G2. ☐ A community official completed Section E for a building located in Zone A (without a FEMA-issued or community-issued BFE) or Zone AO.

G3. ☐ The following information (Items G4-G9) is provided for community floodplain management purposes.

G4. PERMIT NUMBER

03-625E \_ P03CP 08825

G5. DATE PERMIT ISSUED

9-5-03

G6. DATE CERTIFICATE OF COMPLIANCE/OCCUPANCY ISSUED

G7. This permit has been issued for: ☒ New Construction ☐ Substantial Improvement

G8. Elevation of as-built lowest floor (including basement) of the building is:

\_\_\_ ft.(m)

Datum: \_\_\_

G9. BFE or (in Zone AO) depth of flooding at the building site is:

\_\_\_ ft.(m)

Datum: \_\_\_

LOCAL OFFICIAL'S NAME

TITLE

COMMUNITY NAME

TELEPHONE

SIGNATURE

DATE

COMMENTS

☐ Check here if attachments