

FPUP # 04-205

P0\_CP

Client's Initials \_\_\_\_\_

FEDERAL EMERGENCY MANAGEMENT AGENCY  
NATIONAL FLOOD INSURANCE PROGRAMO.M.B. No. 3067-0077  
Expires December 31, 2005

## ELEVATION CERTIFICATE

Important: Read the instructions on pages 1 - 7.

## SECTION A - PROPERTY OWNER INFORMATION

BUILDING OWNER'S NAME Sienna Real Estate and Development L.L.C		For Insurance Company Use: Policy Number	
BUILDING STREET ADDRESS (Including Apt., Unit, Suite, and/or Bldg. No.) OR P.O. ROUTE AND BOX NO. 5481 W. Irvington Road		Company NAIC Number	
CITY Tucson	STATE AZ	ZIP CODE 85 757	
PROPERTY DESCRIPTION (Lot and Block Numbers, Tax Parcel Number, Legal Description, etc.) 210-07-013G T15S - R12E - S02			
BUILDING USE (e.g., Residential, Non-residential, Addition, Accessory, etc. Use a Comments area, if necessary.) Residential Site - Built Home			
LATITUDE/LONGITUDE (OPTIONAL) (###-##-### or ###.####)		HORIZONTAL DATUM: <input type="checkbox"/> NAD 1927 <input type="checkbox"/> NAD 1983	
		SOURCE: <input type="checkbox"/> GPS (Type): <input type="checkbox"/> USGS Quad Map <input type="checkbox"/> Other:	

## SECTION B - FLOOD INSURANCE RATE MAP (FIRM) INFORMATION

B1. NFIP COMMUNITY NAME & COMMUNITY NUMBER Pima County 040073		B2. COUNTY NAME Pima County		B3. STATE AZ	
B4. MAP AND PANEL NUMBER 04019C 2225	B5. SUFFIX K	B6. FIRM INDEX DATE 2/8/99	B7. FIRM PANEL EFFECTIVE/REVISED DATE 2-8-99	B8. FLOOD ZONE(S) AO (1)	B9. BASE FLOOD ELEVATION(S) (Zone AO, use depth of flooding) 1

B10. Indicate the source of the Base Flood Elevation (BFE) data or base flood depth entered in B9.

☐ FIS Profile ☒ FIRM ☐ Community Determined ☐ Other (Describe):B11. Indicate the elevation datum used for the BFE in B9: ☐ NGVD 1929 ☐ NAVD 1988 ☒ Other (Describe): Height Above GradeB12. Is the building located in a Coastal Barrier Resources System (CBRS) area or Otherwise Protected Area (OPA)? ☐ Yes ☒ No Designation Date: N/A

## SECTION C - BUILDING ELEVATION INFORMATION (SURVEY REQUIRED)

C1. Building elevations are based on: ☐ Construction Drawings\* ☐ Building Under Construction\* ☒ Finished Construction

\*A new Elevation Certificate will be required when construction of the building is complete.

C2. Building Diagram Number 1 (Select the building diagram most similar to the building for which this certificate is being completed - see pages 6 and 7. If no diagram accurately represents the building, provide a sketch or photograph.)

C3. Elevations - Zones A1-A30, AE, AH, A (with BFE), VE, V1-V30, V (with BFE), AR, AR/A, AR/AE, AR/A1-A30, AR/AH, AR/AO

Complete Items C3.-a-i below according to the building diagram specified in Item C2. State the datum used. If the datum is different from the datum used for the BFE in Section B, convert the datum to that used for the BFE. Show field measurements and datum conversion calculation. Use the space provided or the Comments area of Section D or Section G, as appropriate, to document the datum conversion.

Datum local Conversion/Comments H.A.G.Elevation reference mark used FPE Does the elevation reference mark used appear on the FIRM? ☐ Yes ☒ No

- a) Top of bottom floor (including basement or enclosure) 103.5 ft.(m)
- b) Top of next higher floor N/A ft.(m)
- c) Bottom of lowest horizontal structural member (V zones only) N/A ft.(m)
- d) Attached garage (top of slab) 103.1 ft.(m)
- e) Lowest elevation of machinery and/or equipment servicing the building (Describe in a Comments area) 103.1 ft.(m)
- f) Lowest adjacent (finished) grade (LAG) 100.0 ft.(m)
- g) Highest adjacent (finished) grade (HAG) 100.5 ft.(m)
- h) No. of permanent openings (flood vents) within 1 ft. above adjacent grade N/A
- i) Total area of all permanent openings (flood vents) in C3.h N/A sq. in. (sq. cm)

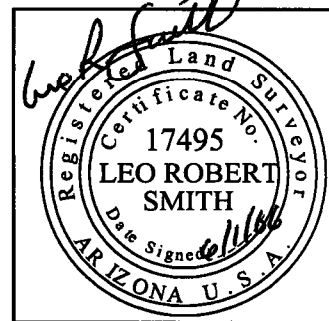
License Number, Embossed Seal,  
Signature, and Date

## SECTION D - SURVEYOR, ENGINEER, OR ARCHITECT CERTIFICATION

This certification is to be signed and sealed by a land surveyor, engineer, or architect authorized by law to certify elevation information.

I certify that the information in Sections A, B, and C on this certificate represents my best efforts to interpret the data available.

I understand that any false statement may be punishable by fine or imprisonment under 18 U.S. Code, Section 1001.

CERTIFIER'S NAME Leo R. Smith		LICENSE NUMBER 17495	
TITLE Capital Improvement Projects Manager		COMPANY NAME Pima County Regional Flood Control District	
ADDRESS 201 N. Stone Ave, Fourth Floor	CITY Tucson	STATE AZ	ZIP CODE 85701
SIGNATURE	DATE 6-1-06	TELEPHONE 520-740-6350	

FPUP # 04-205

**IMPORTANT: In these spaces, copy the corresponding information from Section A.**

BUILDING STREET ADDRESS (Including Apt., Unit, Suite, and/or Bldg. No.) OR P.O. ROUTE AND BOX NO.

5481 W. Irvington Road

CITY

Tucson

STATE

AZ

ZIP CODE

85 757

For Insurance Company Use:

Policy Number

Company NAIC Number

### SECTION D - SURVEYOR, ENGINEER, OR ARCHITECT CERTIFICATION (CONTINUED)

Copy both sides of this Elevation Certificate for (1) community official, (2) insurance agent/company, and (3) building owner.

#### COMMENTS

The lowest service equipment (C3e) is the AC unit. All other equipment is inside at/above the FFE.

☐ Check here if attachments

### SECTION E - BUILDING ELEVATION INFORMATION (SURVEY NOT REQUIRED) FOR ZONE AO AND ZONE A (WITHOUT BFE)

For Zone AO and Zone A (without BFE), complete Items E1 through E4. If the Elevation Certificate is intended for use as supporting information for a LOMA or LOMR-F, Section C must be completed.

E1. Building Diagram Number \_\_ (Select the building diagram most similar to the building for which this certificate is being completed - see pages 6 and 7. If no diagram accurately represents the building, provide a sketch or photograph.)

E2. The top of the bottom floor (including basement or enclosure) of the building is \_\_ ft.(m) \_\_ in.(cm) or ☐ below (check one) the highest adjacent grade. (Use natural grade, if available).

E3. For Building Diagrams 6-8 with openings (see page 7), the next higher floor or elevated floor (elevation b) of the building is \_\_ ft.(m) \_\_ in.(cm) above the highest adjacent grade. Complete items C3.h and C3.i on front of form.

E4. The top of the platform of machinery and/or equipment servicing the building is \_\_ ft.(m) \_\_ in.(cm) ☐ above or ☐ below (check one) the highest adjacent grade. (Use natural grade, if available).

E5. For Zone AO only: If no flood depth number is available, is the top of the bottom floor elevated in accordance with the community's floodplain management ordinance?

☐ Yes ☐ No ☐ Unknown. The local official must certify this information in Section G.

### SECTION F - PROPERTY OWNER (OR OWNER'S REPRESENTATIVE) CERTIFICATION

The property owner or owner's authorized representative who completes Sections A, B, C (Items C3.h and C3.i only), and E for Zone A (without a FEMA-issued or community-issued BFE) or Zone AO must sign here. The statements in Sections A, B, C, and E are correct to the best of my knowledge.

PROPERTY OWNER'S OR OWNER'S AUTHORIZED REPRESENTATIVE'S NAME

ADDRESS

CITY

STATE

ZIP CODE

SIGNATURE

DATE

TELEPHONE

COMMENTS

☐ Check here if attachments

### SECTION G - COMMUNITY INFORMATION (OPTIONAL)

The local official who is authorized by law or ordinance to administer the community's floodplain management ordinance can complete Sections A, B, C (or E), and G of this Elevation Certificate. Complete the applicable item(s) and sign below.

G1. ☒ The information in Section C was taken from other documentation that has been signed and embossed by a licensed surveyor, engineer, or architect who is authorized by state or local law to certify elevation information. (Indicate the source and date of the elevation data in the Comments area below.)

G2. ☐ A community official completed Section E for a building located in Zone A (without a FEMA-issued or community-issued BFE) or Zone AO.

G3. ☐ The following information (Items G4-G9) is provided for community floodplain management purposes.

G4. PERMIT NUMBER

04-205

G5. DATE PERMIT ISSUED

G6. DATE CERTIFICATE OF COMPLIANCE/OCCUPANCY ISSUED

G7. This permit has been issued for: ☒ New Construction ☐ Substantial Improvement

G8. Elevation of as-built lowest floor (including basement) of the building is:

\_\_ ft.(m)

Datum: \_\_

G9. BFE or (in Zone AO) depth of flooding at the building site is:

\_\_ ft.(m)

Datum: \_\_

LOCAL OFFICIAL'S NAME

TITLE

COMMUNITY NAME

TELEPHONE

SIGNATURE

DATE

COMMENTS

☐ Check here if attachments

Client's Initials  
05-04-205

FEDERAL EMERGENCY MANAGEMENT AGENCY  
NATIONAL FLOOD INSURANCE PROGRAM

O.M.B. No. 3067-0077  
Expires December 31, 2005

# ELEVATION CERTIFICATE

Important: Read the instructions on pages 1 - 7.

<b>SECTION A - PROPERTY OWNER INFORMATION</b>			For Insurance Company Use:
BUILDING OWNER'S NAME Sienna Real Estate and Development LLC			Policy Number
BUILDING STREET ADDRESS (Including Apt., Unit, Suite, and/or Bldg. No.) OR P.O. ROUTE AND BOX NO. 5481 W. Irvington Road			Company NAIC Number
CITY Tucson	STATE AZ	ZIP CODE 85	
PROPERTY DESCRIPTION (Lot and Block Numbers, Tax Parcel Number, Legal Description, etc.) 210-07-013G T15S-R12E-S02			
BUILDING USE (e.g., Residential, Non-residential, Addition, Accessory, etc. Use a Comments area, if necessary.) Residential Site - Built Home			
LATITUDE/LONGITUDE (OPTIONAL) (##°-##'-###.###" or ###.####")		HORIZONTAL DATUM: <input type="checkbox"/> NAD 1927 <input type="checkbox"/> NAD 1983	
		SOURCE: <input type="checkbox"/> GPS (Type): <input type="checkbox"/> USGS Quad Map <input type="checkbox"/> Other: _____	

## SECTION B - FLOOD INSURANCE RATE MAP (FIRM) INFORMATION

B1. NFIP COMMUNITY NAME & COMMUNITY NUMBER Pima County 040073		B2. COUNTY NAME Pima County		B3. STATE Arizona	
B4. MAP AND PANEL NUMBER 04019C 2225	B5. SUFFIX K	B6. FIRM INDEX DATE 2/8/99	B7. FIRM PANEL EFFECTIVE/REVISED DATE 2/8/99	B8. FLOOD ZONE(S) AO(1)	B9. BASE FLOOD ELEVATION(S) (Zone AO, use depth of flooding) 1

B10. Indicate the source of the Base Flood Elevation (BFE) data or base flood depth entered in B9.

☐ FIS Profile ☒ FIRM ☐ Community Determined ☐ Other (Describe): \_\_\_\_\_

B11. Indicate the elevation datum used for the BFE in B9: ☐ NGVD 1929

☐ NAVD 1988 ☒ Other (Describe): Height Above Grade

B12. Is the building located in a Coastal Barrier Resources System (CBRS) area or Otherwise Protected Area (OPA)? ☐ Yes ☒ No Designation Date NA

## SECTION C - BUILDING ELEVATION INFORMATION (SURVEY REQUIRED)

C1. Building elevations are based on: ☐ Construction Drawings\* ☐ Building Under Construction\* ☒ Finished Construction

\*A new Elevation Certificate will be required when construction of the building is complete.

C2. Building Diagram Number 1 (Select the building diagram most similar to the building for which this certificate is being completed - see pages 6 and 7. If no diagram accurately represents the building, provide a sketch or photograph.)

C3. Elevations - Zones A1-A30, AE, AH, A (with BFE), VE, V1-V30, V (with BFE), AR, AR/A, AR/AE, AR/A1-A30, AR/AH, AR/AO

Complete Items C3-a-i below according to the building diagram specified in Item C2. State the datum used. If the datum is different from the datum used for the BFE in Section B, convert the datum to that used for the BFE. Show field measurements and datum conversion calculation. Use the space provided or the Comments area of Section D or Section G, as appropriate, to document the datum conversion.

Datum BFE Conversion/Comments H.A.G.

Elevation reference mark used BFE Does the elevation reference mark used appear on the FIRM? ☐ Yes ☒ No

a) Top of bottom floor (including basement or enclosure) 103.5 ft.(m)

b) Top of next higher floor 124 ft.(m)

c) Bottom of lowest horizontal structural member (V-zones only) 124 ft.(m)

d) Attached garage (top of slab) 103.1 ft.(m)

e) Lowest elevation of machinery and/or equipment servicing the building (Describe in a Comments area) 103.1 ft.(m)

f) Lowest adjacent (finished) grade (LAG) 100.0 ft.(m)

g) Highest adjacent (finished) grade (HAG) 100.5 ft.(m)

h) No. of permanent openings (flood vents) within 1 ft. above adjacent grade 0

i) Total area of all permanent openings (flood vents) in C3.h NA sq. in. (sq. cm)

License Number, Embossed Seal, Signature and Date

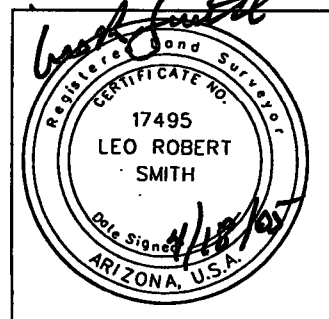

## SECTION D - SURVEYOR, ENGINEER, OR ARCHITECT CERTIFICATION

This certification is to be signed and sealed by a land surveyor, engineer, or architect authorized by law to certify elevation information.

I certify that the information in Sections A, B, and C on this certificate represents my best efforts to interpret the data available.

I understand that any false statement may be punishable by fine or imprisonment under 18 U.S. Code, Section 1001.

CERTIFIER'S NAME Leo R. Smith LICENSE NUMBER 17495

TITLE Floodplain Engineering Manager COMPANY NAME Pima County Flood Control District  
ADDRESS 201 N. Stone Avenue, Tucson, AZ 85701 CITY Tucson STATE AZ ZIP CODE 85701  
SIGNATURE Leo R. Smith DATE April 18, 2005 TELEPHONE 740-6350

elcert\_05

**IMPORTANT: In these spaces, copy the corresponding information from Section A.**

BUILDING STREET ADDRESS (including Apt., Unit, Suite, and/or Bldg. No.) OR P.O. ROUTE AND BOX NO.

5481 W. Irvington Road

CITY  
TucsonSTATE  
AZZIP CODE  
85

For Insurance Company Use:

Policy Number

Company NAIC Number

**SECTION D - SURVEYOR, ENGINEER, OR ARCHITECT CERTIFICATION (CONTINUED)**

Copy both sides of this Elevation Certificate for (1) community official, (2) insurance agent/company, and (3) building owner.

COMMENTS

☐ Check here if attachments**SECTION E - BUILDING ELEVATION INFORMATION (SURVEY NOT REQUIRED) FOR ZONE AO AND ZONE A (WITHOUT BFE)**

For Zone AO and Zone A (without BFE), complete Items E1 through E4. If the Elevation Certificate is intended for use as supporting information for a LOMA or LOMR-F, Section C must be completed.

E1. Building Diagram Number (Select the building diagram most similar to the building for which this certificate is being completed - see pages 6 and 7. If no diagram accurately represents the building, provide a sketch or photograph.)

E2. The top of the bottom floor (including basement or enclosure) of the building is \_\_\_ ft.(m) \_\_\_ in.(cm) ☐ above or ☐ below (check one) the highest adjacent grade. (Use natural grade, if available).

E3. For Building Diagrams 6-8 with openings (see page 7), the next higher floor or elevated floor (elevation b) of the building is \_\_\_ ft.(m) \_\_\_ in.(cm) above the highest adjacent grade. Complete items C3.h and C3.i on front of form.

E4. The top of the platform of machinery and/or equipment servicing the building is \_\_\_ ft.(m) \_\_\_ in.(cm) ☐ above or ☐ below (check one) the highest adjacent grade. (Use natural grade, if available).

E5. For Zone AO only: If no flood depth number is available, is the top of the bottom floor elevated in accordance with the community's floodplain management ordinance?

☐ Yes ☐ No ☐ Unknown. The local official must certify this information in Section G.**SECTION F - PROPERTY OWNER (OR OWNER'S REPRESENTATIVE) CERTIFICATION**

The property owner or owner's authorized representative who completes Sections A, B, C (Items C3.h and C3.i only), and E for Zone A (without a FEMA-issued or community-issued BFE) or Zone AO must sign here. The statements in Sections A, B, C, and E are correct to the best of my knowledge.

PROPERTY OWNER'S OR OWNER'S AUTHORIZED REPRESENTATIVE'S NAME

ADDRESS CITY STATE ZIP CODE

SIGNATURE DATE TELEPHONE

COMMENTS

☐ Check here if attachments**SECTION G - COMMUNITY INFORMATION (OPTIONAL)**

The local official who is authorized by law or ordinance to administer the community's floodplain management ordinance can complete Sections A, B, C (or E), and G of this Elevation Certificate. Complete the applicable item(s) and sign below.

G1. ☒ The information in Section C was taken from other documentation that has been signed and embossed by a licensed surveyor, engineer, or architect who is authorized by state or local law to certify elevation information. (Indicate the source and date of the elevation data in the Comments area below.)G2. ☐ A community official completed Section E for a building located in Zone A (without a FEMA-issued or community-issued BFE) or Zone AO.G3. ☐ The following information (Items G4-G9) is provided for community floodplain management purposes.G4. PERMIT NUMBER  
04-205

G5. DATE PERMIT ISSUED

G6. DATE CERTIFICATE OF COMPLIANCE/OCCUPANCY ISSUED

G7. This permit has been issued for: ☒ New Construction ☐ Substantial Improvement

G8. Elevation of as-built lowest floor (including basement) of the building is: \_\_\_ ft.(m) Datum: \_\_\_

G9. BFE or (in Zone AO) depth of flooding at the building site is: \_\_\_ ft.(m) Datum: \_\_\_

LOCAL OFFICIAL'S NAME

Jean Hudson

TITLE

Senior Hydrologist

COMMUNITY NAME

Pima Co.

TELEPHONE

740-6350

SIGNATURE

Jean Hudson

DATE

4-18-5

COMMENTS

finished construction verification

The Regulatory Flood Elevation (RFE) is one foot above the Base Flood Elevation (BFE). Unless an elevation above mean sea level is given, elevations are based on Highest Adjacent Grade (HAG).

☐ Check here if attachments





5481 W. Irvington Sprp 04-205 210-07-0136 4-18-05  
JA



FEDERAL EMERGENCY MANAGEMENT AGENCY  
NATIONAL FLOOD INSURANCE PROGRAM

O.M.B. No. 3067-0077  
Expires December 31, 2005

ELEVATION CERTIFICATE

Important: Read the instructions on pages 1 - 7.

SECTION A - PROPERTY OWNER INFORMATION		For Insurance Company Use:
BUILDING OWNER'S NAME <b>Sienna Real Estate &amp; Development</b>		Policy Number
BUILDING STREET ADDRESS (Including Apt., Unit, Suite, and/or Bldg. No.) OR P.O. ROUTE AND BOX NO. <b>5481 W. Irvington Rd.</b>		Company NAIC Number
CITY <b>Tucson</b>	STATE <b>AZ</b>	ZIP CODE <b>85716</b>
PROPERTY DESCRIPTION (Lot and Block Numbers, Tax Parcel Number, Legal Description, etc.) <b>Lot #4 ptn. of 210-07-01386 T15S/R12E/Sec 02</b>		
BUILDING USE (e.g., Residential, Non-residential, Addition, Accessory, etc. Use a Comments area, if necessary.) <b>Residential Site-Built Home</b>		
LATITUDE/LONGITUDE (OPTIONAL) (##-##-##.## or ##.#####)	HORIZONTAL DATUM: <input type="checkbox"/> NAD 1927 <input type="checkbox"/> NAD 1983	SOURCE: <input type="checkbox"/> GPS (Type): <input type="checkbox"/> USGS Quad Map <input type="checkbox"/> Other: _____

SECTION B - FLOOD INSURANCE RATE MAP (FIRM) INFORMATION

B1. NFIP COMMUNITY NAME & COMMUNITY NUMBER <b>040073</b>		B2. COUNTY NAME <b>Pima</b>	B3. STATE <b>Arizona</b>
B4. MAP AND PANEL NUMBER <b>04019C2225</b>	B5. SUFFIX <b>K</b>	B6. FIRM INDEX DATE <b>2-8-99</b>	B7. FIRM PANEL EFFECTIVE/REVISED DATE <b>---</b>
B8. FLOOD ZONE(S) <b>A0(1)</b>		B9. BASE FLOOD ELEVATION(S) (Zone AO, use depth of flooding) <b>1.0 ft. H.A.G.</b>	

B10. Indicate the source of the Base Flood Elevation (BFE) data or base flood depth entered in B9.

☐ FIS Profile ☒ FIRM ☐ Community Determined

☐ Other (Describe): \_\_\_\_\_

B11. Indicate the elevation datum used for the BFE in B9: ☐ NGVD 1929

☐ NAVD 1988

☒ Other (Describe): **Height Above Grade**

B12. Is the building located in a Coastal Barrier Resources System (CBRS) area or Otherwise Protected Area (OPA)? ☐ Yes ☐ No Designation Date \_\_\_\_\_

SECTION C - BUILDING ELEVATION INFORMATION (SURVEY REQUIRED)

C1. Building elevations are based on: ☐ Construction Drawings\* ☒ Building Under Construction\* ☐ Finished Construction

\*A new Elevation Certificate will be required when construction of the building is complete.

C2. Building Diagram Number \_ (Select the building diagram most similar to the building for which this certificate is being completed - see pages 6 and 7. If no diagram accurately represents the building, provide a sketch or photograph.)

C3. Elevations - Zones A1-A30, AE, AH, A (with BFE), VE, V1-V30, V (with BFE), AR, AR/A, AR/AE, AR/A1-A30, AR/AH, AR/AO

Complete Items C3.-a-i below according to the building diagram specified in Item C2. State the datum used. If the datum is different from the datum used for the BFE in Section B, convert the datum to that used for the BFE. Show field measurements and datum conversion calculation. Use the space provided or the Comments area of Section D or Section G, as appropriate, to document the datum conversion.

Datum \_\_\_\_\_ Conversion/Comments **NA**

Elevation reference mark used \_\_\_\_\_ Does the elevation reference mark used appear on the FIRM? ☐ Yes ☐ No

a) Top of bottom floor (including basement or enclosure)

**103.50** ft.(m)

b) Top of next higher floor

**N/A** ft.(m)

c) Bottom of lowest horizontal structural member

**N/A** ft.(m)

d) Attached garage (top of slab)

**N/A** ft.(m)

e) Lowest elevation of machinery and/or equipment

**N/A** ft.(m)

servicing the building (Describe in a Comments area)

**N/A** ft.(m)

f) Lowest adjacent (finished) grade (LAG)

**100.00** ft.(m)

g) Highest adjacent (finished) grade (HAG)

**100.50** ft.(m)

h) No. of permanent openings (flood vents) within 1 ft. above adjacent grade

**N/A**

i) Total area of all permanent openings (flood vents) in C3.h **N/A** sq. in. (sq. cm)

License Number, Embossed Seal, Signature, and Date

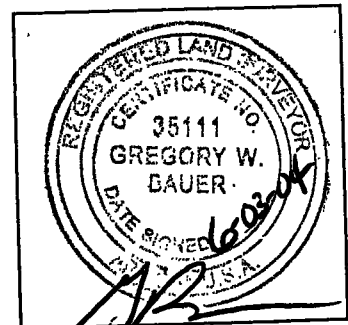

SECTION D - SURVEYOR

CERTIFICATION

This certification is to be signed and sealed by a land surveyor, or \_\_\_\_\_, authorized by law to certify elevation information.

I certify that the information in Sections A, B, and C on this certificate represents my best efforts to interpret the data available.

I understand that any false statement may be punishable by fine or imprisonment under 18 U.S. Code, Section 1001.

CERTIFIER'S NAME  
**GREGORY W BAUER**

LICENSE NUMBER  
**35111**

TITLE  
**VICE PRES.**

COMPANY NAME  
**ARROW LAND SURVY**

ADDRESS  
**3121 E KLENDAVE RD**

CITY  
**TUCSON**

STATE  
**AZ**

ZIP CODE  
**85716**

SIGNATURE  
**[Signature]**

DATE  
**6-03-04**

TELEPHONE  
**520-891-2185**

IMPORTANT: In these spaces, copy the corresponding information from Section A.

BUILDING STREET ADDRESS (Including Apt., Unit, Suite, and/or Bldg. No.) OR P.O. ROUTE AND BOX NO.

5481 W. Irvington Rd.

CITY, Tucson STATE AZ ZIP CODE

For Insurance Company Use:

Policy Number

Company NAIC Number

SECTION D - SURVEYOR

CERTIFICATION (CONTINUED)

Copy both sides of this Elevation Certificate for (1) community official, (2) insurance agent/company, and (3) building owner.

COMMENTS

SECTION E - BUILDING ELEVATION INFORMATION (SURVEY NOT REQUIRED) FOR ZONE AO AND ZONE A (WITHOUT BFE)

☐ Check here if attachments

For Zone AO and Zone A (without BFE), complete Items E1 through E4. If the Elevation Certificate is intended for use as supporting information for a LOMA or LOMR-F, Section C must be completed.

E1. Building Diagram Number (Select the building diagram most similar to the building for which this certificate is being completed - see pages 6 and 7. If no diagram accurately represents the building, provide a sketch or photograph.)

E2. The top of the bottom floor (including basement or enclosure) of the building is \_\_\_ ft.(m) \_\_\_ in.(cm) ☐ above or ☐ below (check one) the highest adjacent grade. (Use natural grade, if available).

E3. For Building Diagrams 6-8 with openings (see page 7), the next higher floor or elevated floor (elevation b) of the building is \_\_\_ ft.(m) \_\_\_ in.(cm) above the highest adjacent grade. Complete items C3.h and C3.i on front of form.

E4. The top of the platform of machinery and/or equipment servicing the building is \_\_\_ ft.(m) \_\_\_ in.(cm) ☐ above or ☐ below (check one) the highest adjacent grade. (Use natural grade, if available).

E5. For Zone AO only: If no flood depth number is available, is the top of the bottom floor elevated in accordance with the community's floodplain management ordinance?  
☐ Yes ☐ No ☐ Unknown. The local official must certify this information in Section G.

SECTION F - PROPERTY OWNER (OR OWNER'S REPRESENTATIVE) CERTIFICATION

The property owner or owner's authorized representative who completes Sections A, B, C (Items C3.h and C3.i only), and E for Zone A (without a FEMA-issued or community-issued BFE) or Zone AO must sign here. The statements in Sections A, B, C, and E are correct to the best of my knowledge.

PROPERTY OWNER'S OR OWNER'S AUTHORIZED REPRESENTATIVE'S NAME

ADDRESS CITY STATE ZIP CODE

SIGNATURE DATE TELEPHONE

COMMENTS

SECTION G - COMMUNITY INFORMATION (OPTIONAL)

☐ Check here if attachments

The local official who is authorized by law or ordinance to administer the community's floodplain management ordinance can complete Sections A, B, C (or E), and G of this Elevation Certificate. Complete the applicable item(s) and sign below.

G1. ☐ The information in Section C was taken from other documentation that has been signed and embossed by a licensed surveyor, engineer, or architect who is authorized by state or local law to certify elevation information. (Indicate the source and date of the elevation data in the Comments area below.)

G2. ☐ A community official completed Section E for a building located in Zone A (without a FEMA-issued or community-issued BFE) or Zone AO.

G3. ☐ The following information (Items G4-G9) is provided for community floodplain management purposes.

G4. PERMIT NUMBER

04-205 E

G5. DATE PERMIT ISSUED

G6. DATE CERTIFICATE OF COMPLIANCE/OCCUPANCY ISSUED

G7. This permit has been issued for: ☐ New Construction ☐ Substantial Improvement

G8. Elevation of as-built lowest floor (including basement) of the building is:

\_\_\_ ft.(m)

Datum: \_\_\_

G9. BFE or (in Zone AO) depth of flooding at the building site is:

\_\_\_ ft.(m)

Datum: \_\_\_

LOCAL OFFICIAL'S NAME TITLE

COMMUNITY NAME TELEPHONE

SIGNATURE DATE

COMMENTS

☐ Check here if attachments