

ELEVATION CERTIFICATE

OMB No. 1660-0008
Expires February 28, 2009

Important: Read the instructions on pages 1-8.

SECTION A - PROPERTY INFORMATION				For Insurance Company Use:	
A1. Building Owner's Name Deborah Leeson				Policy Number	
A2. Building Street Address (including Apt., Unit, Suite, and/or Bldg. No.) or P.O. Route and Box No. 7105 N. Nelson Quihuis Rd.				Company NAIC Number	
City Tucson		State AZ		ZIP Code 85735	
A3. Property Description (Lot and Block Numbers, Tax Parcel Number, Legal Description, etc.)					
Tax Code		Township		Range Section	
A4. Building Use (e.g., Residential, Non-Residential, Addition, Accessory, etc.) Residential: Manufactured Home					
A5. Latitude/Longitude: Lat. 32.3339		Long. -111.2884		Horizontal Datum: <input type="checkbox"/> NAD 1927 <input checked="" type="checkbox"/> NAD 1983	
A6. Attach at least 2 photographs of the building if the Certificate is being used to obtain flood insurance.					
A7. Building Diagram Number 5					
A8. For a building with a crawl space or enclosure(s), provide:					
a) Square footage of crawl space or enclosure(s) N/A sq ft		A9. For a building with an attached garage, provide:			
b) No. of permanent flood openings in the crawl space or enclosure(s) walls within 1.0 foot above adjacent grade N/A		a) Square footage of attached garage N/A sq ft		b) No. of permanent flood openings in the attached garage walls within 1.0 foot above adjacent grade N/A	
c) Total net area of flood openings in A8.b N/A sq in		c) Total net area of flood openings in A9.b N/A sq in			

SECTION B - FLOOD INSURANCE RATE MAP (FIRM) INFORMATION

B1. NFIP Community Name & Community Number Pima County / 040073		B2. County Name Pima County		B3. State AZ	
B4. Map/Panel Number 04019C 1560	B5. Suffix K	B6. FIRM Index Date 2/8/99	B7. FIRM Panel Effective/Revised Date 2/8/99	B8. Flood Zone(s) AO1	B9. Base Flood Elevation(s) (Zone AO, use base flood depth) 1.0
B10. Indicate the source of the Base Flood Elevation (BFE) data or base flood depth entered in Item B9. <input type="checkbox"/> FIS Profile <input checked="" type="checkbox"/> FIRM <input type="checkbox"/> Community Determined <input type="checkbox"/> Other (Describe)					
B11. Indicate elevation datum used for BFE in Item B9: <input type="checkbox"/> NGVD 1929 <input type="checkbox"/> NAVD 1988 <input checked="" type="checkbox"/> Other (Describe) Highest Adjacent Natural Grade					
B12. Is the building located in a Coastal Barrier Resources System (CBRS) area or Otherwise Protected Area (OPA)? <input type="checkbox"/> Yes <input checked="" type="checkbox"/> No Designation Date N/A <input type="checkbox"/> CBRS <input type="checkbox"/> OPA					

SECTION C - BUILDING ELEVATION INFORMATION (SURVEY REQUIRED)

C1. Building elevations are based on: ☐ Construction Drawings* ☐ Building Under Construction* ☒ Finished Construction
*A new Elevation Certificate will be required when construction of the building is complete.

C2. Elevations - Zones A1-A30, AE, AH, A (with BFE), VE, V1-V30, V (with BFE), AR, AR/A, AR/AE, AR/A1-A30, AR/AH, AR/AO. Complete Items C2.a-g below according to the building diagram specified in Item A7.

Benchmark Utilized **LOCAL** Vertical Datum **0.00 ASSUMED LAG**

Conversion/Comments **NONE**

Check the measurement used.

a) Top of bottom floor (including basement, crawl space, or enclosure floor)	3.7 <input checked="" type="checkbox"/> feet	<input type="checkbox"/> meters (Puerto Rico only)
b) Top of the next higher floor	N/A <input checked="" type="checkbox"/> feet	<input type="checkbox"/> meters (Puerto Rico only)
c) Bottom of the lowest horizontal structural member (V Zones only)	N/A <input checked="" type="checkbox"/> feet	<input type="checkbox"/> meters (Puerto Rico only)
d) Attached garage (top of slab)	N/A <input checked="" type="checkbox"/> feet	<input type="checkbox"/> meters (Puerto Rico only)
e) Lowest elevation of machinery or equipment servicing the building (Describe type of equipment in Comments)	3.7 <input checked="" type="checkbox"/> feet	<input type="checkbox"/> meters (Puerto Rico only)
f) Lowest adjacent (finished) grade (LAG)	ASSUMED 0.0 <input checked="" type="checkbox"/> feet	<input type="checkbox"/> meters (Puerto Rico only)
g) Highest adjacent (finished) grade (HAG)	0.4 <input checked="" type="checkbox"/> feet	<input type="checkbox"/> meters (Puerto Rico only)

When B.9 is a depth, indicate highest and lowest NATURAL grade in Section D Comments

SECTION D - SURVEYOR, ENGINEER, OR ARCHITECT CERTIFICATION

This certification is to be signed and sealed by a land surveyor, engineer, or architect authorized by law to certify elevation information. I certify that the information on this Certificate represents my best efforts to interpret the data available. I understand that any false statement may be punishable by fine or imprisonment under 18 U.S. Code, Section 1001.

☒ Check here if comments are provided on back of form.

Certifier's Name EDGAR B. REYNOLDS JR.		License Number AZ 31031	
Title LAND SURVEYOR	Company Name EDGAR REYNOLDS AND ASSOCIATES		
Address 1926 W. CALLE MEGALONA	City TUCSON	State AZ.	ZIP Code 85745
Signature [Signature]	Date 3/15/07	Telephone 520-884-0292	

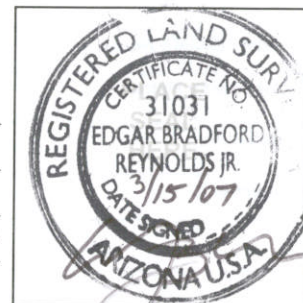

IMPORTANT: In these spaces, copy the corresponding information from Section A.			For Insurance Company Use:
Building Street Address (including Apt., Unit, Suite, and/or Bldg. No.) or P.O. Route and Box No. 7105 N. Nelson Quihuis Rd.			Policy Number
City Tucson	State AZ	ZIP Code 85735	Company NAIC Number

SECTION D - SURVEYOR, ENGINEER, OR ARCHITECT CERTIFICATION (CONTINUED)

Copy both sides of this Elevation Certificate for (1) community official, (2) insurance agent/company, and (3) building owner.

Comments: The lowest service equipment (C3.e) is the FURNACE and the AC is/are above this elevation.

The is 2' BETWEEN THE HAG AND THE BOTTOM OF THE STRUCTURAL BEAM, NO SKIRTING, WINDOW SET AC UNIT USED MANUFACTURED HOME

Signature [Signature] Date 3/15/07 ☐ Check here if attachments

SECTION E - BUILDING ELEVATION INFORMATION (SURVEY NOT REQUIRED) FOR ZONE AO AND ZONE A (WITHOUT BFE)

For Zones AO and A (without BFE), complete Items E1-E5. If the Certificate is intended to support a LOMA or LOMR-F request, complete Sections A, B, and C. For Items E1-E4, use natural grade, if available. Check the measurement used. In Puerto Rico only, enter meters.

- E1. Provide elevation information for the following and check the appropriate boxes to show whether the elevation is above or below the highest adjacent grade (HAG) and the lowest adjacent grade (LAG).
- a) Top of bottom floor (including basement, crawl space, enclosure) is _____ feet _____ meters ☐ above or ☐ below the HAG.
- b) Top of bottom floor (including basement, crawl space, enclosure) is _____ feet _____ meters ☐ above or ☐ below the LAG.
- E2. For Building Diagrams 6-8 with permanent flood openings provided in Section A Items 3 and 9 (see page 8 of Instructions), the next higher floor (elevation C2.b in the diagrams) of the building is _____ feet _____ meters ☐ above or ☐ below the HAG.
- E3. Attached garage (top of slab) is _____ feet _____ meters ☐ above or ☐ below the HAG.
- E4. Top of platform of machinery and/or equipment servicing the building is _____ feet _____ meters ☐ above or ☐ below the HAG.
- E5. Zone AO only: If no flood depth number is available, is the top of the bottom floor elevated in accordance with the community's floodplain management ordinance? ☐ Yes ☐ No ☐ Unknown. The local official must certify this information in Section G.

SECTION F - PROPERTY OWNER (OR OWNER'S REPRESENTATIVE) CERTIFICATION

The property owner or owner's authorized representative who completes Sections A, B, and E for Zone A (without a FEMA-issued or community-issued BFE) or Zone AO must sign here. The statements in Sections A, B, and E are correct to the best of my knowledge.

Property Owner's or Owner's Authorized Representative's Name

Address City State ZIP Code

Signature Date Telephone

Comments

☐ Check here if attachments**SECTION G - COMMUNITY INFORMATION (OPTIONAL)**

The local official who is authorized by law or ordinance to administer the community's floodplain management ordinance can complete Sections A, B, C (or E), and G of this Elevation Certificate. Complete the applicable item(s) and sign below. Check the measurement used in Items G8. and G9.

- G1. ☐ The information in Section C was taken from other documentation that has been signed and sealed by a licensed surveyor, engineer, or architect who is authorized by law to certify elevation information. (Indicate the source and date of the elevation data in the Comments area below.)
- G2. ☐ A community official completed Section E for a building located in Zone A (without a FEMA-issued or community-issued BFE) or Zone AO.
- G3. ☐ The following information (Items G4.-G9.) is provided for community floodplain management purposes.

G4. Permit Number FPUP# 07-060E	G5. Date Permit Issued	G6. Date Certificate Of Compliance/Occupancy Issued
-------------------------------------------	------------------------	-----------------------------------------------------

G7. This permit has been issued for: ☐ New Construction ☐ Substantial Improvement

G8. Elevation of as-built lowest floor (including basement) of the building: _____ feet _____ meters (PR) Datum _____

G9. BFE or (in Zone AO) depth of flooding at the building site: _____ feet _____ meters (PR) Datum _____

Local Official's Name

Title

Community Name

Telephone

Signature

Date

Comments

☐ Check here if attachments

060
FPUP# 07-042E

Building Photographs

Continuation Page

Building Street Address (including Apt., Unit, Suite, and/or Bldg. No.) or P.O. Route and Box No. 7105 N. Nelson Quihuis Rd.			For Insurance Company Use: Policy Number
City Tucson	State AZ	ZIP Code 85735	Company NAIC Number

If submitting more photographs than will fit on the preceding page, affix the additional photographs below. Identify all photographs with: date taken; "Front View" and "Rear View"; and, if required, "Right Side View" and "Left Side View."



7105 Nelson
Quihuis



7105 Nelson
Quihuis