

FPUP# 07-283E

P0 7 CP 04477

U.S. DEPARTMENT OF HOMELAND SECURITY
Federal Emergency Management Agency
National Flood Insurance Program

ELEVATION CERTIFICATE

Important: Read the instructions on pages 1-8.

OMB No. 1660-0008
Expires February 28, 2009

SECTION A - PROPERTY INFORMATION

A1. Building Owner's Name ANA SAUCEDA & JESUS ESPINOZA-ALVAREZ	For Insurance Company Use: Policy Number
A2. Building Street Address (including Apt., Unit, Suite, and/or Bldg. No.) or P.O. Route and Box No. 6131 N ELM TREE LANE	Company NAIC Number

City **TUCSON**

State **AZ**

ZIP Code **85705**

A3. Property Description (Lot and Block Numbers, Tax Parcel Number, Legal Description, etc.)

Tax Code 101-07-0590 Township 13S Range 13E Section 08

Residential: Manufactured Home Replacement

A4. Building Use (e.g., Residential, Non-Residential, Addition, Accessory, etc.)

A5. Latitude/Longitude: Lat. **32.3185E** Long. **-111.0388N** Horizontal Datum: ☐ NAD 1927 ☒ NAD 1983

A6. Attach at least 2 photographs of the building if the Certificate is being used to obtain flood insurance.

A7. Building Diagram Number **5**

A8. For a building with a crawl space or enclosure(s), provide:

a) Square footage of crawl space or enclosure(s) **N/A** sq ft

b) No. of permanent flood openings in the crawl space or enclosure(s) walls within 1.0 foot above adjacent grade **N/A**

c) Total net area of flood openings in A8.b **N/A** sq in

A9. For a building with an attached garage, provide:

a) Square footage of attached garage **N/A** sq ft

b) No. of permanent flood openings in the attached garage walls within 1.0 foot above adjacent grade **N/A**

c) Total net area of flood openings in A9.b **N/A** sq in

SECTION B - FLOOD INSURANCE RATE MAP (FIRM) INFORMATION

B1. NFIP Community Name & Community Number Pima County / 040073	B2. County Name Pima County	B3. State AZ
B4. Map/Panel Number 04019C 1610	B5. Suffix K	B6. FIRM Index Date 2/8/99
B7. FIRM Panel Effective/Revised Date 4/22/04	B8. Flood Zone(s) SHADED X	B9. Base Flood Elevation(s) (Zone AO, use base flood depth) 0.5

B10. Indicate the source of the Base Flood Elevation (BFE) data or base flood depth entered in Item B9.

☐ FIS Profile ☐ FIRM ☒ Community Determined ☐ Other (Describe)

B11. Indicate elevation datum used for BFE in Item B9: ☐ NGVD 1929 ☐ NAVD 1988 ☒ Other (Describe) **Highest Adjacent Natural Grade**

B12. Is the building located in a Coastal Barrier Resources System (CBRS) area or Otherwise Protected Area (OPA)? ☐ Yes ☒ No
Designation Date **N/A** ☐ CBRS ☐ OPA

SECTION C - BUILDING ELEVATION INFORMATION (SURVEY REQUIRED)

C1. Building elevations are based on: ☐ Construction Drawings* ☐ Building Under Construction* ☒ Finished Construction
*A new Elevation Certificate will be required when construction of the building is complete.

C2. Elevations - Zones A1-A30, AE, AH, A (with BFE), VE, V1-V30, V (with BFE), AR, AR/A, AR/AE, AR/A1-A30, AR/AH, AR/AO. Complete Items C2.a-g below according to the building diagram specified in Item A7.

Benchmark Utilized **LOCAL** Vertical Datum **0.00 = LAG ASSUMED**

Conversion/Comments **NONE**

Check the measurement used.

a) Top of bottom floor (including basement, crawl space, or enclosure floor) **3.1** ☒ feet ☐ meters (Puerto Rico only)

b) Top of the next higher floor **0.0** ☒ feet ☐ meters (Puerto Rico only)

c) Bottom of the lowest horizontal structural member (V Zones only) **N/A** ☒ feet ☐ meters (Puerto Rico only)

d) Attached garage (top of slab) **N/A** ☒ feet ☐ meters (Puerto Rico only)

e) Lowest elevation of machinery or equipment servicing the building **2.0** ☒ feet ☐ meters (Puerto Rico only)
(Describe type of equipment in Comments)

f) Lowest adjacent (finished) grade (LAG) **ASSUMED 0.0** ☒ feet ☐ meters (Puerto Rico only)

g) Highest adjacent (finished) grade (HAG) **0.1** ☒ feet ☐ meters (Puerto Rico only)

When B.9 is a depth, indicate highest and lowest NATURAL grade in Section D Comments

SECTION D - SURVEYOR, ENGINEER,

CERTIFICATION

This certification is to be signed and sealed by a land surveyor, engineer, or architect authorized by law to certify elevation information. I certify that the information on this Certificate represents my best efforts to interpret the data available. I understand that any false statement may be punishable by fine or imprisonment under 18 U.S. Code, Section 1001.

☒ Check here if comments are provided on back of form.

Certifier's Name **EDGAR B. REYNOLDS JR.** License Number **AZ31031**

Title **LAND SURVEYOR** Company Name **EDGAR REYNOLDS AND ASSOCIATES**

Address **1926 W. CALLE MEADOW** City **TUCSON** State **AZ** ZIP Code **85745**

Signature **[Signature]** Date **6/18/07** Telephone **520-884-0292**

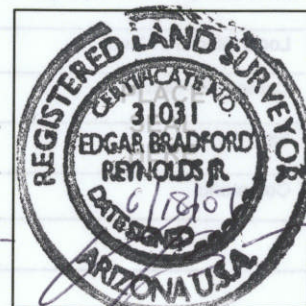

IMPORTANT: In these spaces, copy the corresponding information from Section A.		For Insurance Company Use:
Building Street Address (including Apt., Unit, Suite, and/or Bldg. No.) or P.O. Route and Box No. 6131 N ELM TREE LANE		Policy Number
City TUCSON	State AZ	ZIP Code 85705
		Company NAIC Number

SECTION D - SURVEYOR, ENGINEER, OR ARCHITECT CERTIFICATION (CONTINUED)

Copy both sides of this Elevation Certificate for (1) community official, (2) insurance agent/company, and (3) building owner.

Comments **The lowest service equipment (C3.e) is the AIR COND and the FURNACE, WATER HEATER is/are above this elevation.****There is 1.5' BETWEEN HAG AND BOTTOM OF STRUCTURAL MEMBER. NO SKINTING IN PLACE AT TIME OF PHOTOS, BUT BREAKAWAY SKINTING BEING INSTALLED 6/18/07**Signature **[Signature]** Date **6/18/07** ☐ Check here if attachments**SECTION E - BUILDING ELEVATION INFORMATION (SURVEY NOT REQUIRED) FOR ZONE AO AND ZONE A (WITHOUT BFE)**

For Zones AO and A (without BFE), complete Items E1-E5. If the Certificate is intended to support a LOMA or LOMR-F request, complete Sections A, B, and C. For Items E1-E4, use natural grade, if available. Check the measurement used. In Puerto Rico only, enter meters.

- E1. Provide elevation information for the following and check the appropriate boxes to show whether the elevation is above or below the highest adjacent grade (HAG) and the lowest adjacent grade (LAG).
- a) Top of bottom floor (including basement, crawl space, and enclosure) is _____ feet _____ meters ☐ above or ☐ below the HAG.
- b) Top of bottom floor (including basement, crawl space, and enclosure) is _____ feet _____ meters ☐ above or ☐ below the LAG.
- E2. For Building Diagrams 6-8 with permanent flood openings provided in Section LA Items 3 and 9 (see page 8 of Instructions), the next higher floor (elevation C2.b in the diagrams) of the building is _____ feet _____ meters ☐ above or ☐ below the HAG.
- E3. Attached garage (top of slab) is _____ feet _____ meters ☐ above or ☐ below the HAG.
- E4. Top of platform of machinery and/or equipment servicing the building is _____ feet _____ meters ☐ above or ☐ below the HAG.
- E5. Zone AO only: If no flood depth number is available, is the top of the bottom floor elevated in accordance with the community's floodplain management ordinance? ☐ Yes ☐ No ☐ Unknown. The local official must certify this information in Section G.

SECTION F - PROPERTY OWNER (OR OWNER'S REPRESENTATIVE) CERTIFICATION

The property owner or owner's authorized representative who completes Sections A, B, and E for Zone A (without a FEMA-issued or community-issued BFE) or Zone AO must sign here. The statements in Sections A, B, and E are correct to the best of my knowledge.

Property Owner's or Owner's Authorized Representative's Name

Address _____ City _____ State _____ ZIP Code _____

Signature _____ Date _____ Telephone _____

Comments _____

☐ Check here if attachments**SECTION G - COMMUNITY INFORMATION (OPTIONAL)**

The local official who is authorized by law or ordinance to administer the community's floodplain management ordinance can complete Sections A, B, C (or E), and G of this Elevation Certificate. Complete the applicable item(s) and sign below. Check the measurement used in Items G8. and G9.

- G1. ☐ The information in Section C was taken from other documentation that has been signed and sealed by a licensed surveyor, engineer, or architect who is authorized by law to certify elevation information. (Indicate the source and date of the elevation data in the Comments area below.)
- G2. ☐ A community official completed Section E for a building located in Zone A (without a FEMA-issued or community-issued BFE) or Zone AO.
- G3. ☐ The following information (Items G4.-G9.) is provided for community floodplain management purposes.

G4. Permit Number FPUP# 07-283E	G5. Date Permit Issued	G6. Date Certificate Of Compliance/Occupancy Issued
---	------------------------	---

G7. This permit has been issued for: ☐ New Construction ☐ Substantial Improvement

G8. Elevation of as-built lowest floor (including basement) of the building: _____ feet _____ meters (PR) Datum _____

G9. BFE or (in Zone AO) depth of flooding at the building site: _____ feet _____ meters (PR) Datum _____

Local Official's Name	Title
Community Name	Telephone
Signature	Date
Comments	

☐ Check here if attachments

Def May 17 07

FPUP# 07-283E

Building Photographs

See Instructions for Item A6.

2005-70 49197

Building Street Address (including Apt., Unit, Suite, and/or Bldg. No.) or P.O. Route and Box No.			For Insurance Company Use:	
6131 N ELM TREE LANE			Policy Number	
City	State	ZIP Code	Company NAIC Number	
TUCSON	AZ	85705		



6131 ELM TREE LN
NW CORNER

NO
AC
6/14/07



6131 ELM TREE LN
SE CORNER

6/14/07



6131 ELM TREE LN
NE CORNER

6/14/07



6131 ELM TREE LN
SW CORNER

6/14/07

FPUP# 07-283E

Building Photographs

Continuation Page

For Insurance Company Use:

Building Street Address (including Apt., Unit, Suite, and/or Bldg. No.) or P.O. Route and Box No.

Policy Number

6131 N ELM TREE LANE

City
TUCSON

State
AZ

ZIP Code
85705

Company NAIC Number

If submitting more photographs than will fit on the preceding page, affix the additional photographs below. Identify all photographs with: date taken; "Front View" and "Rear View"; and, if required, "Right Side View" and "Left Side View."



6131 ELM TREE LN
NW CORNER

6/18/07