

FPUP# 07-777E P0 7 CP 09305

U.S. DEPARTMENT OF HOMELAND SECURITY
Federal Emergency Management Agency
National Flood Insurance Program

ELEVATION CERTIFICATE

Important: Read the instructions on pages 1-8.

OMB No. 1660-0008
Expires February 28, 2009

SECTION A - PROPERTY INFORMATION

A1. Building Owner's Name Gustavo Munoz		For Insurance Company Use:
A2. Building Street Address (including Apt., Unit, Suite, and/or Bldg. No.) or P.O. Route and Box No. 7940 S. Camno De Oeste		Policy Number
City Tucson State AZ ZIP Code		Company NAIC Number
A3. Property Description (Lot and Block Numbers, Tax Parcel Number, Legal Description, etc.) Tax Code 210-44-0830 Township 15S Range 12 Section 24		

A4. Building Use (e.g., Residential, Non-Residential, Addition, Accessory, etc.) **Residential: Manufactured Home**

A5. Latitude/Longitude: Lat. **32.1070** Long. **-111.0650** Horizontal Datum: ☐ NAD 1927 ☒ NAD 1983

A6. Attach at least 4 photographs of the building if the Certificate is being used to obtain flood insurance.

A7. Building Diagram Number **6**

A8. For a building with a crawl space or enclosure(s), provide: **2128**
a) Square footage of crawl space or enclosure(s) **2016** sq ft
b) No. of permanent flood openings in the crawl space or enclosure(s) walls within 1.0 foot above adjacent grade **25**
c) Total net area of flood openings in A8.b **3712** sq in

A9. For a building with an attached garage, provide:
a) Square footage of attached garage **N/A** sq ft
b) No. of permanent flood openings in the attached garage walls within 1.0 foot above adjacent grade **N/A**
c) Total net area of flood openings in A9.b **N/A** sq in

SECTION B - FLOOD INSURANCE RATE MAP (FIRM) INFORMATION

B1. NFIP Community Name & Community Number Pima County / 040073		B2. County Name Pima County		B3. State AZ	
B4. Map/Panel Number 04019C 2825	B5. Suffix K	B6. FIRM Index Date 2/8/99	B7. FIRM Panel Effective/Revised Date 2/8/99	B8. Flood Zone(s) A	B9. Base Flood Elevation(s) (Zone AO, use base flood depth) 1.0

B10. Indicate the source of the Base Flood Elevation (BFE) data or base flood depth entered in Item B9.
☐ FIS Profile ☒ FIRM ☐ Community Determined ☐ Other (Describe)

B11. Indicate elevation datum used for BFE in Item B9: ☐ NGVD 1929 ☐ NAVD 1988 ☒ Other (Describe) **Highest Adjacent Natural Grade**

B12. Is the building located in a Coastal Barrier Resources System (CBRS) area or Otherwise Protected Area (OPA)? ☐ Yes ☒ No
Designation Date **N/A** ☐ CBRS ☐ OPA

SECTION C - BUILDING ELEVATION INFORMATION (SURVEY REQUIRED)

C1. Building elevations are based on: ☐ Construction Drawings* ☐ Building Under Construction* ☒ Finished Construction
*A new Elevation Certificate will be required when construction of the building is complete.

C2. Elevations - Zones A1-A30, AE, AH, A (with BFE), VE, V1-V30, V (with BFE), AR, AR/A, AR/AE, AR/A1-A30, AR/AH, AR/AO. Complete Items C2.a-g below according to the building diagram specified in Item A7.

Benchmark Utilized **Local** Vertical Datum **0.00 = LAG ASSUMED**
Conversion/Comments **NONE**

Check the measurement used.

a) Top of bottom floor (including basement, crawl space, or enclosure floor) **0.3** ☒ feet ☐ meters (Puerto Rico only)

b) Top of the next higher floor **3.9** ☒ feet ☐ meters (Puerto Rico only)

c) Bottom of the lowest horizontal structural member (V Zones only) **N/A** ☒ feet ☐ meters (Puerto Rico only)

d) Attached garage (top of slab) **N/A** ☒ feet ☐ meters (Puerto Rico only)

e) Lowest elevation of machinery or equipment servicing the building (Describe type of equipment in Comments) **2.6** ☒ feet ☐ meters (Puerto Rico only)

f) Lowest adjacent (finished) grade (LAG) **ASSUMED 0.0** ☒ feet ☐ meters (Puerto Rico only)

g) Highest adjacent (finished) grade (HAG) **0.3** ☒ feet ☐ meters (Puerto Rico only)

When B.9 is a depth, indicate highest and lowest NATURAL grade in Section D Comments

SECTION D - SURVEYOR, ENGINEER, OR ARCHITECT CERTIFICATION

This certification is to be signed and sealed by a land surveyor, engineer, or architect authorized by law to certify elevation information. I certify that the information on this Certificate represents my best efforts to interpret the data available. I understand that any false statement may be punishable by fine or imprisonment under 18 U.S. Code, Section 1001.

☒ Check here if comments are provided on back of form.

Certifier's Name **EDGAR B. REYNOLDS JR** License Number **AZ 31031**

Title **LAND SURVEYOR** Company Name **EDGAR B. REYNOLDS**

Address **1926 W. CALLE MECEOURA** City **TUCSON** State **AZ** ZIP Code **85745**

Signature **[Signature]** Date **11/27/07** Telephone **520-884-0292**

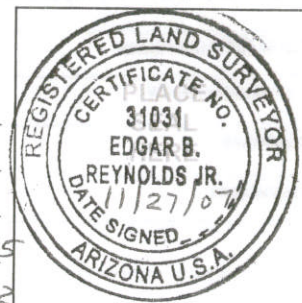

IMPORTANT: In these spaces, copy the corresponding information from Section A.		For Insurance Company Use:
Building Street Address (including Apt., Unit, Suite, and/or Bldg. No.) or P.O. Route and Box No. 7940 S. Camno De Oeste		Policy Number
City Tucson	State AZ	ZIP Code
		Company NAIC Number

SECTION D - SURVEYOR, ENGINEER, OR ARCHITECT CERTIFICATION (CONTINUED)

Copy both sides of this Elevation Certificate for (1) community official, (2) insurance agent/company, and (3) building owner.

Comments The lowest service equipment (C3.e) is the PIN COND. and the FURNACE, HOT WATER is/are above this elevation.
Highest adjacent Natural Grade is 0.3 Lowest adjacent Natural Grade is 0.0NEW MANUFACTURED HOME. BLOCK SKIRTED. THERE IS 2.0' BETWEEN
H.A.G. AND L.S.M. (BOTTOM STRUCTURAL BEAM) AC UNIT ON CONC. PLATFORM
Signature [Signature] Date 11/27/07 ☐ Check here if attachments**SECTION E - BUILDING ELEVATION INFORMATION (SURVEY NOT REQUIRED) FOR ZONE AO AND ZONE A (WITHOUT BFE)**

For Zones AO and A (without BFE), complete Items E1-E5. If the Certificate is intended to support a LOMA or LOMR-F request, complete Sections A, B, and C. For Items E1-E4, use natural grade, if available. Check the measurement used. In Puerto Rico only, enter meters.

- E1. Provide elevation information for the following and check the appropriate boxes to show whether the elevation is above or below the highest adjacent grade (HAG) and the lowest adjacent grade (LAG).
- a) Top of bottom floor (including basement, crawl space, enclosure) is _____ feet _____ meters ☐ above or ☐ below the HAG.
- b) Top of bottom floor (including basement, crawl space, enclosure) is _____ feet _____ meters ☐ above or ☐ below the LAG.
- E2. For Building Diagrams 6-8 with permanent flood openings provided in Section A Items 3 and 9 (see page 8 of Instructions), the next higher floor (elevation C2.b in the diagrams) of the building is _____ feet _____ meters ☐ above or ☐ below the HAG.
- E3. Attached garage (top of slab) is _____ feet _____ meters ☐ above or ☐ below the HAG.
- E4. Top of platform of machinery and/or equipment servicing the building is _____ feet _____ meters ☐ above or ☐ below the HAG.
- E5. Zone AO only: If no flood depth number is available, is the top of the bottom floor elevated in accordance with the community's floodplain management ordinance? ☐ Yes ☐ No ☐ Unknown. The local official must certify this information in Section G.

SECTION F - PROPERTY OWNER (OR OWNER'S REPRESENTATIVE) CERTIFICATION

The property owner or owner's authorized representative who completes Sections A, B, and E for Zone A (without a FEMA-issued or community-issued BFE) or Zone AO must sign here. The statements in Sections A, B, and E are correct to the best of my knowledge.

Property Owner's or Owner's Authorized Representative's Name

Address

City

State

ZIP Code

Signature

Date

Telephone

Comments

☐ Check here if attachments**SECTION G - COMMUNITY INFORMATION (OPTIONAL)**

The local official who is authorized by law or ordinance to administer the community's floodplain management ordinance can complete Sections A, B, C (or E), and G of this Elevation Certificate. Complete the applicable item(s) and sign below. Check the measurement used in Items G8. and G9.

- G1. ☐ The information in Section C was taken from other documentation that has been signed and sealed by a licensed surveyor, engineer, or architect who is authorized by law to certify elevation information. (Indicate the source and date of the elevation data in the Comments area below.)
- G2. ☐ A community official completed Section E for a building located in Zone A (without a FEMA-issued or community-issued BFE) or Zone AO.
- G3. ☐ The following information (Items G4.-G9.) is provided for community floodplain management purposes.

G4. Permit Number FPUP# 07-777E	G5. Date Permit Issued	G6. Date Certificate Of Compliance/Occupancy Issued
------------------------------------	------------------------	-----------------------------------------------------

G7. This permit has been issued for: ☐ New Construction ☐ Substantial Improvement

G8. Elevation of as-built lowest floor (including basement) of the building: _____ feet _____ meters (PR) Datum _____

G9. BFE or (in Zone AO) depth of flooding at the building site: _____ feet _____ meters (PR) Datum _____

Local Official's Name _____ Title _____

Community Name _____ Telephone _____

Signature _____ Date _____

Comments _____

☐ Check here if attachments

FPUP# 07-777E

Building Photographs (Four Color Photographs Required)

See Instructions for Item A6.

Building Street Address (including Apt., Unit, Suite, and/or Bldg. No.) or P.O. Route and Box No. 7940 S. Camno De Oeste			For Insurance Company Use: Policy Number
City Tucson	State AZ	ZIP Code	Company NAIC Number



Insurance, at
date taken
photographs



7940 S. CAM DE OESTE
NW COR 11/27/07

7940 S. CAM DE OESTE
NE CORNER 11/27/07



7940 S. CAM DE OESTE
SW COR 11/27/07

7940 S. CAM DE OESTE
SE COR 11/27/07