

FPUP# 08180E P0 8 CP 01399

U.S. DEPARTMENT OF HOMELAND SECURITY
Federal Emergency Management Agency
National Flood Insurance Program

ELEVATION CERTIFICATE

Important: Read the instructions on pages 1-8.

OMB No. 1660-0008
Expires February 28, 2009

SECTION A - PROPERTY INFORMATION

| | | | |
|---|--------------------|---|--|
| A1. Building Owner's Name Jason and Samantha Jepson | | For Insurance Company Use: Policy Number | |
| A2. Building Street Address (including Apt., Unit, Suite, and/or Bldg. No.) or P.O. Route and Box No. 9980 East Andrada | | Company NAIC Number | |
| City Tucson | State AZ | ZIP Code 85641 | |
| A3. Property Description (Lot and Block Numbers, Tax Parcel Number, Legal Description, etc.) Tax Code 305-85-069E Township 17 Range 15 Section 02 | | | |

A4. Building Use (e.g., Residential, Non-Residential, Addition, Accessory, etc.) **Residential: Manufactured Home Replacement**

A5. Latitude/Longitude: Lat. **32.990239** Long. **-110.779449** Horizontal Datum: ☐ NAD 1927 ☒ NAD 1983

A6. Attach at least 2 photographs of the building if the Certificate is being used to obtain flood insurance.

A7. Building Diagram Number **6**

A8. For a building with a crawl space or enclosure(s), provide:

- a) Square footage of crawl space or enclosure(s) **1643** sq ft
- b) No. of permanent flood openings in the crawl space or enclosure(s) walls within 1.0 foot above adjacent grade **4**
- c) Total net area of flood openings in A8.b **3072** sq in

A9. For a building with an attached garage, provide:

- a) Square footage of attached garage **N/A** sq ft
- b) No. of permanent flood openings in the attached garage walls within 1.0 foot above adjacent grade **N/A**
- c) Total net area of flood openings in A9.b **N/A** sq in

SECTION B - FLOOD INSURANCE RATE MAP (FIRM) INFORMATION

| | | | | | |
|---|------------------------|---------------------------------------|--|-------------------------------|--|
| B1. NFIP Community Name & Community Number Pima County / 040073 | | B2. County Name Pima County | | B3. State AZ | |
| B4. Map/Panel Number 04019C 3450 | B5. Suffix K | B6. FIRM Index Date 2/8/99 | B7. FIRM Panel Effective/Revised Date 2/8/99 | B8. Flood Zone(s) X | B9. Base Flood Elevation(s) (Zone AO, use base flood depth) 0.5 ft |

B10. Indicate the source of the Base Flood Elevation (BFE) data or base flood depth entered in Item B9.
☐ FIS Profile ☐ FIRM ☒ Community Determined ☐ Other (Describe)

B11. Indicate elevation datum used for BFE in Item B9: ☐ NGVD 1929 ☐ NAVD 1988 ☒ Other (Describe) **Highest Adjacent Natural Grade**

B12. Is the building located in a Coastal Barrier Resources System (CBRS) area or Otherwise Protected Area (OPA)? ☐ Yes ☒ No
Designation Date **N/A** ☐ CBRS ☐ OPA

SECTION C - BUILDING ELEVATION INFORMATION (SURVEY REQUIRED)

C1. Building elevations are based on: ☐ Construction Drawings* ☐ Building Under Construction* ☒ Finished Construction
*A new Elevation Certificate will be required when construction of the building is complete.

C2. Elevations - Zones A1-A30, AE, AH, A (with BFE), VE, V1-V30, V (with BFE), AR, AR/A, AR/AE, AR/A1-A30, AR/AH, AR/AO. Complete Items C2.a-g below according to the building diagram specified in Item A7.

Benchmark Utilized **Local** Vertical Datum **0.00 = L.A.G.**

Conversion/Comments **None**

Check the measurement used.

- a) Top of bottom floor (including basement, crawl space, or enclosure floor) **0.8** ☒ feet ☐ meters (Puerto Rico only)
- b) Top of the next higher floor **3.8** ☒ feet ☐ meters (Puerto Rico only)
- c) Bottom of the lowest horizontal structural member (V Zones only) **N/A** ☒ feet ☐ meters (Puerto Rico only)
- d) Attached garage (top of slab) **N/A** ☒ feet ☐ meters (Puerto Rico only)
- e) Lowest elevation of machinery or equipment servicing the building (Describe type of equipment in Comments) **2.6** ☒ feet ☐ meters (Puerto Rico only)
- f) Lowest adjacent (finished) grade (LAG) **0.0** ☒ feet ☐ meters (Puerto Rico only)
- g) Highest adjacent (finished) grade (HAG) **0.8** ☒ feet ☐ meters (Puerto Rico only)

When B.9 is a depth above grade, it is required to indicate highest and lowest NATURAL grade in Section D Comments

SECTION D - SURVEYOR, ENGINEER,

CERTIFICATION

This certification is to be signed and sealed by a land surveyor, engineer, or architect authorized by law to certify elevation information. I certify that the information on this Certificate represents my best efforts to interpret the data available. I understand that any false statement may be punishable by fine or imprisonment under 18 U.S. Code, Section 1001.

☒ Check here if comments are provided on back of form.

| | | | |
|--|--|-----------------------------------|--------------------------|
| Certifier's Name Edgar B. Reynolds Jr. | | License Number AZ 31031 | |
| Title Land Surveyor | Company Name Edgar Reynolds and Associates | | |
| Address 1926 W. Calle Mission Tucson | City Tucson | State AZ | ZIP Code 85745 |
| Signature [Signature] | Date 5-7-08 | Telephone 520-884-0292 | |

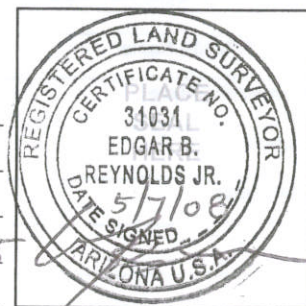

| | | |
|---|--------------------|----------------------------|
| IMPORTANT: In these spaces, copy the corresponding information from Section A. | | For Insurance Company Use: |
| Building Street Address (including Apt., Unit, Suite, and/or Bldg. No.) or P.O. Route and Box No. 9980 East Andrada | | Policy Number |
| City Tucson | State AZ | ZIP Code 85641 |
| | | Company NAIC Number |

SECTION D - SURVEYOR, ENGINEER, OR ARCHITECT CERTIFICATION (CONTINUED)

Copy both sides of this Elevation Certificate for (1) community official, (2) insurance agent/company, and (3) building owner.

Comments The lowest service equipment (C3.e) is the Air Cond and the Furnace Water Heater is/are above this elevation.Highest adjacent natural grade is 0.8 Lowest adjacent natural grade is 0.00NEW MANUFACTURED HOME SET UP BLOCK SKINDED THERE IS 1.5' BETWEEN
H.A.G. AND L.S.M. AC UNIT ON BLOCK STANDSignature [Signature] Date 5-7-08 ☐ Check here if attachments**SECTION E - BUILDING ELEVATION INFORMATION (SURVEY NOT REQUIRED) FOR ZONE AO AND ZONE A (WITHOUT BFE)**

For Zones AO and A (without BFE), complete Items E1-E5. If the Certificate is intended to support a LOMA or LOMR-F request, complete Sections A, B, and C. For Items E1-E4, use natural grade, if available. Check the measurement used. In Puerto Rico only, enter meters.

- E1. Provide elevation information for the following and check the appropriate boxes to show whether the elevation is above or below the highest adjacent grade (HAG) and the lowest adjacent grade (LAG).
- a) Top of bottom floor (including basement, crawl space, enclosure) is _____ feet _____ meters ☐ above or ☐ below the HAG.
- b) Top of bottom floor (including basement, crawl space, enclosure) is _____ feet _____ meters ☐ above or ☐ below the LAG.
- E2. For Building Diagrams 6-8 with permanent flood openings provided in Section A Items 6 and 9 (see page 8 of Instructions), the next higher floor (elevation C2.b in the diagrams) of the building is _____ feet _____ meters ☐ above or ☐ below the HAG.
- E3. Attached garage (top of slab) is _____ feet _____ meters ☐ above or ☐ below the HAG.
- E4. Top of platform of machinery and/or equipment servicing the building is _____ feet _____ meters ☐ above or ☐ below the HAG.
- E5. Zone AO only: If no flood depth number is available, is the top of the bottom floor elevated in accordance with the community's floodplain management ordinance? ☐ Yes ☐ No ☐ Unknown. The local official must certify this information in Section G.

SECTION F - PROPERTY OWNER (OR OWNER'S REPRESENTATIVE) CERTIFICATION

The property owner or owner's authorized representative who completes Sections A, B, and E for Zone A (without a FEMA-issued or community-issued BFE) or Zone AO must sign here. The statements in Sections A, B, and E are correct to the best of my knowledge.

Property Owner's or Owner's Authorized Representative's Name

Address _____ City _____ State _____ ZIP Code _____

Signature _____ Date _____ Telephone _____

Comments _____

☐ Check here if attachments**SECTION G - COMMUNITY INFORMATION (OPTIONAL)**

The local official who is authorized by law or ordinance to administer the community's floodplain management ordinance can complete Sections A, B, C (or E), and G of this Elevation Certificate. Complete the applicable item(s) and sign below. Check the measurement used in Items G8. and G9.

- G1. ☐ The information in Section C was taken from other documentation that has been signed and sealed by a licensed surveyor, engineer, or architect who is authorized by law to certify elevation information. (Indicate the source and date of the elevation data in the Comments area below.)
- G2. ☐ A community official completed Section E for a building located in Zone A (without a FEMA-issued or community-issued BFE) or Zone AO.
- G3. ☐ The following information (Items G4.-G9.) is provided for community floodplain management purposes.

| | | |
|--|------------------------|---|
| G4. Permit Number FPUP# 08180E | G5. Date Permit Issued | G6. Date Certificate Of Compliance/Occupancy Issued |
|--|------------------------|---|

G7. This permit has been issued for: ☐ New Construction ☐ Substantial Improvement

G8. Elevation of as-built lowest floor (including basement) of the building: _____ feet _____ meters (PR) Datum _____

G9. BFE or (in Zone AO) depth of flooding at the building site: _____ feet _____ meters (PR) Datum _____

Local Official's Name _____ Title _____

Community Name _____ Telephone _____

Signature _____ Date _____

Comments _____

☐ Check here if attachments

FPUP# 08180E

Building Photographs

Continuation Page

| | | | |
|---|--------------------|--------------------------|---|
| Building Street Address (including Apt., Unit, Suite, and/or Bldg. No.) or P.O. Route and Box No. 9980 East Andrada | | | For Insurance Company Use: Policy Number |
| City Tucson | State AZ | ZIP Code 85641 | Company NAIC Number |

If submitting more photographs than will fit on the preceding page, affix the additional photographs below. Identify all photographs with: date taken; "Front View" and "Rear View"; and, if required, "Right Side View" and "Left Side View."



FPUP# 08180E

Building Photographs(Four Color Photographs Required)

See Instructions for Item A6.

| | | | |
|---|--------------------|--------------------------|---|
| Building Street Address (including Apt., Unit, Suite, and/or Bldg. No.) or P.O. Route and Box No. 9980 East Andrada | | | For Insurance Company Use: Policy Number |
| City Tucson | State AZ | ZIP Code 85641 | Company NAIC Number |

If using the Elevation Certificate to obtain NFIP flood insurance, affix at least **Four** building photographs below according to the instructions for Item A6. Identify all photographs with: date taken; "Front View" and "Rear View"; and, if required, "Right Side View" and "Left Side View." If submitting more photographs than will fit on this page, use the Continuation Page, following.

