

## ELEVATION CERTIFICATE

Important: Read the instructions on pages 1-9.

OMB No. 1660-0008  
Expires March 31, 2012

## SECTION A - PROPERTY INFORMATION

A1. Building Owner's Name <b>Tony Callaway</b>		For Insurance Company Use:	
		Policy Number	
A2. Building Street Address (including Apt., Unit, Suite, and/or Bldg. No.) or P.O. Route and Box No. <b>9010 W. Safford</b>		Company NAIC Number	
City <b>Marana</b>	State <b>AZ</b>	ZIP Code <b>85653</b>	
A3. Property Description (Lot and Block Numbers, Tax Parcel Number, Legal Description, etc.) <b>Tax Code 216-15-023A Township 12 Range 12 Section 7</b>			
A4. Building Use (e.g., Residential, Non-Residential, Addition, Accessory, etc.) <b>Accessory: Detached Garage</b>			
A5. Latitude/Longitude: Lat. <b>32.399573</b> Long. <b>-111.158190</b>		Horizontal Datum: <input type="checkbox"/> NAD 1927 <input checked="" type="checkbox"/> NAD 1983	
A6. Attach at least 2 photographs of the building if the Certificate is being used to obtain flood insurance.			
A7. Building Diagram Number <b>1A</b>			
A8. For a building with a crawlspace or enclosure(s):		A9. For a building with an attached garage:	
a) Square footage of crawlspace or enclosure(s) <b>1080</b> sq ft	a) Square footage of attached garage <b>NA</b> sq ft		
b) No. of permanent flood openings in the crawlspace or enclosure(s) within 1.0 foot above adjacent grade <b>8</b>	b) No. of permanent flood openings in the attached garage within 1.0 foot above adjacent grade <b>NA</b>		
c) Total net area of flood openings in A8.b <b>1152</b> sq in	c) Total net area of flood openings in A9.b <b>NA</b> sq in		
d) Engineered flood openings? <input type="checkbox"/> Yes <input checked="" type="checkbox"/> No	d) Engineered flood openings? <input type="checkbox"/> Yes <input checked="" type="checkbox"/> No		

## SECTION B - FLOOD INSURANCE RATE MAP (FIRM) INFORMATION

B1. NFIP Community Name & Community Number <b>Pima County / 040073</b>		B2. County Name <b>Pima County</b>		B3. State <b>AZ</b>	
B4. Map/Panel Number <b>04019C 0995</b>	B5. Suffix <b>K</b>	B6. FIRM Index Date <b>2/8/99</b>	B7. FIRM Panel Effective/Revised Date <b>2/8/99</b>	B8. Flood Zone(s) <b>AO1</b>	B9. Base Flood Elevation(s) (Zone AO, use base flood depth) <b>1.0</b>
B10. Indicate the source of the Base Flood Elevation (BFE) data or base flood depth entered in Item B9. <input type="checkbox"/> FIS Profile <input checked="" type="checkbox"/> FIRM <input type="checkbox"/> Community Determined <input type="checkbox"/> Other (Describe)					
B11. Indicate elevation datum used for BFE in Item B9: <input type="checkbox"/> NGVD 1929 <input type="checkbox"/> NAVD 1988 <input type="checkbox"/> Other (Describe) <b>Highest Adjacent Natural Grade</b>					
B12. Is the building located in a Coastal Barrier Resources System (CBRS) area or Otherwise Protected Area (OPA)? <input type="checkbox"/> Yes <input checked="" type="checkbox"/> No Designation Date <b>N/A</b> <input type="checkbox"/> CBRS <input type="checkbox"/> OPA					

## SECTION C - BUILDING ELEVATION INFORMATION (SURVEY REQUIRED)

C1. Building elevations are based on: ☐ Construction Drawings\* ☐ Building Under Construction\* ☒ Finished Construction  
\*A new Elevation Certificate will be required when construction of the building is complete.

C2. Elevations - Zones A1-A30, AE, AH, A (with BFE), VE, V1-V30, V (with BFE), AR, AR/A, AR/AE, AR/A1-A30, AR/AH, AR/AO. Complete Items C2.a-h below according to the building diagram specified in Item A7. Use the same datum as the BFE.  
Benchmark Utilized **FINISH FLOOR - EXISTING CONCRETE** Vertical Datum **ASSUME 100.00**  
Conversion/Comments **None**

	Check the measurement used.
a) Top of bottom floor (including basement, crawlspace, or enclosure floor) <b>100.00</b> <input checked="" type="checkbox"/> feet	<input type="checkbox"/> meters (Puerto Rico only)
b) Top of the next higher floor <b>NA</b> <input checked="" type="checkbox"/> feet	<input type="checkbox"/> meters (Puerto Rico only)
c) Bottom of the lowest horizontal structural member (V Zones only) <b>NA</b> <input checked="" type="checkbox"/> feet	<input type="checkbox"/> meters (Puerto Rico only)
d) Attached garage (top of slab) <b>NA</b> <input checked="" type="checkbox"/> feet	<input type="checkbox"/> meters (Puerto Rico only)
e) Lowest elevation of machinery or equipment servicing the building (Describe type of equipment and location in Comments) <b>NA</b> <input checked="" type="checkbox"/> feet	<input type="checkbox"/> meters (Puerto Rico only)
f) Lowest adjacent (finished) grade next to building (LAG) <b>99.3</b> <input checked="" type="checkbox"/> feet	<input type="checkbox"/> meters (Puerto Rico only)
g) Highest adjacent (finished) grade next to building (HAG) <b>99.5</b> <input checked="" type="checkbox"/> feet	<input type="checkbox"/> meters (Puerto Rico only)
h) Lowest adjacent grade at lowest elevation of deck or stairs, including structural support <b>NA</b> <input checked="" type="checkbox"/> feet	<input type="checkbox"/> meters (Puerto Rico only)

## SECTION D - SURVEYOR, ENGINEER, OR ARCHITECT CERTIFICATION

This certification is to be signed and sealed by a land surveyor, engineer, or architect authorized by law to certify elevation information. I certify that the information on this Certificate represents my best efforts to interpret the data available. I understand that any false statement may be punishable by fine or imprisonment under 18 U.S. Code, Section 1001.

☐ Check here if comments are provided on back of form.Were latitude and longitude in Section A provided by a licensed land surveyor? ☐ Yes ☐ No

Certifier's Name <b>JEFF ANDERSON</b>	License Number <b>RLS 21751</b>
Title <b>PROF.</b>	Company Name <b>(92) LAND SURVEY</b>
Address <b>205 S. VOZACK LN</b>	City <b>TUCSON</b>
State <b>AZ</b>	ZIP Code <b>85748</b>
Signature <b>[Signature]</b>	Date <b>5/3/10</b>
Telephone <b>520-296-9083</b>	

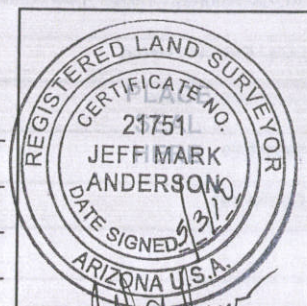



<b>IMPORTANT: In these spaces, copy the corresponding information from Section A.</b>		For Insurance Company Use:
Building Street Address (including Apt., Unit, Suite, and/or Bldg. No.) or P.O. Route and Box No. <b>9010 W. Safford</b>		Policy Number
City <b>Marana</b>	State <b>AZ</b>	ZIP Code <b>85653</b>
		Company NAIC Number

**SECTION D - SURVEYOR, ENGINEER, OR ARCHITECT CERTIFICATION (CONTINUED)**

Copy both sides of this Elevation Certificate for (1) community official, (2) insurance agent/company, and (3) building owner.

Comments The lowest service equipment (C2.e) is the NA and the NA is/are above this elevation.  
Highest adjacent natural grade is 99.5 Lowest adjacent natural grade is 99.3Signature [Signature]Date 5/3/10☐ Check here if attachments**SECTION E - BUILDING ELEVATION INFORMATION (SURVEY NOT REQUIRED) FOR ZONE AO AND ZONE A (WITHOUT BFE)**

For Zones AO and A (without BFE), complete Items E1-E5. If the Certificate is intended to support a LOMA or LOMR-F request, complete Sections A, B, and C. For Items E1-E4, use natural grade, if available. Check the measurement used. In Puerto Rico only, enter meters.

- E1. Provide elevation information for the following and check the appropriate boxes to show whether the elevation is above or below the highest adjacent grade (HAG) and the lowest adjacent grade (LAG).  
a) Top of bottom floor (including basement, crawlspace, or enclosure) is NA feet ☐ meters ☐ above or ☐ below the HAG.  
b) Top of bottom floor (including basement, crawlspace, or enclosure) is NA feet ☐ meters ☐ above or ☐ below the LAG.
- E2. For Building Diagrams 6-9 with permanent flood openings provided in Section A Items 3 and 9 (see pages 8-9 of Instructions), the next higher floor (elevation C2.b in the diagrams) of the building is NA feet ☐ meters ☐ above or ☐ below the HAG.
- E3. Attached garage (top of slab) is NA feet ☐ meters ☐ above or ☐ below the HAG.
- E4. Top of platform of machinery and/or equipment servicing the building is NA feet ☐ meters ☐ above or ☐ below the HAG.
- E5. Zone AO only: If no flood depth number is available, is the top of the bottom floor elevated in accordance with the community's floodplain management ordinance? ☐ Yes ☐ No ☐ Unknown. The local official must certify this information in Section G.

**SECTION F - PROPERTY OWNER (OR OWNER'S REPRESENTATIVE) CERTIFICATION**

The property owner or owner's authorized representative who completes Sections A, B, and E for Zone A (without a FEMA-issued or community-issued BFE) or Zone AO must sign here. The statements in Sections A, B, and E are correct to the best of my knowledge.

Property Owner's or Owner's Authorized Representative's Name NAAddress NACity NAState NAZIP Code NASignature NADate NATelephone NAComments NA☐ Check here if attachments**SECTION G - COMMUNITY INFORMATION (OPTIONAL)**

The local official who is authorized by law or ordinance to administer the community's floodplain management ordinance can complete Sections A, B, C (or E), and G of this Elevation Certificate. Complete the applicable item(s) and sign below. Check the measurement used in Items G8 and G9.

- G1. ☐ The information in Section C was taken from other documentation that has been signed and sealed by a licensed surveyor, engineer, or architect who is authorized by law to certify elevation information. (Indicate the source and date of the elevation data in the Comments area below.)
- G2. ☐ A community official completed Section E for a building located in Zone A (without a FEMA-issued or community-issued BFE) or Zone AO.
- G3. ☐ The following information (Items G4-G9) is provided for community floodplain management purposes.

G4. Permit Number <b>FPUP# 09-081E</b>	G5. Date Permit Issued	G6. Date Certificate Of Compliance/Occupancy Issued
---	------------------------	---

G7. This permit has been issued for: ☐ New Construction ☐ Substantial ImprovementG8. Elevation of as-built lowest floor (including basement) of the building NA feet ☐ meters (PR) Datum NAG9. BFE or (in Zone AO) depth of flooding at the building site NA feet ☐ meters (PR) Datum NAG10. Community's design flood elevation NA feet ☐ meters (PR) Datum NALocal Official's Name NATitle NACommunity Name NATelephone NASignature NADate NAComments NA☐ Check here if attachments



FPUP# 09-081E

## Building Photographs

Continuation Page

Building Street Address (including Apt., Unit, Suite, and/or Bldg. No.) or P.O. Route and Box No.

9010 W. Safford

City  
Marana

State  
AZ

ZIP Code  
85653

For Insurance Company Use:

Policy Number

Company NAIC Number

If submitting more photographs than will fit on the preceding page, affix the additional photographs below. Identify all photographs with: date taken; "Front View" and "Rear View"; and, if required, "Right Side View" and "Left Side View."

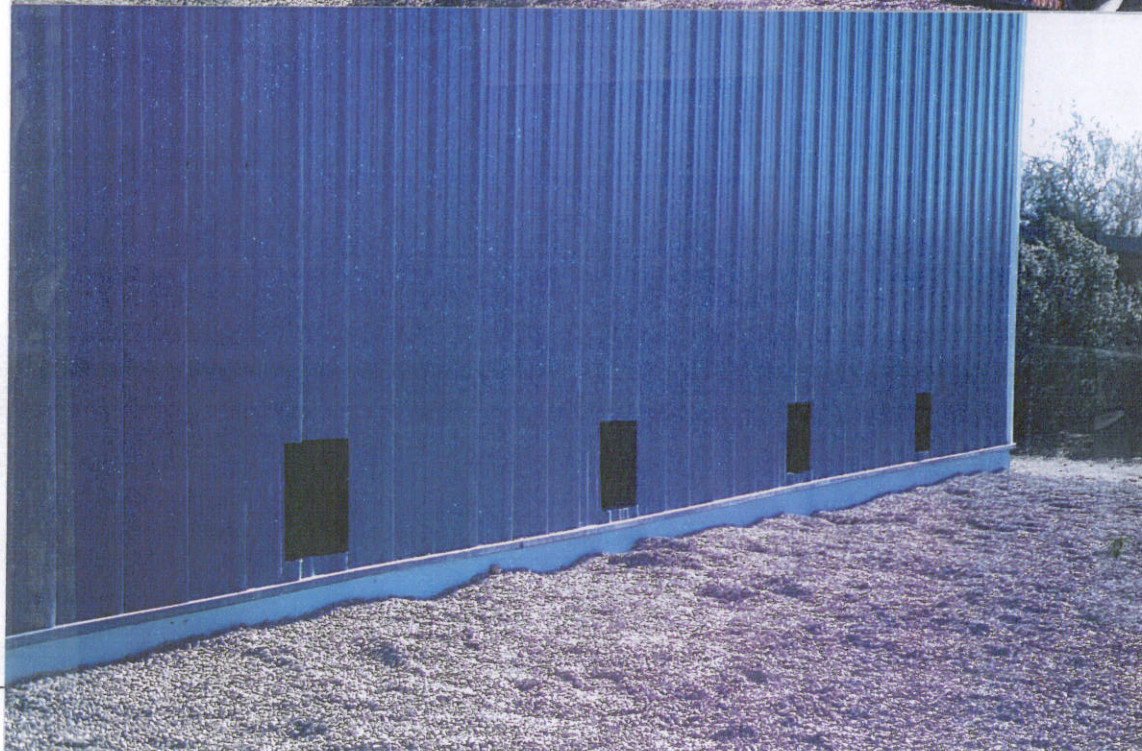
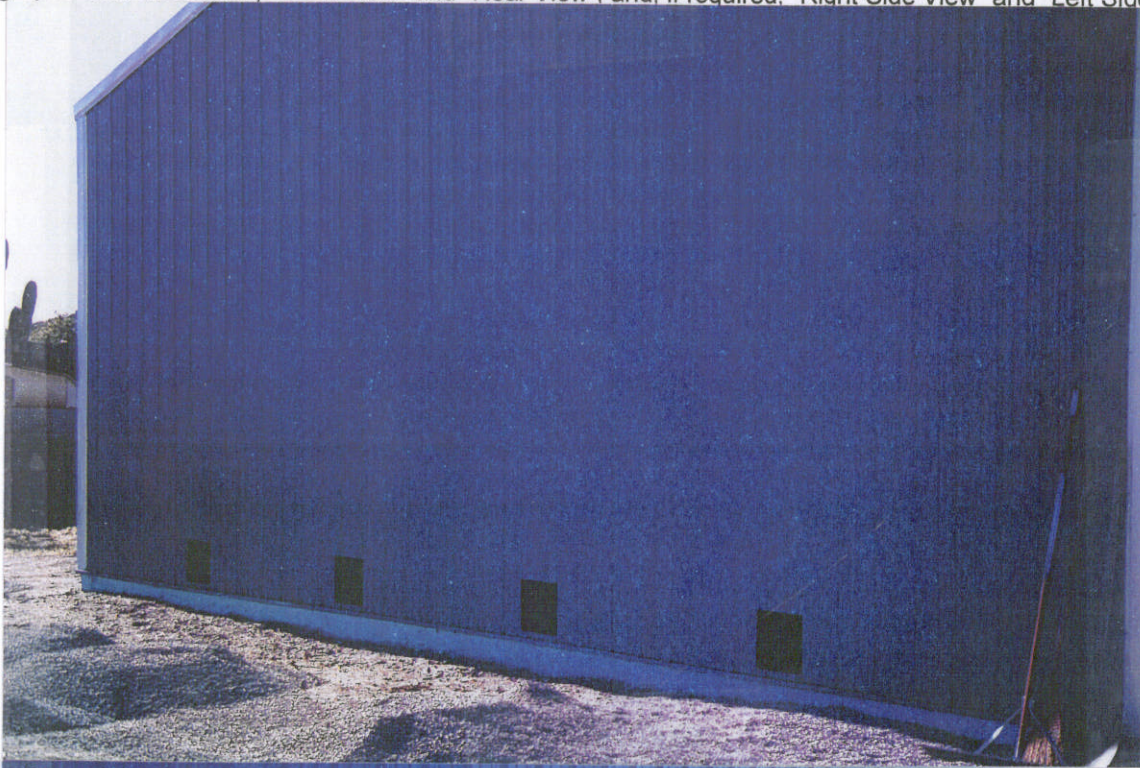



FPUP# 09-081E

## Building Photographs(Four Color Photographs Required)

See Instructions for Item A6.

Building Street Address (including Apt., Unit, Suite, and/or Bldg. No.) or P.O. Route and Box No. <b>9010 W. Safford</b>			For Insurance Company Use: Policy Number
City <b>Marana</b>	State <b>AZ</b>	ZIP Code <b>85653</b>	Company NAIC Number

If using the Elevation Certificate to obtain NFIP flood insurance, affix at least **Four** building photographs below according to the instructions for Item A6. Identify all photographs with: date taken; "Front View" and "Rear View"; and, if required, "Right Side View" and "Left Side View." If submitting more photographs than will fit on this page, use the Continuation Page on the reverse.

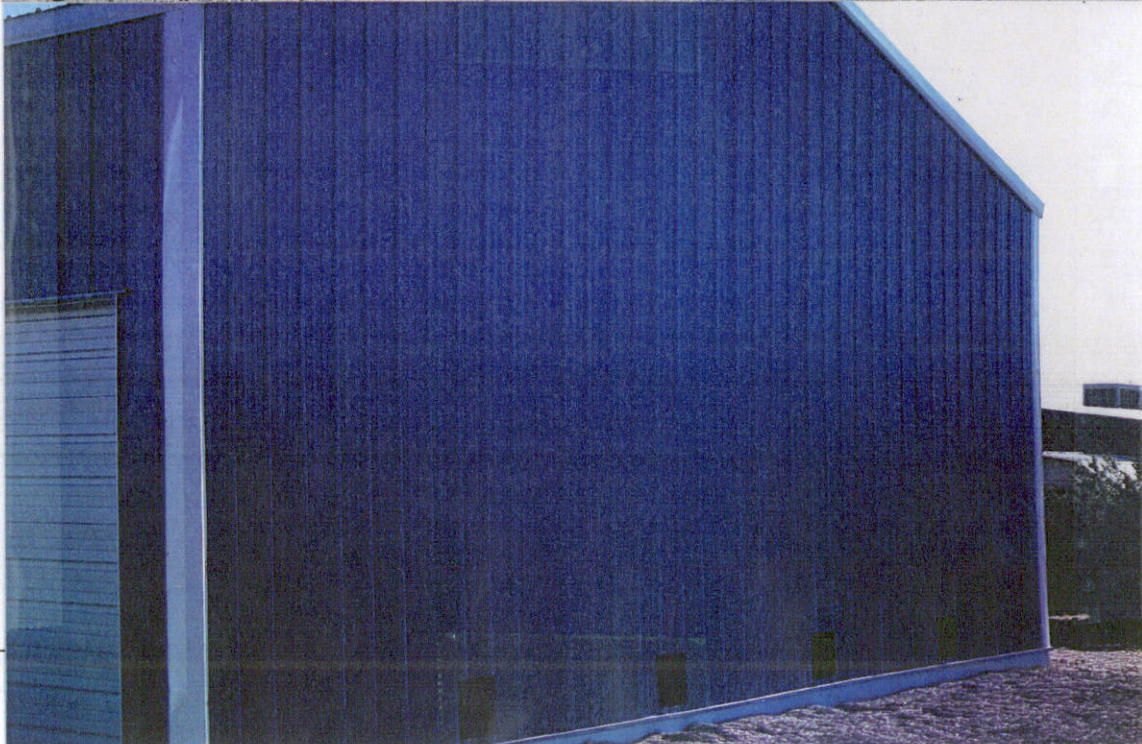
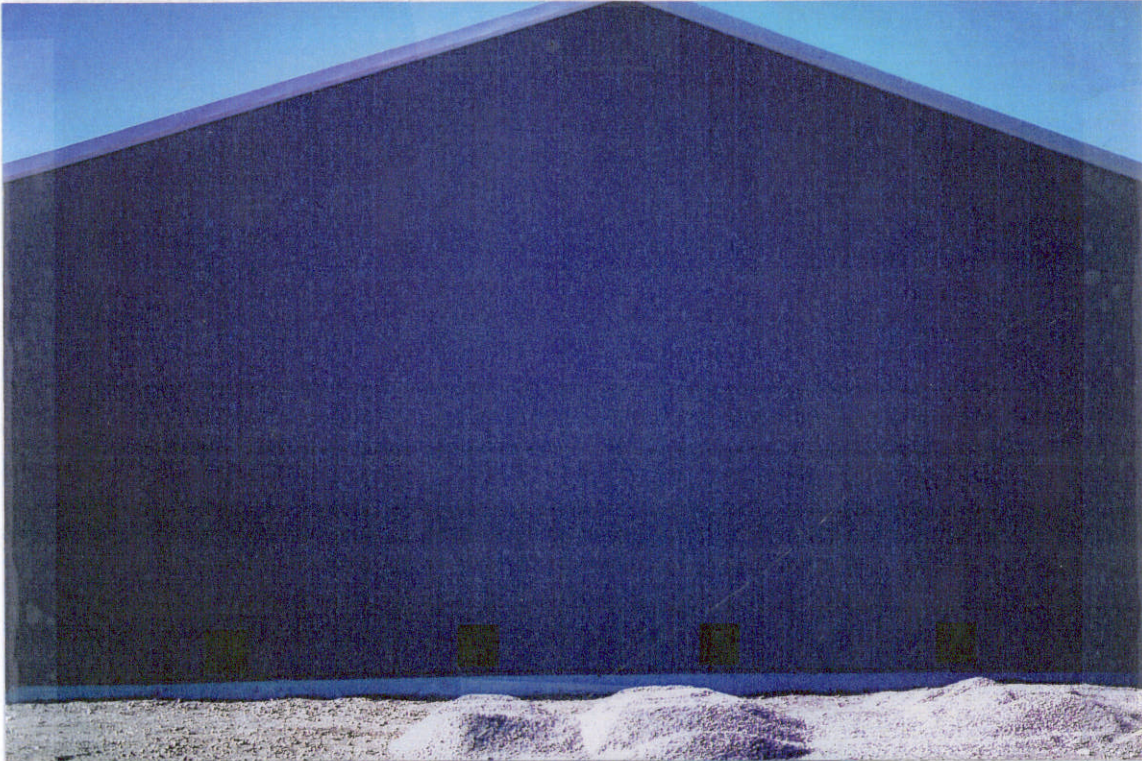



FPUP# 09-081E

## Building Photographs(Four Color Photographs Required)

See Instructions for Item A6.

Building Street Address (including Apt., Unit, Suite, and/or Bldg. No.) or P.O. Route and Box No. <b>9010 W. Safford</b>			For Insurance Company Use: Policy Number
City <b>Marana</b>	State <b>AZ</b>	ZIP Code <b>85653</b>	Company NAIC Number

If using the Elevation Certificate to obtain NFIP flood insurance, affix at least **Four** building photographs below according to the instructions for Item A6. Identify all photographs with: date taken; "Front View" and "Rear View"; and, if required, "Right Side View" and "Left Side View." If submitting more photographs than will fit on this page, use the Continuation Page on the reverse.

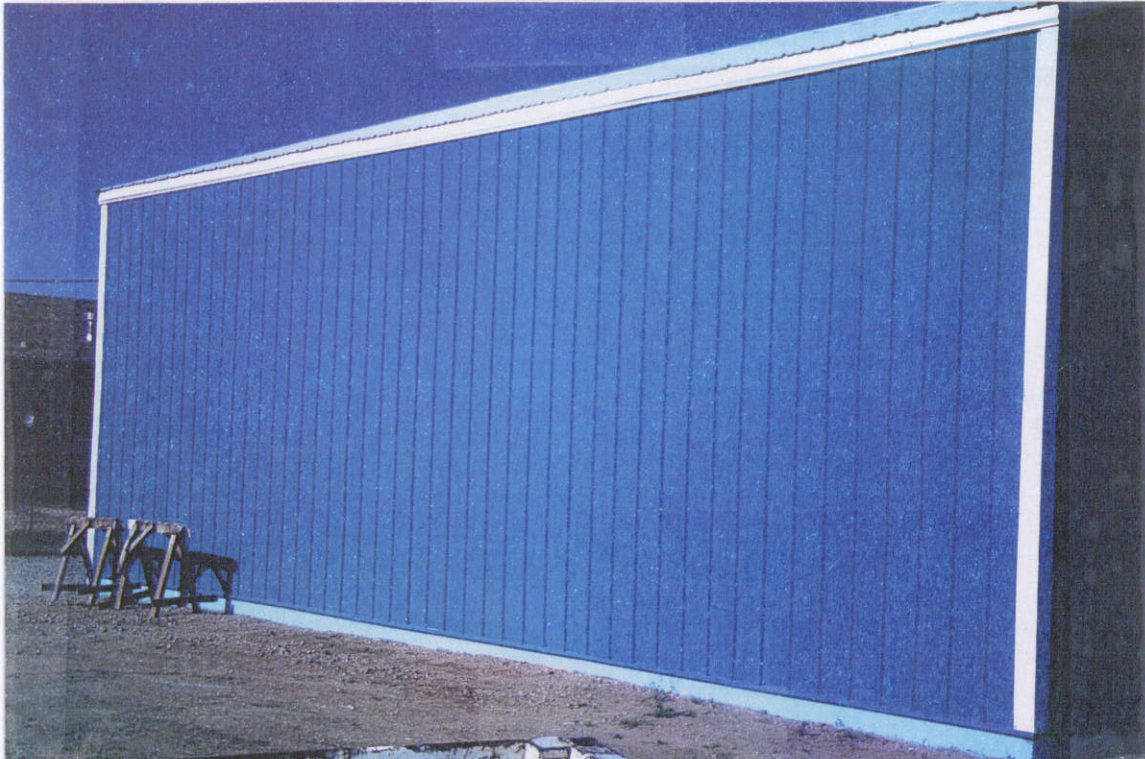



FPUP# 09-081E

## Building Photographs

Continuation Page

Building Street Address (including Apt., Unit, Suite, and/or Bldg. No.) or P.O. Route and Box No. <b>9010 W. Safford</b>			For Insurance Company Use: Policy Number
City <b>Marana</b>	State <b>AZ</b>	ZIP Code <b>85653</b>	Company NAIC Number

If submitting more photographs than will fit on the preceding page, affix the additional photographs below. Identify all photographs with: date taken; "Front View" and "Rear View"; and, if required, "Right Side View" and "Left Side View."

