

ELEVATION CERTIFICATE

Important: Read the instructions on pages 1-8.

OMB No. 1660-0008
Expires February 28, 2009

SECTION A - PROPERTY INFORMATION		For Insurance Company Use:
A1. Building Owner's Name PIAR NANCY SUE & JAMES		Policy Number
A2. Building Street Address (including Apt., Unit, Suite, and/or Bldg. No.) or P.O. Route and Box No. 6560 W EMJAY AVE		Company NAIC Number
City TUCSON	State AZ	ZIP Code 85746
A3. Property Description (Lot and Block Numbers, Tax Parcel Number, Legal Description, etc.) Tax Code 212-46-2190 Township 14S Range 12E Section 34		
A4. Building Use (e.g., Residential, Non-Residential, Addition, Accessory, etc.) Residential: Manufactured Home Replacement		
A5. Latitude/Longitude: Lat. 32.174414 Long. -111.104499 Horizontal Datum: <input type="checkbox"/> NAD 1927 <input checked="" type="checkbox"/> NAD 1983		
A6. Attach at least 4 photographs of the building if the Certificate is being used to obtain flood insurance.		
A7. Building Diagram Number 6		
A8. For a building with a crawl space or enclosure(s), provide: a) Square footage of crawl space or enclosure(s) 1792 sq ft b) No. of permanent flood openings in the crawl space or enclosure(s) walls within 1.0 foot above adjacent grade 19 c) Total net area of flood openings in A8.b 5156 sq in		
A9. For a building with an attached garage, provide: a) Square footage of attached garage NA sq ft b) No. of permanent flood openings in the attached garage walls within 1.0 foot above adjacent grade NA c) Total net area of flood openings in A9.b NA sq in		

SECTION B - FLOOD INSURANCE RATE MAP (FIRM) INFORMATION

R1 NFIP Community Name & Community Number Pima County / 040073		B2. County Name Pima County		B3. State AZ	
B4. Map/Panel Number 04019C	B5. Suffix K	B6. FIRM Index Date 2/8/99	B7. FIRM Panel Effective/Revised Date 2/8/99	B8. Flood Zone(s) X	B9. Base Flood Elevation(s) (Zone AO, use base flood depth) 0.5
B10. Indicate the source of the Base Flood Elevation (BFE) data or base flood depth entered in Item B9. <input type="checkbox"/> FIS Profile <input type="checkbox"/> FIRM <input checked="" type="checkbox"/> Community Determined <input type="checkbox"/> Other (Describe)					
B11. Indicate elevation datum used for BFE in Item B9: <input type="checkbox"/> NGVD 1929 <input type="checkbox"/> NAVD 1988 <input type="checkbox"/> Other (Describe) Highest Adjacent Natural Grade					
B12. Is the building located in a Coastal Barrier Resources System (CBRS) area or Otherwise Protected Area (OPA)? Designation Date N/A <input type="checkbox"/> CBRS <input type="checkbox"/> OPA <input type="checkbox"/> Yes <input checked="" type="checkbox"/> No					

SECTION C - BUILDING ELEVATION INFORMATION (SURVEY REQUIRED)

C1. Building elevations are based on: ☐ Construction Drawings* ☐ Building Under Construction* ☒ Finished Construction
*A new Elevation Certificate will be required when construction of the building is complete.

C2. Elevations - Zones A1-A30, AE, AH, A (with BFE), VE, V1-V30, V (with BFE), AR, AR/A, AR/AE, AR/A1-A30, AR/AH, AR/AO. Complete Items C2.a-g below according to the building diagram specified in Item A7.

Benchmark Utilized **LOCAL** Vertical Datum **0.00=LOWEST ADJACENT GRADE**

Conversion/Comments **NONE**

Check the measurement used.			
a) Top of bottom floor (including basement, crawl space, or enclosure floor)	1 0 <input checked="" type="checkbox"/> feet	<input type="checkbox"/> meters (Puerto Rico only)	
b) Top of the next higher floor	4 0 <input checked="" type="checkbox"/> feet	<input type="checkbox"/> meters (Puerto Rico only)	
c) Bottom of the lowest horizontal structural member (V Zones only)	NA <input checked="" type="checkbox"/> feet	<input type="checkbox"/> meters (Puerto Rico only)	
d) Attached garage (top of slab)	NA <input checked="" type="checkbox"/> feet	<input type="checkbox"/> meters (Puerto Rico only)	
e) Lowest elevation of machinery or equipment servicing the building (Describe type of equipment in Comments)	3 4 <input checked="" type="checkbox"/> feet	<input type="checkbox"/> meters (Puerto Rico only)	
f) Lowest adjacent (finished) grade (LAG)	0 0 <input checked="" type="checkbox"/> feet	<input type="checkbox"/> meters (Puerto Rico only)	
g) Highest adjacent (finished) grade (HAG)	1 0 <input checked="" type="checkbox"/> feet	<input type="checkbox"/> meters (Puerto Rico only)	

When B.9 is a depth, indicate highest and lowest NATURAL grade in Section D Comments

SECTION D - SURVEYOR, ENGINEER, OR ARCHITECT CERTIFICATION

This certification is to be signed and sealed by a land surveyor, engineer, or architect authorized by law to certify elevation information. I certify that the information on this Certificate represents my best efforts to interpret the data available. I understand that any false statement may be punishable by fine or imprisonment under 18 U.S. Code, Section 1001.

☒ Check here if comments are provided on back of form.

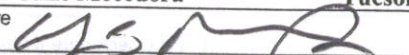
Certifier's Name Edgar B. Reynolds		License Number AZ 31031	
Title Land Surveyor		Company Name Edgar Reynolds and Associates	
Address 1926 W. Calle Mecedora		City Tucson	State AZ
Signature 		Date 10/9/09	ZIP Code 85745
		Telephone 520-884-0292	

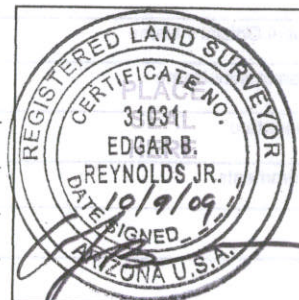

IMPORTANT: In these spaces, copy the corresponding information from Section A.		For Insurance Company Use:
Building Street Address (including Apt., Unit, Suite, and/or Bldg. No.) or P.O. Route and Box No. 6560 W EMJAY AVE		Policy Number
City TUCSON	State AZ	ZIP Code 85746
		Company NAIC Number

SECTION D - SURVEYOR, ENGINEER, OR ARCHITECT CERTIFICATION (CONTINUED)

Copy both sides of this Elevation Certificate for (1) community official, (2) insurance agent/company, and (3) building owner.

Comments **The lowest service equipment (C3.e) is the HEAT PUMP and the FRUNACE, WATER HEATER is/are above this elevation.**
Highest adjacent Natural Grade is _____ Lowest adjacent Natural Grade is _____

NEW MANUFACTURED REPACEMENT SETUP, BLOCK SKIRTED

THERE IS 1.6' BETWEEN HIGHEST ADJACENT GRADE AND LOWEST STRUCTURAL MEMBERSignature  Date **10-9-09** ☐ Check here if attachments**SECTION E - BUILDING ELEVATION INFORMATION (SURVEY NOT REQUIRED) FOR ZONE AO AND ZONE A (WITHOUT BFE)**

For Zones AO and A (without BFE), complete Items E1-E5. If the Certificate is intended to support a LOMA or LOMR-F request, complete Sections A, B, and C. For Items E1-E4, use natural grade, if available. Check the measurement used. In Puerto Rico only, enter meters.

- E1. Provide elevation information for the following and check the appropriate boxes to show whether the elevation is above or below the highest adjacent grade (HAG) and the lowest adjacent grade (LAG).
- a) Top of bottom floor (including basement, crawl space, and enclosure) is _____ feet _____ meters ☐ above or ☐ below the HAG.
- b) Top of bottom floor (including basement, crawl space, and enclosure) is _____ feet _____ meters ☐ above or ☐ below the LAG.
- E2. For Building Diagrams 6-8 with permanent flood openings provided in Section A Items 3 and 9 (see page 8 of Instructions), the next higher floor (elevation C2.b in the diagrams) of the building is _____ feet _____ meters ☐ above or ☐ below the HAG.
- E3. Attached garage (top of slab) is _____ feet _____ meters ☐ above or ☐ below the HAG.
- E4. Top of platform of machinery and/or equipment servicing the building is _____ feet _____ meters ☐ above or ☐ below the HAG.
- E5. Zone AO only: If no flood depth number is available, is the top of the bottom floor elevated in accordance with the community's floodplain management ordinance? ☐ Yes ☐ No ☐ Unknown. The local official must certify this information in Section G.

SECTION F - PROPERTY OWNER (OR OWNER'S REPRESENTATIVE) CERTIFICATION

The property owner or owner's authorized representative who completes Sections A, B, and E for Zone A (without a FEMA-issued or community-issued BFE) or Zone AO must sign here. The statements in Sections A, B, and E are correct to the best of my knowledge.

Property Owner's or Owner's Authorized Representative's Name _____

Address _____ City _____ State _____ ZIP Code _____

Signature _____ Date _____ Telephone _____

Comments _____

☐ Check here if attachments**SECTION G - COMMUNITY INFORMATION (OPTIONAL)**

The local official who is authorized by law or ordinance to administer the community's floodplain management ordinance can complete Sections A, B, C (or E), and G of this Elevation Certificate. Complete the applicable item(s) and sign below. Check the measurement used in Items G8. and G9.

- G1. ☐ The information in Section C was taken from other documentation that has been signed and sealed by a licensed surveyor, engineer, or architect who is authorized by law to certify elevation information. (Indicate the source and date of the elevation data in the Comments area below.)
- G2. ☐ A community official completed Section E for a building located in Zone A (without a FEMA-issued or community-issued BFE) or Zone AO.
- G3. ☐ The following information (Items G4.-G9.) is provided for community floodplain management purposes.

G4. Permit Number FPUP# 09-172E	G5. Date Permit Issued	G6. Date Certificate Of Compliance/Occupancy Issued
---	------------------------	---

G7. This permit has been issued for: ☐ New Construction ☐ Substantial Improvement

G8. Elevation of as-built lowest floor (including basement) of the building: _____ feet _____ meters (PR) Datum _____

G9. BFE or (in Zone AO) depth of flooding at the building site: _____ feet _____ meters (PR) Datum _____

Local Official's Name _____ Title _____

Community Name _____ Telephone _____

Signature _____ Date _____

Comments _____

☐ Check here if attachments



10/9/2009
6560 W. EMJAY NE COR



10/9/2009
6560 W. EMJAY NW COR



10/9/2009
6560 W. EMJAY SW COR



10/9/2009
6560 W. EMJAY SE COR