

## ELEVATION CERTIFICATE

Important: Read the instructions on pages 1-9.

OMB No. 1660-0008  
Expires March 31, 2012

SECTION A - PROPERTY INFORMATION		For Insurance Company Use:
A1. Building Owner's Name	Navarro, Tommy & Alicia	Policy Number
A2. Building Street Address (including Apt., Unit, Suite, and/or Bldg. No.) or P.O. Route and Box No.	16130 N. Forecastle Ave.	Company NAIC Number
City	Tucson	State
		AZ
		ZIP Code
		85739
A3. Property Description (Lot and Block Numbers, Tax Parcel Number, Legal Description, etc.)		
Tax Code 222-13-091A Township 11 Range 14E Section 04		
A4. Building Use (e.g., Residential, Non-Residential, Addition, Accessory, etc.) Residential: Manufactured Home		
A5. Latitude/Longitude: Lat. 32.499068 Long. -110.914105		Horizontal Datum: <input type="checkbox"/> NAD 1927 <input checked="" type="checkbox"/> NAD 1983
A6. Attach at least 2 photographs of the building if the Certificate is being used to obtain flood insurance.		
A7. Building Diagram Number 6		
A8. For a building with a crawlspace or enclosure(s):		
a) Square footage of crawlspace or enclosure(s) 2128 sq ft		
b) No. of permanent flood openings in the crawlspace or enclosure(s) within 1.0 foot above adjacent grade 23		
c) Total net area of flood openings in A8.b 2760 sq in		
d) Engineered flood openings? <input type="checkbox"/> Yes <input checked="" type="checkbox"/> No		
A9. For a building with an attached garage:		
a) Square footage of attached garage N/A sq ft		
b) No. of permanent flood openings in the attached garage within 1.0 foot above adjacent grade N/A		
c) Total net area of flood openings in A9.b N/A sq in		
d) Engineered flood openings? <input type="checkbox"/> Yes <input checked="" type="checkbox"/> No		

## SECTION B - FLOOD INSURANCE RATE MAP (FIRM) INFORMATION

B1. NFIP Community Name & Community Number		B2. County Name		B3. State	
Pima County / 040073		Pima County		AZ	
B4. Map/Panel Number	B5. Suffix	B6. FIRM Index Date	B7. FIRM Panel Effective/Revised Date	B8. Flood Zone(s)	B9. Base Flood Elevation(s) (Zone AO, use base flood depth)
04019C 1035	K	2/8/99	2/8/99	X	3107.0
B10. Indicate the source of the Base Flood Elevation (BFE) data or base flood depth entered in Item B9.					
<input type="checkbox"/> FIS Profile <input type="checkbox"/> FIRM <input type="checkbox"/> Community Determined <input checked="" type="checkbox"/> Other (Describe) Patterson Engineering Report 04/26/2010					
B11. Indicate elevation datum used for BFE in Item B9: <input type="checkbox"/> NGVD 1929 <input checked="" type="checkbox"/> NAVD 1988 <input type="checkbox"/> Other (Describe)					
B12. Is the building located in a Coastal Barrier Resources System (CBRS) area or Otherwise Protected Area (OPA)? <input type="checkbox"/> Yes <input checked="" type="checkbox"/> No					
Designation Date N/A <input type="checkbox"/> CBRS <input type="checkbox"/> OPA					

## SECTION C - BUILDING ELEVATION INFORMATION (SURVEY REQUIRED)

C1. Building elevations are based on: ☐ Construction Drawings\* ☐ Building Under Construction\* ☒ Finished Construction

\*A new Elevation Certificate will be required when construction of the building is complete.

C2. Elevations - Zones A1-A30, AE, AH, A (with BFE), VE, V1-V30, V (with BFE), AR, AR/A, AR/AE, AR/A1-A30, AR/AH, AR/AO. Complete Items C2.a-h below according to the building diagram specified in Item A7. Use the same datum as the BFE.

Benchmark Utilized PCKOT DOT GEODETIC PT A09 Vertical Datum NAVD 88

Conversion/Comments NONE

Check the measurement used.

a) Top of bottom floor (including basement, crawlspace, or enclosure floor)	3104.7	<input checked="" type="checkbox"/> feet	<input type="checkbox"/> meters (Puerto Rico only)
b) Top of the next higher floor	3109.6	<input checked="" type="checkbox"/> feet	<input type="checkbox"/> meters (Puerto Rico only)
c) Bottom of the lowest horizontal structural member (V Zones only)	N/A	<input checked="" type="checkbox"/> feet	<input type="checkbox"/> meters (Puerto Rico only)
d) Attached garage (top of slab)	N/A	<input checked="" type="checkbox"/> feet	<input type="checkbox"/> meters (Puerto Rico only)
e) Lowest elevation of machinery or equipment servicing the building (Describe type of equipment and location in Comments)	3108.3	<input checked="" type="checkbox"/> feet	<input type="checkbox"/> meters (Puerto Rico only)
f) Lowest adjacent (finished) grade next to building (LAG)	3104.2	<input checked="" type="checkbox"/> feet	<input type="checkbox"/> meters (Puerto Rico only)
g) Highest adjacent (finished) grade next to building (HAG)	3104.7	<input checked="" type="checkbox"/> feet	<input type="checkbox"/> meters (Puerto Rico only)
h) Lowest adjacent grade at lowest elevation of deck or stairs, including structural support	3104.4	<input checked="" type="checkbox"/> feet	<input type="checkbox"/> meters (Puerto Rico only)

When B.9 is a depth above grade, it is required to indicate highest and lowest NATURAL grade in Section D Comments

## SECTION D - SURVEYOR, ENGINEER, OR ARCHITECT CERTIFICATION

This certification is to be signed and sealed by a land surveyor, engineer, or architect authorized by law to certify elevation information. I certify that the information on this Certificate represents my best efforts to interpret the data available. I understand that any false statement may be punishable by fine or imprisonment under 18 U.S. Code, Section 1001.

☒ Check here if comments are provided on back of form.Were latitude and longitude in Section A provided by a licensed land surveyor? ☐ Yes ☒ No

Certifier's Name	EDGAR B. REYNOLDS JR.	License Number	AZ RL2 31031
Title	Land Surveyor	Company Name	Edgar Reynolds & Associates
Address	1926 W. CALLE MECORDA	City	TUCSON
		State	AZ
		ZIP Code	85745
Signature	[Signature]	Date	8/26/2010
		Telephone	520-884-0292

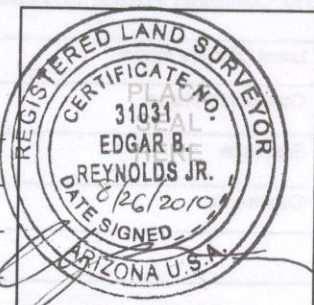



<b>IMPORTANT: In these spaces, copy the corresponding information from Section A.</b>		For Insurance Company Use:
Building Street Address (including Apt., Unit, Suite, and/or Bldg. No.) or P.O. Route and Box No. <b>16130 N. Forecastle Ave.</b>		Policy Number
City <b>Tucson</b>	State <b>AZ</b>	ZIP Code <b>85739</b>
		Company NAIC Number

**SECTION D - SURVEYOR, ENGINEER, OR ARCHITECT CERTIFICATION (CONTINUED)**

Copy both sides of this Elevation Certificate for (1) community official, (2) insurance agent/company, and (3) building owner.

Comments The lowest service equipment (C2.e) is the Air Cond and the FURNACE, WATER HEATER is/are above this elevation.Highest adjacent natural grade is 3104.7 Lowest adjacent natural grade is 3104.2NEW MANUFACTURED HOME ON PIERS BLOCK SHOWN THE BOTTOM OF THE FRONT-  
YARD BEAM IS AT 3108.0' NAVD 88 DATUM. ACQUIT ON LOW BLOCK STAND

Signature

Date

8/26/2010☐ Check here if attachments**SECTION E - BUILDING ELEVATION INFORMATION (SURVEY NOT REQUIRED) FOR ZONE AO AND ZONE A (WITHOUT BFE)**

For Zones AO and A (without BFE), complete Items E1-E5. If the Certificate is intended to support a LOMA or LOMR-F request, complete Sections A, B, and C. For Items E1-E4, use natural grade, if available. Check the measurement used. In Puerto Rico only, enter meters.

E1. Provide elevation information for the following and check the appropriate boxes to show whether the elevation is above or below the highest adjacent grade (HAG) and the lowest adjacent grade (LAG).

a) Top of bottom floor (including basement, crawlspace, and enclosure) is \_\_\_\_\_ feet \_\_\_\_\_ meters ☐ above or ☐ below the HAG.b) Top of bottom floor (including basement, crawlspace, and enclosure) is \_\_\_\_\_ feet \_\_\_\_\_ meters ☐ above or ☐ below the LAG.E2. For Building Diagrams 6-9 with permanent flood openings provided in Section A Items 3 and 9 (see pages 8-9 of Instructions), the next higher floor (elevation C2.b in the diagrams) of the building is \_\_\_\_\_ feet \_\_\_\_\_ meters ☐ above or ☐ below the HAG.E3. Attached garage (top of slab) is \_\_\_\_\_ feet \_\_\_\_\_ meters ☐ above or ☐ below the HAG.E4. Top of platform of machinery and/or equipment servicing the building is \_\_\_\_\_ feet \_\_\_\_\_ meters ☐ above or ☐ below the HAG.E5. Zone AO only: If no flood depth number is available, is the top of the bottom floor elevated in accordance with the community's floodplain management ordinance? ☐ Yes ☐ No ☐ Unknown. The local official must certify this information in Section G.**SECTION F - PROPERTY OWNER (OR OWNER'S REPRESENTATIVE) CERTIFICATION**

The property owner or owner's authorized representative who completes Sections A, B, and E for Zone A (without a FEMA-issued or community-issued BFE) or Zone AO must sign here. The statements in Sections A, B, and E are correct to the best of my knowledge.

Property Owner's or Owner's Authorized Representative's Name

Address

City

State

ZIP Code

Signature

Date

Telephone

Comments

☐ Check here if attachments**SECTION G - COMMUNITY INFORMATION (OPTIONAL)**

The local official who is authorized by law or ordinance to administer the community's floodplain management ordinance can complete Sections A, B, C (or E), and G of this Elevation Certificate. Complete the applicable item(s) and sign below. Check the measurement used in Items G8 and G9.

G1. ☐ The information in Section C was taken from other documentation that has been signed and sealed by a licensed surveyor, engineer, or architect who is authorized by law to certify elevation information. (Indicate the source and date of the elevation data in the Comments area below.)G2. ☐ A community official completed Section E for a building located in Zone A (without a FEMA-issued or community-issued BFE) or Zone AO.G3. ☐ The following information (Items G4-G9) is provided for community floodplain management purposes.

G4. Permit Number <b>FPUP# 09-336E</b>	G5. Date Permit Issued	G6. Date Certificate Of Compliance/Occupancy Issued
---	------------------------	---

G7. This permit has been issued for: ☐ New Construction ☐ Substantial Improvement

G8. Elevation of as-built lowest floor (including basement) of the building \_\_\_\_\_ feet \_\_\_\_\_ meters (PR) Datum \_\_\_\_\_

G9. BFE or (in Zone AO) depth of flooding at the building site \_\_\_\_\_ feet \_\_\_\_\_ meters (PR) Datum \_\_\_\_\_

G10. Community's design flood elevation \_\_\_\_\_ feet \_\_\_\_\_ meters (PR) Datum \_\_\_\_\_

Local Official's Name

Title

Community Name

Telephone

Signature

Date

Comments

☐ Check here if attachments



FPUP# 09-336E

## Building Photographs

Continuation Page

Building Street Address (including Apt., Unit, Suite, and/or Bldg. No.) or P.O. Route and Box No. <b>16130 N. Forecastle Ave.</b>			For Insurance Company Use:
			Policy Number
City <b>Tucson</b>	State <b>AZ</b>	ZIP Code <b>85739</b>	Company NAIC Number

If submitting more photographs than will fit on the preceding page, affix the additional photographs below. Identify all photographs with: date taken; "Front View" and "Rear View"; and, if required, "Right Side View" and "Left Side View."

