

FPUP# 09-583E

P-CP

U.S. DEPARTMENT OF HOMELAND SECURITY
Federal Emergency Management Agency
National Flood Insurance Program

ELEVATION CERTIFICATE

Important: Read the instructions on pages 1-9.

OMB No. 1660-0008
Expires March 31, 2012

SECTION A - PROPERTY INFORMATION

A1. Building Owner's Name Roxana Porter		For Insurance Company Use: Policy Number	
A2. Building Street Address (including Apt., Unit, Suite, and/or Bldg. No.) or P.O. Route and Box No. 11425 N. Musket Rd.		Company NAIC Number	
City Tucson	State AZ	ZIP Code 85746	
A3. Property Description (Lot and Block Numbers, Tax Parcel Number, Legal Description, etc.) Tax Code 208-25-0260 Township 12 Range 10 Section 04			
A4. Building Use (e.g., Residential, Non-Residential, Addition, Accessory, etc.) Accessory: Shed #1			
A5. Latitude/Longitude: Lat. 32.412565 Long. -111.334435		Horizontal Datum: <input type="checkbox"/> NAD 1927 <input checked="" type="checkbox"/> NAD 1983	
A6. Attach at least 2 photographs of the building if the Certificate is being used to obtain flood insurance.			
A7. Building Diagram Number 1			
A8. For a building with a crawlspace or enclosure(s):		A9. For a building with an attached garage:	
a) Square footage of crawlspace or enclosure(s) 80 sq ft	a) Square footage of attached garage N/A sq ft		
b) No. of permanent flood openings in the crawlspace or enclosure(s) within 1.0 foot above adjacent grade 2	b) No. of permanent flood openings in the attached garage within 1.0 foot above adjacent grade N/A		
c) Total net area of flood openings in A8.b 162 sq in	c) Total net area of flood openings in A9.b N/A sq in		
d) Engineered flood openings? <input type="checkbox"/> Yes <input checked="" type="checkbox"/> No	d) Engineered flood openings? <input type="checkbox"/> Yes <input checked="" type="checkbox"/> No		

SECTION B - FLOOD INSURANCE RATE MAP (FIRM) INFORMATION

B1. NFIP Community Name & Community Number Pima County / 040073		B2. County Name Pima County		B3. State AZ	
B4. Map/Panel Number 04019C 965	B5. Suffix K	B6. FIRM Index Date 2/8/99	B7. FIRM Panel Effective/Revised Date 2/8/99	B8. Flood Zone(s) AO1	B9. Base Flood Elevation(s) (Zone AO, use base flood depth) 1.0

B10. Indicate the source of the Base Flood Elevation (BFE) data or base flood depth entered in Item B9.
☐ FIS Profile ☒ FIRM ☐ Community Determined ☐ Other (Describe) _____

B11. Indicate elevation datum used for BFE in Item B9: ☐ NGVD 1929 ☐ NAVD 1988 ☒ Other (Describe) **Highest Adjacent Natural Grade**

B12. Is the building located in a Coastal Barrier Resources System (CBRS) area or Otherwise Protected Area (OPA)? ☐ Yes ☒ No
 Designation Date **N/A** ☐ CBRS ☐ OPA

SECTION C - BUILDING ELEVATION INFORMATION (SURVEY REQUIRED)

C1. Building elevations are based on: ☐ Construction Drawings* ☐ Building Under Construction* ☒ Finished Construction
 *A new Elevation Certificate will be required when construction of the building is complete.

C2. Elevations - Zones A1-A30, AE, AH, A (with BFE), VE, V1-V30, V (with BFE), AR, AR/AE, AR/A1-A30, AR/AH, AR/AO. Complete Items C2.a-h below according to the building diagram specified in Item A7. Use the same datum as the BFE.
 Benchmark Utilized **Pima Associated Gov. BCSME Calle Rudyg Musket Rd** Vertical Datum **NAVD 88**
 Conversion/Comments **N/A**

	Check the measurement used.
a) Top of bottom floor (including basement, crawlspace, or enclosure floor) 1956.8	<input checked="" type="checkbox"/> feet <input type="checkbox"/> meters (Puerto Rico only)
b) Top of the next higher floor N/A	<input checked="" type="checkbox"/> feet <input type="checkbox"/> meters (Puerto Rico only)
c) Bottom of the lowest horizontal structural member (V Zones only) N/A	<input checked="" type="checkbox"/> feet <input type="checkbox"/> meters (Puerto Rico only)
d) Attached garage (top of slab) N/A	<input checked="" type="checkbox"/> feet <input type="checkbox"/> meters (Puerto Rico only)
e) Lowest elevation of machinery or equipment servicing the building (Describe type of equipment and location in Comments) N/A	<input checked="" type="checkbox"/> feet <input type="checkbox"/> meters (Puerto Rico only)
f) Lowest adjacent (finished) grade next to building (LAG) 1956.0	<input checked="" type="checkbox"/> feet <input type="checkbox"/> meters (Puerto Rico only)
g) Highest adjacent (finished) grade next to building (HAG) 1956.0	<input checked="" type="checkbox"/> feet <input type="checkbox"/> meters (Puerto Rico only)
h) Lowest adjacent grade at lowest elevation of deck or stairs, including structural support 1956.0	<input checked="" type="checkbox"/> feet <input type="checkbox"/> meters (Puerto Rico only)

When B.9 is a depth above grade, it is required to indicate highest and lowest NATURAL grade in Section D Comments

SECTION D - SURVEYOR, ENGINEER, OR ARCHITECT CERTIFICATION

This certification is to be signed and sealed by a land surveyor, engineer, or architect authorized by law to certify elevation information. I certify that the information on this Certificate represents my best efforts to interpret the data available. I understand that any false statement may be punishable by fine or imprisonment under 18 U.S. Code, Section 1001.

☒ Check here if comments are provided on back of form.

Were latitude and longitude in Section A provided by a licensed land surveyor? ☐ Yes ☒ No

Certifier's Name Geoffrey K. Brimhall		License Number ZLS 33308	
Title Registered Land Surveyor	Company Name Physical Resource Engineering		
Address 4655 N Flowing Wells	City Tucson	State AZ	ZIP Code 85705
Signature [Signature]	Date 12-15-09	Telephone 520 690 1669	

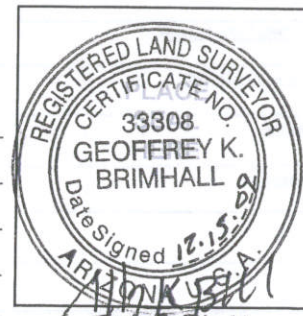

IMPORTANT: In these spaces, copy the corresponding information from Section A.

Building Street Address (including Apt., Unit, Suite, and/or Bldg. No.) or P.O. Route and Box No.

11425 N. Musket Rd.

City Tucson

State AZ

ZIP Code
85746

For Insurance Company Use:

Policy Number

Company NAIC Number

SECTION D - SURVEYOR, ENGINEER, OR ARCHITECT CERTIFICATION (CONTINUED)

Copy both sides of this Elevation Certificate for (1) community official, (2) insurance agent/company, and (3) building owner.

Comments The lowest service equipment (C2.e) is the N/A and the N/A is/are above this elevation.Highest adjacent natural grade is 1956.0 Lowest adjacent natural grade is 1956.0

Signature

1/12 K B L U

Date

12-15-09☐ Check here if attachments**SECTION E - BUILDING ELEVATION INFORMATION (SURVEY NOT REQUIRED) FOR ZONE AO AND ZONE A (WITHOUT BFE)**

For Zones AO and A (without BFE), complete Items E1-E5. If the Certificate is intended to support a LOMA or LOMR-F request, complete Sections A, B, and C. For Items E1-E4, use natural grade, if available. Check the measurement used. In Puerto Rico only, enter meters.

- E1. Provide elevation information for the following and check the appropriate boxes to show whether the elevation is above or below the highest adjacent grade (HAG) and the lowest adjacent grade (LAG).
- a) Top of bottom floor (including basement, crawlspace, and enclosure) is _____ feet _____ meters ☐ above or ☐ below the HAG.
- b) Top of bottom floor (including basement, crawlspace, and enclosure) is _____ feet _____ meters ☐ above or ☐ below the LAG.
- E2. For Building Diagrams 6-9 with permanent flood openings provided in Section A Items 6 and 9 (see pages 8-9 of Instructions), the next higher floor (elevation C2.b in the diagrams) of the building is _____ feet _____ meters ☐ above or ☐ below the HAG.
- E3. Attached garage (top of slab) is _____ feet _____ meters ☐ above or ☐ below the HAG.
- E4. Top of platform of machinery and/or equipment servicing the building is _____ feet _____ meters ☐ above or ☐ below the HAG.
- E5. Zone AO only: If no flood depth number is available, is the top of the bottom floor elevated in accordance with the community's floodplain management ordinance? ☐ Yes ☐ No ☐ Unknown. The local official must certify this information in Section G.

SECTION F - PROPERTY OWNER (OR OWNER'S REPRESENTATIVE) CERTIFICATION

The property owner or owner's authorized representative who completes Sections A, B, and E for Zone A (without a FEMA-issued or community-issued BFE) or Zone AO must sign here. The statements in Sections A, B, and E are correct to the best of my knowledge.

Property Owner's or Owner's Authorized Representative's Name

Address

City

State

ZIP Code

Signature

Date

Telephone

Comments

☐ Check here if attachments**SECTION G - COMMUNITY INFORMATION (OPTIONAL)**

The local official who is authorized by law or ordinance to administer the community's floodplain management ordinance can complete Sections A, B, C (or E), and G of this Elevation Certificate. Complete the applicable item(s) and sign below. Check the measurement used in Items G8 and G9.

- G1. ☐ The information in Section C was taken from other documentation that has been signed and sealed by a licensed surveyor, engineer, or architect who is authorized by law to certify elevation information. (Indicate the source and date of the elevation data in the Comments area below.)
- G2. ☐ A community official completed Section E for a building located in Zone A (without a FEMA-issued or community-issued BFE) or Zone AO.
- G3. ☐ The following information (Items G4-G9) is provided for community floodplain management purposes.

G4. Permit Number
FPUP# 09-583E

G5. Date Permit Issued

G6. Date Certificate Of Compliance/Occupancy Issued

G7. This permit has been issued for: ☐ New Construction ☐ Substantial Improvement

G8. Elevation of as-built lowest floor (including basement) of the building _____ feet _____ meters (PR) Datum _____

G9. BFE or (in Zone AO) depth of flooding at the building site _____ feet _____ meters (PR) Datum _____

G10. Community's design flood elevation _____ feet _____ meters (PR) Datum _____

Local Official's Name

Title

Community Name

Telephone

Signature

Date

Comments

☐ Check here if attachments

FPUP# 09-583E

Building Photographs(Four Color Photographs Required)

See Instructions for Item A6.

Building Street Address (including Apt., Unit, Suite, and/or Bldg. No.) or P.O. Route and Box No.

11425 N. Musket Rd.

City
Tucson

State
AZ

ZIP Code
85746

For Insurance Company Use:

Policy Number

Company NAIC Number

If using the Elevation Certificate to obtain NFIP flood insurance, affix at least Four building photographs below according to the instructions for Item A6. Identify all photographs with: date taken; "Front View" and "Rear View"; and, if required, "Right Side View" and "Left Side View." If submitting more photographs than will fit on this page, use the Continuation Page on the reverse.



Front

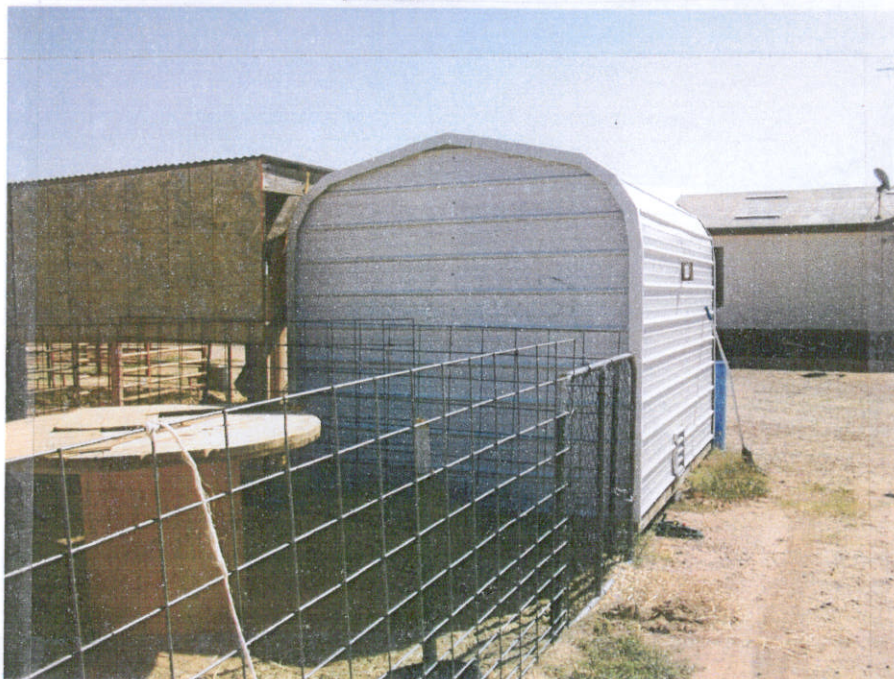

Rear

FPUP# 09-583E

Building Photographs

Continuation Page

Building Street Address (including Apt., Unit, Suite, and/or Bldg. No.) or P.O. Route and Box No. 11425 N. Musket Rd.			For Insurance Company Use: Policy Number
City Tucson	State AZ	ZIP Code 85746	Company NAIC Number

If submitting more photographs than will fit on the preceding page, affix the additional photographs below. Identify all photographs with: date taken; "Front View" and "Rear View"; and, if required, "Right Side View" and "Left Side View."



Right



Left

ELEVATION CERTIFICATE

U.S. DEPARTMENT OF HOMELAND SECURITY
Federal Emergency Management Agency
National Flood Insurance ProgramOMB No. 1660-0008
Expires February 28, 2009

Important: Read the instructions on pages 1-8.

SECTION A - PROPERTY INFORMATION

A1. Building Owner's Name Roxana Porter		For Insurance Company Use:
A2. Building Street Address (including Apt., Unit, Suite, and/or Bldg. No.) or P.O. Route and Box No. 11425 North Musket Road		Policy Number
City Tucson	State AZ	ZIP Code 85746

A3. Property Description (Lot and Block Numbers, Tax Parcel Number, Legal Description, etc.)
Tax Code 208-25-0260 Township 12 Range 10 Section 04

- A4. Building Use (e.g., Residential, Non-Residential, Addition, Accessory, etc.) **Accessory: Shed #2**
- A5. Latitude/Longitude: Lat. **32.412351** Long. **-111.334470** Horizontal Datum: ☐ NAD 1927 ☒ NAD 1983
- A6. Attach at least 2 photographs of the building if the Certificate is being used to obtain flood insurance.
- A7. Building Diagram Number **1**
- A8. For a building with a crawl space or enclosure(s), provide:
- a) Square footage of crawl space or enclosure(s) **200** sq ft
 - b) No. of permanent flood openings in the crawl space or enclosure(s) walls within 1.0 foot above adjacent grade **2**
 - c) Total net area of flood openings in A8.b **242** sq in
- A9. For a building with an attached garage, provide:
- a) Square footage of attached garage **N/A** sq ft
 - b) No. of permanent flood openings in the attached garage walls within 1.0 foot above adjacent grade **N/A**
 - c) Total net area of flood openings in A9.b **N/A** sq in

SECTION B - FLOOD INSURANCE RATE MAP (FIRM) INFORMATION

B1. NFIP Community Name & Community Number Pima County / 040073		B2. County Name Pima County		B3. State AZ	
B4. Map/Panel Number 04019C 0965	B5. Suffix K	B6. FIRM Index Date 2/8/99	B7. FIRM Panel Effective/Revised Date 2/8/99	B8. Flood Zone(s) AO1	B9. Base Flood Elevation(s) (Zone AO, use base flood depth) 1.0

- B10. Indicate the source of the Base Flood Elevation (BFE) data or base flood depth entered in Item B9.
☐ FIS Profile ☒ FIRM ☐ Community Determined ☐ Other (Describe)
- B11. Indicate elevation datum used for BFE in Item B9: ☐ NGVD 1929 ☐ NAVD 1988 ☒ Other (Describe) **Highest Adjacent Natural Grade**
- B12. Is the building located in a Coastal Barrier Resources System (CBRS) area or Otherwise Protected Area (OPA)?
Designation Date **N/A** ☐ CBRS ☐ OPA ☐ Yes ☒ No

SECTION C - BUILDING ELEVATION INFORMATION (SURVEY REQUIRED)

- C1. Building elevations are based on: ☐ Construction Drawings* ☐ Building Under Construction* ☒ Finished Construction
*A new Elevation Certificate will be required when construction of the building is complete.
- C2. Elevations - Zones A1-A30, AE, AH, A (with BFE), VE, V1-V30, V (with BFE), AR, AR/A, AR/AE, AR/A1-A30, AR/AH, AR/AO. Complete Items C2.a-g below according to the building diagram specified in Item A7.
Benchmark Utilized **Pima Associated Gov. BCSME Calle Rudolfo Musket Rd** Vertical Datum **NAVD 88**
Conversion/Comments

Check the measurement used.

- a) Top of bottom floor (including basement, crawl space, or enclosure floor) **1959.5** ☒ feet ☐ meters (Puerto Rico only)
- b) Top of the next higher floor **N/A** ☒ feet ☐ meters (Puerto Rico only)
- c) Bottom of the lowest horizontal structural member (V Zones only) **N/A** ☒ feet ☐ meters (Puerto Rico only)
- d) Attached garage (top of slab) **N/A** ☒ feet ☐ meters (Puerto Rico only)
- e) Lowest elevation of machinery or equipment servicing the building (Describe type of equipment in Comments) **N/A** ☒ feet ☐ meters (Puerto Rico only)
- f) Lowest adjacent (finished) grade (LAG) **1959.0** ☒ feet ☐ meters (Puerto Rico only)
- g) Highest adjacent (finished) grade (HAG) **1959.0** ☒ feet ☐ meters (Puerto Rico only)

When B.9 is a depth above grade, it is required to indicate highest and lowest NATURAL grade in Section D Comments

SECTION D - SURVEYOR, ENGINEER,

CERTIFICATION

This certification is to be signed and sealed by a land surveyor, engineer, or architect authorized by law to certify elevation information. I certify that the information on this Certificate represents my best efforts to interpret the data available. I understand that any false statement may be punishable by fine or imprisonment under 18 U.S. Code, Section 1001.

☒ Check here if comments are provided on back of form.

Certifier's Name Geoffrey K. Brimhall		License Number RLS 33308	
Title Registered Land Surveyor	Company Name Physical Resource Engineering		
Address 4655 N Flowing Wells	City Tucson	State AZ	ZIP Code 85705
Signature GK Brimhall	Date 12-15-09	Telephone 520 690 1669	

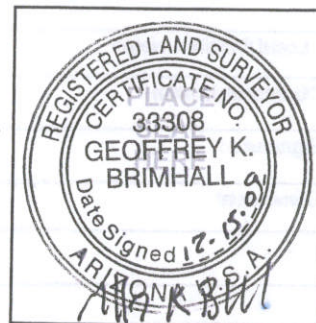

IMPORTANT: In these spaces, copy the corresponding information from Section A.			For Insurance Company Use:
Building Street Address (including Apt., Unit, Suite, and/or Bldg. No.) or P.O. Route and Box No. 11425 North Musket Road			Policy Number
City Tucson	State AZ	ZIP Code 85746	Company NAIC Number

SECTION D - SURVEYOR, ENGINEER, OR ARCHITECT CERTIFICATION (CONTINUED)

Copy both sides of this Elevation Certificate for (1) community official, (2) insurance agent/company, and (3) building owner.

Comments The lowest service equipment (C3.e) is the N/A and the N/A is/are above this elevation.
 Highest adjacent natural grade is 1959.0 Lowest adjacent natural grade is 1959.0

Signature A/H KIBLL Date 12.15.09 ☐ Check here if attachments

SECTION E - BUILDING ELEVATION INFORMATION (SURVEY NOT REQUIRED) FOR ZONE AO AND ZONE A (WITHOUT BFE)

For Zones AO and A (without BFE), complete Items E1-E5. If the Certificate is intended to support a LOMA or LOMR-F request, complete Sections A, B, and C. For Items E1-E4, use natural grade, if available. Check the measurement used. In Puerto Rico only, enter meters.

- E1. Provide elevation information for the following and check the appropriate boxes to show whether the elevation is above or below the highest adjacent grade (HAG) and the lowest adjacent grade (LAG).
 a) Top of bottom floor (including basement, crawl space, enclosure) is N/A feet ☐ meters ☐ above or ☐ below the HAG.
 b) Top of bottom floor (including basement, crawl space, enclosure) is N/A feet ☐ meters ☐ above or ☐ below the LAG.
 E2. For Building Diagrams 6-8 with permanent flood openings provided in Section A Items 3 and 9 (see page 8 of Instructions), the next higher floor (elevation C2.b in the diagrams) of the building is N/A feet ☐ meters ☐ above or ☐ below the HAG.
 E3. Attached garage (top of slab) is N/A feet ☐ meters ☐ above or ☐ below the HAG.
 E4. Top of platform of machinery and/or equipment servicing the building is N/A feet ☐ meters ☐ above or ☐ below the HAG.
 E5. Zone AO only: If no flood depth number is available, is the top of the bottom floor elevated in accordance with the community's floodplain management ordinance? ☐ Yes ☐ No ☐ Unknown. The local official must certify this information in Section G.

SECTION F - PROPERTY OWNER (OR OWNER'S REPRESENTATIVE) CERTIFICATION

The property owner or owner's authorized representative who completes Sections A, B, and E for Zone A (without a FEMA-issued or community-issued BFE) or Zone AO must sign here. The statements in Sections A, B, and E are correct to the best of my knowledge.

Property Owner's or Owner's Authorized Representative's Name N/A
 Address N/A City N/A State N/A ZIP Code N/A
 Signature N/A Date N/A Telephone N/A
 Comments N/A

☐ Check here if attachments

SECTION G - COMMUNITY INFORMATION (OPTIONAL)

The local official who is authorized by law or ordinance to administer the community's floodplain management ordinance can complete Sections A, B, C (or E), and G of this Elevation Certificate. Complete the applicable item(s) and sign below. Check the measurement used in Items G8. and G9.

- G1. ☐ The information in Section C was taken from other documentation that has been signed and sealed by a licensed surveyor, engineer, or architect who is authorized by law to certify elevation information. (Indicate the source and date of the elevation data in the Comments area below.)
 G2. ☐ A community official completed Section E for a building located in Zone A (without a FEMA-issued or community-issued BFE) or Zone AO.
 G3. ☐ The following information (Items G4.-G9.) is provided for community floodplain management purposes.

G4. Permit Number FPUP# 09-583E	G5. Date Permit Issued <u>12/15/09</u>	G6. Date Certificate Of Compliance/Occupancy Issued <u>12/15/09</u>
---	---	--

G7. This permit has been issued for: ☐ New Construction ☐ Substantial Improvement

G8. Elevation of as-built lowest floor (including basement) of the building: N/A feet ☐ meters (PR) Datum N/A

G9. BFE or (in Zone AO) depth of flooding at the building site: N/A feet ☐ meters (PR) Datum N/A

Local Official's Name Geoffrey J. Smith Title Community Official
 Community Name City of Tucson Telephone 520-795-2222
 Signature Geoffrey J. Smith Date 12/15/09
 Comments 11425 North Musket Road

☐ Check here if attachments

FPUP# 09-583E

Building Photographs(Four Color Photographs Required)

See Instructions for Item A6.

Building Street Address (including Apt., Unit, Suite, and/or Bldg. No.) or P.O. Route and Box No. 11425 North Musket Road			For Insurance Company Use: Policy Number
City Tucson	State AZ	ZIP Code 85746	Company NAIC Number

If using the Elevation Certificate to obtain NFIP flood insurance, affix at least Four building photographs below according to the instructions for Item A6. Identify all photographs with: date taken; "Front View" and "Rear View"; and, if required, "Right Side View" and "Left Side View." If submitting more photographs than will fit on this page, use the Continuation Page, following.



Front



Rear

FPUP# 09-583E

Building Photographs

Continuation Page

Building Street Address (including Apt., Unit, Suite, and/or Bldg. No.) or P.O. Route and Box No. 11425 North Musket Road			For Insurance Company Use: Policy Number
City Tucson	State AZ	ZIP Code 85746	Company NAIC Number

If submitting more photographs than will fit on the preceding page, affix the additional photographs below. Identify all photographs with: date taken; "Front View" and "Rear View"; and, if required, "Right Side View" and "Left Side View."



Right



Left

ELEVATION CERTIFICATE

OMB No. 1660-0008
Expires February 28, 2009

Important: Read the instructions on pages 1-8.

SECTION A - PROPERTY INFORMATION

A1. Building Owner's Name Roxana Porter		For Insurance Company Use:	
A2. Building Street Address (including Apt., Unit, Suite, and/or Bldg. No.) or P.O. Route and Box No. 11425 North Musket Road		Policy Number	
City Tucson	State AZ	ZIP Code 85746	
A3. Property Description (Lot and Block Numbers, Tax Parcel Number, Legal Description, etc.) Tax Code 208-25-0260 Township 12 Range 10 Section 04			
A4. Building Use (e.g., Residential, Non-Residential, Addition, Accessory, etc.) Accessory: Shed #3			
A5. Latitude/Longitude: Lat. 32.411788 Long. -111.334963		Horizontal Datum: <input type="checkbox"/> NAD 1927 <input checked="" type="checkbox"/> NAD 1983	
A6. Attach at least 2 photographs of the building if the Certificate is being used to obtain flood insurance.			
A7. Building Diagram Number 1			
A8. For a building with a crawl space or enclosure(s), provide:		A9. For a building with an attached garage, provide:	
a) Square footage of crawl space or enclosure(s) 288 sq ft		a) Square footage of attached garage N/A sq ft	
b) No. of permanent flood openings in the crawl space or enclosure(s) walls within 1.0 foot above adjacent grade 2		b) No. of permanent flood openings in the attached garage walls within 1.0 foot above adjacent grade N/A	
c) Total net area of flood openings in A8.b 408 sq in		c) Total net area of flood openings in A9.b N/A sq in	

SECTION B - FLOOD INSURANCE RATE MAP (FIRM) INFORMATION

B1. NFIP Community Name & Community Number Pima County / 040073		B2. County Name Pima County		B3. State AZ	
B4. Map/Panel Number 04019C 0965	B5. Suffix K	B6. FIRM Index Date 2/8/99	B7. FIRM Panel Effective/Revised Date 2/8/99	B8. Flood Zone(s) AO1	B9. Base Flood Elevation(s) (Zone AO, use base flood depth) 1.0
B10. Indicate the source of the Base Flood Elevation (BFE) data or base flood depth entered in Item B9. <input type="checkbox"/> FIS Profile <input checked="" type="checkbox"/> FIRM <input type="checkbox"/> Community Determined <input type="checkbox"/> Other (Describe)					
B11. Indicate elevation datum used for BFE in Item B9: <input type="checkbox"/> NGVD 1929 <input type="checkbox"/> NAVD 1988 <input checked="" type="checkbox"/> Other (Describe) Highest Adjacent Natural Grade					
B12. Is the building located in a Coastal Barrier Resources System (CBRS) area or Otherwise Protected Area (OPA)? <input type="checkbox"/> Yes <input checked="" type="checkbox"/> No Designation Date N/A <input type="checkbox"/> CBRS <input type="checkbox"/> OPA					

SECTION C - BUILDING ELEVATION INFORMATION (SURVEY REQUIRED)

C1. Building elevations are based on: ☐ Construction Drawings* ☐ Building Under Construction* ☒ Finished Construction
*A new Elevation Certificate will be required when construction of the building is complete.

C2. Elevations - Zones A1-A30, AE, AH, A (with BFE), VE, V1-V30, V (with BFE), AR, AR/A, AR/AE, AR/A1-A30, AR/AH, AR/AO. Complete Items C2.a-g below according to the building diagram specified in Item A7.

Benchmark Utilized **Pima Associated Gov. BCSCMC Calle Rudolfo Musket Rd** Vertical Datum **NAVD 88**

Conversion/Comments

Check the measurement used.

- | | | |
|---|--|--|
| a) Top of bottom floor (including basement, crawl space, or enclosure floor) | 1958.0 <input checked="" type="checkbox"/> feet | <input type="checkbox"/> meters (Puerto Rico only) |
| b) Top of the next higher floor | N/A <input checked="" type="checkbox"/> feet | <input type="checkbox"/> meters (Puerto Rico only) |
| c) Bottom of the lowest horizontal structural member (V Zones only) | N/A <input checked="" type="checkbox"/> feet | <input type="checkbox"/> meters (Puerto Rico only) |
| d) Attached garage (top of slab) | N/A <input checked="" type="checkbox"/> feet | <input type="checkbox"/> meters (Puerto Rico only) |
| e) Lowest elevation of machinery or equipment servicing the building (Describe type of equipment in Comments) | N/A <input checked="" type="checkbox"/> feet | <input type="checkbox"/> meters (Puerto Rico only) |
| f) Lowest adjacent (finished) grade (LAG) | 1957.5 <input checked="" type="checkbox"/> feet | <input type="checkbox"/> meters (Puerto Rico only) |
| g) Highest adjacent (finished) grade (HAG) | 1958.0 <input checked="" type="checkbox"/> feet | <input type="checkbox"/> meters (Puerto Rico only) |

When B.9 is a depth above grade, it is required to indicate highest and lowest NATURAL grade in Section D Comments

SECTION D - SURVEYOR, ENGINEER,

CERTIFICATION

This certification is to be signed and sealed by a land surveyor, engineer, or architect authorized by law to certify elevation information. I certify that the information on this Certificate represents my best efforts to interpret the data available. I understand that any false statement may be punishable by fine or imprisonment under 18 U.S. Code, Section 1001.

☒ Check here if comments are provided on back of form.

Certifier's Name Geoffrey K Brimhall		License Number ILS 33308	
Title Registered Land Surveyor	Company Name Physikal Resource Engineering		
Address 4655 N Flowing Wells	City Tucson	State AZ	ZIP Code 85705
Signature A/H K B L L	Date 12-15-09	Telephone 520 690 1669	

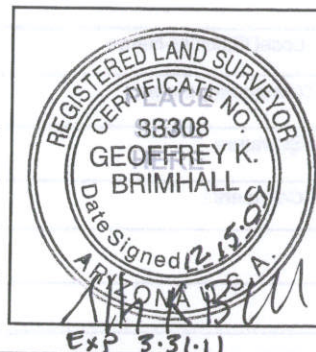

IMPORTANT: In these spaces, copy the corresponding information from Section A.			For Insurance Company Use:
Building Street Address (including Apt., Unit, Suite, and/or Bldg. No.) or P.O. Route and Box No. 11425 North Musket Road			Policy Number
City Tucson	State AZ	ZIP Code 85746	Company NAIC Number

SECTION D - SURVEYOR, ENGINEER, OR ARCHITECT CERTIFICATION (CONTINUED)

Copy both sides of this Elevation Certificate for (1) community official, (2) insurance agent/company, and (3) building owner.

Comments The lowest service equipment (C3.e) is the N/A and the N/A is/are above this elevation.
 Highest adjacent natural grade is 1957.0 Lowest adjacent natural grade is 1957.0

Signature 11/2 K BLM Date 12-15-09 ☐ Check here if attachments

SECTION E - BUILDING ELEVATION INFORMATION (SURVEY NOT REQUIRED) FOR ZONE AO AND ZONE A (WITHOUT BFE)

For Zones AO and A (without BFE), complete Items E1-E5. If the Certificate is intended to support a LOMA or LOMR-F request, complete Sections A, B, and C. For Items E1-E4, use natural grade, if available. Check the measurement used. In Puerto Rico only, enter meters.

- E1. Provide elevation information for the following and check the appropriate boxes to show whether the elevation is above or below the highest adjacent grade (HAG) and the lowest adjacent grade (LAG).
 a) Top of bottom floor (including basement, crawl space, and enclosure) is _____ feet _____ meters ☐ above or ☐ below the HAG.
 b) Top of bottom floor (including basement, crawl space, and enclosure) is _____ feet _____ meters ☐ above or ☐ below the LAG.
 E2. For Building Diagrams 6-8 with permanent flood openings provided in Section A Items 3 and 9 (see page 8 of Instructions), the next higher floor (elevation C2.b in the diagrams) of the building is _____ feet _____ meters ☐ above or ☐ below the HAG.
 E3. Attached garage (top of slab) is _____ feet _____ meters ☐ above or ☐ below the HAG.
 E4. Top of platform of machinery and/or equipment servicing the building is _____ feet _____ meters ☐ above or ☐ below the HAG.
 E5. Zone AO only: If no flood depth number is available, is the top of the bottom floor elevated in accordance with the community's floodplain management ordinance? ☐ Yes ☐ No ☐ Unknown. The local official must certify this information in Section G.

SECTION F - PROPERTY OWNER (OR OWNER'S REPRESENTATIVE) CERTIFICATION

The property owner or owner's authorized representative who completes Sections A, B, and E for Zone A (without a FEMA-issued or community-issued BFE) or Zone AO must sign here. The statements in Sections A, B, and E are correct to the best of my knowledge.

Property Owner's or Owner's Authorized Representative's Name _____

Address _____ City _____ State _____ ZIP Code _____

Signature _____ Date _____ Telephone _____

Comments _____

☐ Check here if attachments

SECTION G - COMMUNITY INFORMATION (OPTIONAL)

The local official who is authorized by law or ordinance to administer the community's floodplain management ordinance can complete Sections A, B, C (or E), and G of this Elevation Certificate. Complete the applicable item(s) and sign below. Check the measurement used in Items G8. and G9.

- G1. ☐ The information in Section C was taken from other documentation that has been signed and sealed by a licensed surveyor, engineer, or architect who is authorized by law to certify elevation information. (Indicate the source and date of the elevation data in the Comments area below.)
 G2. ☐ A community official completed Section E for a building located in Zone A (without a FEMA-issued or community-issued BFE) or Zone AO.
 G3. ☐ The following information (Items G4.-G9.) is provided for community floodplain management purposes.

G4. Permit Number FPUP# 09-583E	G5. Date Permit Issued _____	G6. Date Certificate Of Compliance/Occupancy Issued _____
---	---------------------------------	--

G7. This permit has been issued for: ☐ New Construction ☐ Substantial Improvement

G8. Elevation of as-built lowest floor (including basement) of the building: _____ feet _____ meters (PR) Datum _____

G9. BFE or (in Zone AO) depth of flooding at the building site: _____ feet _____ meters (PR) Datum _____

Local Official's Name _____ Title _____

Community Name _____ Telephone _____

Signature _____ Date _____

Comments _____

☐ Check here if attachments

FPUP# 09-583E

Building Photographs(Four Color Photographs Required)

See Instructions for Item A6.

Building Street Address (including Apt., Unit, Suite, and/or Bldg. No.) or P.O. Route and Box No. 11425 North Musket Road			For Insurance Company Use: Policy Number
City Tucson	State AZ	ZIP Code 85746	Company NAIC Number

If using the Elevation Certificate to obtain NFIP flood insurance, affix at least **Four** building photographs below according to the instructions for Item A6. Identify all photographs with: date taken; "Front View" and "Rear View"; and, if required, "Right Side View" and "Left Side View." If submitting more photographs than will fit on this page, use the Continuation Page, following.

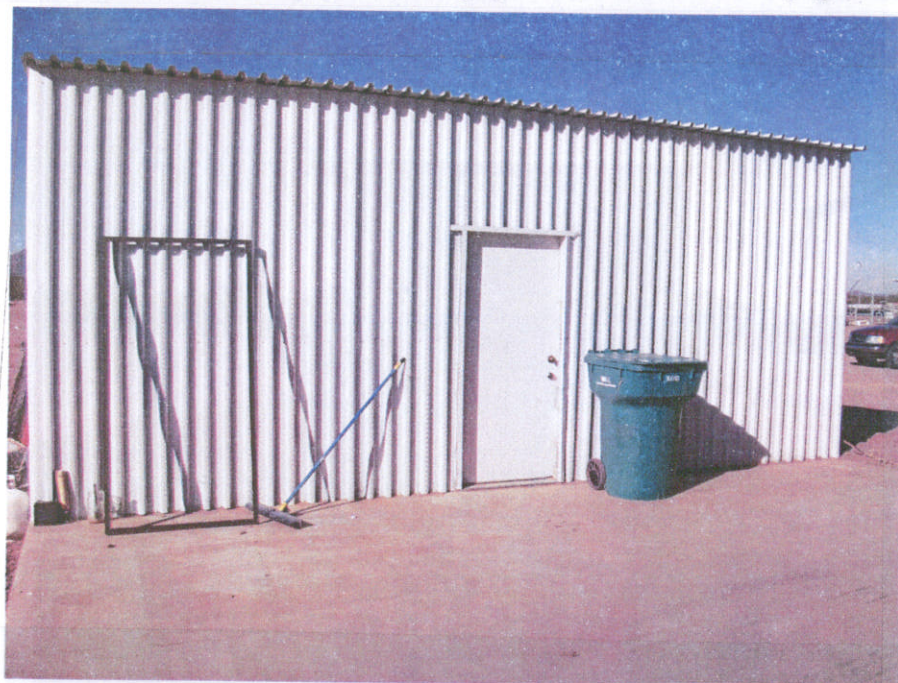

Front

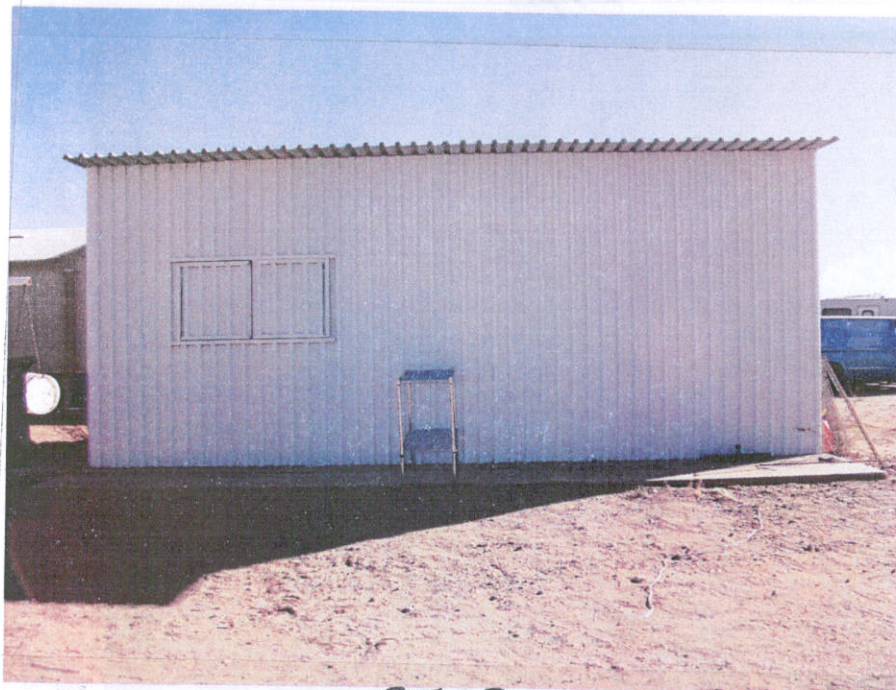

REAR

FPUP# 09-583E

Building Photographs

Continuation Page

Building Street Address (including Apt., Unit, Suite, and/or Bldg. No.) or P.O. Route and Box No. 11425 North Musket Road			For Insurance Company Use: Policy Number
City Tucson	State AZ	ZIP Code 85746	Company NAIC Number

If submitting more photographs than will fit on the preceding page, affix the additional photographs below. Identify all photographs with: date taken; "Front View" and "Rear View"; and, if required, "Right Side View" and "Left Side View."



Right

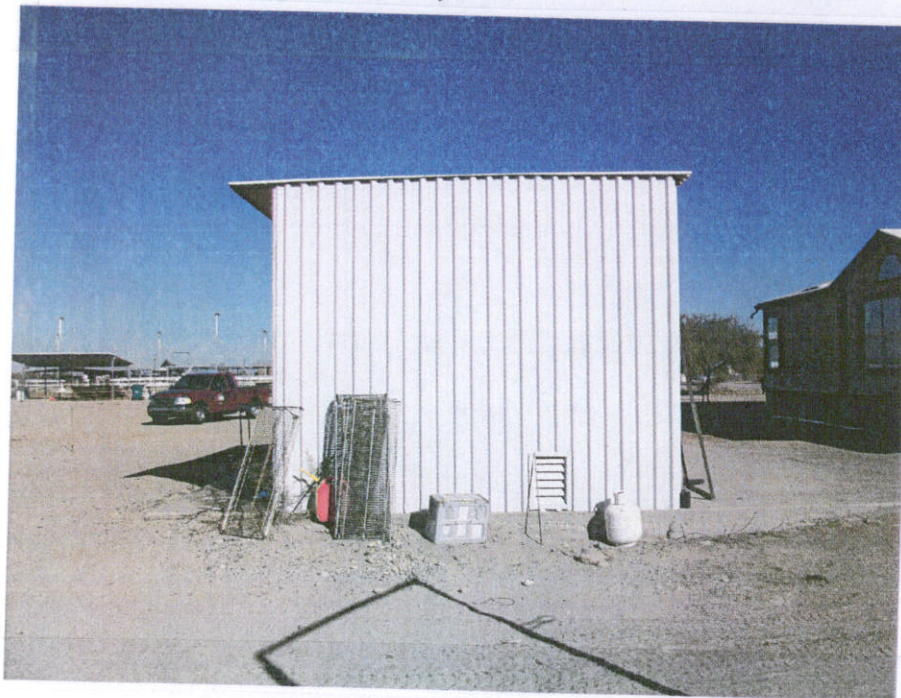

Left