

Accepted
11/18/14 EPE

FPUP# 10-017E P 10 CP 00420

U.S. DEPARTMENT OF HOMELAND SECURITY
FEDERAL EMERGENCY MANAGEMENT AGENCY
National Flood Insurance Program

ELEVATION CERTIFICATE

IMPORTANT: Follow the instructions on pages 1-9.

OMB No. 1660-0008
Expiration Date: July 31, 2015

SECTION A - PROPERTY INFORMATION

FOR INSURANCE COMPANY USE

A1. Building Owner's Name ROUNSAVILLE, LARRY & DALE		Policy Number:
A2. Building Street Address (including Apt., Unit, Suite, and/or Bldg. No.) or P.O. Route and Box No. 6291 W MICHIGAN ST		Company NAIC Number:
City Tucson	State AZ	ZIP Code 85765
A3. Property Description (Lot and Block Numbers, Tax Parcel Number, Legal Description, etc.) Tax Code 212-45-089E Township 14S Range 12E Section 34		
A4. Building Use (e.g., Residential, Non-Residential, Addition, Accessory, etc.) Manufactured Home Setup		
A5. Latitude/Longitude: Lat. 32.169550 Long. -111.098752		Horizontal Datum: <input type="checkbox"/> NAD 1927 <input checked="" type="checkbox"/> NAD 1983
A6. Attach at least 2 photographs of the building if the Certificate is being used to obtain flood insurance.		
A7. Building Diagram Number 56		
A8. For a building with a crawlspace or enclosure(s): a) Square footage of crawlspace or enclosure(s) NA 1394 sq ft b) No. of permanent flood openings in the crawlspace or enclosure(s) within 1.0 foot above adjacent grade NA 22 c) Total net area of flood openings in A8.b NA 2120 sq in d) Engineered flood openings? <input type="checkbox"/> Yes <input checked="" type="checkbox"/> No		A9. For a building with an attached garage: a) Square footage of attached garage NA sq ft b) Number of permanent flood openings in the attached garage within 1.0 foot above adjacent grade NA c) Total net area of flood openings in A9.b NA sq in d) Engineered flood openings? <input type="checkbox"/> Yes <input checked="" type="checkbox"/> No

SECTION B - FLOOD INSURANCE RATE MAP (FIRM) INFORMATION

B1. NFIP Community Name & Community Number Pima County / 040073		B2. County Name Pima County		B3. State AZ	
B4. Map/Panel Number 04019C 2265	B5. Suffix L	B6. FIRM Index Date 9-28-12 6-16-11	B7. FIRM Panel Effective/ Revised Date 6-16-11	B8. Flood Zone(s) X	B9. Base Flood Elevation(s) (Zone AO, use base flood depth) 100.5
B10. Indicate the source of the Base Flood Elevation (BFE) data or base flood depth entered in Item B9: <input type="checkbox"/> FIS Profile <input type="checkbox"/> FIRM <input checked="" type="checkbox"/> Community Determined <input type="checkbox"/> Other/Source: _____					
B11. Indicate elevation datum used for BFE in Item B9: <input type="checkbox"/> NGVD 1929 <input type="checkbox"/> NAVD 1988 <input checked="" type="checkbox"/> Other/Source: Highest Adj. Nat. Grade (=100 ft)					
B12. Is the building located in a Coastal Barrier Resources System (CBRS) area or Otherwise Protected Area (DPA)? <input type="checkbox"/> Yes <input checked="" type="checkbox"/> No Designation Date: N/A / N/A / N/A <input type="checkbox"/> CBRS <input type="checkbox"/> OPA					

SECTION C - BUILDING ELEVATION INFORMATION (SURVEY REQUIRED)

C1. Building elevations are based on: ☐ Construction Drawings* ☐ Building Under Construction* ☒ Finished Construction
*A new Elevation Certificate will be required when construction of the building is complete.

C2. Elevations - Zones A1-A30, AE, AH, A (with BFE), VE, V1-V30, V (with BFE), AR, AR/A, AR/AE, AR/A1-A30, AR/AH, AR/AO. Complete Items C2.a-h below according to the building diagram specified in Item A7. In Puerto Rico only, enter meters.
Benchmark Utilized: **LOCAL** Vertical Datum: **100.0'=H.A.G. NATURAL**

Indicate elevation datum used for the elevations in items a) through h) below. ☐ NGVD 1929 ☐ NAVD 1988 ☒ Other/Source: **H.A.G.**
Datum used for building elevations must be the same as that used for the BFE.

		Check the measurement used.
a) Top of bottom floor (including basement, crawlspace, or enclosure floor)	103.1	<input checked="" type="checkbox"/> feet <input type="checkbox"/> meters
b) Top of the next higher floor	N/A	<input checked="" type="checkbox"/> feet <input type="checkbox"/> meters
c) Bottom of the lowest horizontal structural member (V Zones only)	N/A	<input checked="" type="checkbox"/> feet <input type="checkbox"/> meters
d) Attached garage (top of slab)	N/A	<input checked="" type="checkbox"/> feet <input type="checkbox"/> meters
e) Lowest elevation of machinery or equipment servicing the building (Describe type of equipment and location in Comments)	100.0 11/18/14 102.0	<input checked="" type="checkbox"/> feet <input type="checkbox"/> meters
f) Lowest adjacent (finished) grade next to building (LAG)	99.7	<input checked="" type="checkbox"/> feet <input type="checkbox"/> meters
g) Highest adjacent (finished) grade next to building (HAG)	100.0	<input checked="" type="checkbox"/> feet <input type="checkbox"/> meters
h) Lowest adjacent grade at lowest elevation of deck or stairs, including structural support	99.8	<input checked="" type="checkbox"/> feet <input type="checkbox"/> meters

When B.9 is a depth above grade, it is required to indicate highest and lowest NATURAL grade in Section D Comments

SECTION D - SURVEYOR, ENGINEER, OR ARCHITECT CERTIFICATION

This certification is to be signed and sealed by a land surveyor, engineer, or architect authorized by law to certify elevation information. I certify that the information on this Certificate represents my best efforts to interpret the data available. I understand that any false statement may be punishable by fine or imprisonment under 18 U.S. Code, Section 1001.

☒ Check here if comments are provided on back of form.
☐ Check here if attachments.

Were latitude and longitude in Section A provided by a licensed land surveyor? ☐ Yes ☒ No

Certifier's Name EDGAR B. REYNOLDS JR.		License Number AZ RLS 31031	
Title LAND SURVEYOR		Company Name EDGAR REYNOLDS AND ASSOCIATES	
Address 1926 W. CALLE MECEDORA		City TUCSON	State AZ
Signature 		ZIP Code 85745	Telephone 520-884-0292
Date 6/6/2014		Telephone 520-884-0292	

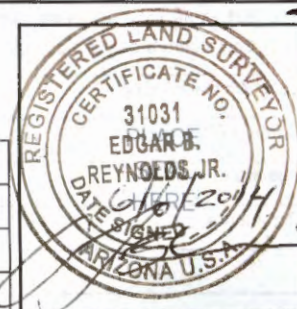

ELEVATION CERTIFICATE, page 2

IMPORTANT: In these spaces, copy the corresponding information from Section A.			FOR INSURANCE COMPANY USE	
Building Street Address (including Apt., Unit, Suite, and/or Bldg. No.) or P.O. Route and Box No. 6291 W MICHIGAN ST			Policy Number:	
City Tucson	State AZ	ZIP Code 85745	Company NAIC Number:	

SECTION D – SURVEYOR, ENGINEER, OR ARCHITECT CERTIFICATION (CONTINUED)

Copy both sides of this Elevation Certificate for (1) community official, (2) insurance agent/company, and (3) building owner.

Comments The lowest service equipment (C3.e) is the AC and the FURNACE, WATER HEATER is/are above this elevation.Highest adjacent natural grade is 100.0 Lowest adjacent natural grade is 99.7**NEW SET UP OF USED MANUFACTURED HOME, NOT SKIRTED, ON PIERS. THERE IS 1.5' BETWEEN****HIGHEST ADJACENT GRADE AND LOWEST STRUCTURAL MEMBER**Signature [Signature] Date 6/6/2014**SECTION E – BUILDING ELEVATION INFORMATION (SURVEY NOT REQUIRED) FOR ZONE AO AND ZONE A (WITHOUT BFE)**

For Zones AO and A (without BFE), complete Items E1–E5. If the Certificate is intended to support a LOMA or LOMR-F request, complete Sections A, B, and C. For Items E1–E4, use natural grade, if available. Check the measurement used. In Puerto Rico only, enter meters.

E1. Provide elevation information for the following and check the appropriate boxes to show whether the elevation is above or below the highest adjacent grade (HAG) and the lowest adjacent grade (LAG).

a) Top of bottom floor (including basement, crawlspace, or enclosure) is _____ ☐ feet ☐ meters ☐ above or ☐ below the HAG.b) Top of bottom floor (including basement, crawlspace, or enclosure) is _____ ☐ feet ☐ meters ☐ above or ☐ below the LAG.

E2. For Building Diagrams 6–9 with permanent flood openings provided in Section A Items 8 and 9 (see pages 8–9 of Instructions),

the next higher floor (elevation C2.b in the diagrams) of the building is _____ ☐ feet ☐ meters ☐ above or ☐ below the HAG.E3. Attached garage (top of slab) is _____ ☐ feet ☐ meters ☐ above or ☐ below the HAG.E4. Top of platform of machinery and/or equipment servicing the building is _____ ☐ feet ☐ meters ☐ above or ☐ below the HAG.E5. Zone AO only: If no flood depth number is available, is the top of the bottom floor elevated in accordance with the community's floodplain management ordinance? ☐ Yes ☐ No ☐ Unknown. The local official must certify this information in Section G.**SECTION F – PROPERTY OWNER (OR OWNER'S REPRESENTATIVE) CERTIFICATION**

The property owner or owner's authorized representative who completes Sections A, B, and E for Zone A (without a FEMA-issued or community-issued BFE) or Zone AO must sign here. The statements in Sections A, B, and E are correct to the best of my knowledge.

Property Owner or Owner's Authorized Representative's Name N/A

Address _____ City _____ State _____ ZIP Code _____

Signature _____ Date _____ Telephone _____

Comments _____

☐ Check here if attachments.**SECTION G – COMMUNITY INFORMATION (OPTIONAL)**

The local official who is authorized by law or ordinance to administer the community's floodplain management ordinance can complete Sections A, B, C (or E), and G of this Elevation Certificate. Complete the applicable item(s) and sign below. Check the measurement used in Items G8–G10. In Puerto Rico only, enter meters.

G1. ☐ The information in Section C was taken from other documentation that has been signed and sealed by a licensed surveyor, engineer, or architect who is authorized by law to certify elevation information. (Indicate the source and date of the elevation data in the Comments area below.)G2. ☐ A community official completed Section E for a building located in Zone A (without a FEMA-issued or community-issued BFE) or Zone AO.G3. ☐ The following information (Items G4–G9) is provided for community floodplain management purposes.G4. Permit Number FPUP# 10-017E G5. Date Permit Issued _____ G6. Date Certificate Of Compliance/Occupancy Issued _____G7. This permit has been issued for: ☐ New Construction ☐ Substantial ImprovementG8. Elevation of as-built lowest floor (including basement) of the building: _____ ☐ feet ☐ meters Datum _____G9. BFE or (in Zone AO) depth of flooding at the building site: _____ ☐ feet ☐ meters Datum _____G10. Community's design flood elevation: _____ ☐ feet ☐ meters Datum _____

Local Official's Name _____ Title _____

Community Name _____ Telephone _____

Signature _____ Date _____

Comments _____

☐ Check here if attachments.

BUILDING PHOTOGRAPHS

See Instructions for Item A6.

IMPORTANT: In these spaces, copy the corresponding information from Section A.			FOR INSURANCE COMPANY USE
Building Street Address (including Apt., Unit, Suite, and/or Bldg. No.) or P.O. Route and Box No. 6291 W MICHIGAN ST			Policy Number:
City Tucson	State AZ	ZIP Code 85765	Company NAIC Number:

If using the Elevation Certificate to obtain NFIP flood insurance, affix at least 2 building photographs below according to the instructions for Item A6. Identify all photographs with date taken; "Front View" and "Rear View"; and, if required, "Right Side View" and "Left Side View." When applicable, photographs must show the foundation with representative examples of the flood openings or vents, as indicated in Section A8. If submitting more photographs than will fit on this page, use the Continuation Page.



SW COR



SE COR



NE COR



NW COR

ALL PICTURES 6/6/2014

IMPORTANT: In these spaces, copy the corresponding information from Section A.			FOR INSURANCE COMPANY USE	
Building Street Address (including Apt., Unit, Suite, and/or Bldg. No.) or P.O. Route and Box No. 6291 W MICHIGAN ST			Policy Number:	
City Tucson	State AZ	ZIP Code 85765	Company NAIC Number:	

If submitting more photographs than will fit on the preceding page, affix the additional photographs below. Identify all photographs with: date taken; "Front View" and "Rear View"; and, if required, "Right Side View" and "Left Side View." When applicable, photographs must show the foundation with representative examples of the flood openings or vents, as indicated in Section A8.



PICTURES TAKEN 10/2/2014 EBR