

# ELEVATION CERTIFICATE

Important: Read the instructions on pages 1-9.

OMB No. 1660-0008  
Expires March 31, 2012

## SECTION A - PROPERTY INFORMATION

A1. Building Owner's Name <u>JASON AND ANDREA RANDALL</u>		For Insurance Company Use:	
A2. Building Street Address (including Apt., Unit, Suite, and/or Bldg. No.) or P.O. Route and Box No. <u>4320 E. CORONADO DRIVE</u>		Policy Number	
City <u>TUCSON</u>		Company NAIC Number	
State <u>AZ.</u>		ZIP Code <u>85718</u>	
A3. Property Description (Lot and Block Numbers, Tax Parcel Number, Legal Description, etc.) <u>TAX CODE 109-05-1490 TOWNSHIP 13 SOUTH, RANGE 14 EAST, Section 3. CORONADO FT HILLS EST. LOT 149</u>			
A4. Building Use (e.g., Residential, Non-Residential, Addition, Accessory, etc.) <u>RESIDENTIAL: SINGLE FAMILY RESIDENCE</u>			
A5. Latitude/Longitude: Lat <u>32.33181</u> Long. <u>-110.90097</u> Horizontal Datum: <input type="checkbox"/> NAD 1927 <input checked="" type="checkbox"/> NAD 1983			
A6. Attach at least 2 photographs of the building if the Certificate is being used to obtain flood insurance.			
A7. Building Diagram Number <u>3</u>			
A8. For a building with a crawlspace or enclosure(s):		A9. For a building with an attached garage:	
a) Square footage of crawlspace or enclosure(s) <u>NA</u> sq ft		a) Square footage of attached garage <u>400</u> sq ft	
b) No. of permanent flood openings in the crawlspace or enclosure(s) within 1.0 foot above adjacent grade <u>NA</u>		b) No. of permanent flood openings in the attached garage within 1.0 foot above adjacent grade <u>0</u>	
c) Total net area of flood openings in A8.b <u>NA</u> sq in		c) Total net area of flood openings in A9.b <u>0</u> sq in	
d) Engineered flood openings? <input type="checkbox"/> Yes <input checked="" type="checkbox"/> No		d) Engineered flood openings? <input type="checkbox"/> Yes <input checked="" type="checkbox"/> No	

## SECTION B - FLOOD INSURANCE RATE MAP (FIRM) INFORMATION

B1. NFIP Community Name & Community Number <u>PIMA COUNTY / 040073</u>		B2. County Name		B3. State	
B4. Map/Panel Number <u>04019C 1635</u>	B5. Suffix <u>K</u>	B6. FIRM Index Date <u>2/8/99</u>	B7. FIRM Panel Effective/Revised Date <u>2/8/99</u>	B8. Flood Zone(s) <u>A</u>	B9. Base Flood Elevation(s) (Zone AO, use base flood depth) <u>2881.0</u>
B10. Indicate the source of the Base Flood Elevation (BFE) data or base flood depth entered in Item B9. <input type="checkbox"/> FIS Profile <input type="checkbox"/> FIRM <input checked="" type="checkbox"/> Community Determined <input type="checkbox"/> Other (Describe)					
B11. Indicate elevation datum used for BFE in Item B9: <input type="checkbox"/> NGVD 1929 <input checked="" type="checkbox"/> NAVD 1988 <input type="checkbox"/> Other (Describe) <u>HIGHEST ADJACENT NATURAL GRADE</u>					
B12. Is the building located in a Coastal Barrier Resources System (CBRS) area or Otherwise Protected Area (OPA)? <input type="checkbox"/> Yes <input checked="" type="checkbox"/> No Designation Date <u>NA</u> <input type="checkbox"/> CBRS <input type="checkbox"/> OPA					

## SECTION C - BUILDING ELEVATION INFORMATION (SURVEY REQUIRED)

C1. Building elevations are based on: ☐ Construction Drawings\* ☐ Building Under Construction\* ☒ Finished Construction  
\*A new Elevation Certificate will be required when construction of the building is complete.

C2. Elevations - Zones A1-A30, AE, AH, A (with BFE), VE, V1-V30, V (with BFE), AR, AR/A, AR/AE, AR/A1-A30, AR/AH, AR/AO. Complete Items C2.a-h below according to the building diagram specified in Item A7. Use the same datum as the BFE.

Benchmark Utilized PIMA CO. GEODETIC CONTROL PT. A13 Vertical Datum NAVD 88

Conversion/Comments NA

	Check the measurement used.
a) Top of bottom floor (including basement, crawlspace, or enclosure floor) <u>2884.1</u> feet	<input type="checkbox"/> meters (Puerto Rico only)
b) Top of the next higher floor <u>2893.3</u> feet	<input type="checkbox"/> meters (Puerto Rico only)
c) Bottom of the lowest horizontal structural member (V Zones only) <u>NA</u> feet	<input type="checkbox"/> meters (Puerto Rico only)
d) Attached garage (top of slab) <u>2892.8</u> feet	<input type="checkbox"/> meters (Puerto Rico only)
e) Lowest elevation of machinery or equipment servicing the building (Describe type of equipment and location in Comments) <u>2891.8</u> feet	<input type="checkbox"/> meters (Puerto Rico only)
f) Lowest adjacent (finished) grade next to building (LAG) <u>2884.2</u> feet	<input type="checkbox"/> meters (Puerto Rico only)
g) Highest adjacent (finished) grade next to building (HAG) <u>2892.9</u> feet	<input type="checkbox"/> meters (Puerto Rico only)
h) Lowest adjacent grade at lowest elevation of deck or stairs, including structural support <u>NA</u> feet	<input type="checkbox"/> meters (Puerto Rico only)

## SECTION D - SURVEYOR, ENGINEER, OR ARCHITECT CERTIFICATION

This certification is to be signed and sealed by a land surveyor, engineer, or architect authorized by law to certify elevation information. I certify that the information on this Certificate represents my best efforts to interpret the data available. I understand that any false statement may be punishable by fine or imprisonment under 18 U.S. Code, Section 1001.

☒ Check here if comments are provided on back of form. Were latitude and longitude in Section A provided by a licensed land surveyor? ☐ Yes ☒ No

Certifier's Name <u>Fred STURNIOLO</u>		License Number <u>RLS 12537</u>	
Title <u>Vice President</u>		Company Name <u>Precision Land Surveying, Inc.</u>	
Address <u>8219 E. 22nd Street</u>		City <u>TUCSON</u>	
State <u>ARIZ</u>		ZIP Code <u>85710</u>	
Signature <u>Fred Sturniolo</u>		Date <u>9/27/2011</u>	
Telephone <u>520-298-3200</u>			





**IMPORTANT: In these spaces, copy the corresponding information from Section A.**

Building Street Address (including Apt., Unit, Suite, and/or Bldg. No.) or P.O. Route and Box No.

4320 E. CORONADO DRIVE

City

TUCSON

State

ARIZ

ZIP Code

85718

For Insurance Company Use:

Policy Number

Company NAIC Number

**SECTION D - SURVEYOR, ENGINEER, OR ARCHITECT CERTIFICATION (CONTINUED)**

Copy both sides of this Elevation Certificate for (1) community official, (2) insurance agent/company, and (3) building owner.

Comments Lowest equipment servicing building is the A/C unit  
Base elevation = 2891.8 Lowest adjacent natural grade = 2882.9  
Highest adjacent natural grade = 2894.2

Signature

Fred Stummich

Date

9/27/2011

☒ Check here if attachments

**SECTION E - BUILDING ELEVATION INFORMATION (SURVEY NOT REQUIRED) FOR ZONE AO AND ZONE A (WITHOUT BFE)**

For Zones AO and A (without BFE), complete Items E1-E5. If the Certificate is intended to support a LOMA or LOMR-F request, complete Sections A, B, and C. For Items E1-E4, use natural grade, if available. Check the measurement used. In Puerto Rico only, enter meters.

- E1. Provide elevation information for the following and check the appropriate boxes to show whether the elevation is above or below the highest adjacent grade (HAG) and the lowest adjacent grade (LAG).
- a) Top of bottom floor (including basement, crawlspace, or enclosure) is \_\_\_\_\_ feet ☐ meters ☐ above or ☐ below the HAG.
- b) Top of bottom floor (including basement, crawlspace, or enclosure) is \_\_\_\_\_ feet ☐ meters ☐ above or ☐ below the LAG.
- E2. For Building Diagrams 6-9 with permanent flood openings provided in Section A Items 8 and/or 9 (see pages 8-9 of Instructions), the next higher floor (elevation C2.b in the diagrams) of the building is \_\_\_\_\_ feet ☐ meters ☐ above or ☐ below the HAG.
- E3. Attached garage (top of slab) is \_\_\_\_\_ feet ☐ meters ☐ above or ☐ below the HAG.
- E4. Top of platform of machinery and/or equipment servicing the building is \_\_\_\_\_ feet ☐ meters ☐ above or ☐ below the HAG.
- E5. Zone AO only: If no flood depth number is available, is the top of the bottom floor elevated in accordance with the community's floodplain management ordinance? ☐ Yes ☐ No ☐ Unknown. The local official must certify this information in Section G.

**SECTION F - PROPERTY OWNER (OR OWNER'S REPRESENTATIVE) CERTIFICATION**

The property owner or owner's authorized representative who completes Sections A, B, and E for Zone A (without a FEMA-issued or community-issued BFE) or Zone AO must sign here. The statements in Sections A, B, and E are correct to the best of my knowledge.

Property Owner's or Owner's Authorized Representative's Name

Address

City

State

ZIP Code

Signature

Date

Telephone

Comments

☐ Check here if attachments

**SECTION G - COMMUNITY INFORMATION (OPTIONAL)**

The local official who is authorized by law or ordinance to administer the community's floodplain management ordinance can complete Sections A, B, C (or E), and G of this Elevation Certificate. Complete the applicable item(s) and sign below. Check the measurement used in Items G8 and G9.

- G1. ☐ The information in Section C was taken from other documentation that has been signed and sealed by a licensed surveyor, engineer, or architect who is authorized by law to certify elevation information. (Indicate the source and date of the elevation data in the Comments area below.)
- G2. ☐ A community official completed Section E for a building located in Zone A (without a FEMA-issued or community-issued BFE) or Zone AO.
- G3. ☐ The following information (Items G4-G9) is provided for community floodplain management purposes.

G4. Permit Number	G5. Date Permit Issued	G6. Date Certificate Of Compliance/Occupancy Issued
-------------------	------------------------	---

G7. This permit has been issued for: ☐ New Construction ☐ Substantial Improvement

G8. Elevation of as-built lowest floor (including basement) of the building \_\_\_\_\_ feet ☐ meters (PR) Datum \_\_\_\_\_

G9. BFE or (in Zone AO) depth of flooding at the building site \_\_\_\_\_ feet ☐ meters (PR) Datum \_\_\_\_\_

G10. Community's design flood elevation \_\_\_\_\_ feet ☐ meters (PR) Datum \_\_\_\_\_

Local Official's Name

Francisco Ramirez

Title

Hydrologist

Community Name

Pima County RFCD

Telephone

520-243-1800

Signature

F. Ramirez

Date

9/30/11

Comments

per phone conversation w/ surveyor HANG should be 2884.2

☐ Check here if attachments



# Building Photographs

Continuation Page

Building Street Address (including Apt., Unit, Suite, and/or Bldg. No.) or P.O. Route and Box No. <b>4320 E. CORONADO DRIVE</b>			For Insurance Company Use: Policy Number /
City <b>TUCSON</b>	State <b>ARIZ</b>	ZIP Code <b>85718</b>	Company NAIC Number

If submitting more photographs than will fit on the preceding page, affix the additional photographs below. Identify all photographs with: date taken; "Front View" and "Rear View"; and, if required, "Right Side View" and "Left Side View."



EAST  
|  
|  
|  
LEFT



WEST  
|  
|  
|  
RIGHT



## Building Photographs

See Instructions for Item A6.

Building Street Address (including Apt., Unit, Suite, and/or Bldg. No.) or P.O. Route and Box No. <b>4320 E. CORONADO DRIVE</b>			For Insurance Company Use: Policy Number
City <b>TUCSON</b>	State <b>ARIZ</b>	ZIP Code <b>85718</b>	Company NAIC Number

If using the Elevation Certificate to obtain NFIP flood insurance, affix at least two building photographs below according to the instructions for Item A6. Identify all photographs with: date taken; "Front View" and "Rear View"; and, if required, "Right Side View" and "Left Side View." If submitting more photographs than will fit on this page, use the Continuation Page on the reverse.



North  
↑  
Left  
FRONT



South  
↑  
REAR



FPUP# 10-269E P 10 CP 03249  
U.S. DEPARTMENT OF HOMELAND SECURITY  
Federal Emergency Management Agency  
National Flood Insurance Program

**ELEVATION CERTIFICATE**

OMB No. 1660-0008  
Expires March 31, 2012

Important: Read the instructions on pages 1-9.

**SECTION A - PROPERTY INFORMATION**

A1. Building Owner's Name <b>Jason and Andrea Randall</b>		For Insurance Company Use
A2. Building Street Address (Including Apt., Unit, Suite, and/or Bldg. No.) or P.O. Route and Box No. <b>4320 E. Coronado Dr.</b>		Policy Number
City <b>Tucson</b> State <b>AZ</b> ZIP Code <b>85718</b>		Company NAIC Number
A3. Property Description (Lot and Block Numbers, Tax Parcel Number, Legal Description, etc.) <b>Tax Code 109-05-1490 Township 13 Range 14 Section 03 Coronado Foothills Estates Lot 149</b>		
A4. Building Use (e.g., Residential, Non-Residential, Addition, Accessory, etc.) <b>Residential: Single Family Residence</b>		
A5. Latitude/Longitude: Lat. <b>32.331819</b> Long. <b>-110.900975</b> Horizontal Datum: <input type="checkbox"/> NAD 1927 <input checked="" type="checkbox"/> NAD 1983		
A6. Attach at least 2 photographs of the building if the Certificate is being used to obtain flood insurance.		
A7. Building Diagram Number <b>1</b>		
A8. For a building with a crawlspace or enclosure(s):		
a) Square footage of crawlspace or enclosure(s) <b>NA</b> sq ft		
b) No. of permanent flood openings in the crawlspace or enclosure(s) within 1.0 foot above adjacent grade <b>NA</b>		
c) Total net area of flood openings in A8.b <b>NA</b> sq in		
d) Engineered flood openings? <input type="checkbox"/> Yes <input checked="" type="checkbox"/> No		
A9. For a building with an attached garage:		
a) Square footage of attached garage <b>400</b> sq ft		
b) No. of permanent flood openings in the attached garage within 1.0 foot above adjacent grade <b>0</b>		
c) Total net area of flood openings in A9.b <b>0</b> sq in		
d) Engineered flood openings? <input type="checkbox"/> Yes <input checked="" type="checkbox"/> No		

**SECTION B - FLOOD INSURANCE RATE MAP (FIRM) INFORMATION**

B1. NFIP Community Name & Community Number <b>Pima County / 040073</b>		B2. County Name <b>Pima County</b>		B3. State <b>AZ</b>	
B4. Map/Panel Number <b>04019C 1635</b>	B5. Suffix <b>K</b>	B6. FIRM Index Date <b>2/8/99</b>	B7. FIRM Panel Effective/Revised Date <b>2/8/99</b>	B8. Flood Zone(s) <b>A</b>	B9. Base Flood Elevation(s) (Zone AO, use base flood depth) <b>2883.8</b>
B10. Indicate the source of the Base Flood Elevation (BFE) data or base flood depth entered in Item B9. <input type="checkbox"/> FIS Profile <input type="checkbox"/> FIRM <input checked="" type="checkbox"/> Community Determined <input type="checkbox"/> Other (Describe)					
B11. Indicate elevation datum used for BFE in Item B9: <input type="checkbox"/> NGVD 1929 <input checked="" type="checkbox"/> NAVD 1988 <input type="checkbox"/> Other (Describe) <b>Highest Adjacent Natural Grade</b>					
B12. Is the building located in a Coastal Barrier Resources System (CBRS) area or Otherwise Protected Area (OPA)? <input type="checkbox"/> Yes <input checked="" type="checkbox"/> No Designation Date <b>N/A</b> <input type="checkbox"/> CBRS <input type="checkbox"/> OPA					

**SECTION C - BUILDING ELEVATION INFORMATION (SURVEY REQUIRED)**

C1. Building elevations are based on: ☐ Construction Drawings\* ☐ Building Under Construction\* ☒ Finished Construction  
\*A new Elevation Certificate will be required when construction of the building is complete.

C2. Elevations - Zones A1-A30, AE, AH, A (with BFE), VE, V1-V30, V (with BFE), AR, AR/A, AR/AE, AR/A1-A30, AR/AH, AR/AO. Complete Items C2.a-h below according to the building diagram specified in Item A7. Use the same datum as the BFE.  
Benchmark Utilized **Pima Co. Geodetic Control Pt. A13** Vertical Datum **NAVD 88 Elev = 3106.24**  
Conversion/Comments **N/A**

	Check the measurement used.
a) Top of bottom floor (including basement, crawlspace, or enclosure floor) <b>2893.3</b>	<input checked="" type="checkbox"/> feet <input type="checkbox"/> meters (Puerto Rico only)
b) Top of the next higher floor <b>NA</b>	<input checked="" type="checkbox"/> feet <input type="checkbox"/> meters (Puerto Rico only)
c) Bottom of the lowest horizontal structural member (V Zones only) <b>N/A</b>	<input checked="" type="checkbox"/> feet <input type="checkbox"/> meters (Puerto Rico only)
d) Attached garage (top of slab) <b>2892.8</b>	<input checked="" type="checkbox"/> feet <input type="checkbox"/> meters (Puerto Rico only)
e) Lowest elevation of machinery or equipment servicing the building (Describe type of equipment and location in Comments) <b>2891.8</b>	<input checked="" type="checkbox"/> feet <input type="checkbox"/> meters (Puerto Rico only)
f) Lowest adjacent (finished) grade next to building (LAG) <b>2885.3</b>	<input checked="" type="checkbox"/> feet <input type="checkbox"/> meters (Puerto Rico only)
g) Highest adjacent (finished) grade next to building (HAG) <b>2892.9</b>	<input checked="" type="checkbox"/> feet <input type="checkbox"/> meters (Puerto Rico only)
h) Lowest adjacent grade at lowest elevation of deck or stairs, including structural support <b>NA</b>	<input checked="" type="checkbox"/> feet <input type="checkbox"/> meters (Puerto Rico only)

**SECTION D - SURVEYOR, ENGINEER, OR ARCHITECT CERTIFICATION**

This certification is to be signed and sealed by a land surveyor, engineer, or architect authorized by law to certify elevation information. I certify that the information on this Certificate represents my best efforts to interpret the data available. I understand that any false statement may be punishable by fine or imprisonment under 18 U.S. Code, Section 1001.

☒ Check here if comments are provided on back of form.Were latitude and longitude in Section A provided by a licensed land surveyor? ☐ Yes ☒ No

Certifier's Name <b>Fred STURNIOLA</b>		License Number <b>RLS 12537</b>	
Title <b>Vice President</b>		Company Name <b>Precision Land Surveying, Inc</b>	
Address <b>8219 E. 22<sup>ND</sup> ST.</b>		City <b>TUCSON</b> State <b>AZ</b> ZIP Code <b>85710</b>	
Signature <b>Fred Sturniola</b>		Date <b>6/22/2010</b> Telephone <b>520 298 3200</b>	

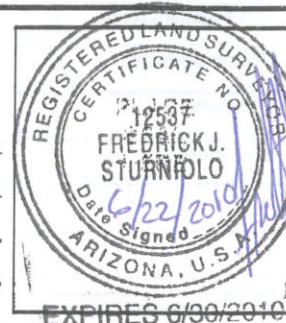



FPUP# 10-269E

P 10 CP 03249

**IMPORTANT: In these spaces, copy the corresponding information from Section A.**

Building Street Address (Including Apt., Unit, Suite, and/or Bldg. No.) or P.O. Route and Box No.

4320 E. Coronado Dr.

City Tucson

State AZ

ZIP Code  
85718

For Insurance Company Use:

Policy Number

Company NAIC Number

**SECTION D - SURVEYOR, ENGINEER, OR ARCHITECT CERTIFICATION (CONTINUED)**

Copy both sides of this Elevation Certificate for (1) community official, (2) insurance agent/company, and (3) building owner.

Comments The lowest service equipment (C2.e) is the A/C UNIT and the BASE elev = 2891.8 is/are above this elevation.  
Highest adjacent natural grade is 2894.2 Lowest adjacent natural grade is 2883.4

Signature

*And Stumm*

Date

6/22/2010

☒ Check here if attachments**SECTION E - BUILDING ELEVATION INFORMATION (SURVEY NOT REQUIRED) FOR ZONE AO AND ZONE A (WITHOUT BFE)**

For Zones AO and A (without BFE), complete items E1-E5. If the Certificate is intended to support a LOMA or LOMR-F request, complete Sections A, B, and C. For items E1-E4, use natural grade, if available. Check the measurement used. In Puerto Rico only, enter meters.

E1. Provide elevation information for the following and check the appropriate boxes to show whether the elevation is above or below the highest adjacent grade (HAG) and the lowest adjacent grade (LAG).

a) Top of bottom floor (including basement, crawlspace, or enclosure) is NA feet NA meters ☐ above or ☐ below the HAG.b) Top of bottom floor (including basement, crawlspace, or enclosure) is NA feet NA meters ☐ above or ☐ below the LAG.E2. For Building Diagrams 8-9 with permanent flood openings provided in Section A items 8-9 (see pages 8-9 of instructions), the next higher floor (elevation C2.b in the diagrams) of the building is NA feet NA meters ☐ above or ☐ below the HAG.E3. Attached garage (top of slab) is NA feet NA meters ☐ above or ☐ below the HAG.E4. Top of platform of machinery and/or equipment servicing the building is NA feet NA meters ☐ above or ☐ below the HAG.E5. Zone AO only: If no flood depth number is available, is the top of the bottom floor elevated in accordance with the community's floodplain management ordinance? ☐ Yes ☐ No ☐ Unknown. The local official must certify this information in Section G.**SECTION F - PROPERTY OWNER (OR OWNER'S REPRESENTATIVE) CERTIFICATION**

The property owner or owner's authorized representative who completes Sections A, B, and E for Zone A (without a FEMA-issued or community-issued BFE) or Zone AO must sign here. The statements in Sections A, B, and E are correct to the best of my knowledge.

Property Owner's or Owner's Authorized Representative's Name

Address

City

State

ZIP Code

Signature

Date

Telephone

Comments

☐ Check here if attachments**SECTION G - COMMUNITY INFORMATION (OPTIONAL)**

The local official who is authorized by law or ordinance to administer the community's floodplain management ordinance can complete Sections A, B, C (or E), and G of this Elevation Certificate. Complete the applicable item(s) and sign below. Check the measurement used in items G8 and G9.

G1. ☐ The information in Section C was taken from other documentation that has been signed and sealed by a licensed surveyor, engineer, or architect who is authorized by law to certify elevation information. (Indicate the source and date of the elevation data in the Comments area below.)G2. ☐ A community official completed Section E for a building located in Zone A (without a FEMA-issued or community-issued BFE) or Zone AO.G3. ☐ The following information (items G4-G9) is provided for community floodplain management purposes.G4. Permit Number  
FPUP# 10-269E

G5. Date Permit Issued

G6. Date Certificate Of Compliance/Occupancy Issued

G7. This permit has been issued for: ☐ New Construction ☐ Substantial ImprovementG8. Elevation of as-built lowest floor (including basement) of the building NA feet NA meters (PR) Datum NAG9. BFE or (in Zone AO) depth of flooding at the building site NA feet NA meters (PR) Datum NAG10. Community's design flood elevation NA feet NA meters (PR) Datum NA

Local Official's Name

*Francisco Ramirez*

Title

*Sr. CEA*

Community Name

*Pima Co. RFCD*

Telephone

*243-1800*

Signature

*F. Ramirez*

Date

*6/29/10*

Comments

*Surveyor says Building Diagram Number is 1 A.*☐ Check here if attachments



FPUP# 10-269E

**Building Photographs(Four Color Photographs Required)**

See Instructions for Item A6.

Building Street Address (Including Apt., Unit, Suite, and/or Bldg. No.) or P.O. Route and Box No.

4320 E. Coronado Dr.

City  
TucsonState  
AZZIP Code  
85718

If using the Elevation Certificate to obtain NFIP flood insurance, affix at least Four building photographs below according to the instructions for Item A6. Identify all photographs with: date taken; "Front View" and "Rear View"; and, if required, "Right Side View" and "Left Side View." If submitting more photographs than will fit on this page, use the Continuation Page on the reverse.

FRONT  
SIDE

North

Rear  
View

South



FPUP# 10-269E

**Building Photographs**  
Continuation Page

Building Street Address (including Apt., Unit, Suite, and/or Bldg. No.) or P.O. Route and Box No. 4320 E. Coronado Dr.			For Insurance Company Use: Policy Number
City Tucson	State AZ	ZIP Code 85718	Company NAIC Number

If submitting more photographs than will fit on the preceding page, affix the additional photographs below. Identify all photographs with: date taken; "Front View" and "Rear View"; and, if required, "Right Side View" and "Left Side View."

LEFT  
SIDE

EAST

RIGHT  
SIDE

WEST