

ELEVATION CERTIFICATE

Important: Read the instructions on pages 1-9.

OMB No. 1660-0008
Expires March 31, 2012

SECTION A - PROPERTY INFORMATION		For Insurance Company Use:
A1. Building Owner's Name Joe Richardson		Policy Number
A2. Building Street Address (including Apt., Unit, Suite, and/or Bldg. No.) or P.O. Route and Box No. 16625 W. Brenda St.		Company NAIC Number
City Tucson	State AZ	ZIP Code 85736
A3. Property Description (Lot and Block Numbers, Tax Parcel Number, Legal Description, etc.) Tax Code 301-20-012B Township 16S Range 10E Section 09		
A4. Building Use (e.g., Residential, Non-Residential, Addition, Accessory, etc.) Residential: Manufactured Home Replacement		
A5. Latitude/Longitude: Lat. 32.050737 Long. -111.317140 Horizontal Datum: <input type="checkbox"/> NAD 1927 <input checked="" type="checkbox"/> NAD 1983		
A6. Attach at least 2 photographs of the building if the Certificate is being used to obtain flood insurance.		
A7. Building Diagram Number 5		
A8. For a building with a crawlspace or enclosure(s): a) Square footage of crawlspace or enclosure(s) NA sq ft b) No. of permanent flood openings in the crawlspace or enclosure(s) within 1.0 foot above adjacent grade NA c) Total net area of flood openings in A8.b NA sq in d) Engineered flood openings? <input type="checkbox"/> Yes <input checked="" type="checkbox"/> No		
A9. For a building with an attached garage: a) Square footage of attached garage NA sq ft b) No. of permanent flood openings in the attached garage within 1.0 foot above adjacent grade NA c) Total net area of flood openings in A9.b NA sq in d) Engineered flood openings? <input type="checkbox"/> Yes <input checked="" type="checkbox"/> No		

SECTION B - FLOOD INSURANCE RATE MAP (FIRM) INFORMATION					
B1. NFIP Community Name & Community Number Pima County / 040073		B2. County Name Pima County		B3. State AZ	
B4. Map/Panel Number 04019C 2775	B5. Suffix K	B6. FIRM Index Date 2-8-99	B7. FIRM Panel Effective/Revised Date 02/08/1999	B8. Flood Zone(s) X	B9. Base Flood Elevation(s) (Zone AO, use base flood depth) 0.5
B10. Indicate the source of the Base Flood Elevation (BFE) data or base flood depth entered in Item B9. <input type="checkbox"/> FIS Profile <input type="checkbox"/> FIRM <input checked="" type="checkbox"/> Community Determined <input type="checkbox"/> Other (Describe)					
B11. Indicate elevation datum used for BFE in Item B9: <input type="checkbox"/> NGVD 1929 <input type="checkbox"/> NAVD 1988 <input checked="" type="checkbox"/> Other (Describe) Highest Adjacent Natural Grade					
B12. Is the building located in a Coastal Barrier Resources System (CBRS) area or Otherwise Protected Area (OPA)? <input type="checkbox"/> Yes <input checked="" type="checkbox"/> No Designation Date N/A <input type="checkbox"/> CBRS <input type="checkbox"/> OPA					

SECTION C - BUILDING ELEVATION INFORMATION (SURVEY REQUIRED)	
C1. Building elevations are based on: <input type="checkbox"/> Construction Drawings* <input type="checkbox"/> Building Under Construction* <input checked="" type="checkbox"/> Finished Construction *A new Elevation Certificate will be required when construction of the building is complete.	
C2. Elevations - Zones A1-A30, AE, AH, A (with BFE), VE, V1-V30, V (with BFE), AR, AR/A, AR/AE, AR/A1-A30, AR/AH, AR/AO. Complete Items C2.a-h below according to the building diagram specified in Item A7. Use the same datum as the BFE. Benchmark Utilized existing Finish Floor of Home Vertical Datum Assumed 100.0 Conversion/Comments NA	
Check the measurement used.	
a) Top of bottom floor (including basement, crawlspace, or enclosure floor) 100.0 <input checked="" type="checkbox"/> feet <input type="checkbox"/> meters (Puerto Rico only)	
b) Top of the next higher floor NA <input checked="" type="checkbox"/> feet <input type="checkbox"/> meters (Puerto Rico only)	
c) Bottom of the lowest horizontal structural member (V Zones only) N/A <input checked="" type="checkbox"/> feet <input type="checkbox"/> meters (Puerto Rico only)	
d) Attached garage (top of slab) NA <input checked="" type="checkbox"/> feet <input type="checkbox"/> meters (Puerto Rico only)	
e) Lowest elevation of machinery or equipment servicing the building (Describe type of equipment and location in Comments) 98.7 <input checked="" type="checkbox"/> feet <input type="checkbox"/> meters (Puerto Rico only)	
f) Lowest adjacent (finished) grade next to building (LAG) 96.6 <input checked="" type="checkbox"/> feet <input type="checkbox"/> meters (Puerto Rico only)	
g) Highest adjacent (finished) grade next to building (HAG) 97.0 <input checked="" type="checkbox"/> feet <input type="checkbox"/> meters (Puerto Rico only)	
h) Lowest adjacent grade at lowest elevation of deck or stairs, including structural support NA <input checked="" type="checkbox"/> feet <input type="checkbox"/> meters (Puerto Rico only)	

SECTION D - SURVEYOR, ENGINEER, OR ARCHITECT CERTIFICATION	
This certification is to be signed and sealed by a land surveyor, engineer, or architect authorized by law to certify elevation information. I certify that the information on this Certificate represents my best efforts to interpret the data available. I understand that any false statement may be punishable by fine or imprisonment under 18 U.S. Code, Section 1001.	
<input checked="" type="checkbox"/> Check here if comments are provided on back of form. Were latitude and longitude in Section A provided by a licensed land surveyor? <input type="checkbox"/> Yes <input checked="" type="checkbox"/> No	
Certifier's Name Fred STURNIOLO	License Number RLS 12537
Title Vice President	Company Name Precision Land Surveying, Inc.
Address 8219 E. 27th St.	City Tucson
State AZ	ZIP Code 85710
Signature <i>Fred Sturniolo</i>	Date 7/25/2011
Telephone 520 298 3200	

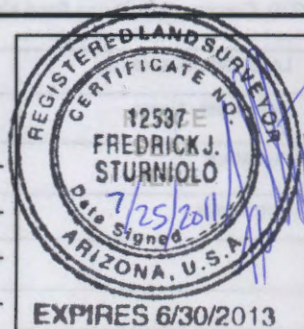

IMPORTANT: In these spaces, copy the corresponding information from Section A.		For Insurance Company Use:
Building Street Address (including Apt., Unit, Suite, and/or Bldg. No.) or P.O. Route and Box No. 16625 W. Brenda St.		Policy Number
City Tucson	State AZ	ZIP Code 85736
		Company NAIC Number

SECTION D - SURVEYOR, ENGINEER, OR ARCHITECT CERTIFICATION (CONTINUED)

Copy both sides of this Elevation Certificate for (1) community official, (2) insurance agent/company, and (3) building owner.

Comments The lowest service equipment (C2.e) is the electric and the meter = elev is 98.7 is/are above this elevation.
Highest adjacent natural grade is 96.9 Lowest adjacent natural grade is 95.6
lowest structural steel member is 98.6

Signature [Signature] Date 7/25/2011 ☒ Check here if attachments

SECTION E - BUILDING ELEVATION INFORMATION (SURVEY NOT REQUIRED) FOR ZONE AO AND ZONE A (WITHOUT BFE)

For Zones AO and A (without BFE), complete Items E1-E5. If the Certificate is intended to support a LOMA or LOMR-F request, complete Sections A, B, and C. For Items E1-E4, use natural grade, if available. Check the measurement used. In Puerto Rico only, enter meters.

- E1. Provide elevation information for the following and check the appropriate boxes to show whether the elevation is above or below the highest adjacent grade (HAG) and the lowest adjacent grade (LAG).
a) Top of bottom floor (including basement, crawlspace, enclosure) is _____ feet _____ meters ☐ above or ☐ below the HAG.
b) Top of bottom floor (including basement, crawlspace, enclosure) is _____ feet _____ meters ☐ above or ☐ below the LAG.
- E2. For Building Diagrams 6-9 with permanent flood openings provided in Section A Items J and K (see pages 8-9 of Instructions), the next higher floor (elevation C2.b in the diagrams) of the building is _____ feet _____ meters ☐ above or ☐ below the HAG.
- E3. Attached garage (top of slab) is _____ feet _____ meters ☐ above or ☐ below the HAG.
- E4. Top of platform of machinery and/or equipment servicing the building is _____ feet _____ meters ☐ above or ☐ below the HAG.
- E5. Zone AO only: If no flood depth number is available, is the top of the bottom floor elevated in accordance with the community's floodplain management ordinance? ☐ Yes ☐ No ☐ Unknown. The local official must certify this information in Section G.

SECTION F - PROPERTY OWNER (OR OWNER'S REPRESENTATIVE) CERTIFICATION

The property owner or owner's authorized representative who completes Sections A, B, and E for Zone A (without a FEMA-issued or community-issued BFE) or Zone AO must sign here. The statements in Sections A, B, and E are correct to the best of my knowledge.

Property Owner's or Owner's Authorized Representative's Name

Address _____ City _____ State _____ ZIP Code _____
Signature _____ Date _____ Telephone _____
Comments _____

☐ Check here if attachments**SECTION G - COMMUNITY INFORMATION (OPTIONAL)**

The local official who is authorized by law or ordinance to administer the community's floodplain management ordinance can complete Sections A, B, C (or E), and G of this Elevation Certificate. Complete the applicable item(s) and sign below. Check the measurement used in Items G8 and G9.

- G1. ☐ The information in Section C was taken from other documentation that has been signed and sealed by a licensed surveyor, engineer, or architect who is authorized by law to certify elevation information. (Indicate the source and date of the elevation data in the Comments area below.)
G2. ☐ A community official completed Section E for a building located in Zone A (without a FEMA-issued or community-issued BFE) or Zone AO.
G3. ☐ The following information (Items G4-G9) is provided for community floodplain management purposes.

G4. Permit Number FPUP# 11-133E	G5. Date Permit Issued	G6. Date Certificate Of Compliance/Occupancy Issued
------------------------------------	------------------------	---

- G7. This permit has been issued for: ☐ New Construction ☐ Substantial Improvement
- G8. Elevation of as-built lowest floor (including basement) of the building _____ feet _____ meters (PR) Datum _____
- G9. BFE or (in Zone AO) depth of flooding at the building site _____ feet _____ meters (PR) Datum _____
- G10. Community's design flood elevation _____ feet _____ meters (PR) Datum _____

Local Official's Name _____ Title _____
Community Name _____ Telephone _____
Signature _____ Date _____
Comments _____

☐ Check here if attachments

FPUP# 11-133E

Building Photographs(Four Color Photographs Required)

See Instructions for Item A6.

Building Street Address (including Apt., Unit, Suite, and/or Bldg. No.) or P.O. Route and Box No. 16625 W. Brenda St.			For Insurance Company Use: Policy Number
City Tucson	State AZ	ZIP Code 85736	Company NAIC Number

If using the Elevation Certificate to obtain NFIP flood insurance, affix at least **Four** building photographs below according to the instructions for Item A6. Identify all photographs with: date taken; "Front View" and "Rear View"; and, if required, "Right Side View" and "Left Side View." If submitting more photographs than will fit on this page, use the Continuation Page on the reverse.



North
↓
Right



South
↓
Left

FPUP# 11-133E

Building Photographs

Continuation Page

Building Street Address (including Apt., Unit, Suite, and/or Bldg. No.) or P.O. Route and Box No. 16625 W. Brenda St.			For Insurance Company Use: Policy Number
City Tucson	State AZ	ZIP Code 85736	Company NAIC Number

If submitting more photographs than will fit on the preceding page, affix the additional photographs below. Identify all photographs with: date taken; "Front View" and "Rear View"; and, if required, "Right Side View" and "Left Side View."



EAST
1
1
FRONT



WEST
1
1
REAR