

ELEVATION CERTIFICATE

IMPORTANT: Follow the instructions on pages 1-9.

OMB No. 1660-0008

Expiration Date: July 31, 2015

SECTION A - PROPERTY INFORMATIONA1. Building Owner's Name **Nathaniel Zuniga**

FOR INSURANCE COMPANY USE

Policy Number:

A2. Building Street Address (including Apt., Unit, Suite, and/or Bldg. No.) or P.O. Route and Box No.
4408 S. Aldon Rd.

Company NAIC Number:

City **Tucson**State **AZ**ZIP Code **85735**A3. Property Description (Lot and Block Numbers, Tax Parcel Number, Legal Description, etc.)
Tax Code 212-41-018E Township 14S Range 12E Section 33A4. Building Use (e.g., Residential, Non-Residential, Addition, Accessory, etc.) **Residential: Single Family Residence**A5. Latitude/Longitude: Lat. **32.169339** Long. **-111.120784**Horizontal Datum: ☐ NAD 1927 ☒ NAD 1983

A6. Attach at least 2 photographs of the building if the Certificate is being used to obtain flood insurance.

A7. Building Diagram Number **18**

A8. For a building with a crawlspace or enclosure(s):

a) Square footage of crawlspace or enclosure(s) **N/A** sq ftb) No. of permanent flood openings in the crawlspace or enclosure(s) within 1.0 foot above adjacent grade **N/A**c) Total net area of flood openings in A8.b **N/A** sq ind) Engineered flood openings? ☐ Yes ☐ No

A9. For a building with an attached garage:

a) Square footage of attached garage **784** sq ftb) Number of permanent flood openings in the attached garage within 1.0 foot above adjacent grade **0**c) Total net area of flood openings in A9.b **0** sq ind) Engineered flood openings? ☐ Yes ☒ No**SECTION B - FLOOD INSURANCE RATE MAP (FIRM) INFORMATION**B1. NFIP Community Name & Community Number
Pima County / 040073B2. County Name **Pima County**B3. State **AZ**B4. Map/Panel Number **04019C 2265**B5. Suffix **L**B6. FIRM Index Date **6-16-11**B7. FIRM Panel Effective/ Revised Date **6-16-11**B8. Flood Zone(s) **X**B9. Base Flood Elevation(s) (Zone A0, use base flood depth) **100.5**

B10. Indicate the source of the Base Flood Elevation (BFE) data or base flood depth entered in Item B9:

☐ FIS Profile ☐ FIRM ☒ Community Determined ☐ Other/Source:B11. Indicate elevation datum used for BFE in Item B9: ☐ NGVD 1929 ☐ NAVD 1988 ☒ Other/Source: **Highest Adj. Nat. Grade (±100 ft)**B12. Is the building located in a Coastal Barrier Resources System (CBRS) area or Otherwise Protected Area (OPA)? ☐ Yes ☒ NoDesignation Date: **N/A** ☐ CBRS ☐ OPA**SECTION C - BUILDING ELEVATION INFORMATION (SURVEY REQUIRED)**C1. Building elevations are based on: ☐ Construction Drawings* ☐ Building Under Construction* ☒ Finished Construction

*A new Elevation Certificate will be required when construction of the building is complete.

C2. Elevations - Zones A1-A30, AE, AH, A (with BFE), VE, V1-V30, V (with BFE), AR, AR/A, AR/AE, AR/A1-A30, AR/AH, AR/AO. Complete Items C2.a-h below according to the building diagram specified in Item A7. In Puerto Rico only, enter meters.

Benchmark Utilized: **HIGHEST ADJACENT GRADE (LOCAL FIRM)** Vertical Datum: **LOCAL ASSUMED**Indicate elevation datum used for the elevations in items a) through h) below. ☐ NGVD 1929 ☐ NAVD 1988 ☒ Other/Source: **LOCAL ASSUMED**

Datum used for building elevations must be the same as that used for the BFE.

Check the measurement used.

a) Top of bottom floor (including basement, crawlspace, or enclosure floor) **102.20**☒ feet ☐ metersb) Top of the next higher floor **N/A**☒ feet ☐ metersc) Bottom of the lowest horizontal structural member (V Zones only) **N/A**☒ feet ☐ metersd) Attached garage (top of slab) **102.12**☒ feet ☐ meterse) Lowest elevation of machinery or equipment servicing the building (Describe type of equipment and location in Comments) **101.10**☒ feet ☐ metersf) Lowest adjacent (finished) grade next to building (LAG) **99.2**☒ feet ☐ metersg) Highest adjacent (finished) grade next to building (HAG) **102.12**☒ feet ☐ metersh) Lowest adjacent grade at lowest elevation of deck or stairs, including structural support **99.1**☒ feet ☐ meters

When B.9 is a depth above grade, it is required to indicate highest and lowest NATURAL grade in Section D Comments

SECTION D - SURVEYOR, ENGINEER, OR ARCHITECT CERTIFICATION

This certification is to be signed and sealed by a land surveyor, engineer, or architect authorized by law to certify elevation information. I certify that the information on this Certificate represents my best efforts to interpret the data available. I understand that any false statement may be punishable by fine or imprisonment under 18 U.S. Code, Section 1001.

☐ Check here if comments are provided on back of form.Were latitude and longitude in Section A provided by a licensed land surveyor? ☐ Yes ☐ No☐ Check here if attachments.

Certifier's Name DAVID A. RHINE		License Number AZ # 24530	
Title	Company Name		
Address 7320 N. LA CNOCHA Blvd. STE 154-127	City TUCSON	State AZ	ZIP Code 85741
Signature David A. Rhine	Date 8/15/2013	Telephone 520-490-2027	

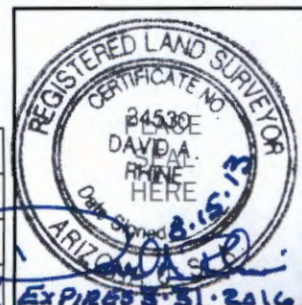

ELEVATION CERTIFICATE, page 2

IMPORTANT: In these spaces, copy the corresponding information from Section A.

Building Street Address (including Apt., Unit, Suite, and/or Bldg. No.) or PO. Route and Box No.

4408 S. Aldon Rd.

City
TucsonState
AZZIP Code
85735

FOR INSURANCE COMPANY USE

Policy Number:

Company NAIC Number:

SECTION D - SURVEYOR, ENGINEER, OR ARCHITECT CERTIFICATION (CONTINUED)

Copy both sides of this Elevation Certificate for (1) community official, (2) insurance agent/company, and (3) building owner.

Comments The lowest service equipment (C3.e) is the HEAT PUMP and the WATER HEATER/ELEC SERVICE is/are above this elevation.
Highest adjacent natural grade is 100.2 Lowest adjacent natural grade is 99.2

Signature

Date

8.15.2013

SECTION E - BUILDING ELEVATION INFORMATION (SURVEY NOT REQUIRED) FOR ZONE AO AND ZONE A (WITHOUT BFE)

For Zones AO and A (without BFE), complete Items E1-E5. If the Certificate is intended to support a LOMA or LOMR-F request, complete Sections A, B, and C. For Items E1-E4, use natural grade, if available. Check the measurement used. In Puerto Rico only, enter meters.

E1. Provide elevation information for the following and check the appropriate boxes to show whether the elevation is above or below the highest adjacent grade (HAG) and the lowest adjacent grade (LAG).

a) Top of bottom floor (including basement, crawlspace, or enclosure) is _____ feet _____ meters ☐ above or ☐ below the HAG.b) Top of bottom floor (including basement, crawlspace, or enclosure) is _____ feet _____ meters ☐ above or ☐ below the LAG.

E2. For Building Diagrams 6-9 with permanent flood openings provided in Section A Items 3 and 9 (see pages 8-9 of Instructions),

the next higher floor (elevation C2.b in the diagrams) of the building is _____ feet _____ meters ☐ above or ☐ below the HAG.E3. Attached garage (top of slab) is _____ feet _____ meters ☐ above or ☐ below the HAG.E4. Top of platform of machinery and/or equipment servicing the building is _____ feet _____ meters ☐ above or ☐ below the HAG.E5. Zone AO only: If no flood depth number is available, is the top of the bottom floor elevated in accordance with the community's floodplain management ordinance? ☐ Yes ☐ No ☐ Unknown. The local official must certify this information in Section G.

SECTION F - PROPERTY OWNER (OR OWNER'S REPRESENTATIVE) CERTIFICATION

The property owner or owner's authorized representative who completes Sections A, B, and E for Zone A (without a FEMA-issued or community-issued BFE) or Zone AO must sign here. The statements in Sections A, B, and E are correct to the best of my knowledge.

Property Owner or Owner's Authorized Representative's Name

Address

City

State

ZIP Code

Signature

Date

Telephone

Comments

☐ Check here if attachments.

SECTION G - COMMUNITY INFORMATION (OPTIONAL)

The local official who is authorized by law or ordinance to administer the community's floodplain management ordinance can complete Sections A, B, C (or E), and G of this Elevation Certificate. Complete the applicable item(s) and sign below. Check the measurement used in Items G8-G10. In Puerto Rico only, enter meters.

G1. ☐ The information in Section C was taken from other documentation that has been signed and sealed by a licensed surveyor, engineer, or architect who is authorized by law to certify elevation information. (Indicate the source and date of the elevation data in the Comments area below.)G2. ☐ A community official completed Section E for a building located in Zone A (without a FEMA-issued or community-issued BFE) or Zone AO.G3. ☐ The following information (Items G4-G9) is provided for community floodplain management purposes.G4. Permit Number 11-150E G5. Date Permit Issued _____ G6. Date Certificate Of Compliance/Occupancy Issued _____G7. This permit has been issued for: ☐ New Construction ☐ Substantial Improvement

G8. Elevation of as-built lowest floor (including basement) of the building: _____ feet _____ meters Datum _____

G9. BFE or (in Zone AO) depth of flooding at the building site: _____ feet _____ meters Datum _____

G10. Community's design flood elevation: _____ feet _____ meters Datum _____

Local Official's Name Suzie BohnetTitle Sr. HydrologistCommunity Name Pima CountyTelephone 520-724-4600Signature Suzie BohnetDate 2-13-2014Comments Photos of a/c unit showing 6" elevation revision submitted 2-12-2014. Therefore Service Equipment elevation = 101.60' - ok to approve.☐ Check here if attachments.

Building Photographs

See Instructions for Item A6.

Building Street Address (including Apt., Unit, Suite, and/or Bldg. No.) or P.O. Route and Box No. 4408 S. Aldon Rd.	For Insurance Company Use: Policy Number
City Tucson State AZ ZIP Code 85735	Company NAIC Number

If using the Elevation Certificate to obtain NFIP flood insurance, affix at least two building photographs below according to the instructions for Item A6. Identify all photographs with: date taken; "Front View" and "Rear View"; and, if required, "Right Side View" and "Left Side View." If submitting more photographs than will fit on this page, use the Continuation Page, following.

SOUTH FACE



WEST FACE



WEST FACE



NORTH FACE



Building Photographs

Continuation Page

Building Street Address (including Apt., Unit, Suite, and/or Bldg. No.) or P.O. Route and Box No. 4408 S. Aldon Rd.	For Insurance Company Use: Policy Number
City Tucson State AZ ZIP Code 85735	Company NAIC Number
If submitting more photographs than will fit on the preceding page, affix the additional photographs below. Identify all photographs with: date taken; "Front View" and "Rear View"; and, if required, "Right Side View" and "Left Side View."	

NORTH FACE



EAST FACE



NORTH FACE



SOUTH FACE



Building Photographs

See Instructions for Item A6.

Building Street Address (including Apt., Unit, Suite, and/or Bldg. No.) or P.O. Route and Box No. 4408 S. Aldon Rd.	For Insurance Company Use:
City Tucson State AZ ZIP Code 85735	Policy Number
	Company NAIC Number

If using the Elevation Certificate to obtain NFIP flood insurance, affix at least two building photographs below according to the instructions for Item A6. Identify all photographs with: date taken; "Front View" and "Rear View"; and, if required, "Right Side View" and "Left Side View." If submitting more photographs than will fit on this page, use the Continuation Page, following.

SOUTH FACE



WEST FACE



WEST FACE

