

ELEVATION CERTIFICATE

IMPORTANT: Follow the instructions on pages 1-9.

OMB No. 1660-0008
Expiration Date: July 31, 2015**SECTION A - PROPERTY INFORMATION****FOR INSURANCE COMPANY USE**A1. Building Owner's Name **Amity Foundation**

Policy Number:

A2. Building Street Address (including Apt., Unit, Suite, and/or Bldg. No.) or P.O. Route and Box No.

10500 E. Tanque Verde Rd. Bldg 49

Company NAIC Number:

City **Tucson**State **AZ**ZIP Code **85749**

A3. Property Description (Lot and Block Numbers, Tax Parcel Number, Legal Description, etc.)

Tax Code 133-01-025A Township 14S Range 15E Section 01A4. Building Use (e.g., Residential, Non-Residential, Addition, Accessory, etc.) **Commercial Building**A5. Latitude/Longitude: Lat. **32.246891** Long. **-110.767144**Horizontal Datum: ☐ NAD 1927 ☒ NAD 1983

A6. Attach at least 2 photographs of the building if the Certificate is being used to obtain flood insurance.

A7. Building Diagram Number **1A**

A8. For a building with a crawlspace or enclosure(s):

a) Square footage of crawlspace or enclosure(s) **N/A** sq ftb) No. of permanent flood openings in the crawlspace or enclosure(s) within 1.0 foot above adjacent grade **N/A**c) Total net area of flood openings in A8.b **N/A** sq ind) Engineered flood openings? ☐ Yes ☒ No

A9. For a building with an attached garage:

a) Square footage of attached garage **N/A** sq ftb) Number of permanent flood openings in the attached garage within 1.0 foot above adjacent grade **N/A**c) Total net area of flood openings in A9.b **N/A** sq ind) Engineered flood openings? ☐ Yes ☒ No**SECTION B - FLOOD INSURANCE RATE MAP (FIRM) INFORMATION**B1. NFIP Community Name & Community Number
Pima County / 040073B2. County Name **Pima County**B3. State **AZ**

B4. Map/Panel Number

B5. Suffix

B6. FIRM Index Date

B7. FIRM Panel Effective/
Revised Date

B8. Flood Zone(s)

B9. Base Flood Elevation(s) (Zone

AO, use base flood depth)

04019C 2307**M****9-28-12****9-28-12****AE****2595.0**

B10. Indicate the source of the Base Flood Elevation (BFE) data or base flood depth entered in Item B9:

☐ FIS Profile ☐ FIRM ☐ Community Determined ☒ Other/Source: **Rick Eng. drainage report 10/7/2010 P1209-056**B11. Indicate elevation datum used for BFE in Item B9: ☐ NGVD 1929 ☒ NAVD 1988 ☐ Other/Source: **Highest Adj. Nat. Grade (=100 ft)**B12. Is the building located in a Coastal Barrier Resources System (CBRS) area or Otherwise Protected Area (OPA)? ☐ Yes ☒ NoDesignation Date: **N/A** / **N/A** / **N/A** ☐ CBRS ☐ OPA**SECTION C - BUILDING ELEVATION INFORMATION (SURVEY REQUIRED)**C1. Building elevations are based on: ☐ Construction Drawings* ☐ Building Under Construction* ☒ Finished Construction

*A new Elevation Certificate will be required when construction of the building is complete.

C2. Elevations - Zones A1-A30, AE, AH, A (with BFE), VE, V1-V30, V (with BFE), AR, AR/A, AR/AE, AR/A1-A30, AR/AH, AR/AO. Complete items C2.a-h below according to the building diagram specified in Item A7. In Puerto Rico only, enter meters.

Benchmark Utilized: **PCDOT/COT GIS Control Pt. FC21** Vertical Datum: **Elev. = 2578.62 (NAVD88)**Indicate elevation datum used for the elevations in items a) through h) below. ☐ NGVD 1929 ☒ NAVD 1988 ☐ Other/Source: _____

Datum used for building elevations must be the same as that used for the BFE.

a) Top of bottom floor (including basement, crawlspace, or enclosure floor) **2599.2** Check the measurement used. ☒ feet ☐ metersb) Top of the next higher floor **N/A** ☒ feet ☐ metersc) Bottom of the lowest horizontal structural member (V Zones only) **N/A** ☒ feet ☐ metersd) Attached garage (top of slab) **N/A** ☒ feet ☐ meterse) Lowest elevation of machinery or equipment servicing the building **2599.0** ☒ feet ☐ meters

(Describe type of equipment and location in Comments)

f) Lowest adjacent (finished) grade next to building (LAG) **2598.3** ☒ feet ☐ metersg) Highest adjacent (finished) grade next to building (HAG) **2599.2** ☒ feet ☐ metersh) Lowest adjacent grade at lowest elevation of deck or stairs, including structural support **N/A** ☒ feet ☐ meters

When B.9 is a depth above grade, it is required to indicate highest and lowest NATURAL grade in Section D Comments

SECTION D - SURVEYOR, ENGINEER, OR ARCHITECT CERTIFICATION

This certification is to be signed and sealed by a land surveyor, engineer, or architect authorized by law to certify elevation information. I certify that the information on this Certificate represents my best efforts to interpret the data available. I understand that any false statement may be punishable by fine or imprisonment under 18 U.S. Code, Section 1001.

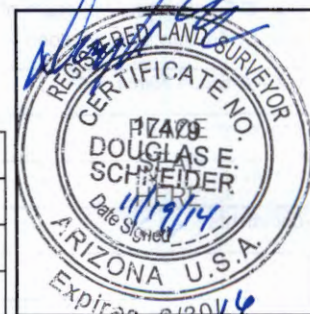
☒ Check here if comments are provided on back of form.Were latitude and longitude in Section A provided by a licensed land surveyor? ☐ Yes ☒ No☐ Check here if attachments.Certifier's Name
Doug SchneiderLicense Number
RLS 17479Title
Survey Manager/AssociateCompany Name
Rick Engineering Co.Address
3945 E. Ft. Lowell Rd. Ste 111City
TucsonState
AZZIP Code
85712Signature
*Doug Schneider*Date
4/19/14Telephone
(520) 795-1000

ELEVATION CERTIFICATE, page 2**IMPORTANT: In these spaces, copy the corresponding information from Section A.**

Building Street Address (including Apt., Unit, Suite, and/or Bldg. No.) or P.O. Route and Box No.

10500 E. Tanque Verde Rd. Bldg 49City
TucsonState
AZZIP Code
85749

FOR INSURANCE COMPANY USE

Policy Number:

Company NAIC Number:

SECTION D – SURVEYOR, ENGINEER, OR ARCHITECT CERTIFICATION (CONTINUED)

Copy both sides of this Elevation Certificate for (1) community official, (2) insurance agent/company, and (3) building owner.

Comments **Lowest service equipment in C2.e) is the air conditioning condenser and all other equipment is above this elevation.**

Signature

Date

11/19/14**SECTION E – BUILDING ELEVATION INFORMATION (SURVEY NOT REQUIRED) FOR ZONE AO AND ZONE A (WITHOUT BFE)**

For Zones AO and A (without BFE), complete Items E1–E5. If the Certificate is intended to support a LOMA or LOMR-F request, complete Sections A, B, and C. For Items E1–E4, use natural grade, if available. Check the measurement used. In Puerto Rico only, enter meters.

E1. Provide elevation information for the following and check the appropriate boxes to show whether the elevation is above or below the highest adjacent grade (HAG) and the lowest adjacent grade (LAG).

a) Top of bottom floor (including basement, crawlspace, or enclosure) is _____ ☐ feet ☐ meters ☐ above or ☐ below the HAG.b) Top of bottom floor (including basement, crawlspace, or enclosure) is _____ ☐ feet ☐ meters ☐ above or ☐ below the LAG.

E2. For Building Diagrams 6–9 with permanent flood openings provided in Section A Items 3 and 4 (see pages 8–9 of Instructions),

the next higher floor (elevation C2.b in the diagrams) of the building is _____ ☐ feet ☐ meters ☐ above or ☐ below the HAG.E3. Attached garage (top of slab) is _____ ☐ feet ☐ meters ☐ above or ☐ below the HAG.E4. Top of platform of machinery and/or equipment servicing the building is _____ ☐ feet ☐ meters ☐ above or ☐ below the HAG.E5. Zone AO only: If no flood depth number is available, is the top of the bottom floor elevated in accordance with the community's floodplain management ordinance? ☐ Yes ☐ No ☐ Unknown. The local official must certify this information in Section G.**SECTION F – PROPERTY OWNER (OR OWNER'S REPRESENTATIVE) CERTIFICATION**

The property owner or owner's authorized representative who completes Sections A, B, and E for Zone A (without a FEMA-issued or community-issued BFE) or Zone AO must sign here. The statements in Sections A, B, and E are correct to the best of my knowledge.

Property Owner or Owner's Authorized Representative's Name

Address

City

State

ZIP Code

Signature

Date

Telephone

Comments

☐ Check here if attachments.**SECTION G – COMMUNITY INFORMATION (OPTIONAL)**

The local official who is authorized by law or ordinance to administer the community's floodplain management ordinance can complete Sections A, B, C (or E), and G of this Elevation Certificate. Complete the applicable item(s) and sign below. Check the measurement used in Items G8–G10. In Puerto Rico only, enter meters.

G1. ☐ The information in Section C was taken from other documentation that has been signed and sealed by a licensed surveyor, engineer, or architect who is authorized by law to certify elevation information. (Indicate the source and date of the elevation data in the Comments area below.)G2. ☐ A community official completed Section E for a building located in Zone A (without a FEMA-issued or community-issued BFE) or Zone AO.G3. ☐ The following information (Items G4–G9) is provided for community floodplain management purposes.

G4. Permit Number

11-203E

G5. Date Permit Issued

G6. Date Certificate Of Compliance/Occupancy Issued

G7. This permit has been issued for: ☐ New Construction ☐ Substantial ImprovementG8. Elevation of as-built lowest floor (including basement) of the building: _____ ☐ feet ☐ meters Datum _____G9. BFE or (in Zone AO) depth of flooding at the building site: _____ ☐ feet ☐ meters Datum _____G10. Community's design flood elevation: _____ ☐ feet ☐ meters Datum _____

Local Official's Name

Title

Community Name

Telephone

Signature

Date

Comments

☐ Check here if attachments.

ELEVATION CERTIFICATE, page 3**BUILDING PHOTOGRAPHS**

See Instructions for Item A6.

IMPORTANT: In these spaces, copy the corresponding information from Section A.			FOR INSURANCE COMPANY USE
Building Street Address (including Apt., Unit, Suite, and/or Bldg. No.) or R.O. Route and Box No. 10500 E. Tanque Verde Rd. Bldg 49			Policy Number:
City Tucson	State AZ	ZIP Code 85749	Company NAIC Number:

If using the Elevation Certificate to obtain NFIP flood insurance, affix at least 2 building photographs below according to the instructions for Item A6. Identify all photographs with date taken; "Front View" and "Rear View"; and, if required, "Right Side View" and "Left Side View." When applicable, photographs must show the foundation with representative examples of the flood openings or vents, as indicated in Section A8. If submitting more photographs than will fit on this page, use the Continuation Page.



NORTH SIDE PHOTO 11/18/2014



SOUTH SIDE PHOTO 11/18/2014

BUILDING PHOTOGRAPHS

Continuation Page

IMPORTANT: In these spaces, copy the corresponding information from Section A.			FOR INSURANCE COMPANY USE
Building Street Address (including Apt., Unit, Suite, and/or Bldg. No.) or P.O. Route and Box No. 10500 E. Tanque Verde Rd. Bldg 49			Policy Number:
City Tucson	State AZ	ZIP Code 85749	Company NAIC Number:

If submitting more photographs than will fit on the preceding page, affix the additional photographs below. Identify all photographs with: date taken; "Front View" and "Rear View"; and, if required, "Right Side View" and "Left Side View." When applicable, photographs must show the foundation with representative examples of the flood openings or vents, as indicated in Section A8.



EAST SIDE PHOTO 11/18/2014



WEST SIDE PHOTO 11/18/2014