

ELEVATION CERTIFICATE

IMPORTANT: Follow the instructions on pages 1-9.

OMB No. 1660-0008
Expiration Date: July 31, 2015

SECTION A - PROPERTY INFORMATION

FOR INSURANCE COMPANY USE

A1. Building Owner's Name **Kansas Land Company LLC**

Policy Number:

A2. Building Street Address (including Apt., Unit, Suite, and/or Bldg. No.) or P.O. Route and Box No.
12091 N. Musket Road

Company NAIC Number:

City **Tucson**State **AZ**ZIP Code **85653**

A3. Property Description (Lot and Block Numbers, Tax Parcel Number, Legal Description, etc.)

Tax Code **20818220E** Township **11S** Range **10E** Section **33**A4. Building Use (e.g., Residential, Non-Residential, Addition, Accessory, etc.) **Residential: Manufactured Home Replacement**A5. Latitude/Longitude: Lat. **32.423715** Long. **-111.334529**Horizontal Datum: ☐ NAD 1927 ☒ NAD 1983

A6. Attach at least 2 photographs of the building if the Certificate is being used to obtain flood insurance.

A7. Building Diagram Number **5**

A8. For a building with a crawlspace or enclosure(s):

a) Square footage of crawlspace or enclosure(s) **1200** sq ftb) No. of permanent flood openings in the crawlspace or enclosure(s) within 1.0 foot above adjacent grade **17**c) Total net area of flood openings in A8.b **1400** sq ind) Engineered flood openings? ☐ Yes ☒ No

A9. For a building with an attached garage:

a) Square footage of attached garage **N/A** sq ftb) Number of permanent flood openings in the attached garage within 1.0 foot above adjacent grade **N/A**c) Total net area of flood openings in A9.b **N/A** sq ind) Engineered flood openings? ☐ Yes ☒ No

SECTION B - FLOOD INSURANCE RATE MAP (FIRM) INFORMATION

B1. NFIP Community Name & Community Number

Pima County / 040073

B2. County Name

Pima County

B3. State

AZ

B4. Map/Panel Number

04019C 1015

B5. Suffix

L

B6. FIRM Index Date

9-28-12B7. FIRM Panel Effective/
Revised Date**9-28-12 6-16-11**

B8. Flood Zone(s)

X (Shaded)B9. Base Flood Elevation(s) (Zone
AO, use base flood depth)**101.0**

B10. Indicate the source of the Base Flood Elevation (BFE) data or base flood depth entered in Item B9:

☐ FIS Profile ☐ FIRM ☒ Community Determined ☐ Other/Source:

B11. Indicate elevation datum used for BFE in Item B9:

☐ NGVD 1929☐ NAVD 1988☒ Other/Source: **Highest Adj. Nat. Grade (=100 ft)**B12. Is the building located in a Coastal Barrier Resources System (CBRS) area or Otherwise Protected Area (OPA)? ☐ Yes ☒ NoDesignation Date: **N/A** / **N/A** / **N/A** ☐ CBRS ☐ OPA

SECTION C - BUILDING ELEVATION INFORMATION (SURVEY REQUIRED)

C1. Building elevations are based on: ☐ Construction Drawings* ☐ Building Under Construction* ☒ Finished Construction

*A new Elevation Certificate will be required when construction of the building is complete.

C2. Elevations - Zones A1-A30, AE, AH, A (with BFE), VE, V1-V30, V (with BFE), AR, AR/A, AR/AE, AR/A1-A30, AR/AH, AR/AO. Complete Items C2.a-h below according to the building diagram specified in Item A7. In Puerto Rico only, enter meters.

Benchmark Utilized: **Highest Adjacent Natural Grade**Vertical Datum: **Assigned Bench Mark Elevation: 100 ft.**Indicate elevation datum used for the elevations in items a) through h) below. ☐ NGVD 1929 ☐ NAVD 1988 ☒ Other/Source: **Assigned Bench**

Datum used for building elevations must be the same as that used for the BFE.

Check the measurement used.

a) Top of bottom floor (including basement, crawlspace, or enclosure floor) **103.53**☒ feet ☐ metersb) Top of the next higher floor **N/A**☒ feet ☐ metersc) Bottom of the lowest horizontal structural member (V Zones only) **N/A**☒ feet ☐ metersd) Attached garage (top of slab) **N/A**☒ feet ☐ meterse) Lowest elevation of machinery or equipment servicing the building
(Describe type of equipment and location in Comments) **102.63**☒ feet ☐ metersf) Lowest adjacent (finished) grade next to building (LAG) **99.69**☒ feet ☐ metersg) Highest adjacent (finished) grade next to building (HAG) **99.85**☒ feet ☐ metersh) Lowest adjacent grade at lowest elevation of deck or stairs, including
structural support **99.87**☒ feet ☐ meters

When B.9 is a depth above grade, it is required to indicate highest and lowest NATURAL grade in Section D Comments

SECTION D - SURVEYOR, ENGINEER, OR ARCHITECT CERTIFICATION

This certification is to be signed and sealed by a land surveyor, engineer, or architect authorized by law to certify elevation information. I certify that the information on this Certificate represents my best efforts to interpret the data available. I understand that any false statement may be punishable by fine or imprisonment under 18 U.S. Code, Section 1001.

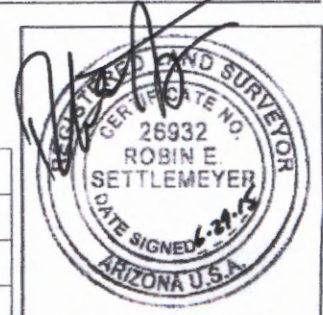
☒ Check here if comments are provided on back of form.Were latitude and longitude in Section A provided by a
licensed land surveyor? ☐ Yes ☒ No☐ Check here if attachments.Certifier's Name
Robin E. SettlemyerLicense Number
RLS 26932Title
OwnerCompany Name
Settlemyer LLCAddress
2100 N. Wilmot Road, Suite 321City
TucsonState
AZZIP Code
65712Signature
Date
6-29-2015Telephone
520-512-0666

Expires: 3-31-2017

ELEVATION CERTIFICATE, page 2

IMPORTANT: In these spaces, copy the corresponding information from Section A.

Building Street Address (including Apt., Unit, Suite, and/or Bldg. No.) or P.O. Route and Box No.

12091 N. Musket Road

City
TucsonState
AZZIP Code
85653

FOR INSURANCE COMPANY USE

Policy Number:

Company NAIC Number:

SECTION D – SURVEYOR, ENGINEER, OR ARCHITECT CERTIFICATION (CONTINUED)

Copy both sides of this Elevation Certificate for (1) community official, (2) insurance agent/company, and (3) building owner.

Comments The lowest service equipment (C2.e) is the Air Conditioner and the Water Heater and Furnace

is/are above this elevation.

Highest adjacent natural grade is 100-ft (Bench) Lowest adjacent natural grade is 99.74 ftThe elevation at the bottom of the lowest structural frame member is 102.23 ft

Signature

Date
June 29, 2015

SECTION E – BUILDING ELEVATION INFORMATION (SURVEY NOT REQUIRED) FOR ZONE AO AND ZONE A (WITHOUT BFE)

For Zones AO and A (without BFE), complete Items E1–E5. If the Certificate is intended to support a LOMA or LOMR-F request, complete Sections A, B, and C. For Items E1–E4, use natural grade, if available. Check the measurement used. In Puerto Rico only, enter meters.

E1. Provide elevation information for the following and check the appropriate boxes to show whether the elevation is above or below the highest adjacent grade (HAG) and the lowest adjacent grade (LAG).

- a) Top of bottom floor (including basement, crawlspace, or enclosure) is _____ ☐ feet ☐ meters ☐ above or ☐ below the HAG.
b) Top of bottom floor (including basement, crawlspace, or enclosure) is _____ ☐ feet ☐ meters ☐ above or ☐ below the LAG.

E2. For Building Diagrams 6–9 with permanent flood openings provided in Section A Items 3 and 9 (see pages 8–9 of Instructions),

the next higher floor (elevation C2.b in the diagrams) of the building is _____ ☐ feet ☐ meters ☐ above or ☐ below the HAG.E3. Attached garage (top of slab) is _____ ☐ feet ☐ meters ☐ above or ☐ below the HAG.E4. Top of platform of machinery and/or equipment servicing the building is _____ ☐ feet ☐ meters ☐ above or ☐ below the HAG.E5. Zone AO only: If no flood depth number is available, is the top of the bottom floor elevated in accordance with the community's floodplain management ordinance? ☐ Yes ☐ No ☐ Unknown. The local official must certify this information in Section G.

SECTION F – PROPERTY OWNER (OR OWNER'S REPRESENTATIVE) CERTIFICATION

The property owner or owner's authorized representative who completes Sections A, B, and E for Zone A (without a FEMA-issued or community-issued BFE) or Zone AO must sign here. The statements in Sections A, B, and E are correct to the best of my knowledge.

Property Owner or Owner's Authorized Representative's Name

Address

City

State

ZIP Code

Signature

Date

Telephone

Comments

☐ Check here if attachments.

SECTION G – COMMUNITY INFORMATION (OPTIONAL)

The local official who is authorized by law or ordinance to administer the community's floodplain management ordinance can complete Sections A, B, C (or E), and G of this Elevation Certificate. Complete the applicable item(s) and sign below. Check the measurement used in Items G8–G10. In Puerto Rico only, enter meters.

G1. ☐ The information in Section C was taken from other documentation that has been signed and sealed by a licensed surveyor, engineer, or architect who is authorized by law to certify elevation information. (Indicate the source and date of the elevation data in the Comments area below.)G2. ☐ A community official completed Section E for a building located in Zone A (without a FEMA-issued or community-issued BFE) or Zone AO.G3. ☐ The following information (Items G4–G9) is provided for community floodplain management purposes.

G4. Permit Number

11-455E

G5. Date Permit Issued

G6. Date Certificate Of Compliance/Occupancy Issued

G7. This permit has been issued for: ☐ New Construction ☐ Substantial Improvement

G8. Elevation of as-built lowest floor (including basement) of the building: _____

☐ feet☐ meters

Datum _____

G9. BFE or (in Zone AO) depth of flooding at the building site: _____

☐ feet☐ meters

Datum _____

G10. Community's design flood elevation: _____

☐ feet☐ meters

Datum _____

Local Official's Name

Title

Community Name

Telephone

Signature

Date

Comments

☐ Check here if attachments.

BUILDING PHOTOGRAPHS

See Instructions for Item A6.

IMPORTANT: In these spaces, copy the corresponding information from Section A.			FOR INSURANCE COMPANY USE	
Building Street Address (including Apt., Unit, Suite, and/or Bldg. No.) or P.O. Route and Box No. 12091 N. Musket Road			Policy Number:	
City Tucson	State AZ	ZIP Code 85653	Company NAIC Number:	

If using the Elevation Certificate to obtain NFIP flood insurance, affix at least 2 building photographs below according to the instructions for Item A6. Identify all photographs with date taken; "Front View" and "Rear View"; and, if required, "Right Side View" and "Left Side View." When applicable, photographs must show the foundation with representative examples of the flood openings or vents, as indicated in Section A8. If submitting more photographs than will fit on this page, use the Continuation Page.

Photographs taken June 22, 2015:



East Face
Front Entrance
of Residence



North Face
Side
of Residence



Detail: Crawl Space Access (North Face of Residence)

IMPORTANT: In these spaces, copy the corresponding information from Section A.			FOR INSURANCE COMPANY USE
Building Street Address (including Apt., Unit, Suite, and/or Bldg. No.) or P.O. Route and Box No. 12091 N. Musket Road			Policy Number:
City Tucson	State AZ	ZIP Code 85653	Company NAIC Number:

If submitting more photographs than will fit on the preceding page, affix the additional photographs below. Identify all photographs with: date taken; "Front View" and "Rear View"; and, if required, "Right Side View" and "Left Side View." When applicable, photographs must show the foundation with representative examples of the flood openings or vents, as indicated in Section A8.

Photographs taken June 22, 2015:



West Face
Rear Entrance
of Residence



South Face
Side
of Residence