

ELEVATION CERTIFICATE

Important: Read the instructions on pages 1-9.

OMB No. 1660-0008
Expires March 31, 2012

SECTION A - PROPERTY INFORMATION

| | | |
|---|-----------------|----------------------------|
| A1. Building Owner's Name Nancy Parker | | For Insurance Company Use: |
| A2. Building Street Address (including Apt., Unit, Suite, and/or Bldg. No.) or P.O. Route and Box No. 12703 W. Crystal Rose Ln. | | Policy Number |
| City Tucson | State AZ | Company NAIC Number |
| | | ZIP Code 85743 |

A3. Property Description (Lot and Block Numbers, Tax Parcel Number, Legal Description, etc.)

Tax Code **213-09-020L** Township **13S** Range **11E** Section **05**A4. Building Use (e.g., Residential, Non-Residential, Addition, Accessory, etc.) **Accessory: Detached Garage**A5. Latitude/Longitude: Lat. **32.329658** Long. **-111.237612** Horizontal Datum: ☐ NAD 1927 ☒ NAD 1983

A6. Attach at least 2 photographs of the building if the Certificate is being used to obtain flood insurance.

A7. Building Diagram Number **1-A**

A8. For a building with a crawlspace or enclosure(s):

- a) Square footage of crawlspace or enclosure(s) **768** sq ft
- b) No. of permanent flood openings in the crawlspace or enclosure(s) within 1.0 foot above adjacent grade **10**
- c) Total net area of flood openings in A8.b **980** sq in
- d) Engineered flood openings? ☐ Yes ☒ No

A9. For a building with an attached garage:

- a) Square footage of attached garage **N/A** sq ft
- b) No. of permanent flood openings in the attached garage within 1.0 foot above adjacent grade **N/A**
- c) Total net area of flood openings in A9.b **N/A** sq in
- d) Engineered flood openings? ☐ Yes ☒ No

SECTION B - FLOOD INSURANCE RATE MAP (FIRM) INFORMATION

| | | | | | |
|---|------------------------|---------------------------------------|---|-------------------------------|---|
| B1. NFIP Community Name & Community Number Pima County / 040073 | | B2. County Name Pima County | | B3. State AZ | |
| B4. Map/Panel Number 04019C 1650 | B5. Suffix L | B6. FIRM Index Date 6-16-11 | B7. FIRM Panel Effective/Revised Date 6-16-11 | B8. Flood Zone(s) X | B9. Base Flood Elevation(s) (Zone AO, use base flood depth) 0.5 |

B10. Indicate the source of the Base Flood Elevation (BFE) data or base flood depth entered in Item B9.

☐ FIS Profile ☐ FIRM ☒ Community Determined ☐ Other (Describe)B11. Indicate elevation datum used for BFE in Item B9: ☐ NGVD 1929 ☐ NAVD 1988 ☒ Other (Describe) **Highest Adj. Nat. Grade (=100 ft)**B12. Is the building located in a Coastal Barrier Resources System (CBRS) area or Otherwise Protected Area (OPA)? ☐ Yes ☒ No
Designation Date **N/A** ☐ CBRS ☐ OPA

SECTION C - BUILDING ELEVATION INFORMATION (SURVEY REQUIRED)

- C1. Building elevations are based on: ☐ Construction Drawings* ☐ Building Under Construction* ☒ Finished Construction
*A new Elevation Certificate will be required when construction of the building is complete.
- C2. Elevations - Zones A1-A30, AE, AH, A (with BFE), VE, V1-V30, V (with BFE), AR, AR/A, AR/AE, AR/A1-A30, AR/AH, AR/AO. Complete Items C2.a-h below according to the building diagram specified in Item A7. Use the same datum as the BFE.
- Benchmark Utilized **HANG** Vertical Datum **LOCAL**
- Conversion/Comments **N/A**

Check the measurement used.

- a) Top of bottom floor (including basement, crawlspace, or enclosure floor) **100.5** ☒ feet ☐ meters (Puerto Rico only)
- b) Top of the next higher floor **N/A** ☒ feet ☐ meters (Puerto Rico only)
- c) Bottom of the lowest horizontal structural member (V Zones only) **N/A** ☒ feet ☐ meters (Puerto Rico only)
- d) Attached garage (top of slab) **N/A** ☒ feet ☐ meters (Puerto Rico only)
- e) Lowest elevation of machinery or equipment servicing the building (Describe type of equipment and location in Comments) **N/A** ☒ feet ☐ meters (Puerto Rico only)
- f) Lowest adjacent (finished) grade next to building (LAG) **99.6** ☒ feet ☐ meters (Puerto Rico only)
- g) Highest adjacent (finished) grade next to building (HAG) **100.1** ☒ feet ☐ meters (Puerto Rico only)
- h) Lowest adjacent grade at lowest elevation of deck or stairs, including structural support **N/A** ☒ feet ☐ meters (Puerto Rico only)

SECTION D - SURVEYOR, ENGINEER, OR ARCHITECT CERTIFICATION

This certification is to be signed and sealed by a land surveyor, engineer, or architect authorized by law to certify elevation information. I certify that the information on this Certificate represents my best efforts to interpret the data available. I understand that any false statement may be punishable by fine or imprisonment under 18 U.S. Code, Section 1001.

☒ Check here if comments are provided on back of form.Were latitude and longitude in Section A provided by a licensed land surveyor? ☐ Yes ☒ No

| | | | |
|--|--|-------------------------------|--------------------------|
| Certifier's Name Carlos Padilla | | License Number 46474 | |
| Title RLS - Principal | Company Name AAA Survey Arizona | | |
| Address 1830 E Broadway | City 124 Tucson | State AZ | ZIP Code 85743 |
| Signature [Signature] | Date 1/24/12 | Telephone 520-981-1553 | Expires 6.30.2013 |

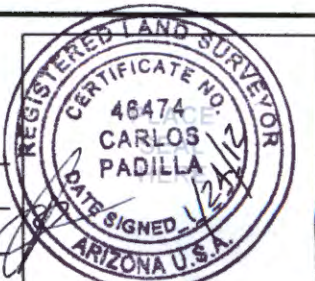

IMPORTANT: In these spaces, copy the corresponding information from Section A.

Building Street Address (including Apt., Unit, Suite, and/or Bldg. No.) or P.O. Route and Box No.

12703 W. Crystal Rose Ln.

City
TucsonState
AZZIP Code
85743

For Insurance Company Use:

Policy Number

Company NAIC Number

SECTION D - SURVEYOR, ENGINEER, OR ARCHITECT CERTIFICATION (CONTINUED)

Copy both sides of this Elevation Certificate for (1) community official, (2) insurance agent/company, and (3) building owner.

Comments The lowest service equipment (C3.e) is the N/A and the N/A is/are above this elevation.Highest adjacent natural grade is 100.0 Lowest adjacent natural grade is 99.3

Signature

Date

1/24/12☒ Check here if attachments**SECTION E - BUILDING ELEVATION INFORMATION (SURVEY NOT REQUIRED) FOR ZONE AO AND ZONE A (WITHOUT BFE)**

For Zones AO and A (without BFE), complete Items E1-E5. If the Certificate is intended to support a LOMA or LOMR-F request, complete Sections A, B, and C. For Items E1-E4, use natural grade, if available. Check the measurement used. In Puerto Rico only, enter meters.

E1. Provide elevation information for the following and check the appropriate boxes to show whether the elevation is above or below the highest adjacent grade (HAG) and the lowest adjacent grade (LAG).

a) Top of bottom floor (including basement, crawlspace, or enclosure) is N/A feet ☐ meters ☐ above or ☐ below the HAG.b) Top of bottom floor (including basement, crawlspace, or enclosure) is N/A feet ☐ meters ☐ above or ☐ below the LAG.E2. For Building Diagrams 6-9 with permanent flood openings provided in Section A Items 6-9 (see pages 8-9 of Instructions), the next higher floor (elevation C2.b in the diagrams) of the building is N/A feet ☐ meters ☐ above or ☐ below the HAG.E3. Attached garage (top of slab) is N/A feet ☐ meters ☐ above or ☐ below the HAG.E4. Top of platform of machinery and/or equipment servicing the building is N/A feet ☐ meters ☐ above or ☐ below the HAG.E5. Zone AO only: If no flood depth number is available, is the top of the bottom floor elevated in accordance with the community's floodplain management ordinance? ☐ Yes ☐ No ☐ Unknown. The local official must certify this information in Section G.**SECTION F - PROPERTY OWNER (OR OWNER'S REPRESENTATIVE) CERTIFICATION**

The property owner or owner's authorized representative who completes Sections A, B, and E for Zone A (without a FEMA-issued or community-issued BFE) or Zone AO must sign here. The statements in Sections A, B, and E are correct to the best of my knowledge.

Property Owner's or Owner's Authorized Representative's Name

Address

City

State

ZIP Code

Signature

Date

Telephone

Comments

☐ Check here if attachments**SECTION G - COMMUNITY INFORMATION (OPTIONAL)**

The local official who is authorized by law or ordinance to administer the community's floodplain management ordinance can complete Sections A, B, C (or E), and G of this Elevation Certificate. Complete the applicable item(s) and sign below. Check the measurement used in Items G8 and G9.

G1. ☐ The information in Section C was taken from other documentation that has been signed and sealed by a licensed surveyor, engineer, or architect who is authorized by law to certify elevation information. (Indicate the source and date of the elevation data in the Comments area below.)G2. ☐ A community official completed Section E for a building located in Zone A (without a FEMA-issued or community-issued BFE) or Zone AO.G3. ☐ The following information (Items G4-G9) is provided for community floodplain management purposes.

G4. Permit Number

11-458E

G5. Date Permit Issued

G6. Date Certificate Of Compliance/Occupancy Issued

G7. This permit has been issued for: ☐ New Construction ☐ Substantial ImprovementG8. Elevation of as-built lowest floor (including basement) of the building N/A feet ☐ meters (PR) Datum N/AG9. BFE (or in Zone AO) depth of flooding at the building site N/A feet ☐ meters (PR) Datum N/AG10. Community's design flood elevation N/A feet ☐ meters (PR) Datum N/A

Local Official's Name

Title

Community Name

Telephone

Signature

Date

Comments

☐ Check here if attachments

11-458E

Building Photographs

See Instructions for Item A6.

| | | | |
|---|--------------------|--------------------------|---|
| Building Street Address (including Apt., Unit, Suite, and/or Bldg. No.) or P.O. Route and Box No. 12703 W. Crystal Rose Ln. | | | For Insurance Company Use: Policy Number |
| City Tucson | State AZ | ZIP Code 85743 | Company NAIC Number |

If using the Elevation Certificate to obtain NFIP flood insurance, affix at least building photographs below according to the instructions for Item A6. Identify all photographs with: date taken; "Front View" and "Rear View"; and, if required, "Right Side View" and "Left Side View." If submitting more photographs than will fit on this page, use the Continuation Page on the reverse.

**RIGHT SIDE VIEW****1/23/2012**

11-458E

Building Photographs

See Instructions for Item A6.

| | | | |
|---|--------------------|--------------------------|---|
| Building Street Address (including Apt., Unit, Suite, and/or Bldg. No.) or P.O. Route and Box No. 12703 W. Crystal Rose Ln. | | | For Insurance Company Use: Policy Number |
| City Tucson | State AZ | ZIP Code 85743 | Company NAIC Number |

If using the Elevation Certificate to obtain NFIP flood insurance, affix at least building photographs below according to the instructions for Item A6. Identify all photographs with: date taken; "Front View" and "Rear View"; and, if required, "Right Side View" and "Left Side View." If submitting more photographs than will fit on this page, use the Continuation Page on the reverse.

**REAR VIEW****1/23/2012**

11-458E

Building Photographs

See Instructions for Item A6.

| | | | |
|---|--------------------|--------------------------|---|
| Building Street Address (including Apt., Unit, Suite, and/or Bldg. No.) or P.O. Route and Box No. 12703 W. Crystal Rose Ln. | | | For Insurance Company Use: Policy Number |
| City Tucson | State AZ | ZIP Code 85743 | Company NAIC Number |

If using the Elevation Certificate to obtain NFIP flood insurance, affix at least building photographs below according to the instructions for Item A6. Identify all photographs with: date taken; "Front View" and "Rear View"; and, if required, "Right Side View" and "Left Side View." If submitting more photographs than will fit on this page, use the Continuation Page on the reverse.

**FRONT VIEW****1/23/2012**

11-458E

Building Photographs

See Instructions for Item A6.

| | | | |
|---|--------------------|--------------------------|---|
| Building Street Address (including Apt., Unit, Suite, and/or Bldg. No.) or P.O. Route and Box No. 12703 W. Crystal Rose Ln. | | | For Insurance Company Use: Policy Number |
| City Tucson | State AZ | ZIP Code 85743 | Company NAIC Number |

If using the Elevation Certificate to obtain NFIP flood insurance, affix at least building photographs below according to the instructions for Item A6. Identify all photographs with: date taken; "Front View" and "Rear View"; and, if required, "Right Side View" and "Left Side View." If submitting more photographs than will fit on this page, use the Continuation Page on the reverse.

**LEFT SIDE VIEW****1/23/2012**