

U.S. DEPARTMENT OF HOMELAND SECURITY  
Federal Emergency Management Agency  
National Flood Insurance Program

OMB Control No. 1660-0008  
Expiration Date: 06/30/2026

FPUP # P18FC00792

DSD # P18BP08886

**ELEVATION CERTIFICATE**

**IMPORTANT: MUST FOLLOW THE INSTRUCTIONS ON PAGES 9-19**

Copy all pages of this Elevation Certificate and all attachments for (1) community official, (2) insurance agent/company, and (3) building owner.

SECTION A – PROPERTY INFORMATION		FOR INSURANCE COMPANY USE
A1. Building Owner's Name: <u>Post Land Company LLC</u>		Policy Number: _____
A2. Building Street Address (including Apt., Unit, Suite, and/or Bldg. No.) or P.O. Route and Box No.: <u>14950 N Trico Rd</u>		Company NAIC Number: _____
City: <u>Marana</u> State: <u>Arizona</u> ZIP Code: <u>85653</u>		
A3. Property Description (e.g., Lot and Block Numbers or Legal Description) and/or Tax Parcel Number: Taxcode: <u>208-12-001N</u> Township <u>11S</u> Range <u>10E</u> Section <u>14</u> S2 NW4 EXC W30' & PTN N2 NW4 SW4		
A4. Building Use (e.g., Residential, Non-Residential, Addition, Accessory, etc.): <u>Accessory: Ticketing Building #C</u>		
A5. Latitude/Longitude: Lat. <u>32°2822.15</u> Long. <u>-111°1743.40</u> Horizontal Datum: <input type="checkbox"/> NAD 1927 <input checked="" type="checkbox"/> NAD 1983 <input type="checkbox"/> WGS 84		
A6. Attach at least two and when possible four clear photographs (one for each side) of the building (see Form pages 7 and 8). <small>Pima County Regional Flood Control District requires four (4) photographs</small>		
A7. Building Diagram Number: <u>1A</u>		
A8. For a building with a crawlspace or enclosure(s):		
a) Square footage of crawlspace or enclosure(s): <u>N/A</u> sq. ft.		
b) Is there at least one permanent flood opening on two different sides of each enclosed area? <input type="checkbox"/> Yes <input type="checkbox"/> No <input checked="" type="checkbox"/> N/A		
c) Enter number of permanent flood openings in the crawlspace or enclosure(s) within 1.0 foot above adjacent grade: Non-engineered flood openings: <u>N/A</u> Engineered flood openings: <u>N/A</u>		
d) Total net open area of non-engineered flood openings in A8.c: <u>N/A</u> sq. in.		
e) Total rated area of engineered flood openings in A8.c (attach documentation – see Instructions): <u>N/A</u> sq. ft.		
f) Sum of A8.d and A8.e rated area (if applicable – see Instructions): <u>N/A</u> sq. ft.		
A9. For a building with an attached garage:		
a) Square footage of attached garage: <u>N/A</u> sq. ft.		
b) Is there at least one permanent flood opening on two different sides of the attached garage? <input type="checkbox"/> Yes <input type="checkbox"/> No <input checked="" type="checkbox"/> N/A		
c) Enter number of permanent flood openings in the attached garage within 1.0 foot above adjacent grade: Non-engineered flood openings: <u>N/A</u> Engineered flood openings: <u>N/A</u>		
d) Total net open area of non-engineered flood openings in A9.c: <u>N/A</u> sq. in.		
e) Total rated area of engineered flood openings in A9.c (attach documentation – see Instructions): <u>N/A</u> sq. ft.		
f) Sum of A9.d and A9.e rated area (if applicable – see Instructions): <u>N/A</u> sq. ft.		
SECTION B – FLOOD INSURANCE RATE MAP (FIRM) INFORMATION		
B1.a. NFIP Community Name: <u>Pima County</u>		B1.b. NFIP Community Identification Number: <u>040073</u>
B2. County Name: <u>Pima County</u>	B3. State: <u>Arizona</u>	B4. Map/Panel No.: <u>04019C 1010</u> B5. Suffix: <u>L</u>
B6. FIRM Index Date: <u>09/28/2012</u>		B7. FIRM Panel Effective/Revised Date: <u>08/18/2023</u>
B8. Flood Zone(s): <u>AE</u>		B9. Base Flood Elevation(s) (BFE) (Zone AO, use Base Flood Depth): <u>1914.0</u>
B10. Indicate the source of the BFE data or Base Flood Depth entered in Item B9: <input type="checkbox"/> FIS <input checked="" type="checkbox"/> FIRM <input type="checkbox"/> Community Determined <input type="checkbox"/> Other: _____		
B11. Indicate elevation datum used for BFE in Item B9: <input type="checkbox"/> NGVD 1929 <input checked="" type="checkbox"/> NAVD 1988 <input type="checkbox"/> Other/Source: _____		Highest Adjacent Natural Grade (=100.0 ft)
B12. Is the building located in a Coastal Barrier Resources System (CBRS) area or Otherwise Protected Area (OPA)? <input type="checkbox"/> Yes <input checked="" type="checkbox"/> No Designation Date: <u>N/A</u> <input type="checkbox"/> CBRS <input type="checkbox"/> OPA		
B13. Is the building located seaward of the Limit of Moderate Wave Action (LIMWA)? <input type="checkbox"/> Yes <input checked="" type="checkbox"/> No		

# ELEVATION CERTIFICATE

IMPORTANT: MUST FOLLOW THE INSTRUCTIONS ON PAGES 9-19

Building Street Address (including Apt., Unit, Suite, and/or Bldg. No.) or P.O. Route and Box No.:

14950 N Trico Rd

City: Marana

State: Arizona ZIP Code: 85653

FOR INSURANCE COMPANY USE

Policy Number:

Company NAIC Number:

## SECTION C – BUILDING ELEVATION INFORMATION (SURVEY REQUIRED)

C1. Building elevations are based on: ☐ Construction Drawings\* ☐ Building Under Construction\* ☒ Finished Construction

\*A new Elevation Certificate will be required when construction of the building is complete.

C2. Elevations – Zones A1–A30, AE, AH, AO, A (with BFE), VE, V1–V30, V (with BFE), AR, AR/A, AR/AE, AR/A1–A30, AR/AH, AR/AO, A99. Complete Items C2.a–h below according to the Building Diagram specified in Item A7. In Puerto Rico only, enter meters.

Benchmark Utilized: Pima County OPUS Pt. L-17 (PID ) Vertical Datum: El. = 1911.61 (NAVD 1988)

Indicate elevation datum used for the elevations in items a) through h) below.

☐ NGVD 1929 ☒ NAVD 1988 ☐ Other: \_\_\_\_\_

Datum used for building elevations must be the same as that used for the BFE. Conversion factor used?

☐ Yes ☒ No

If Yes, describe the source of the conversion factor in the Section D Comments area.

Check the measurement used:

a) Top of bottom floor (including basement, crawlspace, or enclosure floor): 1916.82 ☒ feet ☐ meters

b) Top of the next higher floor (see Instructions): N/A ☒ feet ☐ meters

c) Bottom of the lowest horizontal structural member (see Instructions): N/A ☒ feet ☐ meters

d) Attached garage (top of slab): N/A ☒ feet ☐ meters

e) Lowest elevation of Machinery and Equipment (M&E) servicing the building (describe type of M&E and location in Section D Comments area): 1916.6 ☒ feet ☐ meters

f) Lowest Adjacent Grade (LAG) next to building: ☒ Natural ☒ Finished 1915.6 ☒ feet ☐ meters

PCRFCD Note: For projects involving a fill pad indicate lowest adjacent finished grade in Section D

g) Highest Adjacent Grade (HAG) next to building: ☒ Natural ☒ Finished 1916.00 ☒ feet ☐ meters

PCRFCD Note: For projects involving a fill pad indicate highest adjacent finished grade in Section D

h) Finished LAG at lowest elevation of attached deck or stairs, including structural support: N/A ☒ feet ☐ meters

## SECTION D – SURVEYOR, ENGINEER, OR ARCHITECT CERTIFICATION

This certification is to be signed and sealed by a land surveyor, engineer, or architect authorized by state law to certify elevation information. I certify that the information on this Certificate represents my best efforts to interpret the data available. I understand that any false statement may be punishable by fine or imprisonment under 18 U.S. Code, Section 1001.

Were latitude and longitude in Section A provided by a licensed land surveyor? ☒ Yes ☐ No

☒ Check here if attachments and describe in the Comments area.

Certifier's Name: Kevin D. Riley License Number: 42285

Title: Land Surveyor

Company Name: Bowman

Address: 3275 W. Ina Rd.

City: Tucson State: AZ ZIP Code: 85741

Signature:  Date: 8/31/23

Telephone: (520) 353-9432 Ext.: \_\_\_\_\_ Email: Kriley@bowman.com

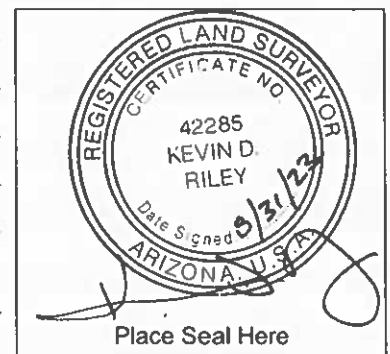

Copy all pages of this Elevation Certificate and all attachments for (1) community official, (2) insurance agent/company, and (3) building owner.

Comments (including source of conversion factor in C2; type of equipment and location per C2.e; and description of any attachments):

The lowest service equipment (C2.e) is the 1916.6 Fiberglass A/C Pad

Highest adjacent finished grade is 1916.47 Lowest adjacent finish grade is 1916.19

Base Flood Elevation was determined based on a Letter of Map Revision dated April 5, 2023 and effective August 18, 2023 along with the associated revised Firm Map listed in Section B. (See Attached)

# ELEVATION CERTIFICATE

IMPORTANT: MUST FOLLOW THE INSTRUCTIONS ON PAGES 9-19

Building Street Address (including Apt., Unit, Suite, and/or Bldg. No.) or P.O. Route and Box No.:

14950 N Trico Rd

City: Marana

State: Arizona ZIP Code: 85653

## FOR INSURANCE COMPANY USE

Policy Number: \_\_\_\_\_

Company NAIC Number: \_\_\_\_\_

## SECTION E – BUILDING MEASUREMENT INFORMATION (SURVEY NOT REQUIRED) FOR ZONE AO, ZONE AR/AO, AND ZONE A (WITHOUT BFE)

For Zones AO, AR/AO, and A (without BFE), complete Items E1–E5. For Items E1–E4, use natural grade, if available. If the Certificate is intended to support a Letter of Map Change request, complete Sections A, B, and C. Check the measurement used. In Puerto Rico only, enter meters.

Building measurements are based on: ☐ Construction Drawings\* ☐ Building Under Construction\* ☐ Finished Construction

\*A new Elevation Certificate will be required when construction of the building is complete.

E1. Provide measurements (C.2.a in applicable Building Diagram) for the following and check the appropriate boxes to show whether the measurement is above or below the natural HAG and the LAG.

a) Top of bottom floor (including basement, crawlspace, or enclosure) is:

☐ feet ☐ meters ☐ above or ☐ below the HAG.

b) Top of bottom floor (including basement, crawlspace, or enclosure) is:

☐ feet ☐ meters ☐ above or ☐ below the LAG.

E2. For Building Diagrams 6–9 with permanent flood openings provided in Section A Items 8 and/or 9 (see pages 1–2 of Instructions), the next higher floor (C.2.b in applicable Building Diagram) of the building is:

☐ feet ☐ meters ☐ above or ☐ below the HAG.

E3. Attached garage (top of slab) is:

☐ feet ☐ meters ☐ above or ☐ below the HAG.

E4. Top of platform of machinery and/or equipment servicing the building is:

☐ feet ☐ meters ☐ above or ☐ below the HAG.

E5. Zone AO only: If no flood depth number is available, is the top of the bottom floor elevated in accordance with the community's floodplain management ordinance? ☐ Yes ☐ No ☐ Unknown The local official must certify this information in Section G.

## SECTION F – PROPERTY OWNER (OR OWNER'S AUTHORIZED REPRESENTATIVE) CERTIFICATION

The property owner or owner's authorized representative who completes Sections A, B, and E for Zone A (without BFE) or Zone AO must sign here. The statements in Sections A, B, and E are correct to the best of my knowledge.

☐ Check here if attachments and describe in the Comments area.

Property Owner or Owner's Authorized Representative Name: \_\_\_\_\_

Address: \_\_\_\_\_

City: \_\_\_\_\_ State: \_\_\_\_\_ ZIP Code: \_\_\_\_\_

Signature: \_\_\_\_\_ Date: \_\_\_\_\_

Telephone: \_\_\_\_\_ Ext.: \_\_\_\_\_ Email: \_\_\_\_\_

Comments: \_\_\_\_\_

# ELEVATION CERTIFICATE

IMPORTANT: MUST FOLLOW THE INSTRUCTIONS ON PAGES 9-19

Building Street Address (including Apt., Unit, Suite, and/or Bldg. No.) or P.O. Route and Box No.:

14950 N Trico Rd

City: Marana

State: Arizona ZIP Code: 85653

## FOR INSURANCE COMPANY USE

Policy Number: \_\_\_\_\_

Company NAIC Number: \_\_\_\_\_

## SECTION G – COMMUNITY INFORMATION (RECOMMENDED FOR COMMUNITY OFFICIAL COMPLETION)

The local official who is authorized by law or ordinance to administer the community's floodplain management ordinance can complete Section A, B, C, E, G, or H of this Elevation Certificate. Complete the applicable item(s) and sign below when:

- G1. ☐ The information in Section C was taken from other documentation that has been signed and sealed by a licensed surveyor, engineer, or architect who is authorized by state law to certify elevation information. (Indicate the source and date of the elevation data in the Comments area below.)
- G2.a. ☐ A local official completed Section E for a building located in Zone A (without a BFE), Zone AO, or Zone AR/AO, or when item E5 is completed for a building located in Zone AO.
- G2.b. ☐ A local official completed Section H for insurance purposes.
- G3. ☐ In the Comments area of Section G, the local official describes specific corrections to the information in Sections A, B, E and H.
- G4. ☐ The following information (Items G5–G11) is provided for community floodplain management purposes.
- G5. Permit Number: \_\_\_\_\_ G6. Date Permit Issued: \_\_\_\_\_
- G7. Date Certificate of Compliance/Occupancy Issued: \_\_\_\_\_
- G8. This permit has been issued for: ☐ New Construction ☐ Substantial Improvement
- G9.a. Elevation of as-built lowest floor (including basement) of the building: \_\_\_\_\_ ☐ feet ☐ meters Datum: \_\_\_\_\_
- G9.b. Elevation of bottom of as-built lowest horizontal structural member: \_\_\_\_\_ ☐ feet ☐ meters Datum: \_\_\_\_\_
- G10.a. BFE (or depth in Zone AO) of flooding at the building site: \_\_\_\_\_ ☐ feet ☐ meters Datum: \_\_\_\_\_
- G10.b. Community's minimum elevation (or depth in Zone AO) requirement for the lowest floor or lowest horizontal structural member: \_\_\_\_\_ ☐ feet ☐ meters Datum: \_\_\_\_\_
- G11. Variance issued? ☐ Yes ☐ No If yes, attach documentation and describe in the Comments area.

The local official who provides information in Section G must sign here. *I have completed the information in Section G and certify that it is correct to the best of my knowledge. If applicable, I have also provided specific corrections in the Comments area of this section.*

Local Official's Name: \_\_\_\_\_ Title: \_\_\_\_\_

NFIP Community Name: \_\_\_\_\_

Telephone: \_\_\_\_\_ Ext.: \_\_\_\_\_ Email: \_\_\_\_\_

Address: \_\_\_\_\_

City: \_\_\_\_\_ State: \_\_\_\_\_ ZIP Code: \_\_\_\_\_

Signature: \_\_\_\_\_ Date: \_\_\_\_\_

Comments (including type of equipment and location, per C2.e; description of any attachments; and corrections to specific information in Sections A, B, D, E, or H):

# ELEVATION CERTIFICATE

IMPORTANT: MUST FOLLOW THE INSTRUCTIONS ON PAGES 9-19

Building Street Address (including Apt., Unit, Suite, and/or Bldg. No.) or P.O. Route and Box No.:

14950 N Trico Rd

City: Marana

State: Arizona ZIP Code: 85653

## FOR INSURANCE COMPANY USE

Policy Number: \_\_\_\_\_

Company NAIC Number: \_\_\_\_\_

### SECTION H – BUILDING'S FIRST FLOOR HEIGHT INFORMATION FOR ALL ZONES (SURVEY NOT REQUIRED) (FOR INSURANCE PURPOSES ONLY)

The property owner, owner's authorized representative, or local floodplain management official may complete Section H for all flood zones to determine the building's first floor height for insurance purposes. Sections A, B, and I must also be completed. Enter heights to the nearest tenth of a foot (nearest tenth of a meter in Puerto Rico). **Reference the Foundation Type Diagrams (at the end of Section H Instructions) and the appropriate Building Diagrams (at the end of Section I Instructions) to complete this section.**

H1. Provide the height of the top of the floor (as indicated in Foundation Type Diagrams) above the Lowest Adjacent Grade (LAG):

a) For Building Diagrams 1A, 1B, 3, and 5–9. Top of bottom \_\_\_\_\_ ☐ feet ☐ meters ☐ above the LAG  
floor (include above-grade floors only for buildings with  
subgrade crawlspaces or enclosure floors) is:

b) For Building Diagrams 2A, 2B, 4, and 6–9. Top of next \_\_\_\_\_ ☐ feet ☐ meters ☐ above the LAG  
higher floor (i.e., the floor above basement, crawlspace, or  
enclosure floor) is:

H2. Is all Machinery and Equipment servicing the building (as listed in Item H2 instructions) elevated to or above the floor indicated by the H2 arrow (shown in the Foundation Type Diagrams at end of Section H instructions) for the appropriate Building Diagram?

☐ Yes ☐ No

### SECTION I – PROPERTY OWNER (OR OWNER'S AUTHORIZED REPRESENTATIVE) CERTIFICATION

The property owner or owner's authorized representative who completes Sections A, B, and H must sign here. *The statements in Sections A, B, and H are correct to the best of my knowledge.* **Note:** If the local floodplain management official completed Section H, they should indicate in Item G2.b and sign Section G.

☐ Check here if attachments are provided (including required photos) and describe each attachment in the Comments area.

Property Owner or Owner's Authorized Representative Name: \_\_\_\_\_

Address: \_\_\_\_\_

City: \_\_\_\_\_ State: \_\_\_\_\_ ZIP Code: \_\_\_\_\_

Signature: \_\_\_\_\_ Date: \_\_\_\_\_

Telephone: \_\_\_\_\_ Ext.: \_\_\_\_\_ Email: \_\_\_\_\_

Comments: \_\_\_\_\_



**ELEVATION CERTIFICATE**  
**IMPORTANT: MUST FOLLOW THE INSTRUCTIONS ON PAGES 9-19**  
**BUILDING PHOTOGRAPHS**

See Instructions for Item A6.

Building Street Address (including Apt., Unit, Suite, and/or Bldg. No.) or P.O. Route and Box No.:

14950 N Trico Rd

City: Marana

State: Arizona

ZIP Code: 85653

**FOR INSURANCE COMPANY USE**

Policy Number: \_\_\_\_\_

Company NAIC Number: \_\_\_\_\_

Instructions: Insert below at least two and when possible four photographs showing each side of the building (for example, may only be able to take front and back pictures of townhouses/rowhouses). Identify all photographs with the date taken and "Front View," "Rear View," "Right Side View," or "Left Side View." Photographs must show the foundation. When flood openings are present, include at least one close-up photograph of representative flood openings or vents, as indicated in Sections A8 and A9.



Photo One

Photo One Caption: Admissions - Front - 6/22/23



Photo Two

Photo Two Caption: Admissions - North Side - 6/22/23

**ELEVATION CERTIFICATE**  
**IMPORTANT: MUST FOLLOW THE INSTRUCTIONS ON PAGES 9-19**  
**BUILDING PHOTOGRAPHS**

Continuation Page

Building Street Address (including Apt., Unit, Suite, and/or Bldg. No.) or P.O. Route and Box No.:

14950 N Trico Rd

City: Marana

State: Arizona ZIP Code: 85653

**FOR INSURANCE COMPANY USE**

Policy Number: \_\_\_\_\_

Company NAIC Number: \_\_\_\_\_

Insert the third and fourth photographs below. Identify all photographs with the date taken and "Front View," "Rear View," "Right Side View," or "Left Side View." When flood openings are present, include at least one close-up photograph of representative flood openings or vents, as indicated in Sections A8 and A9.



Photo Three

Photo Three Caption: Admissions - Rear - 6/22/23



Photo Four

Photo Four Caption: Admissions - South Side - 6-22-23



# Federal Emergency Management Agency

Washington, D.C. 20472

## LETTER OF MAP REVISION DETERMINATION DOCUMENT

COMMUNITY AND REVISION INFORMATION		PROJECT DESCRIPTION	BASIS OF REQUEST
COMMUNITY	Town of Marana Pima County Arizona	NO PROJECT	FLOODWAY 2D HYDRAULIC ANALYSIS UPDATED TOPOGRAPHIC DATA
	COMMUNITY NO.: 040118		
IDENTIFIER	5SCLIV, Lower Santa Cruz River	APPROXIMATE LATITUDE & LONGITUDE: 32.453, -111.277 SOURCE: USGS QUADRANGLE      DATUM: NAD 83	
ANNOTATED MAPPING ENCLOSURES		ANNOTATED STUDY ENCLOSURES	
TYPE FIRM*      NO. 04019C1030L      DATE June 16, 2011 TYPE FIRM      NO. 04019C1020L      DATE June 16, 2011 TYPE FIRM      NO. 04019C0420L      DATE June 16, 2011 TYPE FIRM      NO. 04019C1010L      DATE June 16, 2011 TYPE FIRM      NO. 04019C1040L      DATE June 16, 2011		DATE OF EFFECTIVE FLOOD INSURANCE STUDY: September 28, 2012  PROFILE(S): 201P - 203P FLOODWAY DATA TABLE: 8	

Enclosures reflect changes to flooding sources affected by this revision  
 \* FIRM - Flood Insurance Rate Map

### FLOODING SOURCE(S) & REVISED REACH(ES)

See Page 2 for Additional Flooding Sources

Santa Cruz River - from approximately 20,000 feet downstream of North Trico Road to just downstream of North Sanders Road.

### SUMMARY OF REVISIONS

Flooding Source	Effective Flooding	Revised Flooding	Increases	Decreases
Santa Cruz River	BFEs*	BFEs	YES	YES
	Zone AE	Zone AE	YES	YES
	Floodway	Floodway	YES	YES
	Zone X (shaded)	Zone X (unshaded)	YES	YES

\* BFEs - Base Flood Elevations

### DETERMINATION

This document provides the determination from the Department of Homeland Security's Federal Emergency Management Agency (FEMA) regarding a request for a Letter of Map Revision (LOMR) for the area described above. Using the information submitted, we have determined that a revision to the flood hazards depicted in the Flood Insurance Study (FIS) report and/or National Flood Insurance Program (NFIP) map is warranted. This document revises the effective NFIP map, as indicated in the attached documentation. Please use the enclosed annotated map panels revised by this LOMR for floodplain management purposes and for all flood insurance policies and renewals in your community.

This determination is based on the flood data presently available. The enclosed documents provide additional information regarding this determination. If you have any questions about this document, please contact the FEMA Mapping and Insurance eXchange (FMIX) toll free at 1-877-336-2627 (1-877-FEMA MAP) or by letter addressed to the LOMC Clearinghouse, 3601 Eisenhower Avenue, Suite 500, Alexandria, VA 22304-6426. Additional information about the NFIP is available on our website at <https://www.fema.gov/flood-insurance>.

Patrick "Rick" F. Sacbitt, P.E., Branch Chief  
 Engineering Services Branch  
 Federal Insurance and Mitigation Administration





**Federal Emergency Management Agency**  
Washington, D.C. 20472

**LETTER OF MAP REVISION  
DETERMINATION DOCUMENT (CONTINUED)**

**OTHER FLOODING SOURCES AFFECTED BY THIS REVISION**

**FLOODING SOURCE(S) & REVISED REACH(ES)**

Tortolita Mountain Runoff - from approximately 10 000 feet downstream of North Lockett Road to just upstream of North Lockett Road.

**SUMMARY OF REVISIONS**

Flooding Source	Effective Flooding	Revised Flooding	Increases	Decreases
Tortolita Mountain Runoff	Depths	Depths	NONE	NONE
	Zone AO	Zone AO	NONE	YES
	Zone X (unshaded)	Zone AO	YES	YES

This determination is based on the flood data presently available. The enclosed documents provide additional information regarding this determination. If you have any questions about this document, please contact the FEMA Mapping and Insurance eXchange (FMIX) toll free at 1-877-336-2627 (1-877-FEMA MAP) or by letter addressed to the LOMC Clearinghouse, 3601 Eisenhower Avenue, Suite 500, Alexandria, VA 22304-6426. Additional information about the NFIP is available on our website at <https://www.fema.gov/flood-insurance>.

Patrick "Rick" F. Sacbibit, P.E., Branch Chief  
Engineering Services Branch  
Federal Insurance and Mitigation Administration



**Federal Emergency Management Agency**  
Washington, D.C. 20472

**LETTER OF MAP REVISION  
DETERMINATION DOCUMENT (CONTINUED)**

**OTHER COMMUNITIES AFFECTED BY THIS REVISION**

**CID Number:** 040073      **Name:** Pima County, Arizona

AFFECTED MAP PANELS				AFFECTED PORTIONS OF THE FLOOD INSURANCE STUDY REPORT
TYPE: FIRM	NO. 04019C0415L	DATE: June 16, 2011		DATE OF EFFECTIVE FLOOD INSURANCE STUDY: September 28, 2012 PROFILE(S): 199P-203P FLOODWAY DATA TABLE 8
TYPE: FIRM	NO. 04019C1020L	DATE: June 16, 2011		
TYPE: FIRM	NO. 04019C1010L	DATE: June 16, 2011		
TYPE: FIRM	NO. 04019C1005L	DATE: June 16, 2011		
TYPE: FIRM	NO. 04019C0420L	DATE: June 16, 2011		

This determination is based on the flood data presently available. The enclosed documents provide additional information regarding this determination. If you have any questions about this document, please contact the FEMA Mapping and Insurance eXchange (FMIX) toll free at 1-877-336-2627 (1-877-FEMA MAP) or by letter addressed to the LOMC Clearinghouse, 3601 Eisenhower Avenue, Suite 500, Alexandria, VA 22304-6426. Additional information about the NFIP is available on our website at <https://www.fema.gov/flood-insurance>.

Patrick "Rick" F. Sacbibit, P.E., Branch Chief  
Engineering Services Branch  
Federal Insurance and Mitigation Administration



**Federal Emergency Management Agency**  
Washington, D.C. 20472

**LETTER OF MAP REVISION  
DETERMINATION DOCUMENT (CONTINUED)**

**COMMUNITY INFORMATION**

**APPLICABLE NFIP REGULATIONS/COMMUNITY OBLIGATION**

We have made this determination pursuant to Section 206 of the Flood Disaster Protection Act of 1973 (P.L. 93-234) and in accordance with the National Flood Insurance Act of 1968, as amended (Title XIII of the Housing and Urban Development Act of 1968, P.L. 90-448), 42 U.S.C. 4001-4128, and 44 CFR Part 65. Pursuant to Section 1361 of the National Flood Insurance Act of 1968, as amended, communities participating in the NFIP are required to adopt and enforce floodplain management regulations that meet or exceed NFIP criteria. These criteria, including adoption of the FIS report and FIRM, and the modifications made by this LOMR, are the minimum requirements for continued NFIP participation and do not supersede more stringent State Commonwealth or local requirements to which the regulations apply.

We provide the floodway designation to your community as a tool to regulate floodplain development. Therefore, the floodway revision we have described in this letter, while acceptable to us, must also be acceptable to your community and adopted by appropriate community action, as specified in Paragraph 60.3(d) of the NFIP regulations.

**COMMUNITY REMINDERS**

We based this determination on the 1-percent-annual-chance flood discharges computed in the FIS for your community without considering subsequent changes in watershed characteristics that could increase flood discharges. Future development of projects upstream could cause increased flood discharges, which could cause increased flood hazards. A comprehensive restudy of your community's flood hazards would consider the cumulative effects of development on flood discharges subsequent to the publication of the FIS report for your community and could, therefore, establish greater flood hazards in this area.

Your community must regulate all proposed floodplain development and ensure that permits required by Federal and/or State/Commonwealth law have been obtained. State/Commonwealth or community officials, based on knowledge of local conditions and in the interest of safety, may set higher standards for construction or may limit development in floodplain areas. If your State/Commonwealth or community has adopted more restrictive or comprehensive floodplain management criteria, those criteria take precedence over the minimum NFIP requirements.

We will not print and distribute this LOMR to primary users, such as local insurance agents or mortgage lenders, instead, the community will serve as a repository for the new data. We encourage you to disseminate the information in this LOMR by preparing a news release for publication in your community's newspaper that describes the revision and explains how your community will provide the data and help interpret the NFIP maps. In that way, interested persons, such as property owners, insurance agents, and mortgage lenders, can benefit from the information.

This determination is based on the flood data presently available. The enclosed documents provide additional information regarding this determination. If you have any questions about this document, please contact the FEMA Mapping and Insurance eXchange (FMIX) toll free at 1-877-336-2627 (1-877-FEMA MAP) or by letter addressed to the LOMC Clearinghouse, 3601 Eisenhower Avenue, Suite 500, Alexandria, VA 22304-6426. Additional information about the NFIP is available on our website at <https://www.fema.gov/flood-insurance>.

Patrick "Rick" F. Sacibit, P.E., Branch Chief  
Engineering Services Branch  
Federal Insurance and Mitigation Administration



**Federal Emergency Management Agency**  
Washington, D.C. 20472

**LETTER OF MAP REVISION  
DETERMINATION DOCUMENT (CONTINUED)**

We have designated a Consultation Coordination Officer (CCO) to assist your community. The CCO will be the primary liaison between your community and FEMA. For information regarding your CCO, please contact:

Kathryn Lipiecki  
Director, Mitigation Division  
Federal Emergency Management Agency, Region IX  
1111 Broadway, Suite 1200  
Oakland, CA 94607-4052  
(510) 627-7211

**STATUS OF THE COMMUNITY NFIP MAPS**

We will not physically revise and republish the FIRM and FIS report for your community to reflect the modifications made by this LOMR at this time. When changes to the previously cited FIRM panel(s) and FIS report warrant physical revision and republication in the future, we will incorporate the modifications made by this LOMR at that time.

This determination is based on the flood data presently available. The enclosed documents provide additional information regarding this determination. If you have any questions about this document, please contact the FEMA Mapping and Insurance eXchange (FMIX) toll free at 1-877-336-2627 (1-877-FEMA MAP) or by letter addressed to the LOMC Clearinghouse, 3601 Eisenhower Avenue, Suite 500, Alexandria, VA 22304-6426. Additional information about the NFIP is available on our website at <https://www.fema.gov/flood-insurance>.

Patrick "Rick" F. Sacbibit, P.E., Branch Chief  
Engineering Services Branch  
Federal Insurance and Mitigation Administration