



Floodplain Use Permit- Case History

RECORD: P19FC00044

Building/Floodplain Use Permit

Case Name:MHR

Issue: Mobile Home replacement with T400 and upgrade to 200a

1/30/2019 Application Intake - Submitted: Application successfully submitted

Case Reviewer:Gail Kroth

1/31/2019 Review - Note: RFC Drafted. Proposed Manufactured Home close to Lee Moore Floodplain boundary, request to orientate NW-SE. Travel trailers on property, seem to be road ready and non-occupied.

Case Reviewer:David Saba

1/31/2019 Review - Note: Draft RFC letter review completed, ok to mail.

Case Reviewer:Francisco Ramirez

1/31/2019 Review - Request for Corrections: RFC Email Sent

Case Reviewer:David Saba

2/5/2019 Application Intake - Resubmit: Applicant resubmitted site plan at counter. Wire fence, camper trailers, junk, central horse stall to be removed. Will send photos

Case Reviewer:David Saba

2/7/2019 Review - Note: Spoke with applicant at counter, confirmed accuracy of revised site plan. Request to be issued once photos of junk removed have been returned. Need Access Covs?

Case Reviewer:David Saba

2/13/2019 Review - Approved: FPUP approved. D1FC1 plan set uploaded to DSD plan review folder.

Case Reviewer:Francisco Ramirez

4/4/2019 Issuance - Note: Photos received, covenants needed

Case Reviewer:David Saba



4/12/2019 Issuance - Issued - Documents Required: No Comments

Case Reviewer:Gail Kroth

4/15/2019 Inspection - Note: WAITING FOR GENERAL AND ACCESS COVENANTS TO BE RETURNED FROM THE RECORDERS OFFICE AND FOR THE EL CERT TO BE RETURNED.

Case Reviewer:Deanna Reyes

9/6/2019 Inspection - Documents Approved: P2E Elevation Certificate reviewed, OK, LSFM & SE above RFE on reinforced piers; hold released.

Case Reviewer:Edward Eastburn

9/6/2019 Close Out - Note: FPUP folder placed in "Chrono" slot.

Case Reviewer:Edward Eastburn

1/16/2020 Close Out - Note: COVENANTS RETURNED AND RECORDED 4/19/19

Case Reviewer:Debbie Grijalva

4/28/2026 Close Out - Note: all docs returned. OK to close out

Case Reviewer:Philip Calabrese

4/28/2026 Close Out - Complete: No Comments

Case Reviewer:Valerie Gonzales

FPUP # P19FC00044
 DSD # P19BP00649

ELEVATION CERTIFICATE

Important: Follow the instructions on pages 1-9.

Copy all pages of this Elevation Certificate and all attachments for (1) community official, (2) insurance agent/company, and (3) building owner.

SECTION A - PROPERTY INFORMATION				FOR INSURANCE COMPANY USE	
A1. Building Owner's Name Samantha N Garcia				Policy Number:	
A2. Building Street Address (including Apt., Unit, Suite, and/or Bldg. No.) or P.O. Route and Box No. 17555 S Columbus Bl				Company NAIC Number:	
City Sahuarita		State Arizona		ZIP Code 85629	
A3. Property Description (Lot and Block Numbers, Tax Parcel Number, Legal Description, etc.) Taxcode: 303-64-055B Township 17S Range 14E Section 22 E2 S2 NW4 SW4 SE4 2.50 AC SEC 22-17-14					
A4. Building Use (e.g., Residential, Non-Residential, Addition, Accessory, etc.) Residential: <u>Manufactured Home Replacement</u>					
A5. Latitude/Longitude: Lat. <u>31.930632</u> Long. <u>-110.899976</u> Horizontal Datum: <input type="checkbox"/> NAD 1927 <input checked="" type="checkbox"/> NAD 1983					
A6. Attach at least 2 photographs of the building if the Certificate is being used to obtain flood insurance. <small>Pima County Regional Flood Control District requires four (4) photographs.</small>					
A7. Building Diagram Number <u>5</u>					
A8. For a building with a crawlspace or enclosure(s):					
a) Square footage of crawlspace or enclosure(s) <u>0</u> sq ft					
b) Number of permanent flood openings in the crawlspace or enclosure(s) within 1.0 foot above adjacent grade <u>0</u>					
c) Total net area of flood openings in A8.b <u>0</u> sq in					
d) Engineered flood openings? <input type="checkbox"/> Yes <input checked="" type="checkbox"/> No					
A9. For a building with an attached garage:					
a) Square footage of attached garage <u>0</u> sq ft					
b) Number of permanent flood openings in the attached garage within 1.0 foot above adjacent grade <u>0</u>					
c) Total net area of flood openings in A9.b <u>0</u> sq in					
d) Engineered flood openings? <input type="checkbox"/> Yes <input checked="" type="checkbox"/> No					
SECTION B - FLOOD INSURANCE RATE MAP (FIRM) INFORMATION					
B1. NFIP Community Name & Community Number Pima County / 040073			B2. County Name Pima County		B3. State Arizona
B4. Map/Panel Number 04019C3470	B5. Suffix L	B6. FIRM Index Date 09/28/2012	B7. FIRM Panel Effective/ Revised Date 06-16-2011	B8. Flood Zone(s) X	B9. Base Flood Elevation(s) (Zone AO, use Base Flood Depth) 100.5
B10. Indicate the source of the Base Flood Elevation (BFE) data or base flood depth entered in Item B9: <input type="checkbox"/> FIS Profile <input type="checkbox"/> FIRM <input checked="" type="checkbox"/> Community Determined <input type="checkbox"/> Other/Source: _____					
B11. Indicate elevation datum used for BFE in Item B9: <input type="checkbox"/> NGVD 1929 <input type="checkbox"/> NAVD 1988 <input checked="" type="checkbox"/> Other/Source: <u>Highest Adjacent Natural Grade (=100.0)</u>					
B12. Is the building located in a Coastal Barrier Resources System (CBRS) area or Otherwise Protected Area (OPA)? <input type="checkbox"/> Yes <input checked="" type="checkbox"/> No Designation Date: _____ <input type="checkbox"/> CBRS <input type="checkbox"/> OPA					

ELEVATION CERTIFICATE

OMB No. 1660-0008
Expiration Date: November 30, 2018

IMPORTANT: In these spaces, copy the corresponding information from Section A.			FOR INSURANCE COMPANY USE
Building Street Address (including Apt., Unit, Suite, and/or Bldg. No.) or P.O. Route and Box No. 17555 S Columbus Bl			Policy Number:
City Sahuarita	State Arizona	ZIP Code 85629	Company NAIC Number

SECTION C – BUILDING ELEVATION INFORMATION (SURVEY REQUIRED)

C1. Building elevations are based on: Construction Drawings* Building Under Construction* Finished Construction
 *A new Elevation Certificate will be required when construction of the building is complete.

C2. Elevations – Zones A1–A30, AE, AH, A (with BFE), VE, V1–V30, V (with BFE), AR, AR/A, AR/AE, AR/A1–A30, AR/AH, AR/AO. Complete Items C2.a–h below according to the building diagram specified in Item A7. In Puerto Rico only, enter meters.

Benchmark Utilized: LOCAL Vertical Datum: 100.0'=H.A.N.G.

Indicate elevation datum used for the elevations in items a) through h) below.

NGVD 1929 NAVD 1988 Other/Source: H.A.N.G. = 100.60 feet

Datum used for building elevations must be the same as that used for the BFE.

Check the measurement used.

- | | | | | | |
|---|-------|-------------------------------------|------|--------------------------|--------|
| a) Top of bottom floor (including basement, crawlspace, or enclosure floor) | 103.2 | <input checked="" type="checkbox"/> | feet | <input type="checkbox"/> | meters |
| b) Top of the next higher floor | N/A | <input type="checkbox"/> | feet | <input type="checkbox"/> | meters |
| c) Bottom of the lowest horizontal structural member (V Zones only) | N/A | <input type="checkbox"/> | feet | <input type="checkbox"/> | meters |
| d) Attached garage (top of slab) | N/A | <input type="checkbox"/> | feet | <input type="checkbox"/> | meters |
| e) Lowest elevation of machinery or equipment servicing the building
(Describe type of equipment and location in Comments) | 102.7 | <input checked="" type="checkbox"/> | feet | <input type="checkbox"/> | meters |
| f) Lowest adjacent (finished) grade next to building (LAG)
<small>PCRFCD Note: Indicate lowest adjacent natural grade (LANG) in Section D.</small> | 99.2 | <input checked="" type="checkbox"/> | feet | <input type="checkbox"/> | meters |
| g) Highest adjacent (finished) grade next to building (HAG)
<small>PCRFCD Note: Indicate highest adjacent natural grade (HANG) in Section D.</small> | 100.0 | <input checked="" type="checkbox"/> | feet | <input type="checkbox"/> | meters |
| h) Lowest adjacent grade at lowest elevation of deck or stairs, including structural support | 102.7 | <input checked="" type="checkbox"/> | feet | <input type="checkbox"/> | meters |

SECTION D – SURVEYOR, ENGINEER, OR ARCHITECT CERTIFICATION

This certification is to be signed and sealed by a land surveyor, engineer, or architect authorized by law to certify elevation information. I certify that the information on this Certificate represents my best efforts to interpret the data available. I understand that any false statement may be punishable by fine or imprisonment under 18 U.S. Code, Section 1001.

Were latitude and longitude in Section A provided by a licensed land surveyor? Yes No Check here if attachments.

Certifier's Name EDGAR B. REYNOLDS JR.	License Number AZ RLS 31031	
Title LAND SURVEYOR		
Company Name EDGAR REYNOLDS AND ASSOCIATES		
Address 1926 W. CALLE MECEDORA		
City TUCSON	State AZ	ZIP Code 85745
Signature 	Date 9-5-2019	Telephone 520-884-0292
		Ext. EXPIRES 3-21-2019

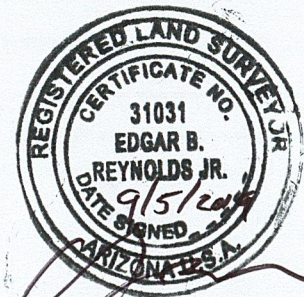

Copy all pages of this Elevation Certificate and all attachments for (1) community official, (2) insurance agent/company, and (3) building owner.

Comments (including type of equipment and location, per C2(e), if applicable)

The lowest service equipment (C3.e) is the HEAT PUMP and the WATER HEATER is/are above this elevation.
 Highest adjacent natural grade is 100.0 Lowest adjacent natural grade is 99.2

USED MANUFACTURED HOME ON PIERS , NO SKIRTING.

ELEVATION CERTIFICATE

BUILDING PHOTOGRAPHS

See Instructions for Item A6.

OMB No. 1660-0008
Expiration Date: November 30, 2018

IMPORTANT: In these spaces, copy the corresponding information from Section A.			FOR INSURANCE COMPANY USE
Building Street Address (including Apt., Unit, Suite, and/or Bldg. No.) or P.O. Route and Box No. 17555 S Columbus Bl			Policy Number:
City Sahuarita	State Arizona	ZIP Code 85629	Company NAIC Number

If using the Elevation Certificate to obtain NFIP flood insurance, affix at least 2 building photographs below according to the instructions for Item A6. Identify all photographs with date taken; "Front View" and "Rear View"; and, if required, "Right Side View" and "Left Side View." When applicable, photographs must show the foundation with representative examples of the flood openings or vents, as indicated in Section A8. If submitting more photographs than will fit on this page, use the Continuation Page.



Photo One

Photo One Caption 17555 S COUMBUS BLVD NW COR

Clear Photo One



Photo Two

Photo Two Caption 17555 S COUMBUS BLVD SW COR

Clear Photo Two