

HR
7/17/19

OMB No. 1660-0008
Expiration Date: November 30, 2018

FPUP # P19FC00285
DSD # P19BP02899

ELEVATION CERTIFICATE

Important: Follow the instructions on pages 1-9.

Copy all pages of this Elevation Certificate and all attachments for (1) community official, (2) insurance agent/company, and (3) building owner.

SECTION A - PROPERTY INFORMATION						FOR INSURANCE COMPANY USE	
A1. Building Owner's Name Steve Scott, William & Anthony Brewster						Policy Number:	
A2. Building Street Address (including Apt., Unit, Suite, and/or Bldg. No.) or P.O. Route and Box No. 12715 West Orange Grove Road						Company NAIC Number:	
City Tucson		State Arizona		ZIP Code 85743			
A3. Property Description (Lot and Block Numbers, Tax Parcel Number, Legal Description, etc.) Taxcode: 213-12-1030 Township 13S Rand 11E Section 08 NW4 NW4 NE4 NE4 EXC W176' 1.17 AC							
A4. Building Use (e.g., Residential, Non-Residential, Addition, Accessory, etc.) <u>Residential: Manufactured Home Replacement</u>							
A5. Latitude/Longitude: Lat. <u>32.320252</u> Long. <u>-111.238678</u> Horizontal Datum: <input type="checkbox"/> NAD 1927 <input checked="" type="checkbox"/> NAD 1983							
A6. Attach at least 2 photographs of the building if the Certificate is being used to obtain flood insurance.							
A7. Building Diagram Number <u>5</u>							
A8. For a building with a crawlspace or enclosure(s):							
a) Square footage of crawlspace or enclosure(s) <u>n/a</u> sq ft							
b) Number of permanent flood openings in the crawlspace or enclosure(s) within 1.0 foot above adjacent grade <u>n/a</u>							
c) Total net area of flood openings in A8.b <u>n/a</u> sq in							
d) Engineered flood openings? <input type="checkbox"/> Yes <input checked="" type="checkbox"/> No							
A9. For a building with an attached garage:							
a) Square footage of attached garage <u>n/a</u> sq ft							
b) Number of permanent flood openings in the attached garage within 1.0 foot above adjacent grade <u>n/a</u>							
c) Total net area of flood openings in A9.b <u>n/a</u> sq in							
d) Engineered flood openings? <input type="checkbox"/> Yes <input checked="" type="checkbox"/> No							
SECTION B - FLOOD INSURANCE RATE MAP (FIRM) INFORMATION							
B1. NFIP Community Name & Community Number Pima County / 040073				B2. County Name Pima County		B3. State Arizona	
B4. Map/Panel Number 04019C1650	B5. Suffix L	B6. FIRM Index Date 09/28/2012	B7. FIRM Panel Effective/Revised Date 06/16/2011	B8. Flood Zone(s) X	B9. Base Flood Elevation(s) (Zone AO, use Base Flood Depth) 100.5		
B10. Indicate the source of the Base Flood Elevation (BFE) data or base flood depth entered in Item B9: <input type="checkbox"/> FIS Profile <input type="checkbox"/> FIRM <input checked="" type="checkbox"/> Community Determined <input type="checkbox"/> Other/Source: _____							
B11. Indicate elevation datum used for BFE in Item B9: <input type="checkbox"/> NGVD 1929 <input type="checkbox"/> NAVD 1988 <input checked="" type="checkbox"/> Other/Source: <u>HANG = 100.0</u>							
B12. Is the building located in a Coastal Barrier Resources System (CBRS) area or Otherwise Protected Area (OPA)? <input type="checkbox"/> Yes <input checked="" type="checkbox"/> No Designation Date: _____ <input type="checkbox"/> CBRS <input type="checkbox"/> OPA							

ELEVATION CERTIFICATE

OMB No. 1660-0008
Expiration Date: November 30, 2018

IMPORTANT: In these spaces, copy the corresponding information from Section A.			FOR INSURANCE COMPANY USE
Building Street Address (including Apt., Unit, Suite, and/or Bldg. No.) or P.O. Route and Box No. 12715 West Orange Grove Road			Policy Number:
City Tucson	State Arizona	ZIP Code 85743	Company NAIC Number

SECTION C – BUILDING ELEVATION INFORMATION (SURVEY REQUIRED)

- C1. Building elevations are based on: ☐ Construction Drawings* ☐ Building Under Construction* ☒ Finished Construction
*A new Elevation Certificate will be required when construction of the building is complete.

- C2. Elevations – Zones A1–A30, AE, AH, A (with BFE), VE, V1–V30, V (with BFE), AR, AR/A, AR/AE, AR/A1–A30, AR/AH, AR/AO. Complete Items C2.a–h below according to the building diagram specified in Item A7. In Puerto Rico only, enter meters.

Benchmark Utilized: LOCAL Vertical Datum: HANG = 100.0

Indicate elevation datum used for the elevations in items a) through h) below.

☐ NGVD 1929 ☐ NAVD 1988 ☒ Other/Source: HANG = 100.0

Datum used for building elevations must be the same as that used for the BFE.

Check the measurement used.

- | | | | |
|---|--|--|---------------------------------|
| a) Top of bottom floor (including basement, crawlspace, or enclosure floor) | <u>103.6</u> | <input checked="" type="checkbox"/> feet | <input type="checkbox"/> meters |
| b) Top of the next higher floor | <u>n/a</u> | <input type="checkbox"/> feet | <input type="checkbox"/> meters |
| c) Bottom of the lowest horizontal structural member (V Zones only) | <u>n/a</u> | <input type="checkbox"/> feet | <input type="checkbox"/> meters |
| d) Attached garage (top of slab) | <u>n/a</u> | <input type="checkbox"/> feet | <input type="checkbox"/> meters |
| e) Lowest elevation of machinery or equipment servicing the building
(Describe type of equipment and location in Comments) | <u>103.6</u> ^{EPC 10-2-19} 100.4 | <input checked="" type="checkbox"/> feet | <input type="checkbox"/> meters |
| f) Lowest adjacent (finished) grade next to building (LAG) | <u>99.6</u> | <input checked="" type="checkbox"/> feet | <input type="checkbox"/> meters |
| g) Highest adjacent (finished) grade next to building (HAG) | <u>100.0</u> | <input checked="" type="checkbox"/> feet | <input type="checkbox"/> meters |
| h) Lowest adjacent grade at lowest elevation of deck or stairs, including structural support | <u>99.7</u> | <input checked="" type="checkbox"/> feet | <input type="checkbox"/> meters |

SECTION D – SURVEYOR, ENGINEER, OR ARCHITECT CERTIFICATION

This certification is to be signed and sealed by a land surveyor, engineer, or architect authorized by law to certify elevation information. I certify that the information on this Certificate represents my best efforts to interpret the data available. I understand that any false statement may be punishable by fine or imprisonment under 18 U.S. Code, Section 1001.

Were latitude and longitude in Section A provided by a licensed land surveyor? ☐ Yes ☒ No ☐ Check here if attachments.

Certifier's Name
Robert Acken

License Number
AZ RLS 41659

Title
Registered Land Surveyor

Company Name
Racken Survey Consultants

Address
9800 W Picture Rocks Rd

City
Tucson

State
Arizona

ZIP Code
85743

Signature
Robert P. Acken

Date
7/15/2019

Telephone

Ext.

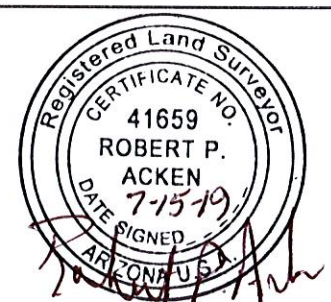

Copy all pages of this Elevation Certificate and all attachments for (1) community official, (2) insurance agent/company, and (3) building owner.

Comments (including type of equipment and location, per C2(e), if applicable)

C2.e = Electric Meter post at ground *Bottom of water heater in Manufactured Home.*
EPC 10-2-19

ELEVATION CERTIFICATE

OMB No. 1660-0008
Expiration Date: November 30, 2018

IMPORTANT: In these spaces, copy the corresponding information from Section A.			FOR INSURANCE COMPANY USE	
Building Street Address (including Apt., Unit, Suite, and/or Bldg. No.) or P.O. Route and Box No. 12715 West Orange Grove Road			Policy Number:	
City Tucson	State Arizona	ZIP Code 85743	Company NAIC Number	

SECTION E – BUILDING ELEVATION INFORMATION (SURVEY NOT REQUIRED) FOR ZONE AO AND ZONE A (WITHOUT BFE)

For Zones AO and A (without BFE), complete Items E1–E5. If the Certificate is intended to support a LOMA or LOMR-F request, complete Sections A, B, and C. For Items E1–E4, use natural grade, if available. Check the measurement used. In Puerto Rico only, enter meters.

- E1. Provide elevation information for the following and check the appropriate boxes to show whether the elevation is above or below the highest adjacent grade (HAG) and the lowest adjacent grade (LAG).
- a) Top of bottom floor (including basement, crawlspace, or enclosure) is _____ ☐ feet ☐ meters ☐ above or ☐ below the HAG.
- b) Top of bottom floor (including basement, crawlspace, or enclosure) is _____ ☐ feet ☐ meters ☐ above or ☐ below the LAG.
- E2. For Building Diagrams 6–9 with permanent flood openings provided in Section A Items 8 and/or 9 (see pages 1–2 of Instructions), the next higher floor (elevation C2.b in the diagrams) of the building is _____ ☐ feet ☐ meters ☐ above or ☐ below the HAG.
- E3. Attached garage (top of slab) is _____ ☐ feet ☐ meters ☐ above or ☐ below the HAG.
- E4. Top of platform of machinery and/or equipment servicing the building is _____ ☐ feet ☐ meters ☐ above or ☐ below the HAG.
- E5. Zone AO only: If no flood depth number is available, is the top of the bottom floor elevated in accordance with the community's floodplain management ordinance? ☐ Yes ☐ No ☐ Unknown. The local official must certify this information in Section G.

SECTION F – PROPERTY OWNER (OR OWNER'S REPRESENTATIVE) CERTIFICATION

The property owner or owner's authorized representative who completes Sections A, B, and E for Zone A (without a FEMA-issued or community-issued BFE) or Zone AO must sign here. The statements in Sections A, B, and E are correct to the best of my knowledge.

Property Owner or Owner's Authorized Representative's Name

Address City State ZIP Code

Signature Date Telephone

Comments

☐ Check here if attachments.

ELEVATION CERTIFICATE

OMB No. 1660-0008
Expiration Date: November 30, 2018

IMPORTANT: In these spaces, copy the corresponding information from Section A.			FOR INSURANCE COMPANY USE
Building Street Address (including Apt., Unit, Suite, and/or Bldg. No.) or P.O. Route and Box No. 12715 West Orange Grove Road			Policy Number:
City Tucson	State Arizona	ZIP Code 85743	Company NAIC Number

SECTION G – COMMUNITY INFORMATION (OPTIONAL)

The local official who is authorized by law or ordinance to administer the community's floodplain management ordinance can complete Sections A, B, C (or E), and G of this Elevation Certificate. Complete the applicable item(s) and sign below. Check the measurement used in Items G8–G10. In Puerto Rico only, enter meters.

- G1. ☐ The information in Section C was taken from other documentation that has been signed and sealed by a licensed surveyor, engineer, or architect who is authorized by law to certify elevation information. (Indicate the source and date of the elevation data in the Comments area below.)
- G2. ☐ A community official completed Section E for a building located in Zone A (without a FEMA-issued or community-issued BFE) or Zone AO.
- G3. ☐ The following information (Items G4–G10) is provided for community floodplain management purposes.

G4. Permit Number	G5. Date Permit Issued	G6. Date Certificate of Compliance/Occupancy Issued
-------------------	------------------------	---

- G7. This permit has been issued for: ☐ New Construction ☐ Substantial Improvement
- G8. Elevation of as-built lowest floor (including basement) of the building: _____ ☐ feet ☐ meters Datum _____
- G9. BFE or (in Zone AO) depth of flooding at the building site: _____ ☐ feet ☐ meters Datum _____
- G10. Community's design flood elevation: _____ ☐ feet ☐ meters Datum _____

Local Official's Name <i>Edward P Eastburn</i>	Title <i>Hydrologist</i>
Community Name <i>Pima County Regional Flood Control District</i>	Telephone <i>(520) 724-4600</i>
Signature <i>Edward P Eastburn</i>	Date <i>10-2-2019</i>

Comments (including type of equipment and location, per C2(e), if applicable)

Surveyor relayed to Edward P Eastburn that the lowest service equipment for the Manufactured home is the bottom of the water heater inside the Manufactured home. Surveyor gave Edward Eastburn permission to update this Elevation Certificate.

☐ Check here if attachments.

ELEVATION CERTIFICATE**BUILDING PHOTOGRAPHS**

Continuation Page

OMB No. 1660-0008

Expiration Date: November 30, 2018

IMPORTANT: In these spaces, copy the corresponding information from Section A.**FOR INSURANCE COMPANY USE**Building Street Address (including Apt., Unit, Suite, and/or Bldg. No.) or P.O. Route and Box No.
12715 West Orange Grove Road

Policy Number:

City
TucsonState
ArizonaZIP Code
85743

Company NAIC Number

If submitting more photographs than will fit on the preceding page, affix the additional photographs below. Identify all photographs with: date taken; "Front View" and "Rear View"; and, if required, "Right Side View" and "Left Side View." When applicable, photographs must show the foundation with representative examples of the flood openings or vents, as indicated in Section A8.

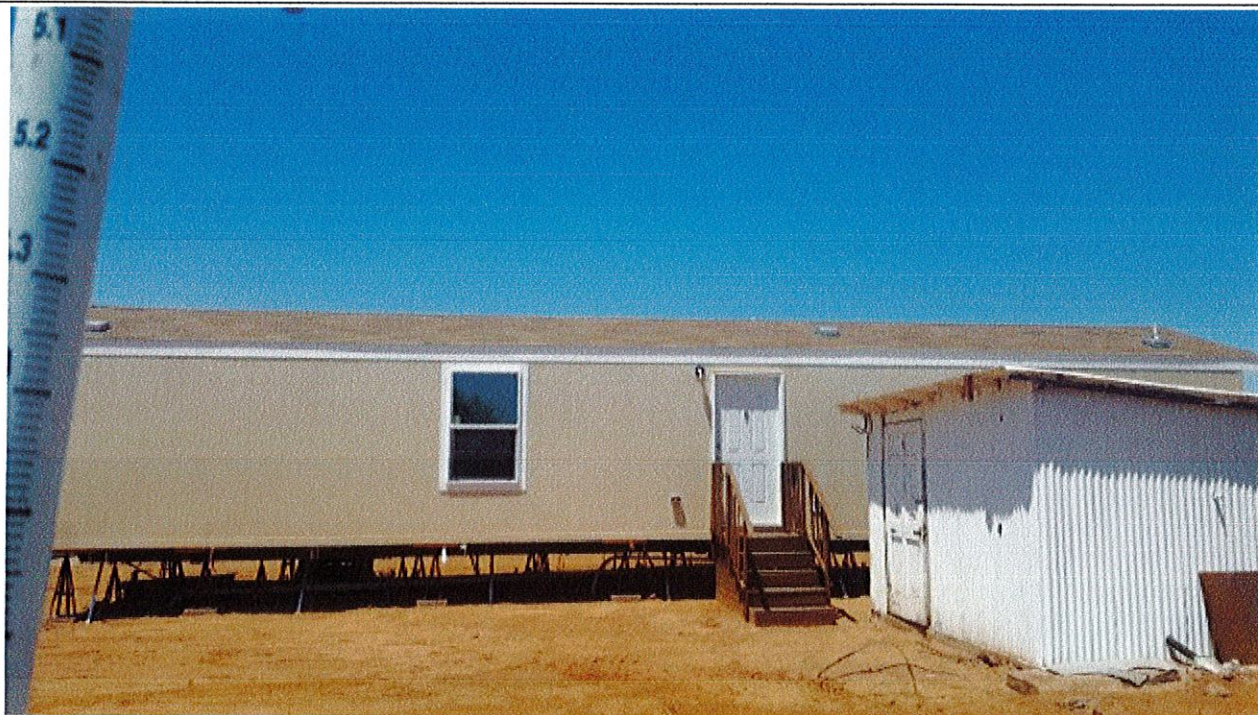

Photo Three

Photo Three Caption South Face

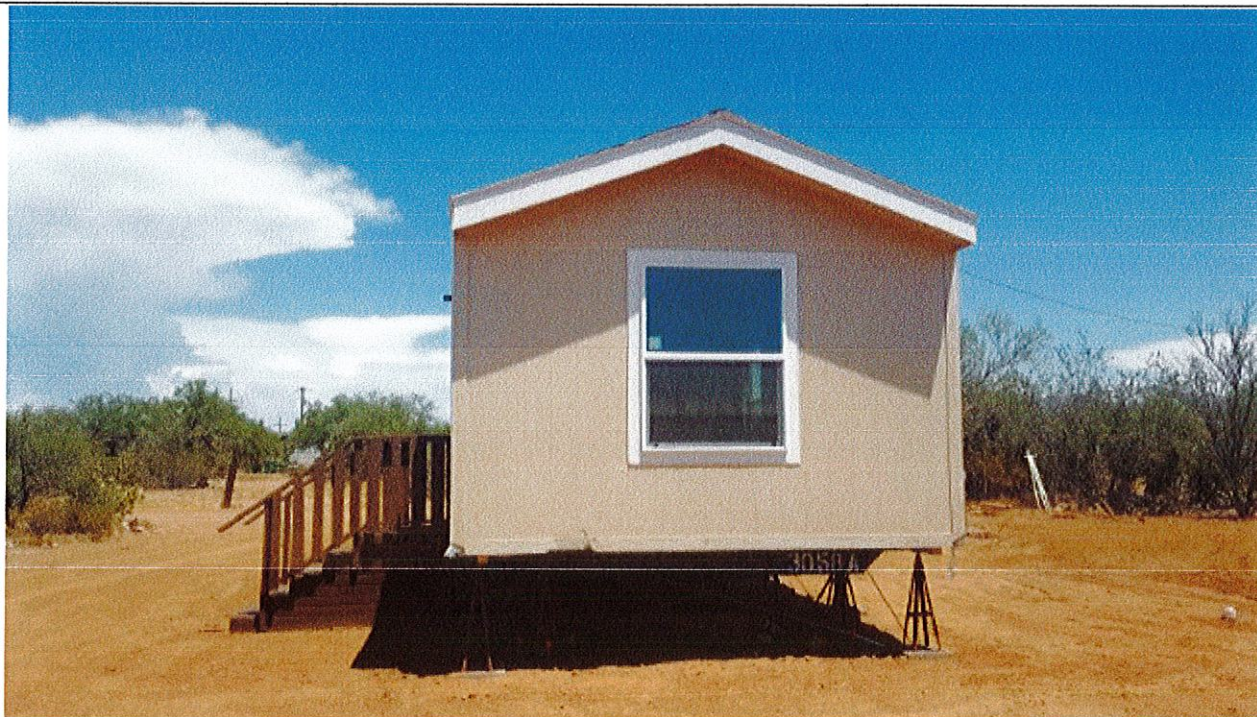

Photo Four

Photo Four Caption West Face

BUILDING PHOTOGRAPHS

See Instructions for Item A6.

OMB No. 1660-0008

Expiration Date: November 30, 2018

ELEVATION CERTIFICATE**IMPORTANT: In these spaces, copy the corresponding information from Section A.****FOR INSURANCE COMPANY USE**Building Street Address (including Apt., Unit, Suite, and/or Bldg. No.) or P.O. Route and Box No.
12715 West Orange Grove Road

Policy Number:

City
TucsonState
ArizonaZIP Code
85743

Company NAIC Number

If using the Elevation Certificate to obtain NFIP flood insurance, affix at least 2 building photographs below according to the instructions for Item A6. Identify all photographs with date taken; "Front View" and "Rear View"; and, if required, "Right Side View" and "Left Side View." When applicable, photographs must show the foundation with representative examples of the flood openings or vents, as indicated in Section A8. If submitting more photographs than will fit on this page, use the Continuation Page.



Photo One

Photo One Caption North Face



Photo Two

Photo Two Caption East Face