

FPUP # P20FC00913

DSD # P20BP08125

# ELEVATION CERTIFICATE

Important: Follow the instructions on pages 1–9.

Copy all pages of this Elevation Certificate and all attachments for (1) community official, (2) insurance agent/company, and (3) building owner.

SECTION A – PROPERTY INFORMATION				FOR INSURANCE COMPANY USE	
A1. Building Owner's Name Mariana & Stuart Sherman				Policy Number:	
A2. Building Street Address (including Apt., Unit, Suite, and/or Bldg. No.) or P.O. Route and Box No. 4590 W Lambert Ln				Company NAIC Number:	
City Tucson		State Arizona		ZIP Code 85742	
A3. Property Description (Lot and Block Numbers, Tax Parcel Number, Legal Description, etc.) Taxcode: 22416009A Township 12S Range 13E Section 7 S2 LOT 4 LYG E & ADJ RD					
A4. Building Use (e.g., Residential, Non-Residential, Addition, Accessory, etc.) Residential: Addition <u>N. CONC SLAB</u>					
A5. Latitude/Longitude: Lat. <u>32.395758</u> Long. <u>-111.062748</u> Horizontal Datum: <input type="checkbox"/> NAD 1927 <input checked="" type="checkbox"/> NAD 1983					
A6. Attach at least 2 photographs of the building if the Certificate is being used to obtain flood insurance. <small>Pima County Regional Flood Control District requires four (4) photographs.</small>					
A7. Building Diagram Number <u>1b</u>					
A8. For a building with a crawlspace or enclosure(s): a) Square footage of crawlspace or enclosure(s) <u>NA</u> sq ft b) Number of permanent flood openings in the crawlspace or enclosure(s) within 1.0 foot above adjacent grade <u>NA</u> c) Total net area of flood openings in A8.b <u>NA</u> sq in d) Engineered flood openings? <input type="checkbox"/> Yes <input checked="" type="checkbox"/> No					
A9. For a building with an attached garage: a) Square footage of attached garage <u>NA</u> sq ft b) Number of permanent flood openings in the attached garage within 1.0 foot above adjacent grade <u>NA</u> c) Total net area of flood openings in A9.b <u>NA</u> sq in d) Engineered flood openings? <input type="checkbox"/> Yes <input checked="" type="checkbox"/> No					
SECTION B – FLOOD INSURANCE RATE MAP (FIRM) INFORMATION					
B1. NFIP Community Name & Community Number Pima County / 040073			B2. County Name Pima County		B3. State Arizona
B4. Map/Panel Number 04019C1065	B5. Suffix L	B6. FIRM Index Date 09/28/2012	B7. FIRM Panel Effective/ Revised Date 06-16-2011	B8. Flood Zone(s) X	B9. Base Flood Elevation(s) (Zone AO, use Base Flood Depth) 100.5
B10. Indicate the source of the Base Flood Elevation (BFE) data or base flood depth entered in Item B9: <input type="checkbox"/> FIS Profile <input type="checkbox"/> FIRM <input checked="" type="checkbox"/> Community Determined <input type="checkbox"/> Other/Source: _____					
B11. Indicate elevation datum used for BFE in Item B9: <input type="checkbox"/> NGVD 1929 <input type="checkbox"/> NAVD 1988 <input checked="" type="checkbox"/> Other/Source: Highest Adjacent Natural Grade (=100.0 ft)					
B12. Is the building located in a Coastal Barrier Resources System (CBRS) area or Otherwise Protected Area (OPA)? <input type="checkbox"/> Yes <input checked="" type="checkbox"/> No Designation Date: _____ <input type="checkbox"/> CBRS <input type="checkbox"/> OPA					



# ELEVATION CERTIFICATE

OMB No. 1660-0008  
Expiration Date: November 30, 2022

<b>IMPORTANT: In these spaces, copy the corresponding information from Section A.</b>			<b>FOR INSURANCE COMPANY USE</b>
Building Street Address (including Apt., Unit, Suite, and/or Bldg. No.) or P.O. Route and Box No. 4590 W Lambert Ln			Policy Number:
City Tucson	State Arizona	ZIP Code 85742	Company NAIC Number

## SECTION C – BUILDING ELEVATION INFORMATION (SURVEY REQUIRED)

C1. Building elevations are based on: ☐ Construction Drawings\* ☐ Building Under Construction\* ☒ Finished Construction

\*A new Elevation Certificate will be required when construction of the building is complete.

C2. Elevations – Zones A1–A30, AE, AH, A (with BFE), VE, V1–V30, V (with BFE), AR, AR/A, AR/AE, AR/A1–A30, AR/AH, AR/AO. Complete Items C2.a–h below according to the building diagram specified in Item A7. In Puerto Rico only, enter meters.

Benchmark Utilized: NA Vertical Datum: NA

Indicate elevation datum used for the elevations in items a) through h) below.

☐ NGVD 1929 ☐ NAVD 1988 ☒ Other/Source: HANG = 100.00

Datum used for building elevations must be the same as that used for the BFE.

Check the measurement used.

- |   |               |  |
|---|---------------|--|
| a) Top of bottom floor (including basement, crawlspace, or enclosure floor)   | <u>103.43</u> | <input checked="" type="checkbox"/> feet <input type="checkbox"/> meters |
| b) Top of the next higher floor   | <u>NA</u>     | <input type="checkbox"/> feet <input type="checkbox"/> meters            |
| c) Bottom of the lowest horizontal structural member (V Zones only)   | <u>NA</u>     | <input type="checkbox"/> feet <input type="checkbox"/> meters            |
| d) Attached garage (top of slab)  | <u>NA</u>     | <input type="checkbox"/> feet <input type="checkbox"/> meters            |
| e) Lowest elevation of machinery or equipment servicing the building<br>(Describe type of equipment and location in Comments) | <u>NA</u>     | <input type="checkbox"/> feet <input type="checkbox"/> meters            |
| f) Lowest adjacent (finished) grade next to building (LAG)  | <u>99.60</u>  | <input checked="" type="checkbox"/> feet <input type="checkbox"/> meters |
| PCRFCD Note: Indicate lowest adjacent natural grade (LANG) in Section D.  |               |  |
| g) Highest adjacent (finished) grade next to building (HAG)   | <u>100.00</u> | <input checked="" type="checkbox"/> feet <input type="checkbox"/> meters |
| PCRFCD Note: Indicate highest adjacent natural grade (HANG) in Section D.   |               |  |
| h) Lowest adjacent grade at lowest elevation of deck or stairs, including structural support                                  | <u>NA</u>     | <input type="checkbox"/> feet <input type="checkbox"/> meters            |

## SECTION D – SURVEYOR, ENGINEER, OR ARCHITECT CERTIFICATION

This certification is to be signed and sealed by a land surveyor, engineer, or architect authorized by law to certify elevation information. I certify that the information on this Certificate represents my best efforts to interpret the data available. I understand that any false statement may be punishable by fine or imprisonment under 18 U.S. Code, Section 1001.

Were latitude and longitude in Section A provided by a licensed land surveyor? ☐ Yes ☒ No ☐ Check here if attachments.

Certifier's Name FRED STURNIOLO License Number RLS 12537

Title Vice President

Company Name PRECISION LAND SURVEYING, INC

Address 8219 E. 22ND STREET

City TUCSON State ARIZ ZIP Code ☒ 85710

Signature Fred Sturniolo Date 6/28/2023 Telephone 520 298 3200 Ext.

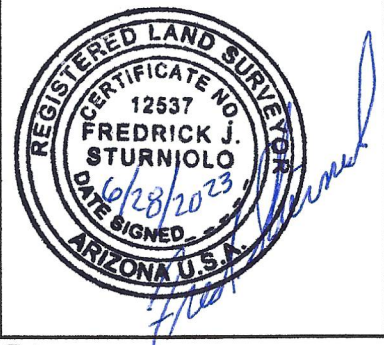

Copy all pages of this Elevation Certificate and all attachments for (1) community official, (2) insurance agent/company, and (3) building owner.

Comments (including type of equipment and location, per C2(e), if applicable)

The lowest service equipment (C2.e) is the NA and the - is/are above this elevation.

Highest adjacent natural grade is 100.00 Lowest adjacent natural grade is 99.60

The elevation of the bottom of the structural frame of the manufactured home is NA

ONLY CONCRETE SLAB EXISTS. NO SERVICE EQUIPMENT



# ELEVATION CERTIFICATE

OMB No. 1660-0008  
Expiration Date: November 30, 2022

<b>IMPORTANT: In these spaces, copy the corresponding information from Section A.</b>			<b>FOR INSURANCE COMPANY USE</b>
Building Street Address (including Apt., Unit, Suite, and/or Bldg. No.) or P.O. Route and Box No. 4590 W Lambert Ln			Policy Number:
City Tucson	State Arizona	ZIP Code 85742	Company NAIC Number

## SECTION E – BUILDING ELEVATION INFORMATION (SURVEY NOT REQUIRED) FOR ZONE AO AND ZONE A (WITHOUT BFE)

For Zones AO and A (without BFE), complete Items E1–E5. If the Certificate is intended to support a LOMA or LOMR-F request, complete Sections A, B, and C. For Items E1–E4, use natural grade, if available. Check the measurement used. In Puerto Rico only, enter meters.

- E1. Provide elevation information for the following and check the appropriate boxes to show whether the elevation is above or below the highest adjacent grade (HAG) and the lowest adjacent grade (LAG).
- a) Top of bottom floor (including basement, crawlspace, or enclosure) is \_\_\_\_\_ ☐ feet ☐ meters ☐ above or ☐ below the HAG.
- b) Top of bottom floor (including basement, crawlspace, or enclosure) is \_\_\_\_\_ ☐ feet ☐ meters ☐ above or ☐ below the LAG.
- E2. For Building Diagrams 6–9 with permanent flood openings provided in Section A Items 8 and/or 9 (see pages 1–2 of Instructions), the next higher floor (elevation C2.b in the diagrams) of the building is \_\_\_\_\_ ☐ feet ☐ meters ☐ above or ☐ below the HAG.
- E3. Attached garage (top of slab) is \_\_\_\_\_ ☐ feet ☐ meters ☐ above or ☐ below the HAG.
- E4. Top of platform of machinery and/or equipment servicing the building is \_\_\_\_\_ ☐ feet ☐ meters ☐ above or ☐ below the HAG.
- E5. Zone AO only: If no flood depth number is available, is the top of the bottom floor elevated in accordance with the community's floodplain management ordinance? ☐ Yes ☐ No ☐ Unknown. The local official must certify this information in Section G.

## SECTION F – PROPERTY OWNER (OR OWNER'S REPRESENTATIVE) CERTIFICATION

The property owner or owner's authorized representative who completes Sections A, B, and E for Zone A (without a FEMA-issued or community-issued BFE) or Zone AO must sign here. The statements in Sections A, B, and E are correct to the best of my knowledge.

Property Owner or Owner's Authorized Representative's Name

Address \_\_\_\_\_ City \_\_\_\_\_ State \_\_\_\_\_ ZIP Code \_\_\_\_\_

Signature \_\_\_\_\_ Date \_\_\_\_\_ Telephone \_\_\_\_\_

Comments

☐ Check here if attachments.

# ELEVATION CERTIFICATE

OMB No. 1660-0008  
Expiration Date: November 30, 2022

<b>IMPORTANT: In these spaces, copy the corresponding information from Section A.</b>			<b>FOR INSURANCE COMPANY USE</b>
Building Street Address (including Apt., Unit, Suite, and/or Bldg. No.) or P.O. Route and Box No. 4590 W Lambert Ln			Policy Number:
City Tucson	State Arizona	ZIP Code 85742	Company NAIC Number

## SECTION G – COMMUNITY INFORMATION (OPTIONAL)

The local official who is authorized by law or ordinance to administer the community's floodplain management ordinance can complete Sections A, B, C (or E), and G of this Elevation Certificate. Complete the applicable item(s) and sign below. Check the measurement used in Items G8–G10. In Puerto Rico only, enter meters.

- G1. ☐ The information in Section C was taken from other documentation that has been signed and sealed by a licensed surveyor, engineer, or architect who is authorized by law to certify elevation information. (Indicate the source and date of the elevation data in the Comments area below.)
- G2. ☐ A community official completed Section E for a building located in Zone A (without a FEMA-issued or community-issued BFE) or Zone AO.
- G3. ☐ The following information (Items G4–G10) is provided for community floodplain management purposes.

G4. Permit Number	G5. Date Permit Issued	G6. Date Certificate of Compliance/Occupancy Issued
G7. This permit has been issued for: <input type="checkbox"/> New Construction <input type="checkbox"/> Substantial Improvement		
G8. Elevation of as-built lowest floor (including basement) of the building: _____ <input type="checkbox"/> feet <input type="checkbox"/> meters Datum _____		
G9. BFE or (in Zone AO) depth of flooding at the building site: _____ <input type="checkbox"/> feet <input type="checkbox"/> meters Datum _____		
G10. Community's design flood elevation: _____ <input type="checkbox"/> feet <input type="checkbox"/> meters Datum _____		
Local Official's Name		Title
Community Name		Telephone
Signature		Date

Comments (including type of equipment and location, per C2(e), if applicable)

☐ Check here if attachments.



# ELEVATION CERTIFICATE

## BUILDING PHOTOGRAPHS

See Instructions for Item A6.

OMB No. 1660-0008

Expiration Date: November 30, 2022

**IMPORTANT: In these spaces, copy the corresponding information from Section A.**

**FOR INSURANCE COMPANY USE**

Building Street Address (including Apt., Unit, Suite, and/or Bldg. No.) or P.O. Route and Box No.  
4590 W Lambert Ln

Policy Number:

City  
Tucson

State  
Arizona

ZIP Code  
85742

Company NAIC Number

If using the Elevation Certificate to obtain NFIP flood insurance, affix at least 2 building photographs below according to the instructions for Item A6. Identify all photographs with date taken; "Front View" and "Rear View"; and, if required, "Right Side View" and "Left Side View." When applicable, photographs must show the foundation with representative examples of the flood openings or vents, as indicated in Section A8. If submitting more photographs than will fit on this page, use the Continuation Page.



NORTH  
↑  
FRONT

PHOTOS  
TAKEN ON  
6/21/2023

Photo One Caption

Clear Photo One



South  
↓  
REAR

Photo Two

Photo Two Caption

Clear Photo Two



# ELEVATION CERTIFICATE

## BUILDING PHOTOGRAPHS

Continuation Page

OMB No. 1660-0008

Expiration Date: November 30, 2022

**IMPORTANT: In these spaces, copy the corresponding information from Section A.**

**FOR INSURANCE COMPANY USE**

Building Street Address (including Apt., Unit, Suite, and/or Bldg. No.) or P.O. Route and Box No.  
4590 W Lambert Ln

Policy Number:

City  
Tucson

State  
Arizona

ZIP Code  
85742

Company NAIC Number

If submitting more photographs than will fit on the preceding page, affix the additional photographs below. Identify all photographs with: date taken; "Front View" and "Rear View"; and, if required, "Right Side View" and "Left Side View." When applicable, photographs must show the foundation with representative examples of the flood openings or vents, as indicated in Section A8.



EAST  
1/2  
LEFT

PHOTOS  
TAKEN ON  
6/21/2023

Photo Three Caption

Clear Photo Three



WEST  
1/2  
RIGHT

Photo Four

Photo Four Caption

Clear Photo Four