

FPUP # P21FC00064

DSD # P21BP04691

ELEVATION CERTIFICATE

Important: Follow the instructions on pages 1–9.

Copy all pages of this Elevation Certificate and all attachments for (1) community official, (2) insurance agent/company, and (3) building owner.

SECTION A – PROPERTY INFORMATION				FOR INSURANCE COMPANY USE	
A1. Building Owner's Name DR Horton				Policy Number:	
A2. Building Street Address (including Apt., Unit, Suite, and/or Bldg. No.) or P.O. Route and Box No. 17021 W Weatherby Rd				Company NAIC Number:	
City Marana		State Arizona		ZIP Code 85653	
A3. Property Description (Lot and Block Numbers, Tax Parcel Number, Legal Description, etc.) Taxcode: 208172090 Township 11S Range 10E Section 28 Hunter No 2 Lot #202					
A4. Building Use (e.g., Residential, Non-Residential, Addition, Accessory, etc.) Residential: Single Family Residence					
A5. Latitude/Longitude: Lat. 32.43915° Long. -111.33100° Horizontal Datum: <input type="checkbox"/> NAD 1927 <input checked="" type="checkbox"/> NAD 1983					
A6. Attach at least 2 photographs of the building if the Certificate is being used to obtain flood insurance. <small>Pima County Regional Flood Control District requires four (4) photographs.</small>					
A7. Building Diagram Number 1B					
A8. For a building with a crawlspace or enclosure(s):					
a) Square footage of crawlspace or enclosure(s) N/A sq ft					
b) Number of permanent flood openings in the crawlspace or enclosure(s) within 1.0 foot above adjacent grade N/A					
c) Total net area of flood openings in A8.b N/A sq in					
d) Engineered flood openings? <input type="checkbox"/> Yes <input checked="" type="checkbox"/> No					
A9. For a building with an attached garage:					
a) Square footage of attached garage 458.00 sq ft					
b) Number of permanent flood openings in the attached garage within 1.0 foot above adjacent grade N/A					
c) Total net area of flood openings in A9.b N/A sq in					
d) Engineered flood openings? <input type="checkbox"/> Yes <input checked="" type="checkbox"/> No					
SECTION B – FLOOD INSURANCE RATE MAP (FIRM) INFORMATION					
B1. NFIP Community Name & Community Number Pima County / 040073			B2. County Name Pima County		B3. State Arizona
B4. Map/Panel Number 04019C1005	B5. Suffix L	B6. FIRM Index Date 09/28/2012	B7. FIRM Panel Effective/ Revised Date 06-16-2011	B8. Flood Zone(s) AE	B9. Base Flood Elevation(s) (Zone AO, use Base Flood Depth) 1930.2
B10. Indicate the source of the Base Flood Elevation (BFE) data or base flood depth entered in Item B9: <input type="checkbox"/> FIS Profile <input checked="" type="checkbox"/> FIRM <input type="checkbox"/> Community Determined <input type="checkbox"/> Other/Source: _____					
B11. Indicate elevation datum used for BFE in Item B9: <input type="checkbox"/> NGVD 1929 <input checked="" type="checkbox"/> NAVD 1988 <input type="checkbox"/> Other/Source: Highest Adjacent Natural Grade (=100.0 ft)					
B12. Is the building located in a Coastal Barrier Resources System (CBRS) area or Otherwise Protected Area (OPA)? <input type="checkbox"/> Yes <input checked="" type="checkbox"/> No Designation Date: _____ <input type="checkbox"/> CBRS <input type="checkbox"/> OPA					

ELEVATION CERTIFICATE

OMB No. 1660-0008
Expiration Date: November 30, 2022

IMPORTANT: In these spaces, copy the corresponding information from Section A.			FOR INSURANCE COMPANY USE
Building Street Address (including Apt., Unit, Suite, and/or Bldg. No.) or P.O. Route and Box No. 17021 W Weatherby Rd			Policy Number:
City Marana	State Arizona	ZIP Code 85653	Company NAIC Number

SECTION C – BUILDING ELEVATION INFORMATION (SURVEY REQUIRED)

C1. Building elevations are based on: ☐ Construction Drawings* ☐ Building Under Construction* ☒ Finished Construction

*A new Elevation Certificate will be required when construction of the building is complete.

C2. Elevations – Zones A1–A30, AE, AH, A (with BFE), VE, V1–V30, V (with BFE), AR, AR/A, AR/AE, AR/A1–A30, AR/AH, AR/AO. Complete Items C2.a–h below according to the building diagram specified in Item A7. In Puerto Rico only, enter meters.

Benchmark Utilized: BOE P19SC00036 Vertical Datum: NAVD88

Indicate elevation datum used for the elevations in items a) through h) below.

☐ NGVD 1929 ☒ NAVD 1988 ☐ Other/Source: _____

Datum used for building elevations must be the same as that used for the BFE.

Check the measurement used.

- | | | | |
|---|----------------|--|---------------------------------|
| a) Top of bottom floor (including basement, crawlspace, or enclosure floor) | <u>1932.09</u> | <input checked="" type="checkbox"/> feet | <input type="checkbox"/> meters |
| b) Top of the next higher floor | <u>N/A</u> | <input type="checkbox"/> feet | <input type="checkbox"/> meters |
| c) Bottom of the lowest horizontal structural member (V Zones only) | <u>N/A</u> | <input type="checkbox"/> feet | <input type="checkbox"/> meters |
| d) Attached garage (top of slab) | <u>1931.85</u> | <input checked="" type="checkbox"/> feet | <input type="checkbox"/> meters |
| e) Lowest elevation of machinery or equipment servicing the building
(Describe type of equipment and location in Comments) | <u>1931.50</u> | <input checked="" type="checkbox"/> feet | <input type="checkbox"/> meters |
| f) Lowest adjacent (finished) grade next to building (LAG) | <u>1931.13</u> | <input checked="" type="checkbox"/> feet | <input type="checkbox"/> meters |
| g) Highest adjacent (finished) grade next to building (HAG) | <u>1931.31</u> | <input checked="" type="checkbox"/> feet | <input type="checkbox"/> meters |
| h) Lowest adjacent grade at lowest elevation of deck or stairs, including structural support | <u>N/A</u> | <input type="checkbox"/> feet | <input type="checkbox"/> meters |

PCRFGD Note: Indicate lowest adjacent natural grade (LANG) in Section D.

PCRFGD Note: Indicate highest adjacent natural grade (HANG) in Section D.

SECTION D – SURVEYOR, ENGINEER, OR ARCHITECT CERTIFICATION

This certification is to be signed and sealed by a land surveyor, engineer, or architect authorized by law to certify elevation information. I certify that the information on this Certificate represents my best efforts to interpret the data available. I understand that any false statement may be punishable by fine or imprisonment under 18 U.S. Code, Section 1001.

Were latitude and longitude in Section A provided by a licensed land surveyor? ☐ Yes ☒ No ☐ Check here if attachments.

Certifier's Name
Patrick McGarrity

License Number
AZ 49459

Title
Sr. Project Surveyor

Company Name
EPS Group, Inc.

Address
8710 N. Thornydale Road, Ste. 140

City
Tucson

State
Arizona

ZIP Code
85742

Signature
Patrick McGarrity

Date
10-28-2022

Telephone
(520) 408-1400

Ext.

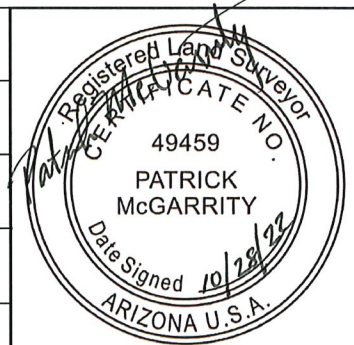

Copy all pages of this Elevation Certificate and all attachments for (1) community official, (2) insurance agent/company, and (3) building owner.

Comments (including type of equipment and location, per C2(e), if applicable)

Highest adjacent natural grade is 1929.99 feet. Lowest adjacent natural grade is 1928.80 feet..

The C2(e) equipment is the AC unit on the West side of the House.

ELEVATION CERTIFICATE

OMB No. 1660-0008
Expiration Date: November 30, 2022

IMPORTANT: In these spaces, copy the corresponding information from Section A.			FOR INSURANCE COMPANY USE	
Building Street Address (including Apt., Unit, Suite, and/or Bldg. No.) or P.O. Route and Box No. 17021 W Weatherby Rd			Policy Number:	
City Marana	State Arizona	ZIP Code 85653	Company NAIC Number	
SECTION E – BUILDING ELEVATION INFORMATION (SURVEY NOT REQUIRED) FOR ZONE AO AND ZONE A (WITHOUT BFE)				
For Zones AO and A (without BFE), complete Items E1–E5. If the Certificate is intended to support a LOMA or LOMR-F request, complete Sections A, B, and C. For Items E1–E4, use natural grade, if available. Check the measurement used. In Puerto Rico only, enter meters.				
E1. Provide elevation information for the following and check the appropriate boxes to show whether the elevation is above or below the highest adjacent grade (HAG) and the lowest adjacent grade (LAG).				
a) Top of bottom floor (including basement, crawlspace, or enclosure) is		_____	<input type="checkbox"/> feet <input type="checkbox"/> meters	<input type="checkbox"/> above or <input type="checkbox"/> below the HAG.
b) Top of bottom floor (including basement, crawlspace, or enclosure) is		_____	<input type="checkbox"/> feet <input type="checkbox"/> meters	<input type="checkbox"/> above or <input type="checkbox"/> below the LAG.
E2. For Building Diagrams 6–9 with permanent flood openings provided in Section A Items 8 and/or 9 (see pages 1–2 of Instructions), the next higher floor (elevation C2.b in the diagrams) of the building is				
_____		<input type="checkbox"/> feet <input type="checkbox"/> meters	<input type="checkbox"/> above or <input type="checkbox"/> below the HAG.	
E3. Attached garage (top of slab) is				
_____		<input type="checkbox"/> feet <input type="checkbox"/> meters	<input type="checkbox"/> above or <input type="checkbox"/> below the HAG.	
E4. Top of platform of machinery and/or equipment servicing the building is				
_____		<input type="checkbox"/> feet <input type="checkbox"/> meters	<input type="checkbox"/> above or <input type="checkbox"/> below the HAG.	
E5. Zone AO only: If no flood depth number is available, is the top of the bottom floor elevated in accordance with the community's floodplain management ordinance? <input type="checkbox"/> Yes <input type="checkbox"/> No <input type="checkbox"/> Unknown. The local official must certify this information in Section G.				
SECTION F – PROPERTY OWNER (OR OWNER'S REPRESENTATIVE) CERTIFICATION				
The property owner or owner's authorized representative who completes Sections A, B, and E for Zone A (without a FEMA-issued or community-issued BFE) or Zone AO must sign here. The statements in Sections A, B, and E are correct to the best of my knowledge.				
Property Owner or Owner's Authorized Representative's Name				
Address		City	State	ZIP Code
Signature		Date	Telephone	
Comments				
<input type="checkbox"/> Check here if attachments.				

ELEVATION CERTIFICATE

OMB No. 1660-0008
Expiration Date: November 30, 2022

IMPORTANT: In these spaces, copy the corresponding information from Section A.			FOR INSURANCE COMPANY USE
Building Street Address (including Apt., Unit, Suite, and/or Bldg. No.) or P.O. Route and Box No. 17021 W Weatherby Rd			Policy Number:
City Marana	State Arizona	ZIP Code 85653	Company NAIC Number

SECTION G – COMMUNITY INFORMATION (OPTIONAL)

The local official who is authorized by law or ordinance to administer the community's floodplain management ordinance can complete Sections A, B, C (or E), and G of this Elevation Certificate. Complete the applicable item(s) and sign below. Check the measurement used in Items G8–G10. In Puerto Rico only, enter meters.

- G1. ☐ The information in Section C was taken from other documentation that has been signed and sealed by a licensed surveyor, engineer, or architect who is authorized by law to certify elevation information. (Indicate the source and date of the elevation data in the Comments area below.)
- G2. ☐ A community official completed Section E for a building located in Zone A (without a FEMA-issued or community-issued BFE) or Zone AO.
- G3. ☐ The following information (Items G4–G10) is provided for community floodplain management purposes.

G4. Permit Number	G5. Date Permit Issued	G6. Date Certificate of Compliance/Occupancy Issued
-------------------	------------------------	---

- G7. This permit has been issued for: ☐ New Construction ☐ Substantial Improvement
- G8. Elevation of as-built lowest floor (including basement) of the building: _____ ☐ feet ☐ meters Datum _____
- G9. BFE or (in Zone AO) depth of flooding at the building site: _____ ☐ feet ☐ meters Datum _____
- G10. Community's design flood elevation: _____ ☐ feet ☐ meters Datum _____

Local Official's Name	Title
-----------------------	-------

Community Name	Telephone
----------------	-----------

Signature	Date
-----------	------

Comments (including type of equipment and location, per C2(e), if applicable)

☐ Check here if attachments.

BUILDING PHOTOGRAPHS**ELEVATION CERTIFICATE**

See Instructions for Item A6.

OMB No. 1660-0008

Expiration Date: November 30, 2022

IMPORTANT: In these spaces, copy the corresponding information from Section A.**FOR INSURANCE COMPANY USE**Building Street Address (including Apt., Unit, Suite, and/or Bldg. No.) or P.O. Route and Box No.
17021 W Weatherby Rd

Policy Number:

City
MaranaState
ArizonaZIP Code
85653

Company NAIC Number

If using the Elevation Certificate to obtain NFIP flood insurance, affix at least 2 building photographs below according to the instructions for Item A6. Identify all photographs with date taken; "Front View" and "Rear View"; and, if required, "Right Side View" and "Left Side View." When applicable, photographs must show the foundation with representative examples of the flood openings or vents, as indicated in Section A8. If submitting more photographs than will fit on this page, use the Continuation Page.



Photo One

Photo One Caption Completed Construction from NW, 10/28/2022

Clear Photo One



Photo Two

Photo Two Caption Completed Construction from NE, 10/28/2022

Clear Photo Two

BUILDING PHOTOGRAPHS

ELEVATION CERTIFICATE

Continuation Page

OMB No. 1660-0008

Expiration Date: November 30, 2022

IMPORTANT: In these spaces, copy the corresponding information from Section A.			FOR INSURANCE COMPANY USE
Building Street Address (including Apt., Unit, Suite, and/or Bldg. No.) or P.O. Route and Box No. 17021 W Weatherby Rd			Policy Number:
City Marana	State Arizona	ZIP Code 85653	Company NAIC Number

If submitting more photographs than will fit on the preceding page, affix the additional photographs below. Identify all photographs with: date taken; "Front View" and "Rear View"; and, if required, "Right Side View" and "Left Side View." When applicable, photographs must show the foundation with representative examples of the flood openings or vents, as indicated in Section A8.



Photo Three

Photo Three Caption Completed Construction from SW, 10/28/2022

Clear Photo Three



Photo Four

Photo Four Caption Completed Construction from SE, 10/28/2022

Clear Photo Four