

U.S. DEPARTMENT OF HOMELAND SECURITY  
 Federal Emergency Management Agency  
 National Flood Insurance Program

OMB No. 1660-0008  
 Expiration Date: November 30, 2022

FPUP # P22FC01174  
 DSD # P22BP12662

# ELEVATION CERTIFICATE

Important: Follow the instructions on pages 1-9.

HR  
 4/21/23

Copy all pages of this Elevation Certificate and all attachments for (1) community official, (2) insurance agent/company, and (3) building owner.

SECTION A - PROPERTY INFORMATION	FOR INSURANCE COMPANY USE
A1. Building Owner's Name DIANA SPRINGER	Policy Number:
A2. Building Street Address (including Apt., Unit, Suite, and/or Bldg. No.) or P.O. Route and Box No. 11851 W PAJARO VERDE	Company NAIC Number:
City TUCSON	State Arizona
	ZIP Code 85743
A3. Property Description (Lot and Block Numbers, Tax Parcel Number, Legal Description, etc.) Taxcode: 211-18-1470    Township 14S    Range 11E    Section 09    Ranchita Avra Resubdivision Lot 60	
A4. Building Use (e.g., Residential, Non-Residential, Addition, Accessory, etc.)    Residential: <u>Manufactured Home</u>	
A5. Latitude/Longitude: Lat. <u>32.232148</u> Long. <u>-111.220026</u> Horizontal Datum: <input type="checkbox"/> NAD 1927 <input checked="" type="checkbox"/> NAD 1983	
A6. Attach at least 2 photographs of the building if the Certificate is being used to obtain flood insurance. <small>Pima County Regional Flood Control District requires four (4) photographs.</small>	
A7. Building Diagram Number <u>6</u>	
A8. For a building with a crawlspace or enclosure(s):	
a) Square footage of crawlspace or enclosure(s) <u>998.00</u> sq ft	
b) Number of permanent flood openings in the crawlspace or enclosure(s) within 1.0 foot above adjacent grade <u>14</u>	
c) Total net area of flood openings in A8.b <u>1956.00</u> sq in	
d) Engineered flood openings? <input type="checkbox"/> Yes <input checked="" type="checkbox"/> No	
A9. For a building with an attached garage:	
a) Square footage of attached garage <u>N/A</u> sq ft	
b) Number of permanent flood openings in the attached garage within 1.0 foot above adjacent grade <u>N/A</u>	
c) Total net area of flood openings in A9.b <u>N/A</u> sq in	
d) Engineered flood openings? <input type="checkbox"/> Yes <input checked="" type="checkbox"/> No	

## SECTION B - FLOOD INSURANCE RATE MAP (FIRM) INFORMATION

B1. NFIP Community Name & Community Number <u>Pima County / 040073</u>		B2. County Name <u>Pima County</u>		B3. State <u>Arizona</u>	
B4. Map/Panel Number <u>04019C2250</u>	B5. Suffix <u>L</u>	B6. FIRM Index Date <u>09/28/2012</u>	B7. FIRM Panel Effective/ Revised Date <u>06-16-2011</u>	B8. Flood Zone(s) <u>X</u>	B9. Base Flood Elevation(s) (Zone AO, use Base Flood Depth) <u>100.5 ft</u>
B10. Indicate the source of the Base Flood Elevation (BFE) data or base flood depth entered in Item B9: <input type="checkbox"/> FIS Profile <input type="checkbox"/> FIRM <input checked="" type="checkbox"/> Community Determined <input type="checkbox"/> Other/Source: _____					
B11. Indicate elevation datum used for BFE in Item B9: <input type="checkbox"/> NGVD 1929 <input type="checkbox"/> NAVD 1988 <input checked="" type="checkbox"/> Other/Source: <u>Highest Adjacent Natural Grade (=100.0)</u>					
B12. Is the building located in a Coastal Barrier Resources System (CBRS) area or Otherwise Protected Area (OPA)? <input type="checkbox"/> Yes <input checked="" type="checkbox"/> No Designation Date: <u>N/A</u> <input type="checkbox"/> CBRS <input type="checkbox"/> OPA					

# ELEVATION CERTIFICATE

OMB No. 1660-0008  
Expiration Date: November 30, 2022

<b>IMPORTANT: In these spaces, copy the corresponding information from Section A.</b>			<b>FOR INSURANCE COMPANY USE</b>
Building Street Address (including Apt., Unit, Suite, and/or Bldg. No.) or P.O. Route and Box No. 11851 W PAJARO VERDE			Policy Number:
City TUCSON	State Arizona	ZIP Code 85743	Company NAIC Number

## SECTION C – BUILDING ELEVATION INFORMATION (SURVEY REQUIRED)

C1. Building elevations are based on:  Construction Drawings\*  Building Under Construction\*  Finished Construction  
\*A new Elevation Certificate will be required when construction of the building is complete.

C2. Elevations – Zones A1–A30, AE, AH, A (with BFE), VE, V1–V30, V (with BFE), AR, AR/A, AR/AE, AR/A1–A30, AR/AH, AR/AO. Complete Items C2.a–h below according to the building diagram specified in Item A7. In Puerto Rico only, enter meters.

Benchmark Utilized: N/A Vertical Datum: N/A

Indicate elevation datum used for the elevations in items a) through h) below.

NGVD 1929  NAVD 1988  Other/Source: HANG=100.00'

Datum used for building elevations must be the same as that used for the BFE.

Check the measurement used.

- |                                                                                                                               |               |                                          |                                 |
|-------------------------------------------------------------------------------------------------------------------------------|---------------|------------------------------------------|---------------------------------|
| a) Top of bottom floor (including basement, crawlspace, or enclosure floor)                                                   | <u>100.00</u> | <input checked="" type="checkbox"/> feet | <input type="checkbox"/> meters |
| b) Top of the next higher floor                                                                                               | <u>103.16</u> | <input checked="" type="checkbox"/> feet | <input type="checkbox"/> meters |
| c) Bottom of the lowest horizontal structural member (V Zones only)                                                           | <u>N/A</u>    | <input checked="" type="checkbox"/> feet | <input type="checkbox"/> meters |
| d) Attached garage (top of slab)                                                                                              | <u>N/A</u>    | <input checked="" type="checkbox"/> feet | <input type="checkbox"/> meters |
| e) Lowest elevation of machinery or equipment servicing the building<br>(Describe type of equipment and location in Comments) | <u>101.83</u> | <input checked="" type="checkbox"/> feet | <input type="checkbox"/> meters |
| f) Lowest adjacent (finished) grade next to building (LAG)                                                                    | <u>98.94</u>  | <input checked="" type="checkbox"/> feet | <input type="checkbox"/> meters |
| PCRFCD Note: Indicate lowest adjacent natural grade (LANG) in Section D.                                                      |               |                                          |                                 |
| g) Highest adjacent (finished) grade next to building (HAG)                                                                   | <u>100.00</u> | <input checked="" type="checkbox"/> feet | <input type="checkbox"/> meters |
| PCRFCD Note: Indicate highest adjacent natural grade (HANG) in Section D.                                                     |               |                                          |                                 |
| h) Lowest adjacent grade at lowest elevation of deck or stairs, including structural support                                  | <u>N/A</u>    | <input checked="" type="checkbox"/> feet | <input type="checkbox"/> meters |

## SECTION D – SURVEYOR, ENGINEER, OR ARCHITECT CERTIFICATION

This certification is to be signed and sealed by a land surveyor, engineer, or architect authorized by law to certify elevation information. I certify that the information on this Certificate represents my best efforts to interpret the data available. I understand that any false statement may be punishable by fine or imprisonment under 18 U.S. Code, Section 1001.

Were latitude and longitude in Section A provided by a licensed land surveyor?  Yes  No  Check here if attachments.

Certifier's Name Taylor Webb	License Number RLS 52699	
Title Land Surveyor		
Company Name On Point Surveying, PLLC		
Address 6200 N Shannon Road		
City Tucson	State Arizona	

Signature 	Date 04-21-2023	Telephone (520) 490-2467	Ext.
--------------------------------------------------------------------------------------------------	--------------------	-----------------------------	------

Copy all pages of this Elevation Certificate and all attachments for (1) community official, (2) insurance agent/company, and (3) building owner.

Comments (including type of equipment and location, per C2(e), if applicable)  
The lowest service equipment (C2.e) is the A/C unit and all other equipment is above this elevation.  
Highest adjacent natural grade is 100.00'. Lowest adjacent natural grade is 98.94'.  
The elevation of the bottom of the structural frame of the manufactured home is 101.61'.

**ELEVATION CERTIFICATE**

OMB No. 1660-0008  
 Expiration Date: November 30, 2022

<b>IMPORTANT: In these spaces, copy the corresponding information from Section A.</b>			<b>FOR INSURANCE COMPANY USE</b>
Building Street Address (including Apt., Unit, Suite, and/or Bldg. No.) or P.O. Route and Box No. 11851 W PAJARO VERDE			Policy Number:
City TUCSON	State Arizona	ZIP Code 85743	Company NAIC Number

**SECTION E – BUILDING ELEVATION INFORMATION (SURVEY NOT REQUIRED)  
 FOR ZONE AO AND ZONE A (WITHOUT BFE)**

For Zones AO and A (without BFE), complete Items E1–E5. If the Certificate is intended to support a LOMA or LOMR-F request, complete Sections A, B, and C. For Items E1–E4, use natural grade, if available. Check the measurement used. In Puerto Rico only, enter meters.

- E1. Provide elevation information for the following and check the appropriate boxes to show whether the elevation is above or below the highest adjacent grade (HAG) and the lowest adjacent grade (LAG).
- a) Top of bottom floor (including basement, crawlspace, or enclosure) is \_\_\_\_\_  feet  meters  above or  below the HAG.
  - b) Top of bottom floor (including basement, crawlspace, or enclosure) is \_\_\_\_\_  feet  meters  above or  below the LAG.
- E2. For Building Diagrams 6–9 with permanent flood openings provided in Section A Items 8 and/or 9 (see pages 1–2 of Instructions), the next higher floor (elevation C2.b in the diagrams) of the building is \_\_\_\_\_  feet  meters  above or  below the HAG.
- E3. Attached garage (top of slab) is \_\_\_\_\_  feet  meters  above or  below the HAG.
- E4. Top of platform of machinery and/or equipment servicing the building is \_\_\_\_\_  feet  meters  above or  below the HAG.
- E5. Zone AO only: If no flood depth number is available, is the top of the bottom floor elevated in accordance with the community's floodplain management ordinance?  Yes  No  Unknown. The local official must certify this information in Section G.

**SECTION F – PROPERTY OWNER (OR OWNER'S REPRESENTATIVE) CERTIFICATION**

The property owner or owner's authorized representative who completes Sections A, B, and E for Zone A (without a FEMA-issued or community-issued BFE) or Zone AO must sign here. The statements in Sections A, B, and E are correct to the best of my knowledge.

Property Owner or Owner's Authorized Representative's Name

Address \_\_\_\_\_ City \_\_\_\_\_ State \_\_\_\_\_ ZIP Code \_\_\_\_\_

Signature \_\_\_\_\_ Date \_\_\_\_\_ Telephone \_\_\_\_\_

Comments

Check here if attachments.



# BUILDING PHOTOGRAPHS

## ELEVATION CERTIFICATE

See Instructions for Item A6.

OMB No. 1660-0008  
Expiration Date: November 30, 2022

<b>IMPORTANT: In these spaces, copy the corresponding information from Section A.</b>			<b>FOR INSURANCE COMPANY USE</b>
Building Street Address (including Apt., Unit, Suite, and/or Bldg. No.) or P.O. Route and Box No. 11851 W PAJARO VERDE			Policy Number:
City TUCSON	State Arizona	ZIP Code 85743	Company NAIC Number

If using the Elevation Certificate to obtain NFIP flood insurance, affix at least 2 building photographs below according to the instructions for Item A6. Identify all photographs with date taken; "Front View" and "Rear View"; and, if required, "Right Side View" and "Left Side View." When applicable, photographs must show the foundation with representative examples of the flood openings or vents, as indicated in Section A8. If submitting more photographs than will fit on this page, use the Continuation Page.



Photo One

Photo One Caption

Clear Photo One

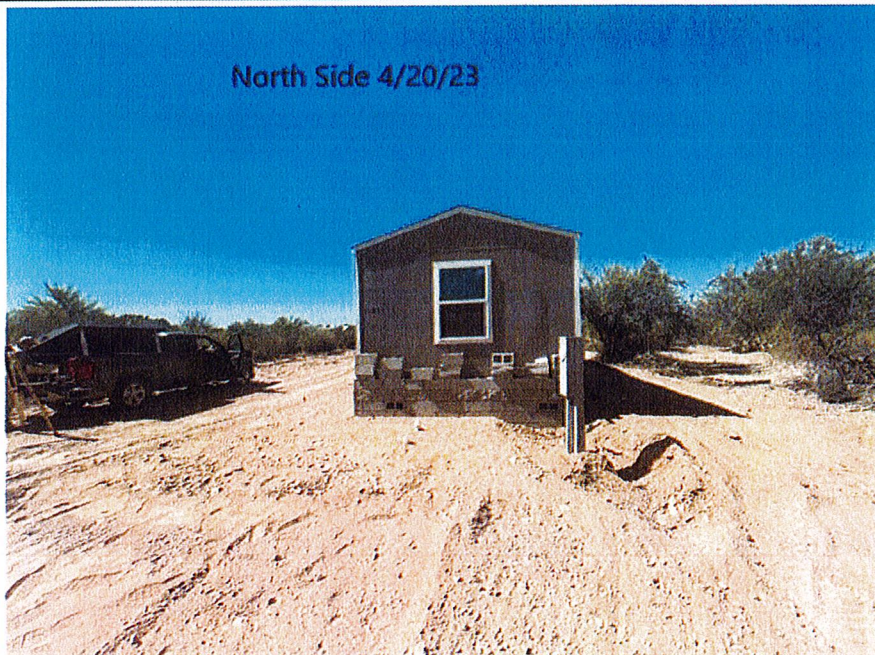

Photo Two

Photo Two Caption

Clear Photo Two

**ELEVATION CERTIFICATE**

**BUILDING PHOTOGRAPHS**

Continuation Page

OMB No. 1660-0008  
Expiration Date: November 30, 2022

<b>IMPORTANT: In these spaces, copy the corresponding information from Section A.</b>			<b>FOR INSURANCE COMPANY USE</b>
Building Street Address (including Apt., Unit, Suite, and/or Bldg. No.) or P.O. Route and Box No. 11851 W PAJARO VERDE			Policy Number:
City TUCSON	State Arizona	ZIP Code 85743	Company NAIC Number

If submitting more photographs than will fit on the preceding page, affix the additional photographs below. Identify all photographs with: date taken; "Front View" and "Rear View"; and, if required, "Right Side View" and "Left Side View." When applicable, photographs must show the foundation with representative examples of the flood openings or vents, as indicated in Section A8.



South Side 4/20/23

Photo Three

Photo Three Caption

Clear Photo Three

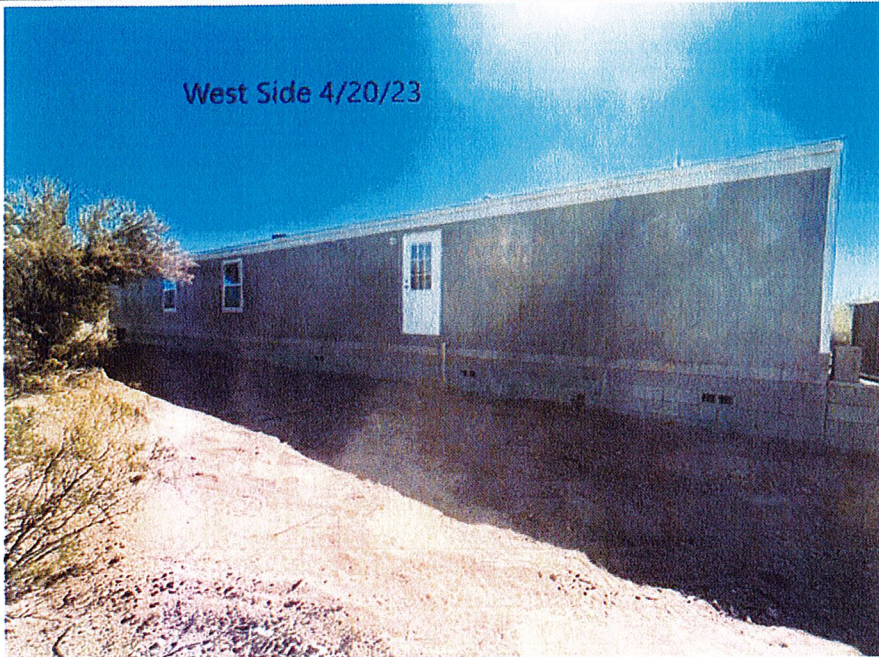

West Side 4/20/23

Photo Four

Photo Four Caption

Clear Photo Four