

FPUP # P22FC00243

DSD # P22BP01929

ELEVATION CERTIFICATE

Important: Follow the instructions on pages 1-9.

FEB 9 '23 AM 9:17

Copy all pages of this Elevation Certificate and all attachments for (1) community official, (2) insurance agent/company, and (3) building owner.

SECTION A - PROPERTY INFORMATION				FOR INSURANCE COMPANY USE	
A1. Building Owner's Name Epidaurus, a California non-profit public benefit corporation				Policy Number:	
A2. Building Street Address (including Apt., Unit, Suite, and/or Bldg. No.) or P.O. Route and Box No. 10500 E. Tanque Verde Road, Building # 3				Company NAIC Number:	
City Tucson		State Arizona		ZIP Code 85749	
A3. Property Description (Lot and Block Numbers, Tax Parcel Number, Legal Description, etc.) Assessor Parcel Number 133-01-025B, Township 14 South, Range 15 East, Section 01					
A4. Building Use (e.g., Residential, Non-Residential, Addition, Accessory, etc.) Addition: Laundry					
A5. Latitude/Longitude: Lat. 32.248841 Long. -110.765864 Horizontal Datum: <input type="checkbox"/> NAD 1927 <input checked="" type="checkbox"/> NAD 1983					
A6. Attach at least 2 photographs of the building if the Certificate is being used to obtain flood insurance.					
A7. Building Diagram Number 1A					
A8. For a building with a crawlspace or enclosure(s): a) Square footage of crawlspace or enclosure(s) N/A sq ft b) Number of permanent flood openings in the crawlspace or enclosure(s) within 1.0 foot above adjacent grade N/A c) Total net area of flood openings in A8.b N/A sq in d) Engineered flood openings? <input type="checkbox"/> Yes <input checked="" type="checkbox"/> No					
A9. For a building with an attached garage: a) Square footage of attached garage N/A sq ft b) Number of permanent flood openings in the attached garage within 1.0 foot above adjacent grade N/A c) Total net area of flood openings in A9.b N/A sq in d) Engineered flood openings? <input type="checkbox"/> Yes <input checked="" type="checkbox"/> No					
SECTION B - FLOOD INSURANCE RATE MAP (FIRM) INFORMATION					
B1. NFIP Community Name & Community Number Pima County / 040073			B2. County Name Pima County		B3. State Arizona
B4. Map/Panel Number 04019C 2307	B5. Suffix M	B6. FIRM Index Date 09-28-2012	B7. FIRM Panel Effective/ Revised Date 09-28-2012	B8. Flood Zone(s) AE	B9. Base Flood Elevation(s) (Zone AO, use Base Flood Depth) 2600.1
B10. Indicate the source of the Base Flood Elevation (BFE) data or base flood depth entered in Item B9: <input checked="" type="checkbox"/> FIS Profile <input type="checkbox"/> FIRM <input type="checkbox"/> Community Determined <input type="checkbox"/> Other/Source: _____					
B11. Indicate elevation datum used for BFE in Item B9: <input type="checkbox"/> NGVD 1929 <input checked="" type="checkbox"/> NAVD 1988 <input type="checkbox"/> Other/Source: _____					
B12. Is the building located in a Coastal Barrier Resources System (CBRS) area or Otherwise Protected Area (OPA)? <input type="checkbox"/> Yes <input checked="" type="checkbox"/> No Designation Date: _____ <input type="checkbox"/> CBRS <input type="checkbox"/> OPA					

ELEVATION CERTIFICATE

OMB No. 1660-0008
Expiration Date: November 30, 2022

IMPORTANT: In these spaces, copy the corresponding information from Section A.			FOR INSURANCE COMPANY USE
Building Street Address (including Apt., Unit, Suite, and/or Bldg. No.) or P.O. Route and Box No. 10500 E. Tanque Verde Road, Building # 3			Policy Number:
City Tucson	State Arizona	ZIP Code 85749	Company NAIC Number

SECTION C – BUILDING ELEVATION INFORMATION (SURVEY REQUIRED)

C1. Building elevations are based on: ☐ Construction Drawings* ☐ Building Under Construction* ☒ Finished Construction

*A new Elevation Certificate will be required when construction of the building is complete.

C2. Elevations – Zones A1–A30, AE, AH, A (with BFE), VE, V1–V30, V (with BFE), AR, AR/A, AR/AE, AR/A1–A30, AR/AH, AR/AO. Complete Items C2.a–h below according to the building diagram specified in Item A7. In Puerto Rico only, enter meters.

Benchmark Utilized: PCDO/COT GIS Control Point 21 Vertical Datum: Elev.= 2578.62 (NAVD 88)

Indicate elevation datum used for the elevations in items a) through h) below.

☐ NGVD 1929 ☒ NAVD 1988 ☐ Other/Source: _____

Datum used for building elevations must be the same as that used for the BFE.

Check the measurement used.

- | | | | |
|---|--------|--|---------------------------------|
| a) Top of bottom floor (including basement, crawlspace, or enclosure floor) | 2599.7 | <input checked="" type="checkbox"/> feet | <input type="checkbox"/> meters |
| b) Top of the next higher floor | N/A | <input checked="" type="checkbox"/> feet | <input type="checkbox"/> meters |
| c) Bottom of the lowest horizontal structural member (V Zones only) | N/A | <input checked="" type="checkbox"/> feet | <input type="checkbox"/> meters |
| d) Attached garage (top of slab) | N/A | <input checked="" type="checkbox"/> feet | <input type="checkbox"/> meters |
| e) Lowest elevation of machinery or equipment servicing the building
(Describe type of equipment and location in Comments) | 2599.7 | <input checked="" type="checkbox"/> feet | <input type="checkbox"/> meters |
| f) Lowest adjacent (finished) grade next to building (LAG) | 2599.4 | <input checked="" type="checkbox"/> feet | <input type="checkbox"/> meters |
| g) Highest adjacent (finished) grade next to building (HAG) | 2599.5 | <input checked="" type="checkbox"/> feet | <input type="checkbox"/> meters |
| h) Lowest adjacent grade at lowest elevation of deck or stairs, including structural support | N/A | <input checked="" type="checkbox"/> feet | <input type="checkbox"/> meters |

SECTION D – SURVEYOR, ENGINEER, OR ARCHITECT CERTIFICATION

This certification is to be signed and sealed by a land surveyor, engineer, or architect authorized by law to certify elevation information. I certify that the information on this Certificate represents my best efforts to interpret the data available. I understand that any false statement may be punishable by fine or imprisonment under 18 U.S. Code, Section 1001.

Were latitude and longitude in Section A provided by a licensed land surveyor? ☒ Yes ☐ No ☒ Check here if attachments.

Certifier's Name
Douglas Scheider

License Number
17479

Title
Survey Manager / Associate

Company Name
Rick Engineering Company, Inc.

Address
3945 E. Fort Lowell Road, Suite 111

City
Tucson

State
Arizona

ZIP Code
85712

Signature



Digitally signed by Doug Schneider
DN: cn=Doug Schneider, o=Rick
Engineering, ou,
email=dschneider@rickengineering.c
om, c=US
Date: 2023.01.23 14:23:06 -07'00'

Date
01/23/2023

Telephone
(520) 795-1000

Ext.

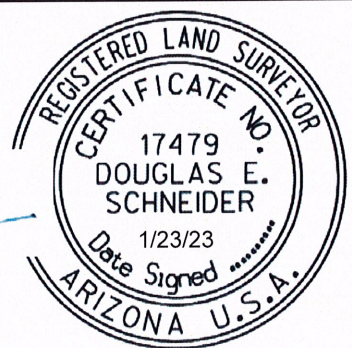

Copy all pages of this Elevation Certificate and all attachments for (1) community official, (2) insurance agent/company, and (3) building owner.

Comments (including type of equipment and location, per C2(e), if applicable)

The equipment servicing the building referenced in section C2(e) above is a hot water heater and all other equipment is above this elevation.

REFERENCE: Building Permit P22BP01929-01, FPUP #P22FC00243

ELEVATION CERTIFICATEOMB No. 1660-0008
Expiration Date: November 30, 2022

IMPORTANT: In these spaces, copy the corresponding information from Section A.			FOR INSURANCE COMPANY USE
Building Street Address (including Apt., Unit, Suite, and/or Bldg. No.) or P.O. Route and Box No. 10500 E. Tanque Verde Road, Building # 3			Policy Number:
City Tucson	State Arizona	ZIP Code 85749	Company NAIC Number

**SECTION E – BUILDING ELEVATION INFORMATION (SURVEY NOT REQUIRED)
FOR ZONE AO AND ZONE A (WITHOUT BFE)**

For Zones AO and A (without BFE), complete Items E1–E5. If the Certificate is intended to support a LOMA or LOMR-F request, complete Sections A, B, and C. For Items E1–E4, use natural grade, if available. Check the measurement used. In Puerto Rico only, enter meters.

- E1. Provide elevation information for the following and check the appropriate boxes to show whether the elevation is above or below the highest adjacent grade (HAG) and the lowest adjacent grade (LAG).
- a) Top of bottom floor (including basement, crawlspace, or enclosure) is _____ ☐ feet ☐ meters ☐ above or ☐ below the HAG.
- b) Top of bottom floor (including basement, crawlspace, or enclosure) is _____ ☐ feet ☐ meters ☐ above or ☐ below the LAG.
- E2. For Building Diagrams 6–9 with permanent flood openings provided in Section A Items 8 and/or 9 (see pages 1–2 of Instructions), the next higher floor (elevation C2.b in the diagrams) of the building is _____ ☐ feet ☐ meters ☐ above or ☐ below the HAG.
- E3. Attached garage (top of slab) is _____ ☐ feet ☐ meters ☐ above or ☐ below the HAG.
- E4. Top of platform of machinery and/or equipment servicing the building is _____ ☐ feet ☐ meters ☐ above or ☐ below the HAG.
- E5. Zone AO only: If no flood depth number is available, is the top of the bottom floor elevated in accordance with the community's floodplain management ordinance? ☐ Yes ☐ No ☐ Unknown. The local official must certify this information in Section G.

SECTION F – PROPERTY OWNER (OR OWNER'S REPRESENTATIVE) CERTIFICATION

The property owner or owner's authorized representative who completes Sections A, B, and E for Zone A (without a FEMA-issued or community-issued BFE) or Zone AO must sign here. The statements in Sections A, B, and E are correct to the best of my knowledge.

Property Owner or Owner's Authorized Representative's Name

Address City State ZIP Code

Signature Date Telephone

Comments

☐ Check here if attachments.

ELEVATION CERTIFICATE

OMB No. 1660-0008
Expiration Date: November 30, 2022

IMPORTANT: In these spaces, copy the corresponding information from Section A.			FOR INSURANCE COMPANY USE
Building Street Address (including Apt., Unit, Suite, and/or Bldg. No.) or P.O. Route and Box No. 10500 E. Tanque Verde Road, Building # 3			Policy Number:
City Tucson	State Arizona	ZIP Code 85749	Company NAIC Number

SECTION G – COMMUNITY INFORMATION (OPTIONAL)

The local official who is authorized by law or ordinance to administer the community's floodplain management ordinance can complete Sections A, B, C (or E), and G of this Elevation Certificate. Complete the applicable item(s) and sign below. Check the measurement used in Items G8–G10. In Puerto Rico only, enter meters.

- G1. ☐ The information in Section C was taken from other documentation that has been signed and sealed by a licensed surveyor, engineer, or architect who is authorized by law to certify elevation information. (Indicate the source and date of the elevation data in the Comments area below.)
- G2. ☐ A community official completed Section E for a building located in Zone A (without a FEMA-issued or community-issued BFE) or Zone AO.
- G3. ☐ The following information (Items G4–G10) is provided for community floodplain management purposes.

G4. Permit Number	G5. Date Permit Issued	G6. Date Certificate of Compliance/Occupancy Issued
-------------------	------------------------	---

G7. This permit has been issued for: ☐ New Construction ☐ Substantial Improvement

G8. Elevation of as-built lowest floor (including basement) of the building: _____ ☐ feet ☐ meters Datum _____

G9. BFE or (in Zone AO) depth of flooding at the building site: _____ ☐ feet ☐ meters Datum _____

G10. Community's design flood elevation: _____ ☐ feet ☐ meters Datum _____

Local Official's Name	Title
-----------------------	-------

Community Name	Telephone
----------------	-----------

Signature	Date
-----------	------

Comments (including type of equipment and location, per C2(e), if applicable)

☐ Check here if attachments.

ELEVATION CERTIFICATE**BUILDING PHOTOGRAPHS**

See Instructions for Item A6.

OMB No. 1660-0008

Expiration Date: November 30, 2022

IMPORTANT: In these spaces, copy the corresponding information from Section A.**FOR INSURANCE COMPANY USE**Building Street Address (including Apt., Unit, Suite, and/or Bldg. No.) or P.O. Route and Box No.
10500 E. Tanque Verde Road, Building # 3

Policy Number:

City
TucsonState
ArizonaZIP Code
85749

Company NAIC Number

If using the Elevation Certificate to obtain NFIP flood insurance, affix at least 2 building photographs below according to the instructions for Item A6. Identify all photographs with date taken; "Front View" and "Rear View"; and, if required, "Right Side View" and "Left Side View." When applicable, photographs must show the foundation with representative examples of the flood openings or vents, as indicated in Section A8. If submitting more photographs than will fit on this page, use the Continuation Page.



Photo One

Photo One Caption North side, picture date 01/12/23

Clear Photo One



Photo Two

Photo Two Caption East side, picture date 01/12/23

Clear Photo Two

ELEVATION CERTIFICATE**BUILDING PHOTOGRAPHS**

Continuation Page

OMB No. 1660-0008

Expiration Date: November 30, 2022

IMPORTANT: In these spaces, copy the corresponding information from Section A.**FOR INSURANCE COMPANY USE**Building Street Address (including Apt., Unit, Suite, and/or Bldg. No.) or P.O. Route and Box No.
10500 E. Tanque Verde Road, Building # 3

Policy Number:

City
TucsonState
ArizonaZIP Code
85749

Company NAIC Number

If submitting more photographs than will fit on the preceding page, affix the additional photographs below. Identify all photographs with: date taken; "Front View" and "Rear View"; and, if required, "Right Side View" and "Left Side View." When applicable, photographs must show the foundation with representative examples of the flood openings or vents, as indicated in Section A8.



Photo Three

Photo Three Caption West side, picture date 01/12/23

Clear Photo Three

Photo Four

Photo Four

Photo Four Caption

Clear Photo Four



3945 East Fort Lowell Rd., Suite 111
Tucson, AZ 85712

Tel: (520) 795-1000

Date 01-12-22
Job No. 3621-13
Page _____
Done By _____
Checked By _____

FFE EL=99.7

+ 3.10

HZ 102.80

Bm 1 -3.63

EL=99.17

Bm: 99.17

+ 3.80

HZ 102.97

-3.27

FFE 99.7

Bm-1 99.17

+ 4.72

HZ 103.89

FFE 99.66

+ 4.34

HZ 104.00

- 4.84

~~Bm 1~~ 99.16

SET 3

Bm 2 = 99.49

+ 4.13

HZ 103.62

50
-4.08
99.54

NAVEL

FFE
-4.23

99.66

50
-4.36
99.53

NAVEL
-4.27
99.62

-4.27
99.35

+ 0.10

NOTED
-3.72
100.17

0.49

42.1
- 68.14

99.68

SET 4
Z

-3.05

99.75

50
-3.49
99.31

50
-4.53
99.09

TILE

50
-5.01
98.61

FFE

PAVING

50
-3.83
98.97

Bm 1
NAVEL
99.17

-2.31
EL=99.49

SET 4
1

-3.33
99.47



3945 East Fort Lowell Rd., Suite 111
Tucson, AZ 85712
Tel: (520) 795-1000

Date 01-12-20
Job No. 2621-111
Page _____
Done By _____
Checked By _____

9
11
12

